

DRAINAGE AREA = 19 Ac		LOW GRADE ELE (FT)		754.64 (EXIST)		754.83 (PROPOSED)		@ Sta 871+37	
FLOOD FREQUENCY (YEAR)	Q C.F.	OPENING (SQ. FT.)	NAT. H. ELEV.	EXIST	PROP	HEAD (FT)	EXIST	PROP	HEADWATER ELE. (FT)
10	19	4.4	751.46	0.57	0.00	752.03	751.46	0.57	752.03
DESIGN	50	5.3	751.83	0.82	0.00	752.45	751.83	0.82	752.45
BASE	100	5.7	751.71	1.01	0.00	752.72	751.71	1.01	752.72
OVERTOP									
MAX CALC	500	5.2	751.83	1.44	0.37	753.27	751.83	1.44	753.27

Existing Structure Velocity (10-Yr) 5.0 fps
Proposed Structure Velocity (10-Yr) 5.0 fps

F.A. RTE.	SECTION	COUNTY	TOTAL SHEETS	SHEET NO.
549	116RS-1	OGLLE	593	77

STA. 467+00 TO STA. 483+00
FED. ROAD DIST. NO. ILLINOIS FED. AID PROJECT

DATE	BY
DATE	BY

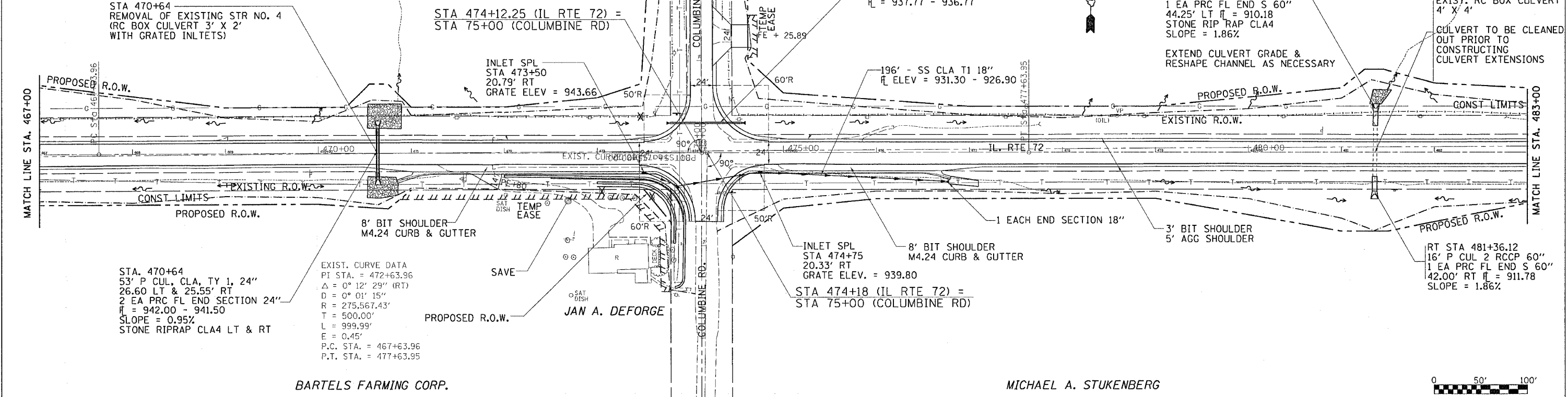

DATE	BY
DATE	BY

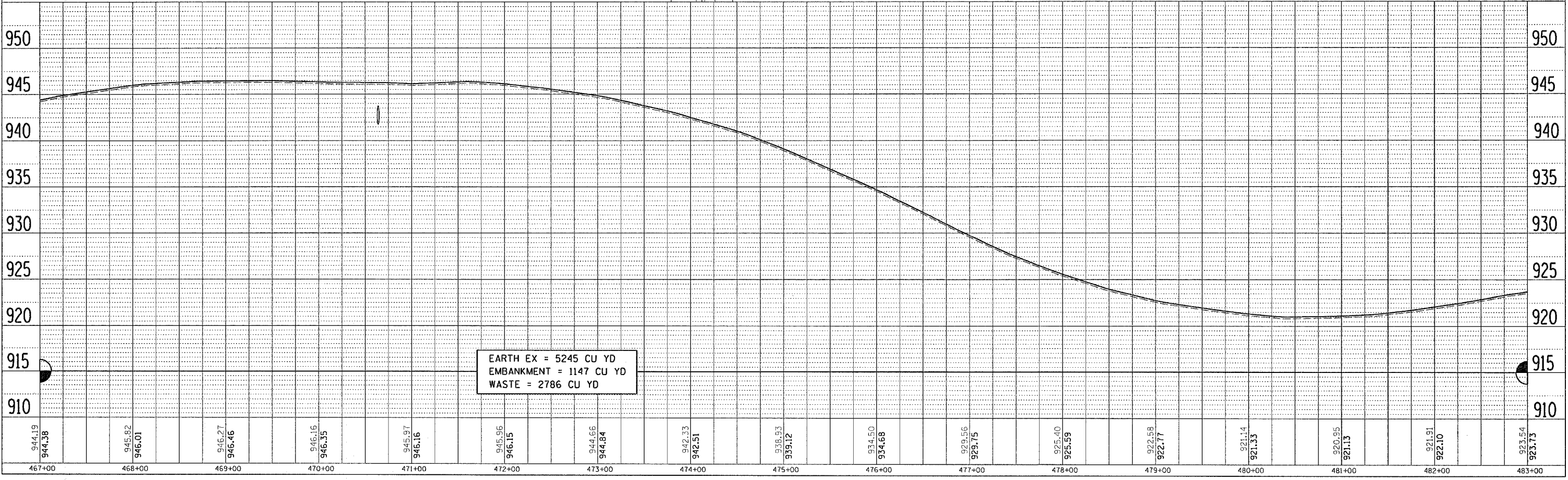

DATE-TIME
DRAWN-BREC
CHECKED-
DATE-
REF