

F.A.P. RTE.	SECTION	COUNTY	TOTAL SHEETS	SHEET NO.
549	116RS-1	OGLE	593	129
STA.		TO STA.		
FED. ROAD DIST. NO.		ILLINOIS FED. AID PROJECT		

REMOVAL ITEMS

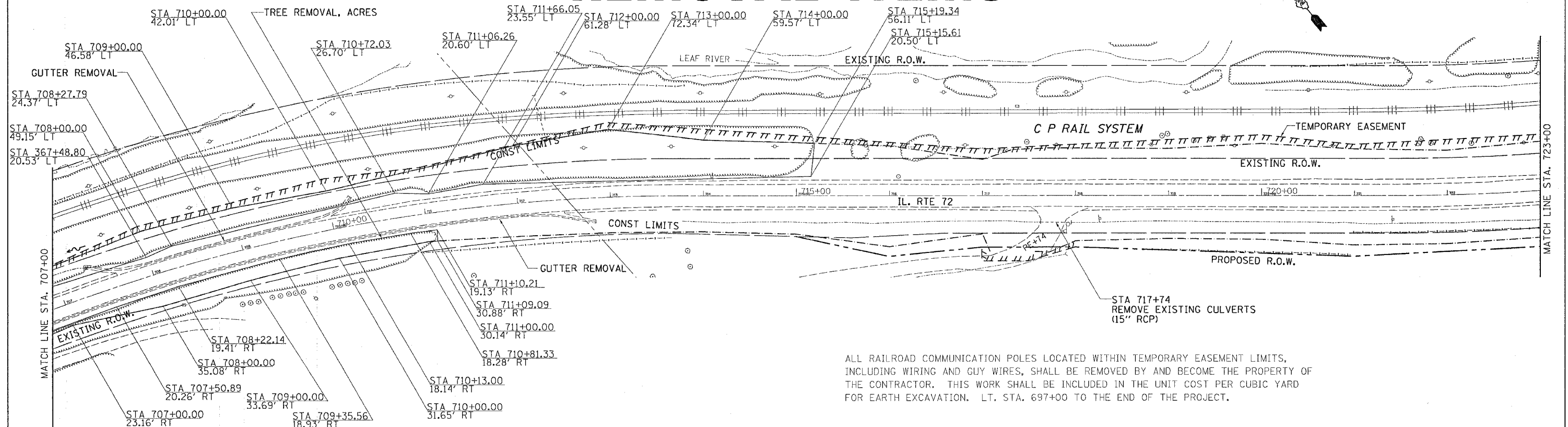

ALL RAILROAD COMMUNICATION POLES LOCATED WITHIN TEMPORARY EASEMENT LIMITS, INCLUDING WIRING AND GUY WIRES, SHALL BE REMOVED BY AND BECOME THE PROPERTY OF THE CONTRACTOR. THIS WORK SHALL BE INCLUDED IN THE UNIT COST PER CUBIC YARD FOR EARTH EXCAVATION. LT. STA. 697+00 TO THE END OF THE PROJECT.

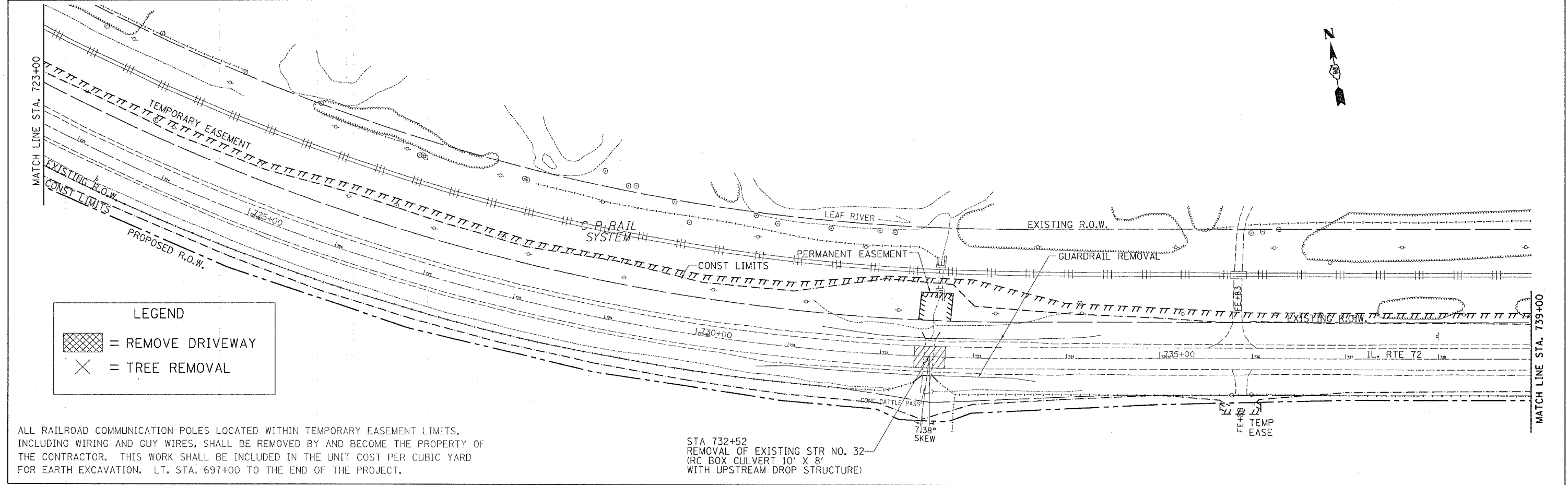

LEGEND	
	= REMOVE DRIVEWAY
	= TREE REMOVAL

ALL RAILROAD COMMUNICATION POLES LOCATED WITHIN TEMPORARY EASEMENT LIMITS, INCLUDING WIRING AND GUY WIRES, SHALL BE REMOVED BY AND BECOME THE PROPERTY OF THE CONTRACTOR. THIS WORK SHALL BE INCLUDED IN THE UNIT COST PER CUBIC YARD FOR EARTH EXCAVATION. LT. STA. 697+00 TO THE END OF THE PROJECT.

STA 732+52
REMOVAL OF EXISTING STR NO. 32
(RC BOX CULVERT 10' X 8'
WITH UPSTREAM DROP STRUCTURE)

PLOT DATE = Wed Feb 03 07:46:23 2005
FILE NAME = C:\projects\200417\080457\rem.dgn
PLOT SCALE = 50.0000 / IN.
REFERENCE = 116RS