

F.A.S. RTE.	SECTION	COUNTY	TOTAL SHEETS	SHEET NO.
1197	105-T	WHITESIDE	59	12
STA. 425+38		TO STA. 429+00		
FED. ROAD DIST. NO.		ILLINOIS FED. AID PROJECT		
CONTRACT 64421				

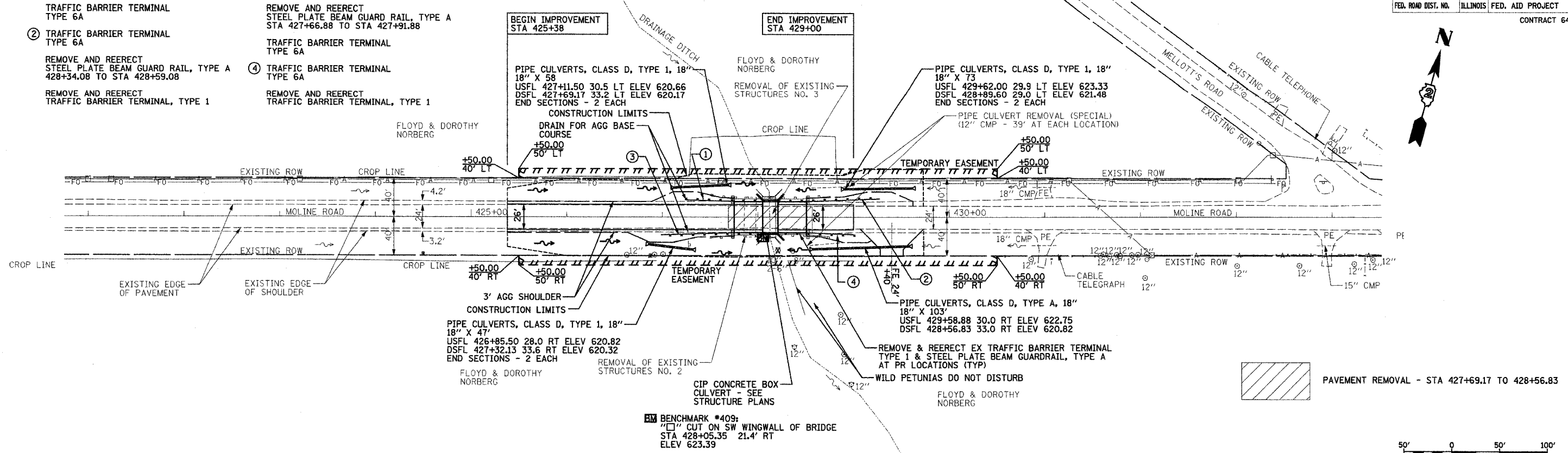

- ① REMOVE AND REERECT TRAFFIC BARRIER TERMINAL, TYPE 1
TRAFFIC BARRIER TERMINAL TYPE 6A
- ② TRAFFIC BARRIER TERMINAL TYPE 6A
REMOVE AND REERECT STEEL PLATE BEAM GUARD RAIL, TYPE A 428+34.08 TO STA 428+59.08
REMOVE AND REERECT TRAFFIC BARRIER TERMINAL, TYPE 1
- ③ REMOVE AND REERECT TRAFFIC BARRIER TERMINAL, TYPE 1
REMOVE AND REERECT STEEL PLATE BEAM GUARD RAIL, TYPE A STA 427+66.88 TO STA 427+91.88
TRAFFIC BARRIER TERMINAL TYPE 6A
- ④ TRAFFIC BARRIER TERMINAL TYPE 6A
REMOVE AND REERECT TRAFFIC BARRIER TERMINAL, TYPE 1



BENCHMARK *409:
" " CUT ON SW WINGWALL OF BRIDGE
STA 428+05.35 21.4' RT
ELEV 623.39

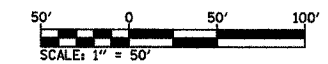

PLAN	DATE
BY	
NO.	
DATE	
BY	
NO.	
DATE	
BY	
NO.	

PROFILE	DATE
BY	
NO.	
DATE	
BY	
NO.	
DATE	
BY	
NO.	

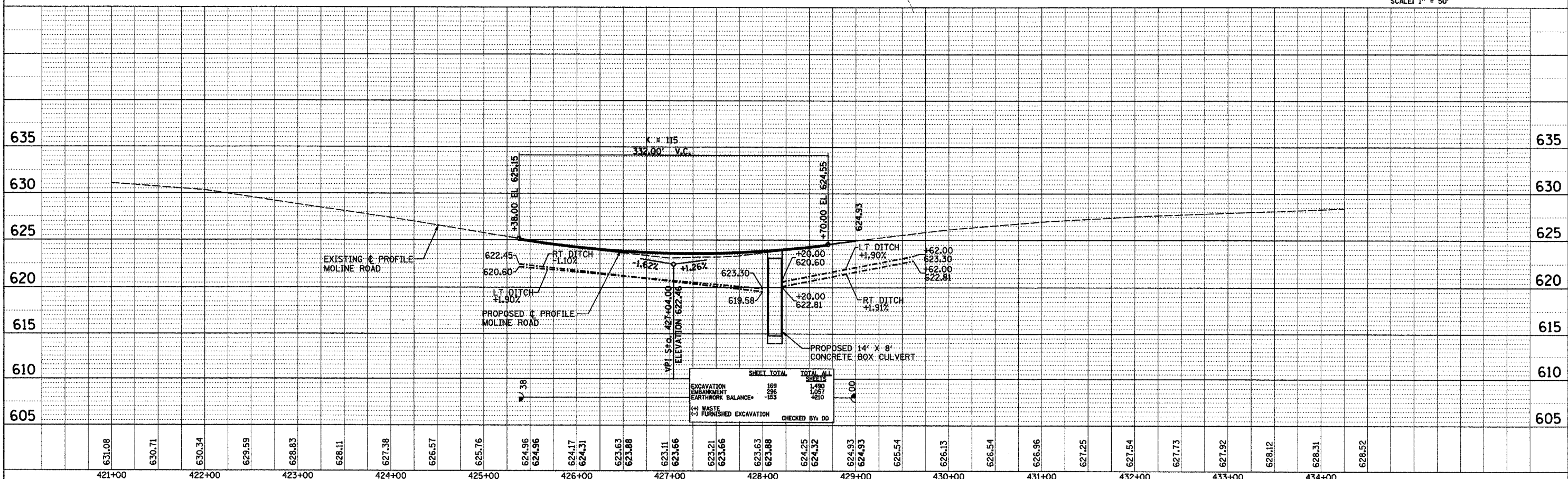

PLOT DATE: 11/8/2004 10:14:02 AM D05499PLN1b.dgn

MOLINE ROAD (0.5 mi SW of I-88)