

STATE OF ILLINOIS
DEPARTMENT OF TRANSPORTATION

ROUTE NO.	SECTION	COUNTY	TOTAL SHEETS	SHEET NO.	SHEET NO. 2
FAS 1197	105-T	Whiteside	51	28	5 SHEETS
FED. ROAD DIST. NO. 7	ILLINOIS	FED. AID PROJECT			64421

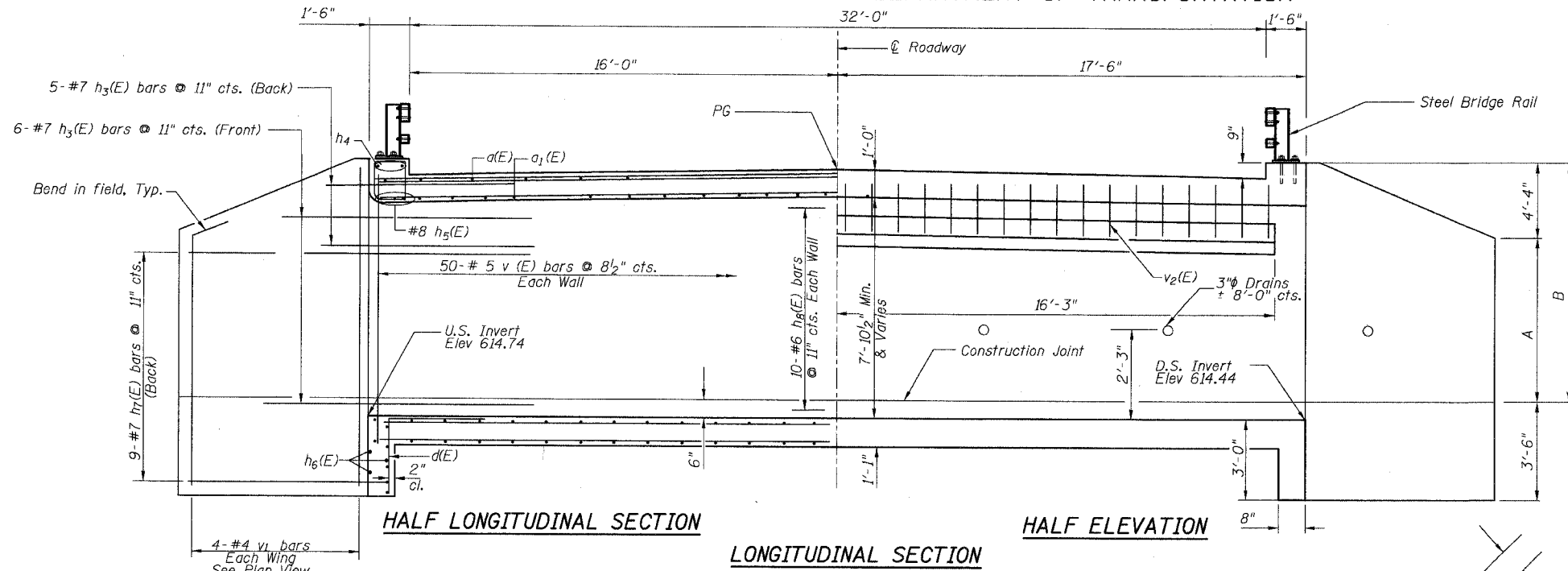

HALF LONGITUDINAL SECTION

HALF ELEVATION

LONGITUDINAL SECTION

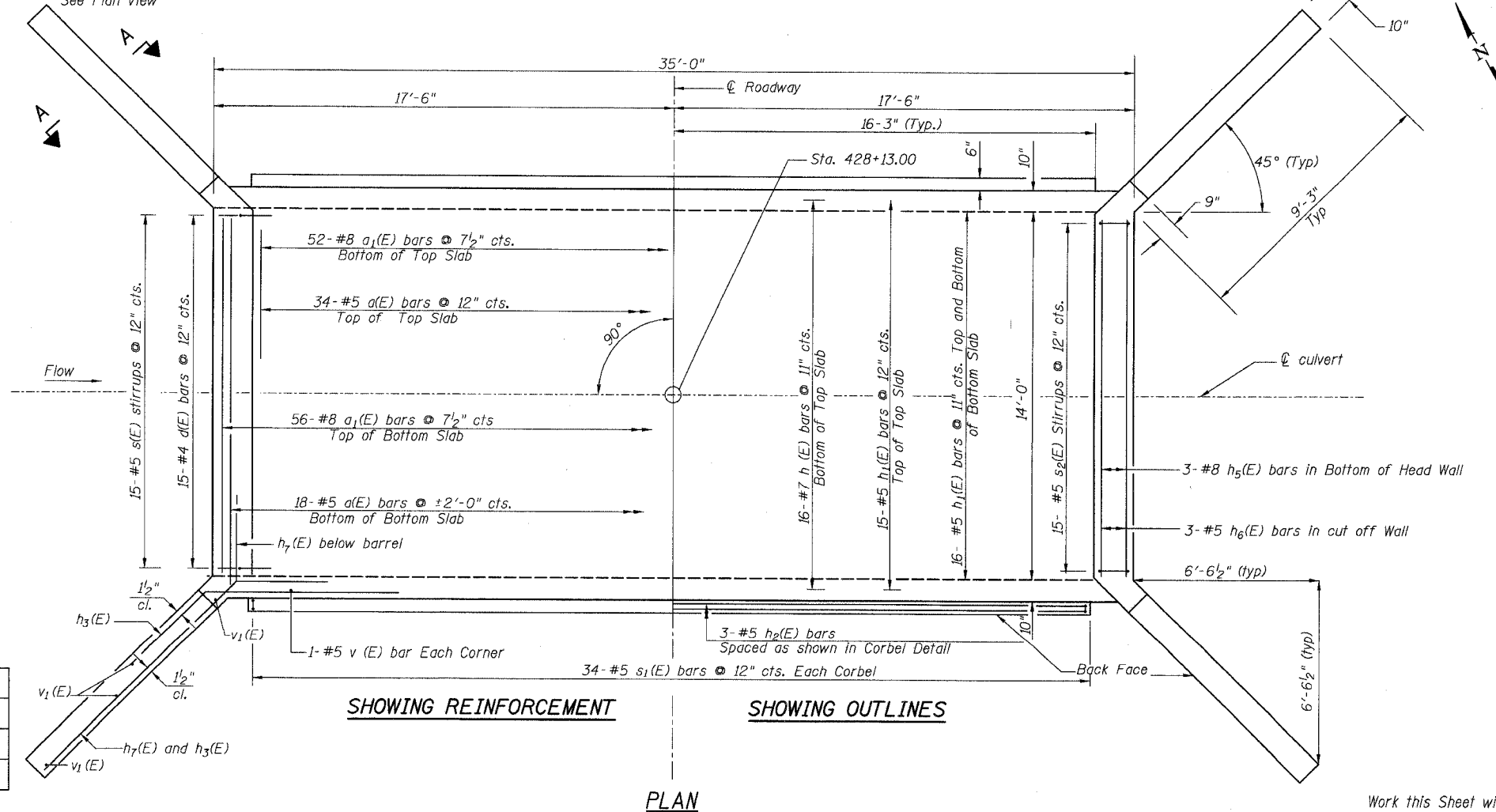

SHOWING REINFORCEMENT

SHOWING OUTLINES

PLAN

TABLE OF DIMENSIONS

LOCATION	A	B
North West Wing	4'-11 ³ / ₄ "	9'-3 ³ / ₄ "
South West Wing	4'-10 ³ / ₈ "	9'-2 ³ / ₈ "
North East Wing	5'-3 ³ / ₈ "	9'-7 ³ / ₈ "
South East Wing	5'-2"	9'-6"

BILL OF MATERIAL

Bar	No.	Size	Length	Shape
a(E)	52	#5	15'-3"	—
a1(E)	108	#8	17'-2"	U
d(E)	30	#4	4'-6"	L
h(E)	16	#7	34'-8"	—
h1(E)	47	#5	34'-8"	—
h2(E)	6	#5	32'-3"	—
h3(E)	44	#7	8'-0"	—
h4(E)	4	#6	15'-0"	—
h5(E)	6	#8	15'-0"	—
h6(E)	6	#5	15'-3"	—
h7(E)	36	#7	12'-4"	—
h8(E)	20	#6	34'-8"	—
s(E)	15	#5	5'-11"	□
s1(E)	68	#5	4'-3"	□
s2(E)	15	#5	5'-9"	□
v(E)	104	#5	9'-9"	—
v1(E)	16	#4	12'-3"	—
v2(E)	68	#5	2'-0"	—
Concrete Box Culverts			Cu. Yd.	76.4
Reinforcement Bars (Epoxy coated)			Pound	13820

Notes:
A distance of half the length of the wingwall but not less than six feet of the barrel shall be poured monolithically with the wingwalls.

Reinforcement bars designated (E) shall be epoxy coated.

CULVERT DETAILS
FAS ROUTE 1197 - SECTION 105-T
WHITESIDE COUNTY
STATION 428+13.00
STRUCTURE NO. 098-1013

MID-AMERICA ENGINEERING SERVICES
975 South Durkin Dr, Springfield IL 62704

Work this Sheet with Sheet No. 3 of 5.

DESIGNED	-	K.R.G.
CHECKED	-	J.L.K.
DRAWN	-	M.D.
CHECKED	-	J.L.K.