

F.A.P. RTE.	SECTION	COUNTY	TOTAL SHEETS	SHEET NO.
553	120RS-3	OGLE	145	79
STA.		TO STA.		
FED. ROAD DIST. NO.		ILLINOIS	FED. AID PROJECT	

# ELEVATION DETAILS

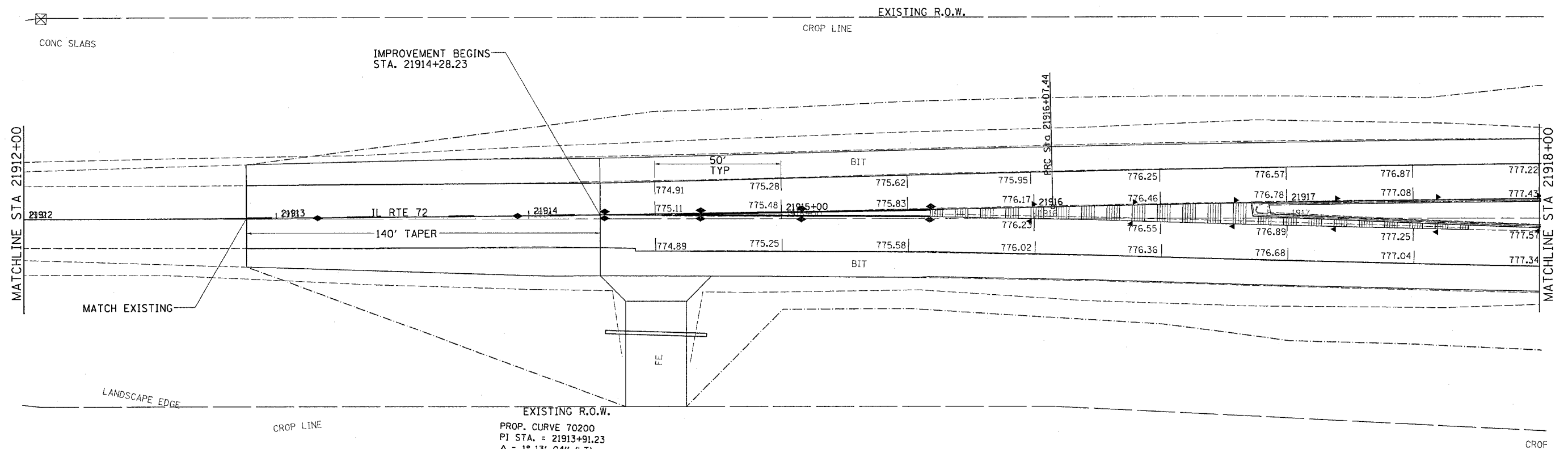

PROP. CURVE 70200  
 P.I. STA. = 21913+91.23  
 $\Delta = 1^\circ 13' 04''$  (LT)  
 $D = 0^\circ 16' 54''$   
 $R = 20,343.89'$   
 $T = 216.22'$   
 $L = 432.42'$   
 $e = 1.15'$   
 $e = \text{-----}$   
 $T.R. = \text{-----}$   
 $S.E. \text{ RUN} = \text{-----}$   
 P.C. STA = 21911+75.02  
 P.T. STA = 21916+07.44

PLOT DATE = Mon Mar 28 14:56:12 2005  
 FILE NAME = c:\p\c\m\p\21912-21918.dgn  
 PLOT SCALE = 20.0000 / IN.