

F.A.P. RTE.	SECTION	COUNTY	TOTAL SHEETS	SHEET NO.
595	(2)RM & TS	HENRY	90	44
STA.		TO STA.		
FED. ROAD DIST. NO.		ILLINOIS FED. AID PROJECT		

**GENERAL NOTES**

1. NO WORK SHALL BE ALLOWED UNTIL ALL NECESSARY COMPONENTS, TO COMPLETE THE SIGNAL INSTALLATION HAVE ARRIVED ON THE JOB SITE.
2. THE MOUNTING HEIGHT FOR THE LUMINAIRES SHALL BE 35'-0B TENON MOUNTED WITH AN 8' HORIZONTAL ARM.
3. ALL TRAFFIC SIGNAL MAST ARM ASSEMBLIES (STANDARD, COMBINATION, OR DUAL) MUST BE DESIGNED FOR THE LOADING SHOWN ON THE HIGHWAY STANDARDS OR THESE SIGNAL PLANS, WHICHEVER IS GREATER.
4. THE EXACT LOCATION OF MAST ARM ASSEMBLIES SHALL BE DETERMINED BY THE FIELD ENGINEER.
5. ANY SIGNS NOT INCLUDED AS REMOVED OR RE-ERECT IN THESE PLANS WHICH REQUIRE RELOCATION OR RE-ERECTION DO TO THIS PROJECT SHALL BE IN ACCORDANCE WITH ART. 107.25 OF THE CURRENT STANDARD SPECIFICATIONS FOR ROAD AND BRIDGE CONSTRUCTION MANUAL.
6. KURT GLAZIER, 815-284-5478, OF THE ILLINOIS DEPARTMENT OF TRANSPORTATION SHALL BE NOTIFIED TWO (2) WEEKS PRIOR TO THE LOCATION AND PLACEMENT OF SIGNS ON THIS PROJECT.
7. THE FOLLOWING REMOVAL OF EXISTING TRAFFIC SIGNAL EQUIPMENT COST SHALL INCLUDE ANY NECESSARY MATERIAL AND WORK TO REMOVE THE FOLLOW EQUIPMENT. THIS EQUIPMENT SHALL BE REMOVED BY THE CONTRACTOR AND RETAINED BY HIM/HER FOR SALVAGE:  
 1 EACH FLASHING BEACON  
 1 EACH SIGNAL POST  
 1 EACH POST FOUNDATION  
 1 EACH FLASHER CONTROLLER  
 1 EACH ELECTRIC SERVICE

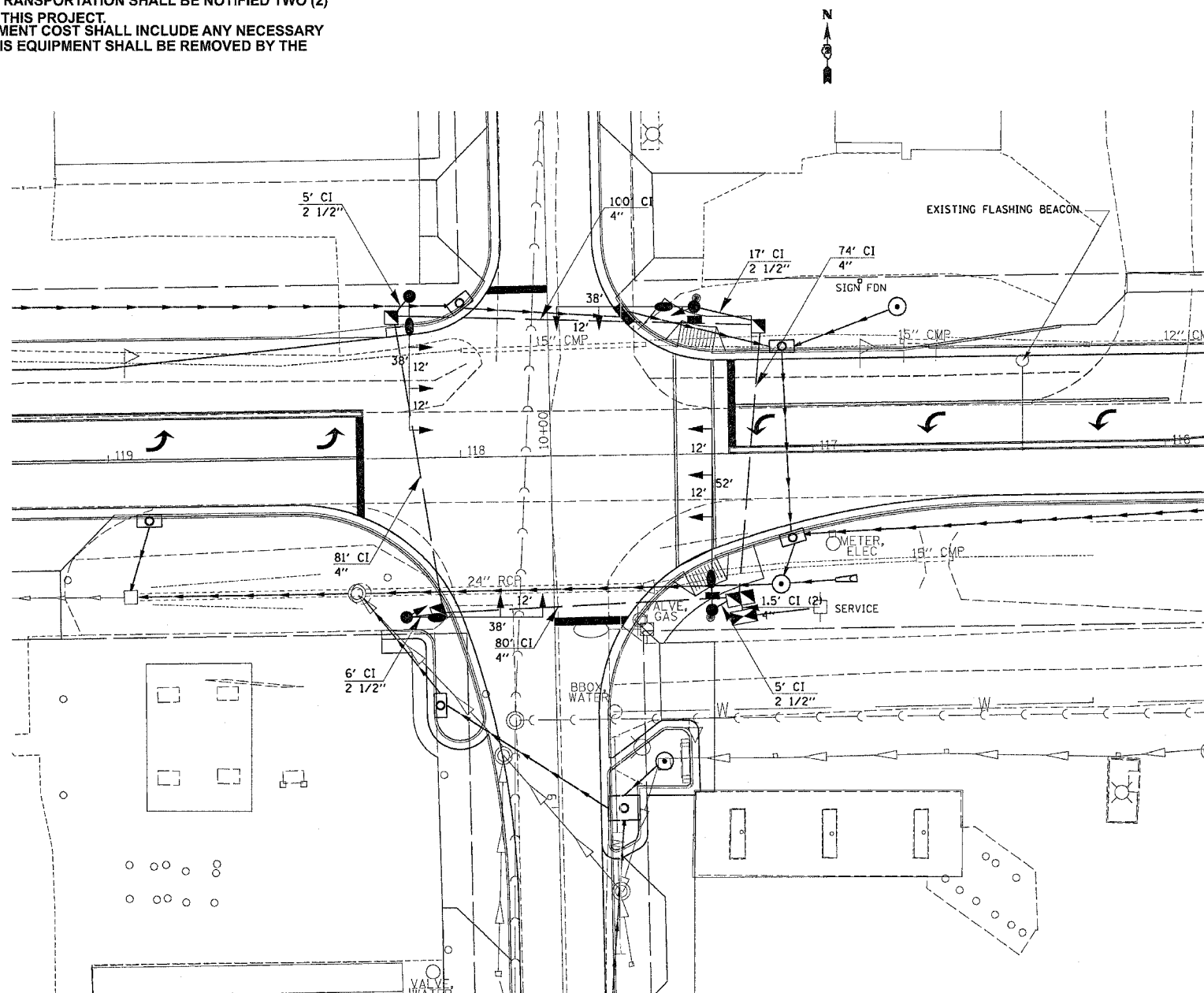

PAY CODE	ITEM	UNIT	TOTAL
<b>Tabulation of Signal Quantities for IL 84 @ 5TH ST Colona</b>			
X0324887	CONDUIT INSTALLED, 2 1/2", NON-METALLIC	FOOT	33
X0324888	CONDUIT INSTALLED, 4", NON-METALLIC	FOOT	247
72000100	SIGN PANEL - TYPE I	SQ FT	51
73000100	WOOD SIGN SUPPORT	FOOT	60
80501000	SERVICE INSTALLATION (SPECIAL)	EACH	1
81012500	CONDUIT IN TRENCH, 1 1/2", PVC	FOOT	10
81400400	CONCRETE HANDHOLE	EACH	3
81400600	CONCRETE DOUBLE HANDHOLE	EACH	1
81702110	ELECTRIC CABLE IN CONDUIT, 600V (XLP TYPE USE) 1/C NO. 10	FOOT	1038
82103250	LUMINAIRE, SODIUM VAPOR, HORIZONTAL, PHOTO-CELL CONTROLLER, 250 WATT	EACH	4
85700200	FULL-ACTUATED CONTROLLER AND TYPE IV CABINET	EACH	1
87301215	ELECTRIC CABLE IN CONDUIT, SIGNAL, NO. 14 2C	FOOT	141
87301225	ELECTRIC CABLE IN CONDUIT, SIGNAL, NO. 14 3C	FOOT	161
87301245	ELECTRIC CABLE IN CONDUIT, SIGNAL, NO. 14 5C	FOOT	1050
87301255	ELECTRIC CABLE IN CONDUIT, SIGNAL, NO. 14 7C	FOOT	565
87301815	ELECTRIC CABLE IN CONDUIT, SERVICE, NO. 6 3C	FOOT	20
87702920	STEEL COMBINATION MAST ARM ASSEMBLY AND POLE 38 FT	EACH	3
87702985	STEEL COMBINATION MAST ARM ASSEMBLY AND POLE 52 FT	EACH	1
87800200	CONCRETE FOUNDATION, TYPE D	FOOT	3.5
87800400	CONCRETE FOUNDATION, TYPE E, 30-INCH DIAMETER	FOOT	40.5
87800415	CONCRETE FOUNDATION, TYPE E, 36-INCH DIAMETER	FOOT	15
88200400	TRAFFIC SIGNAL BACKPLATE, FORMED PLASTIC	EACH	10
88800100	PEDESTRIAN PUSH-BUTTON	EACH	2
X0320872	VIDEO VEHICLE DETECTION SYSTEM	EACH	1
X0323153	ELECTRIC CABLE IN CONDUIT, GROUND, No. 6 1C (GREEN)	FOOT	438
X0962500	REMOVE EXISTING TRAFFIC SIGNAL EQUIPMENT	L SUM	1
X8801310	SIGNAL HEAD, POLYCARBONATE, LED, 1-FACE, 3-SECTION, MAST ARM MOUNTED	EACH	8
X8801395	SIGNAL HEAD, POLYCARBONATE, LED, 1-FACE, 5-SECTION, BRACKET MOUNT	EACH	2
X8801400	SIGNAL HEAD, POLYCARBONATE, LED, 1-FACE, 5-SECTION, MAST ARM MOUNTED	EACH	2
X8810395	PEDESTRIAN SIGNAL HEAD, POLYCARBONATE, LED, 1-FACE, BRACKET MOUNT	EACH	2

**LEGEND**

- EXISTING CONTROLLER
- NEW CONTROLLER
- EXISTING ALUMINUM MAST ARM ASSEMBLY AND POLE
- NEW ALUMINUM MAST ARM ASSEMBLY AND POLE
- EXISTING STEEL MAST ARM ASSEMBLY AND POLE
- NEW STEEL MAST ARM ASSEMBLY AND POLE
- EXISTING SIGNAL HEAD AND POST
- NEW SIGNAL HEAD AND POST
- EXISTING SIGNAL HEAD
- NEW SIGNAL HEAD WITH BACKPLATE
- EXISTING PEDESTRIAN HEAD
- NEW PEDESTRIAN HEAD
- PEDESTRIAN PUSHBUTTON
- EXISTING HANDHOLE
- NEW HANDHOLE
- NEW JUNCTION BOX
- NEW HEAVY-DUTY HANDHOLE
- NEW DOUBLE HANDHOLE
- EXISTING CONDUIT (LENGTH AND SIZE)
- NEW LUMINAIRE
- NEW CONDUIT INSTALLED, NON-METALLIC
- UPPER NUMERAL INDICATES LENGTH
- "CI" INDICATES CONDUIT INSTALLED, NON -METALLIC
- WHETHER PUSHED OR TRENCHED
- LOWER NUMERAL INDICATES SIZE OF CONDUIT

TYPE E, 30"	
MAST ARM LENGTH (FT)	FOUNDATION DEPTH (FT)
38	13.5
38	13.5
38	13.5
	40.5

TYPE E, 36"	
MAST ARM LENGTH (FT)	FOUNDATION DEPTH (FT)
52	15

REVISIONS		ILLINOIS DEPARTMENT OF TRANSPORTATION
NAME	DATE	
		SCALE: VERT. HORIZ. DATE DRAWN BY CHECKED BY