

I:\projects\2011\20110520\110520\110520.dwg

| F.A.I. RTE.                          | SECTION                | COUNTY   | TOTAL SHEETS     | SHEET NO. |
|--------------------------------------|------------------------|----------|------------------|-----------|
| 74                                   | 00-DR-29013,14,15-IR-1 | TAZEWELL | 1566             | 119       |
| STA. 153+150.000 TO STA. 153+892.180 |                        |          |                  |           |
| FED. ROAD DIST. NO. 4                |                        | ILLINOIS | FED. AID PROJECT |           |

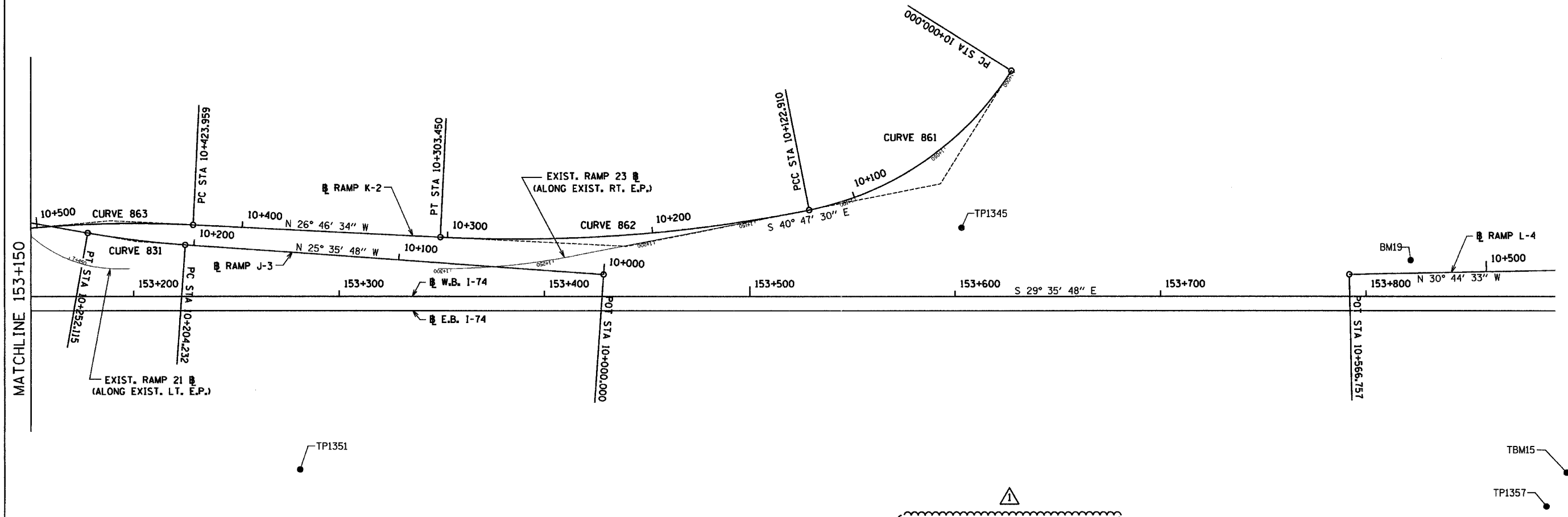
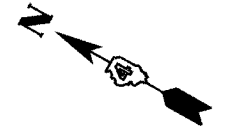
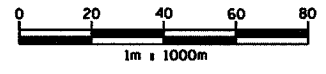

PROP. CURVE 831  
 PI STA = 10+228.196  
 N 444472.468  
 E 750231.584  
 $\Delta = 6^\circ 05' 48''$  (RT)  
 R = 450.000 m  
 T = 23.964 m  
 L = 47.883 m  
 E = 0.638 m  
 S.E. = 6.2%  
 P.C. STA = 10+204.232  
 N 444450.856  
 E 750241.937  
 P.T. STA = 10+252.115  
 N 444495.058  
 E 750223.585  
 TRANSITION IN: 10+177 - 10+218  
 TRANSITION OUT: 10+237 - 10+283

PROP. CURVE 861  
 PI STA = 10+065.099  
 N 444145.742  
 E 750449.223  
 $\Delta = 46^\circ 41' 46''$  (RT)  
 R = 150.810 m  
 T = 65.099 m  
 L = 122.910 m  
 E = 13.451 m  
 S.E. = 7.8%  
 P.C. STA = 10+000.000  
 N 444142.889  
 E 750514.260  
 P.C.C. STA = 10+122.910  
 N 444195.028  
 E 750406.693  
 TRANSITION IN: 9+969 - 10+016  
 TRANSITION OUT: 10+102 - 10+123

PROP. CURVE 862  
 PI STA = 10+213.633  
 N 444263.713  
 E 750347.423  
 $\Delta = 14^\circ 00' 56''$  (RT)  
 R = 738.047 m  
 T = 90.723 m  
 L = 180.540 m  
 E = 5.555 m  
 S.E. = 2.8%  
 P.C.C. STA = 10+122.910  
 N 444195.028  
 E 750406.693  
 P.T. STA = 10+303.450  
 N 444344.708  
 E 750306.552  
 TRANSITION IN: 10+123 - 10+144  
 TRANSITION OUT: 10+299 - 10+310

PROP. CURVE 863  
 PI STA = 10+464.428  
 N 444488.424  
 E 750234.031  
 $\Delta = 7^\circ 58' 57''$  (LT)  
 R = 580.000 m  
 T = 40.469 m  
 L = 80.806 m  
 E = 1.410 m  
 S.E. = -4.4%  
 P.C. STA = 10+423.959  
 N 444452.295  
 E 750252.262  
 P.T. STA = 10+504.765  
 N 444521.672  
 E 750210.959  
 TRANSITION IN: 10+385 - 10+443  
 TRANSITION OUT: 10+484 - 10+547

NOTE:  
 FOR COORDINATES OF "ECS" AND "TP" POINTS  
 SEE REFERENCE TIES & BENCHMARK SHT.  
 FOR BENCHMARK INFORMATION SEE  
 REFERENCE TIES & BENCHMARK SHT.

REVISIONS  
 NAME DATE  
 1 MAY 27 2005

ILLINOIS DEPARTMENT OF TRANSPORTATION  
 SCHEMATIC DRAWING  
 WESTBOUND I-74  
 STA. 153+150.000 TO  
 STA. 153+892.180

**URS**  
 URS CORPORATION  
 ST. LOUIS, MO

DATE 12/20/04  
 DRAWN BY JEH  
 CHECKED BY MLB