

D:\Projects\1101-Sema-115.dgn 5/27/2005 9:03:27 AM

F.A.I. RTE.	SECTION	COUNTY	TOTAL SHEETS	SHEET NO.
74	*	TAZEWELL	136	171
STA.		TO STA.		
FED. ROAD DIST. NO.		ILLINOIS FED. AID PROJECT		

*(90-11)R-2;90(13,14,14-1)R-1

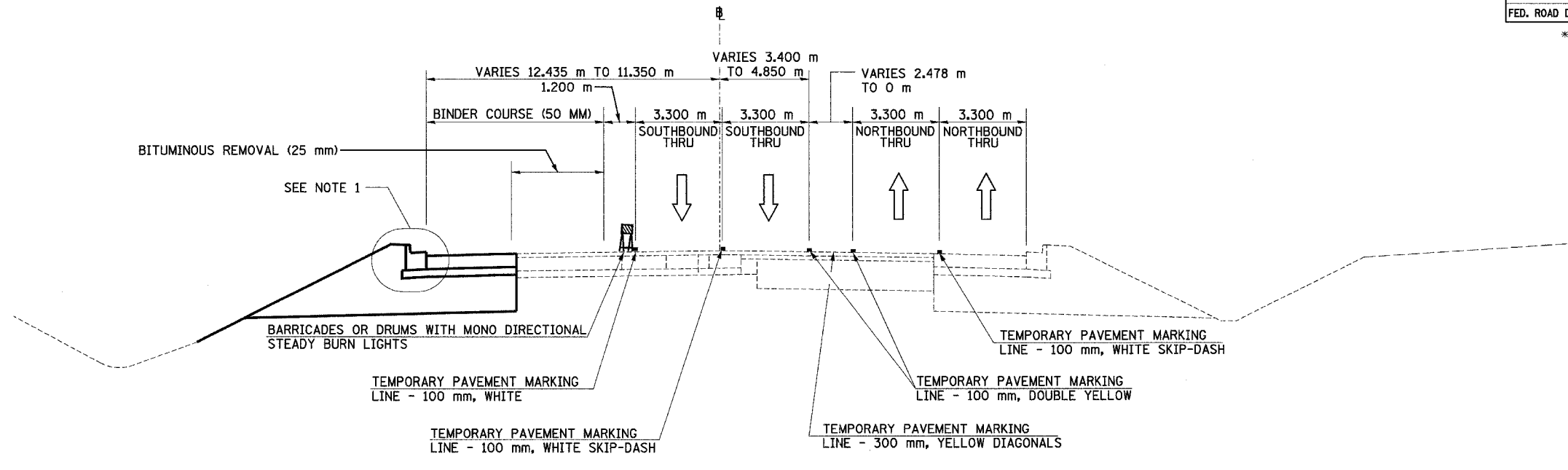

NORTH MAIN ST MOT TYPICAL SECTION NO. 13B (13B)
 STA. 3+058.794 TO STA. 3+178.034

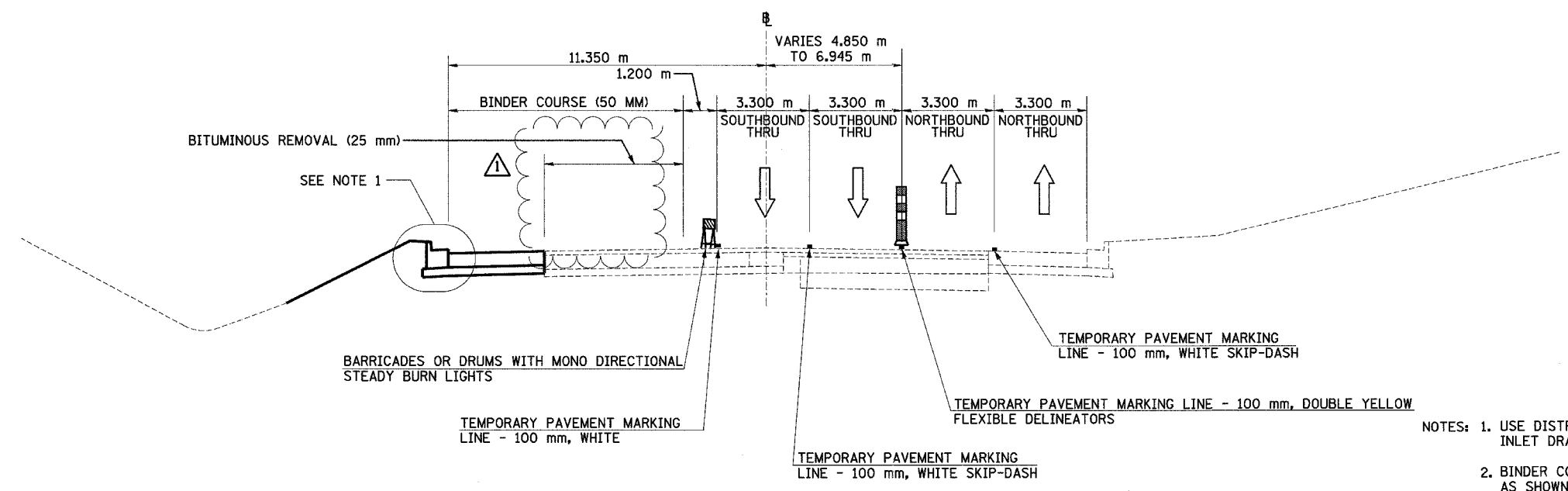

NORTH MAIN ST MOT TYPICAL SECTION NO. 14B (14B)
 STA. 3+178.034 TO STA. 3+546.295

- NOTES: 1. USE DISTRICT 4 STANDARD 602401-D4, TEMPORARY INLET DRAINAGE TREATMENT
 2. BINDER COURSE IS TO BE PLACED IN WORKZONE AREAS AS SHOWN

⚠ REVISIED REMOVAL LIMIT

REVISIONS	
NAME	DATE
⚠	MAY 27 2005



ILLINOIS DEPARTMENT OF TRANSPORTATION
 FAI ROUTE 74 (I-74)
 MAINTENANCE OF TRAFFIC
 STAGE 3A-3
 ILL. 116-U.S. 150-NORTH MAIN ST.
 TYPICAL SECTIONS 13B & 14B
 DATE 12/20/2004
 DRAWN BY MRF
 CHECKED BY RTG