

I:\projects\9002\2004\11-20-04\11-20-04.dwg 5/27/2005 11:28:24 AM

STAGE 3B CONSTRUCTION:

- ① PROVIDE EXIT FROM WB I-74 TO NB MAIN STREET USING TEMPORARY PAVEMENT AND EXISTING RAMP 19
- ② CONSTRUCT WEST BOUND I-74 FROM STATION 153+167 TO STATION 153+470.
- ③ CONSTRUCT RAMP J-3 AND RAMP K-2. RAMP K-2 STRUCTURES OVER NORTH MAIN STREET CAN BE PLACED.
- ④ CONSTRUCT RETAINING WALL 81

TRAFFIC:

1. THE EAST AND WEST BOUND LANES OF I-74 ARE OPEN AT ALL TIMES.
2. MAINTAIN TWO LANES OF TRAFFIC IN EACH DIRECTION ON I-74 DURING PEAK HOURS AND AT LEAST ONE LANE OF TRAFFIC IN EACH DIRECTION DURING OFF PEAK HOURS. LANE CLOSURES SHALL BE IN ACCORDANCE WITH STANDARD 701406.
3. MAINTAIN TWO LANES OF TRAFFIC IN EACH DIRECTION ON NORTH MAIN STREET DURING PEAK HOURS AND AT LEAST ONE LANE OF TRAFFIC IN EACH DIRECTION DURING OFF PEAK HOURS. LANE CLOSURES SHALL BE IN ACCORDANCE WITH STANDARD 701602.
4. FOR RELOCATION OF TEMPORARY CONCRETE BARRIER FOR THE TEMPORARY RAMP, USE STANDARD 701101.
5. TEMPORARY RAMP 19 MUST OPEN TO TRAFFIC PRIOR TO THE CLOSURE OF RAMP L-3

GENERAL NOTES:

SEE SIGNING PLAN FOR STAGED REMOVAL OF EXISTING SIGNS AND STAGED PLACEMENT OF PROPOSED INFORMATION AND GUIDE SIGNS.

THE STAGED CONSTRUCTION SHOWN HERE IS A GENERAL SEQUENCING SUGGESTION.

SEE PLAN SET 2 OF 4 FOR MAINTENANCE OF TRAFFIC FOR WASHINGTON STREET, RAMP L-3, AND L-4.

F.A.I. RTE.	SECTION	COUNTY	TOTAL SHEETS	SHEET NO.
74	(90-11R-2; 90(13,14,14-1R-1	TAZEWELL	1306	201
STA. 152+445.837 TO STA. 153+892.180				
FED. ROAD DIST. NO. 4 ILLINOIS			FED. AID PROJECT	

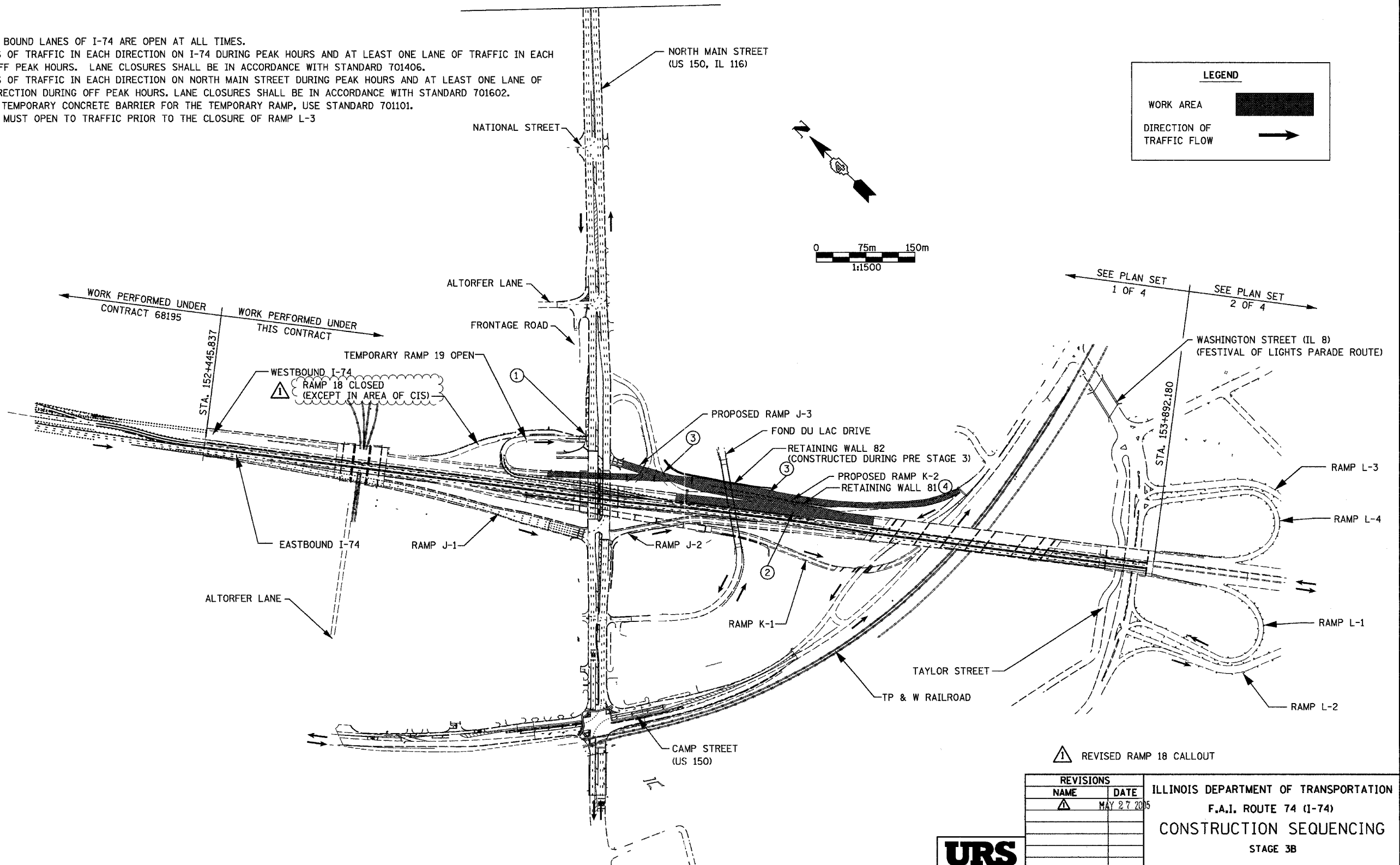

△ REVISED RAMP 18 CALLOUT

REVISIONS	
NAME	DATE
△	MAY 27 2005

ILLINOIS DEPARTMENT OF TRANSPORTATION
 F.A.I. ROUTE 74 (I-74)
 CONSTRUCTION SEQUENCING
 STAGE 3B



DATE 12/20/2004
 DRAWN BY KMO
 CHECKED BY RTG