

F.A.P. RTE.	SECTION	COUNTY	TOTAL SHEETS	SHEET NO.
310	138-2RS	MCDONOUGH	66	44
STA. 85+00		TO STA. 98+50		
FED. ROAD DIST. NO.		ILLINOIS		FED. AID PROJECT

T6N R3W 4TH PM (MACOMB CITY TWP)
SECTION 30

T6N R3W 4TH PM (MACOMB CITY TWP)
SECTION 25

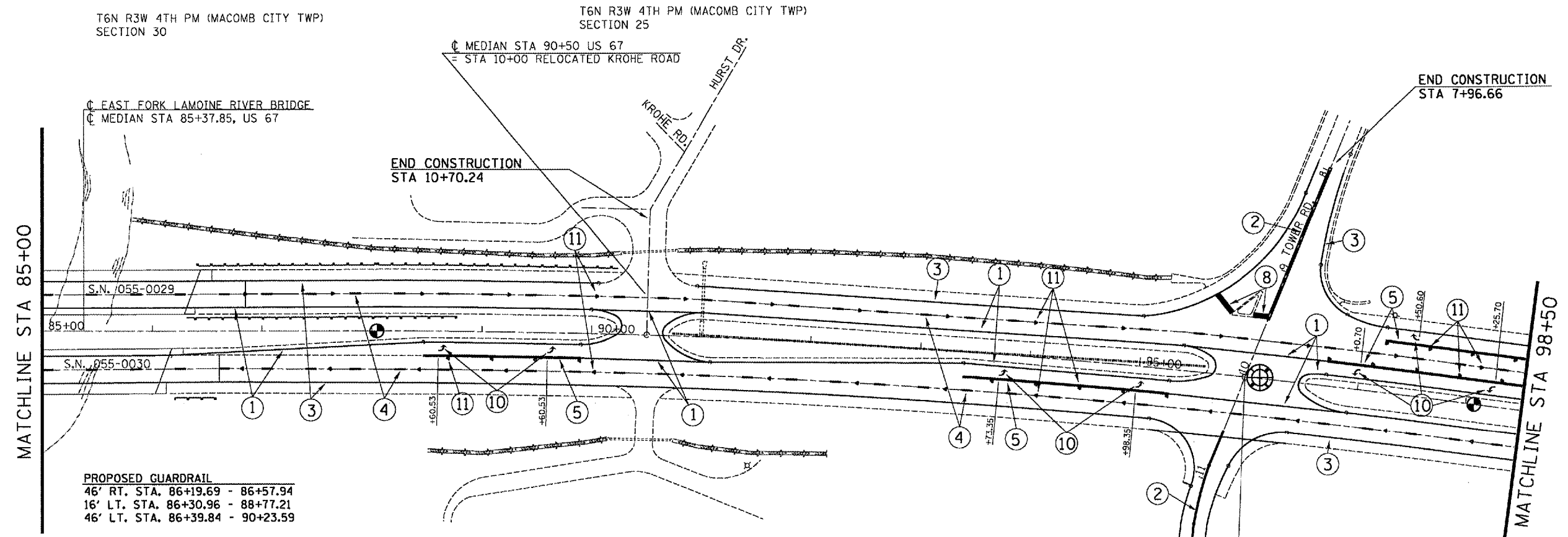

PROPOSED GUARDRAIL
 46' RT. STA. 86+19.69 - 86+57.94
 16' LT. STA. 86+30.96 - 88+77.21
 46' LT. STA. 86+39.84 - 90+23.59

T6N R2W 4TH PM (MACOMB CITY TWP)
SECTION 30

- ① 4" YELLOW EPOXY LINE
- ② 4" DOUBLE YELLOW EPOXY LINES
- ③ 4" WHITE EPOXY LINE
- ④ 6" WHITE PREFORMED PLASTIC LINE (30' SKIP/10' DASH)
- ⑤ 8" WHITE EPOXY LINE
- ⑥ 12" WHITE EPOXY LINE
- ⑦ 12" YELLOW EPOXY LINE
- ⑧ 24" WHITE EPOXY LINE
- ⑨ YELLOW EPOXY TURN ARROWS
- ⑩ WHITE EPOXY TURN ARROWS
- ⑪ ONE-WAY CRYSTAL
- ⑫ ONE-WAY AMBER
- ⑬ TWO-WAY AMBER

REVISIONS	
NAME	DATE

ILLINOIS DEPARTMENT OF TRANSPORTATION
PROPOSED STRIPING
 STA 85+00 - 98+50

SCALE: VERT. 1" = 50'
 HORIZ. 1" = 50'

DATE: _____ DRAWN BY: CADD
 CHECKED BY: _____



PLOT DATE: 3/23/2005
 FILE NAME: c:\projects\69334\sheet.dgn
 PLOT SCALE: 1/8" = 100'
 REFERENCE: SHEET