

CONTRACT NO. 68334				
F.A.P. RITE.	SECTION	COUNTY	TOTAL SHEETS	SHEET NO.
310	138-21RS	MCDONOUGH	66	48
STA. 140+00		TO STA. E.O.P.		
FED. ROAD DIST. NO.		ILLINOIS FED. AID PROJECT		

- ① 4" YELLOW EPOXY LINE
- ② 4" DOUBLE YELLOW EPOXY LINES
- ③ 4" WHITE EPOXY LINE
- ④ 6" WHITE PREFORMED PLASTIC LINE (30' SKIP/10' DASH)
- ⑤ 8" WHITE EPOXY LINE
- ⑥ 12" WHITE EPOXY LINE
- ⑦ 12" YELLOW EPOXY LINE
- ⑧ 24" WHITE EPOXY LINE
- ⑨ YELLOW EPOXY TURN ARROWS
- ⑩ WHITE EPOXY TURN ARROWS
- ⑪ ONE-WAY CRYSTAL
- ⑫ ONE-WAY AMBER
- ⑬ TWO-WAY AMBER

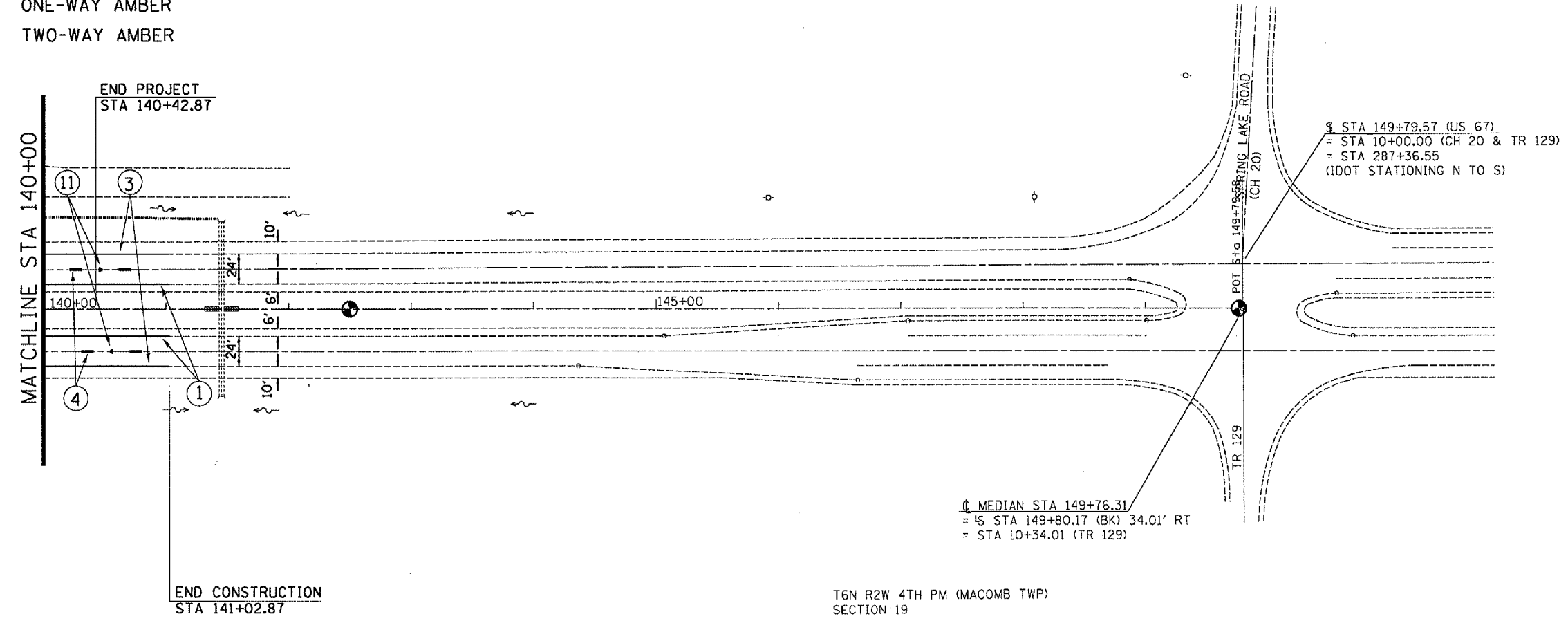

T6N R3W 4TH PM (EMMET TWP)
SECTION 24



☐ MEDIAN STA 149+76.31
= 1/2 STA 149+80.17 (BK) 34.01' RT
= STA 10+34.01 (TR 129)

☐ STA 149+79.57 (US 67)
= STA 10+00.00 (CH 20 & TR 129)
= STA 287+36.55
(IDOT STATIONING N TO S)

T6N R2W 4TH PM (MACOMB TWP)
SECTION 19



PLOT DATE = 3/23/2005
FILE NAME = c:\p\m\meta\68334\sheet.dgn
PLOT SCALE = 1/8"=1'-0"
REFERENCE = NHP

REVISIONS	
NAME	DATE

ILLINOIS DEPARTMENT OF TRANSPORTATION
PROPOSED STRIPING
STA 140+00 - E.O.P.

SCALE: VERT. 1" = 50'
HORIZ. DATE
DRAWN BY CADD
CHECKED BY