

F.A.P. RTE.	SECTION	COUNTY	TOTAL SHEETS	SHEET NO.
662	.	MACOUPIN	74	23
STA.		TO STA.		
FED. ROAD DIST. NO.	ILLINOIS	FED. AID PROJECT		

• 10Z (RS-1); IV, T) R-2; SIRS-4)

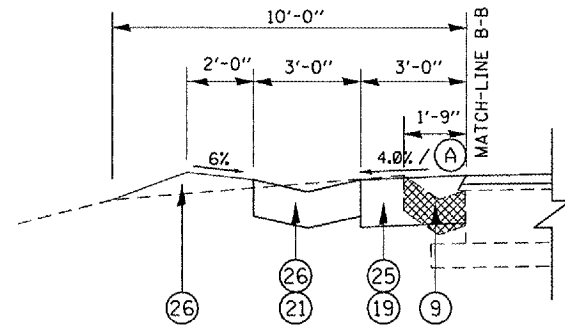

- PART A**
- LT STA 143+00.00 TO LT STA 143+36.00 - PR TY-A GUTTER OUTLET
 - LT STA 143+36.00 TO LT STA 146+99.95
 - LT STA 199+50.00 TO LT STA 200+00.00 - TRANS. 1' BIT. SHLD. TO 3' BIT. SHLD. - NO PR GUTTER
 - LT STA 200+00.00 TO LT STA 200+12.00 - PR TY-A GUTTER INLET
 - LT STA 200+12.00 TO LT STA 202+74.60
 - LT STA 202+74.60 TO LT STA 203+25.00 - PR TY-A GUTTER OUTLET
 - LT STA 204+86.00 TO LT STA 204+98.00 - PR TY-A GUTTER INLET
 - LT STA 204+98.00 TO LT STA 207+58.60
 - LT STA 207+58.60 TO LT STA 208+00.00 - PR TY-A GUTTER OUTLET
 - LT STA 208+00.00 TO LT STA 208+50.00 - TRANS. 3' BIT. SHLD. TO 1' BIT. SHLD. - NO PR GUTTER
 - LT STA 245+06.39 TO LT STA 245+38.00
 - LT STA 245+38.00 TO LT STA 245+50.00 - PR TY-A GUTTER INLET
 - LT STA 245+50.00 TO LT STA 246+00.00 - TRANS. 3' BIT. SHLD. TO 1' BIT. SHLD. - NO PR GUTTER

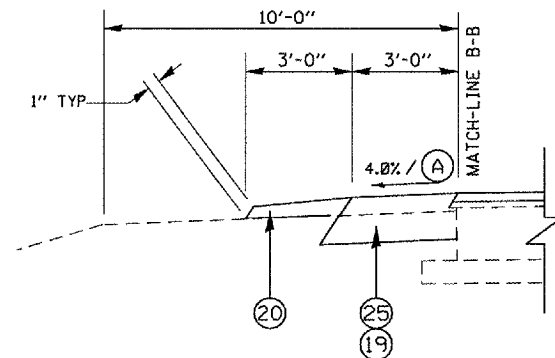

- PART A**
- LT STA 141+14.00 TO LT STA 141+50.00 - EX CONC. GUTTER OUTLET, INLET BOX, GRATES, AND CMP DRAIN PIPES [TBR]
 - LT STA 141+50.00 TO LT STA 142+13.00 - EX TY-A GUTTER ENTR. [TBR]
 - LT STA 142+13.00 TO LT STA 143+00.00 - EX GUTTER [TBR]
 - LT STA 203+25.00 TO LT STA 204+86.00 - EX CONC. GUTTER OUTLET [TBR]
 - RT STA 245+06.39 TO RT STA 245+15.00 - EX CONC. GUTTER ENTRANCE [TBR]
 - RT STA 245+15.00 TO RT STA 245+65.00 - TRANS. 3' BIT. SHLD. TO 1' BIT. SHLD.

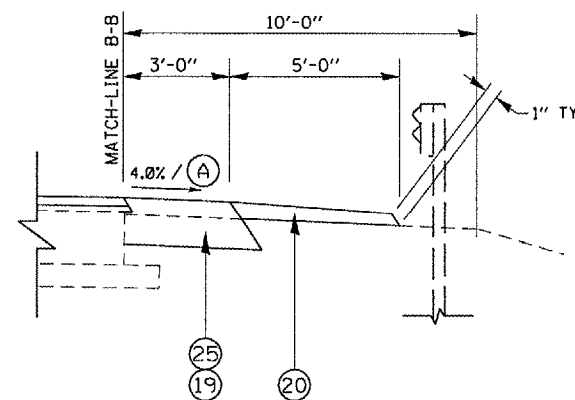

- PART A**
- RT STA 134+00.00 TO RT STA 135+50.00
 - RT STA 135+50.00 TO RT STA 137+50.00 - NO EX GUARDRAIL
 - RT STA 137+50.00 TO RT STA 142+55.00
 - RT STA 142+55.00 TO RT STA 143+05.00 - TRANS. 3' BIT. & 5' AGG. SHLDS. TO 1' BIT. & 3' AGG. SHLD.

NOTE: (A) SHLD. SLOPES FOR S.E. SECTION
 LOW SIDE OF S.E.
 SHLD. SLOPE SHALL BE THE SAME AS THE S.E. RATE BUT NOT LESS THAN 4.0% HIGH SIDE OF S.E.
 HIGH SIDE OF S.E.
 - WHEN S.E. RATE OF THE PAVEMENT IS BETWEEN 0% AND 4.0%, THE SHLD. SLOPE SHALL BE 4.0%
 - WHEN S.E. RATE OF PAVEMENT EXCEEDS 4.0% THE SHLD. SHALL BE SLOPED SO THAT THE ALGEBRAIC DIFFERENCE BETWEEN PAVEMENT AND SHLD. WILL NOT BE GREATER THAN 8.0%

LEGEND

- (1) EX PCC PAVEMENT, 9"
- (2) EX PCC PAVEMENT, 7"-8"-7"
- (3) EX PCC BASE COURSE WIDENING, 8"
- (4) EX PCC BASE COURSE WIDENING, 9"
- (5) EX BITUMINOUS BASE COURSE WIDENING, 8"
- (6) EX PCC BASE COURSE, 8"
- (7) EX BITUMINOUS CONC. SURFACE
- STA 129+96.00 TO STA 131+20.00 - 2 1/2"
- STA 131+20.00 TO STA 265+80.00 - 0"
- STA 265+80.00 TO STA 321+81.00 - 7" ± 1"
- STA 321+81.00 TO STA 349+61.00 - 0"
- STA 349+61.00 TO STA 399+40.00 - 7" ± 2"
- STA 399+40.00 TO STA 478+00.00 - 0"
- (8) EX SUB-BASE GRANULAR MATERIAL
- (9) EX CONCRETE GUTTER, TYPE B (TO BE REMOVED)
- (10) EX STEEL PLATE BEAM GUARDRAIL
- (11) EX COMBINATION CONC. CURB & GUTTER
- (12) PR BIT. SURFACE REMOVAL, VAR. DEPTH
- (13) PR LEVELING BINDER (MACHINE METHOD), SUPERPAVE, 3/4" AVG. (SEE BIT. MIXTURE TABLE)
- (14) PR LEVELING BINDER (MACHINE METHOD), SUPERPAVE, 1" AVG. (SEE BIT. MIXTURE TABLE)
- (15) PR LEVELING BINDER (MACHINE METHOD) SUPERPAVE, VAR. DEPTH (1/2" MIN) (SEE BIT. MIXTURE TABLE)
- (16) PR BIT. CONCRETE SURFACE COURSE, SUPERPAVE 1 1/2" (SEE BIT. MIXTURE TABLE)
- (17) PR BIT. SHLDS, SUPERPAVE, 2-1/2" (SEE BIT. MIXTURE TABLE)
- (18) PR BIT. SHLDS, SUPERPAVE, 8" (SEE BIT. MIXTURE TABLE)
- (19) PR BIT. SHLDS, SUPERPAVE, 8" (SEE BIT. MIXTURE TABLE)
- (20) PR AGG. SHLDS., TYPE B
- (21) PR CONC. GUTTER, TY-A (STD 606101)
- (22) PR PREFORMED PLASTIC PAYMENT MARKING, TY-B, LINE - 5"
- (23) PR PAINT PAVEMENT MARKING, LINE - 5"
- (24) PR GRADING AND SHAPING SHOULDERS
- (25) PR EXCAVATING AND GRADING EX SHLD.
- (26) PR EXCAVATING AND GRADING EX SHLD., SPECIAL
- (27) PR EARTH EXCAVATION WIDENING
- (28) PR EARTH EMBANKMENT
- (29) PR BIT. BASE COURSE WIDENING, SUPERPAVE, 10" (SEE BIT. MIXTURE TABLE)

REVISIONS		ILLINOIS DEPARTMENT OF TRANSPORTATION
NAME	DATE	
		PART A TYPICAL SECTIONS

SCALE: VERT. HORIZ. DATE 04-07-03 DRAWN BY MAW CHECKED BY