

FILE NO.	SECTION	COUNTY	TOTAL SHEETS	SHEET NO.
7989	*	SAGAMON	61	46
STA.	TO STA.			
EXISTING CONDITIONS:				
* D-6 RESURFACING 2005-1				
CONTRACT NO. 72790				

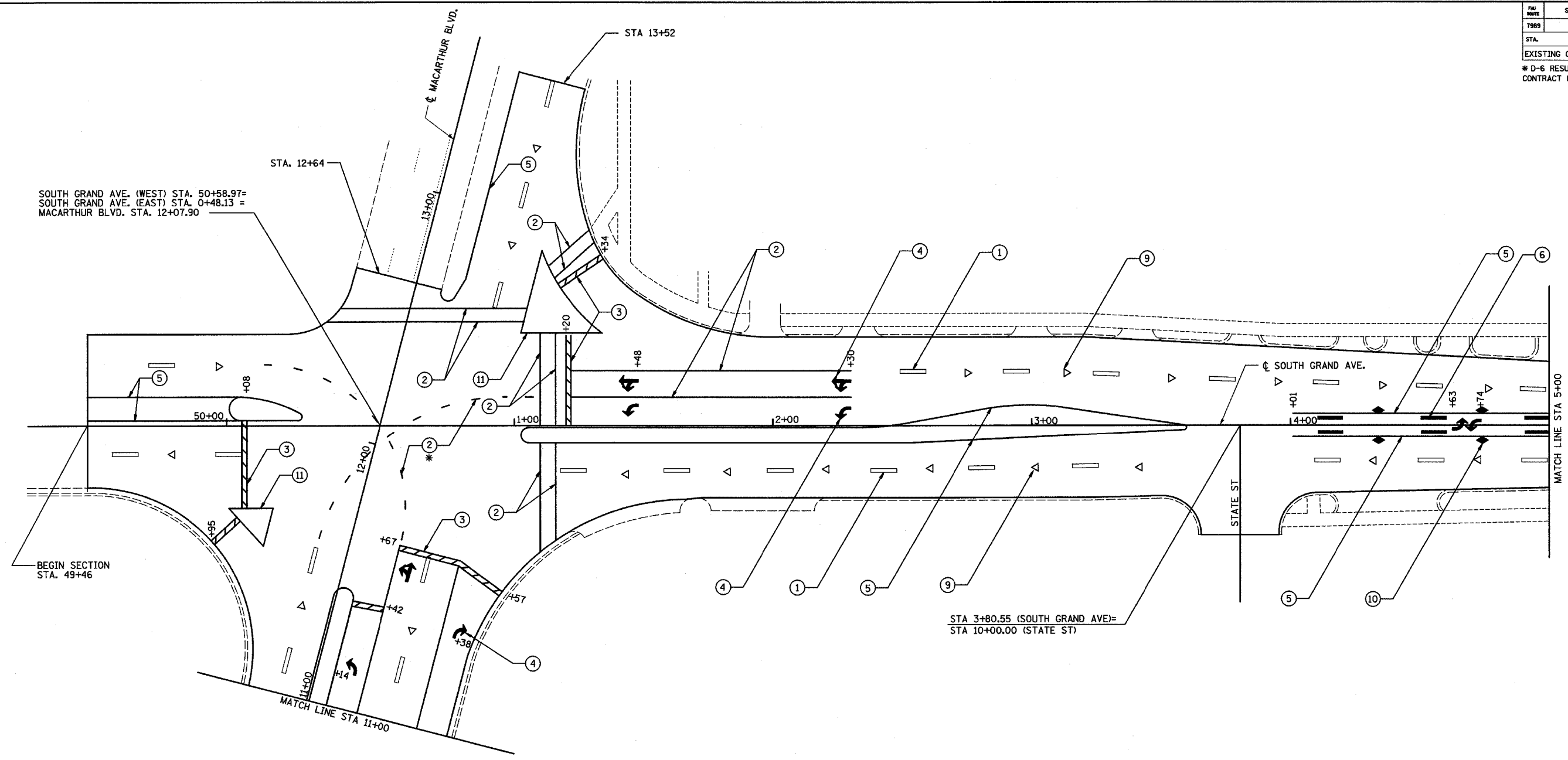

PLAN	DATE
BY	
CHECKED	
NO.	



* DASHED EXTENSION 2' ON/ 4' OFF

- LEGEND**
- ① PREFORMED PLASTIC PAVEMENT MARKING LINE, TYPE B - 5" WHITE SKIP DASH 10' ON/30' OFF
 - ② PREFORMED PLASTIC PAVEMENT MARKING LINE, TYPE B - 6" WHITE LINE
 - ③ PREFORMED PLASTIC PAVEMENT MARKING LINE, TYPE B - 24" WHITE STOP BAR
 - ④ PREFORMED PLASTIC PAVEMENT MARKING, TYPE B - LETTERS AND SYMBOLS
 - ⑤ THERMOPLASTIC PAVEMENT MARKING LINE - 5" YELLOW LINE
 - ⑥ THERMOPLASTIC PAVEMENT MARKING LINE - 5" YELLOW SKIP DASH 10' ON/30' OFF
 - ⑦ PREFORMED PLASTIC PAVEMENT MARKING LINE, TYPE B - 5" DOUBLE YELLOW LANE LINE
 - ⑧ PREFORMED PLASTIC PAVEMENT MARKING LINE, TYPE B - 12" YELLOW DIAGONAL @ 45°, 20' C-C
 - ⑨ RAISED REFLECTIVE PAVEMENT MARKERS - 1 WAY CRYSTAL
 - ⑩ RAISED REFLECTIVE PAVEMENT MARKERS - 2 WAY AMBER
 - ⑪ PREFORMED PLASTIC PAVEMENT MARKING LINE, TYPE B - 8" WHITE LINE
 - ⑫ THERMOPLASTIC PAVEMENT MARKING LINE - 12" WHITE LINE

HOMER L. CHASTAIN & ASSOCIATES, LLP
 CONSULTING ENGINEERS
 DECATUR (317) 422-8544
 CHICAGO (773) 714-0050
 184-001397

REVISIONS	
NAME	DATE

ILLINOIS DEPARTMENT OF TRANSPORTATION
 FAU ROUTE 8012
 MACARTHUR BLVD.
 FAU ROUTE 7989
 SOUTH GRAND AVE.
 SECTION D-6 RESURFACING 2005-1
 SANGAMON COUNTY
PAVEMENT MARKING PLAN
 DRAWN BY: WJW CHECKED BY: GLF