

F.A.P. RTE.	SECTION	COUNTY	TOTAL SHEETS	SHEET NO.
502	.	ADAMS	315	38
STA.	TO STA.			
FED. ROAD DIST. NO.	ILLINOIS	FED. AID PROJECT		
• (53RS-7, PIRS-2)JN, TS				
CONTRACT NO. 72897				

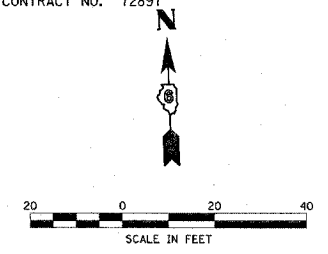

J.M. HUBER CORPORATION

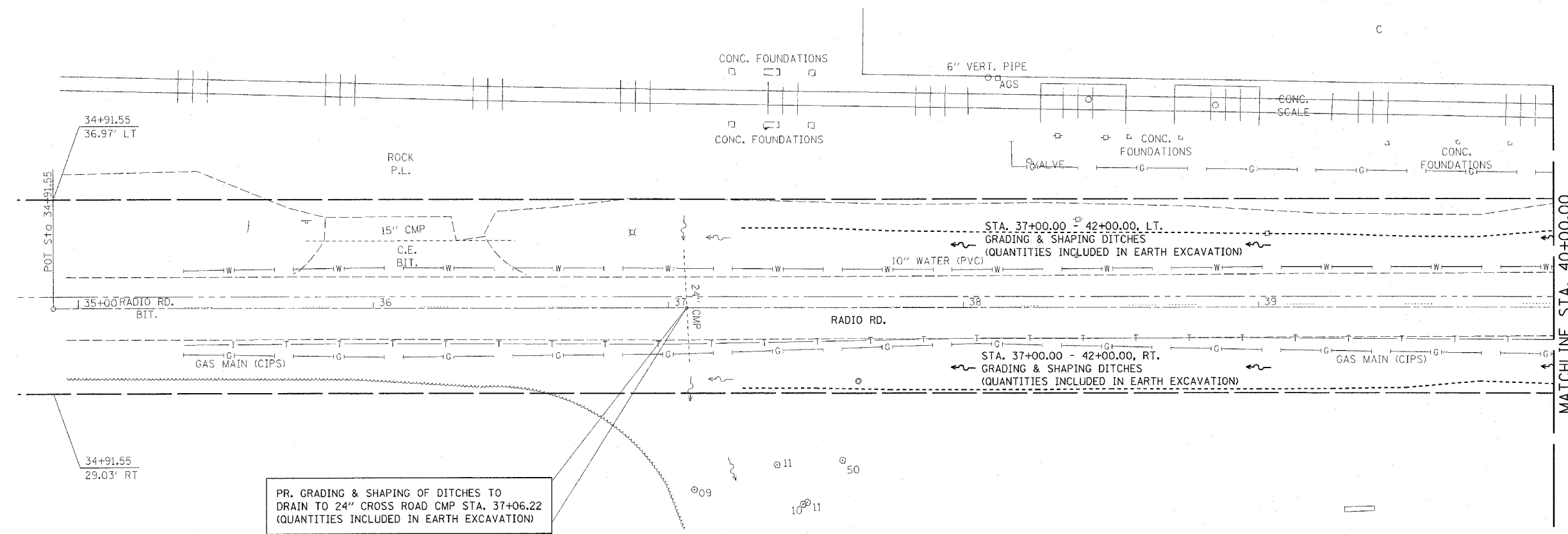

PR. GRADING & SHAPING OF DITCHES TO DRAIN TO 24\"/>

SEE DRAINAGE P&Ps FOR DRAINAGE INFORMATION

J.M. HUBER CORPORATION

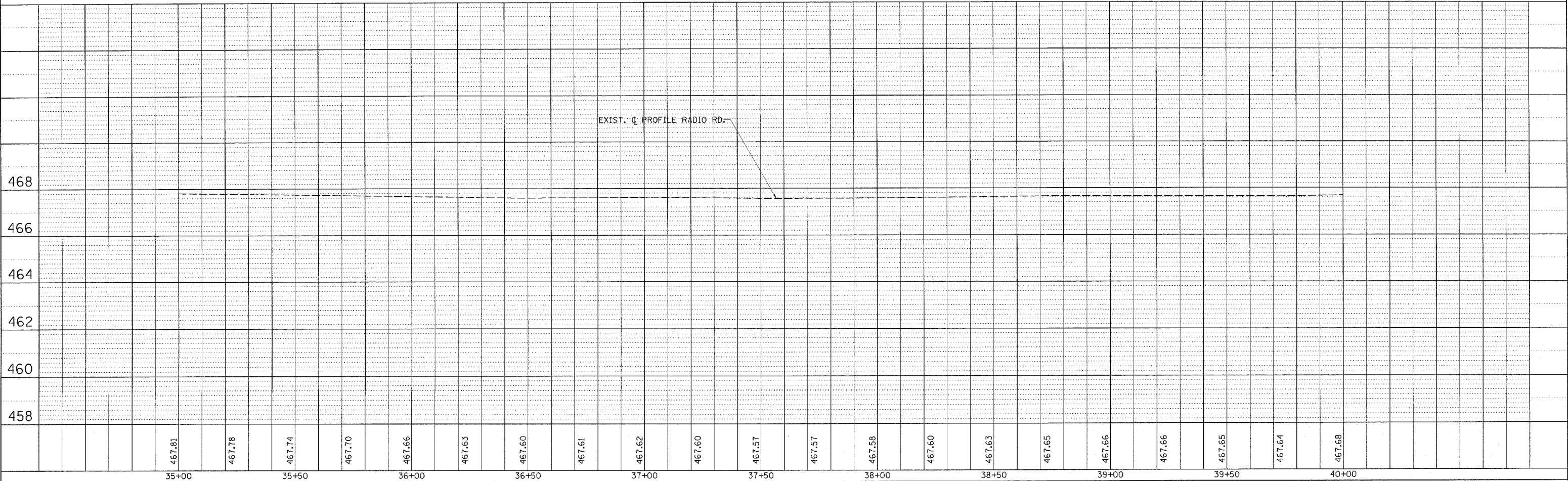

467.81	467.78	467.74	467.70	467.66	467.63	467.60	467.61	467.62	467.60	467.57	467.57	467.58	467.60	467.63	467.65	467.66	467.66	467.65	467.64	467.68
35+00	35+50	36+00	36+50	37+00	37+50	38+00	38+50	39+00	39+50	40+00										

PLAN
 SURVEYED
 ALIGNMENT CHECKED
 NOTE BOOK
 NO. _____

PROFILE
 SURVEYED
 GRADES CHECKED
 NOTE BOOK
 NO. _____

* DGN-SPEC *
 * DATE-TIME *
 * REF 01