

F.A.P. RTE.	SECTION	COUNTY	TOTAL SHEETS	SHEET NO.
502		ADAMS	315	65
STA.	TO STA.			
FED. ROAD DIST. NO.	ILLINOIS	FED. AID PROJECT		

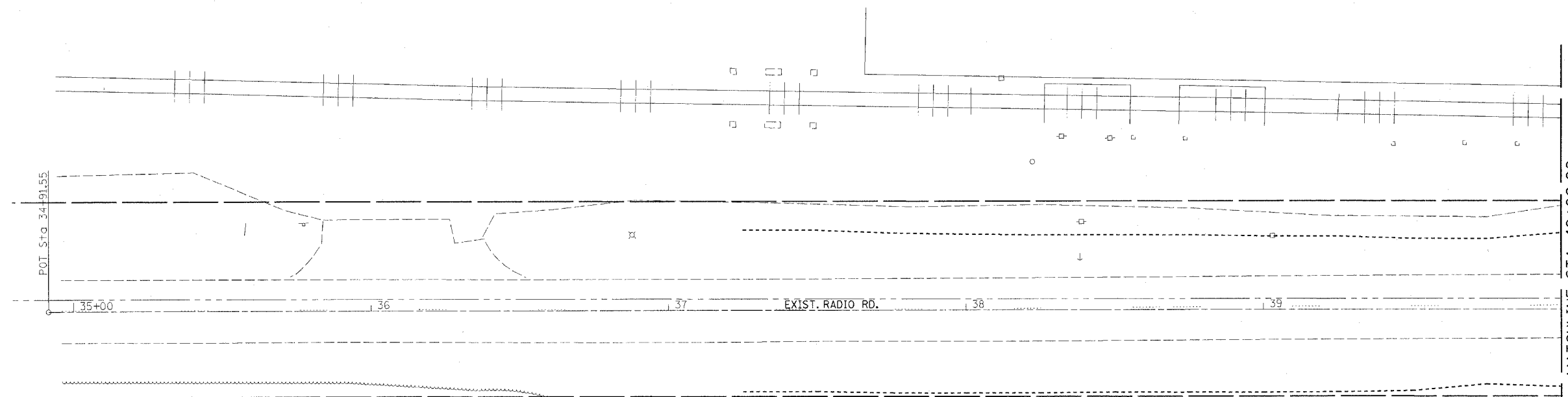

- | | |
|--|--|
| ① POLYUREA PAVEMENT MARKING SPECIAL - LETTERS AND SYMBOLS | ⑦ POLYUREA PAVEMENT MARKING SPECIAL - LINE 5" SKIP DASH YELLOW |
| ② POLYUREA PAVEMENT MARKING SPECIAL - LINE 5" SOLID WHITE | ⑧ POLYUREA PAVEMENT MARKING SPECIAL - LINE 5" SOLID YELLOW |
| ③ POLYUREA PAVEMENT MARKING SPECIAL - LINE 6" SOLID WHITE | ⑨ POLYUREA PAVEMENT MARKING SPECIAL - LINE 6" SOLID YELLOW |
| ④ POLYUREA PAVEMENT MARKING SPECIAL - LINE 8" SOLID WHITE | ⑩ POLYUREA PAVEMENT MARKING SPECIAL - LINE 8" SOLID YELLOW |
| ⑤ POLYUREA PAVEMENT MARKING SPECIAL - LINE 12" SOLID WHITE | ⑪ RAISED REFLECTIVE PAVEMENT MARKERS - 1 WAY - AMBER |
| ⑥ POLYUREA PAVEMENT MARKING SPECIAL - LINE 24" SOLID WHITE | ⑫ RAISED REFLECTIVE PAVEMENT MARKERS - 2 WAY - AMBER |

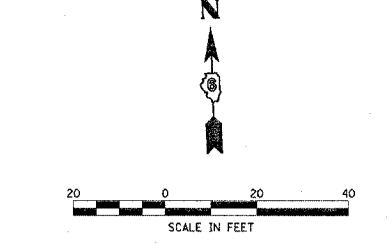
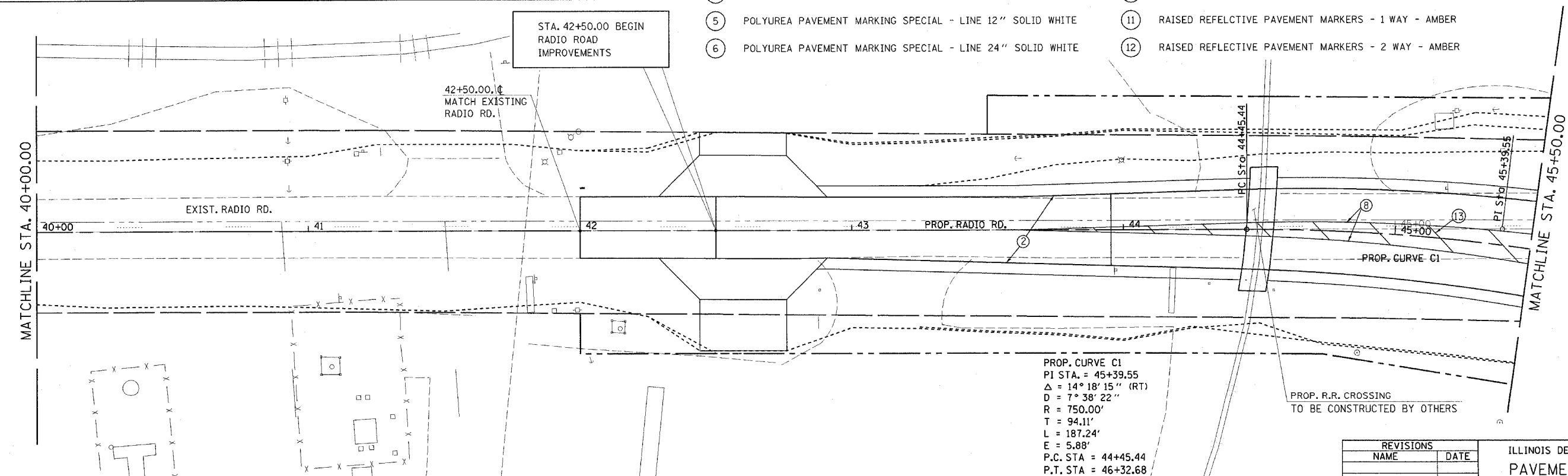

PROP. CURVE C1
 PI STA. = 45+39.55
 $\Delta = 14^\circ 18' 15''$ (RT)
 $D = 7^\circ 38' 22''$
 $R = 750.00'$
 $T = 94.11'$
 $L = 187.24'$
 $E = 5.88'$
 P.C. STA = 44+45.44
 P.T. STA = 46+32.68

REVISIONS	
NAME	DATE

ILLINOIS DEPARTMENT OF TRANSPORTATION
PAVEMENT MARKING DETAILS
 FAP 502 (IL 57) & RADIO ROAD
 SEC. [53RS-7, PIRS-2]N, TS
 ADAMS COUNTY
 QUINCY, IL.

VERT. SCALE: DRAWN BY TMJ
 HORIZ. SCALE: CHECKED BY MEB
 DATE 08-02-04

c:\projects\653004\pavemark.dgn
 2/3/2005
 *REF01