

steffenmk
10/26/2004
c:\projects\74048d\02904pa.dgn

FAP RTL	SECTION	COUNTY	TOTAL SHEETS	SHEET NO.
821		JEFFERSON	11	5
FED. ROAD DIST. NO. 1		SLIDING	FED. AID PROJECT NO.	

CONTRACT NO. 74048
• (13-2)RS-2,13ZRS-3

CURVE DATA
P.I. STA= 537+55.20
 $\Delta = 24^\circ 34' 00.00''$ LT
D= 2° 20' 00.00"
R= 2,455.53
T= 534.64
L= 1,052.86
E= 57.53
S.E.=
P.C. STA= 532+20.56
P.T. STA= 542+73.42

CURVE DATA
P.I. STA= 555+72.53
 $\Delta = 20^\circ 52' 55.00''$ RT
D= 1° 07' 60.00"
R= 5,055.51
T= 931.60
L= 1,842.52
E= 85.12
S.E.=
P.C. STA= 546+40.93
P.T. STA= 564+83.45

PROJECT BEGINS
STA. 543+46

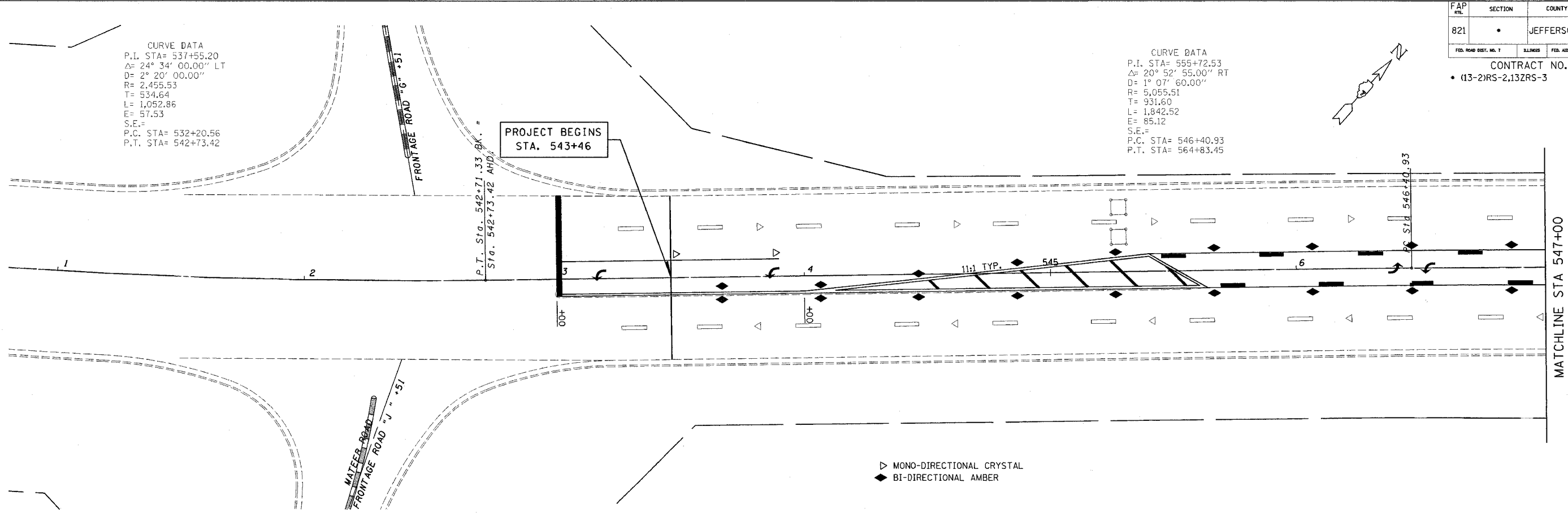

▷ MONO-DIRECTIONAL CRYSTAL
◆ BI-DIRECTIONAL AMBER

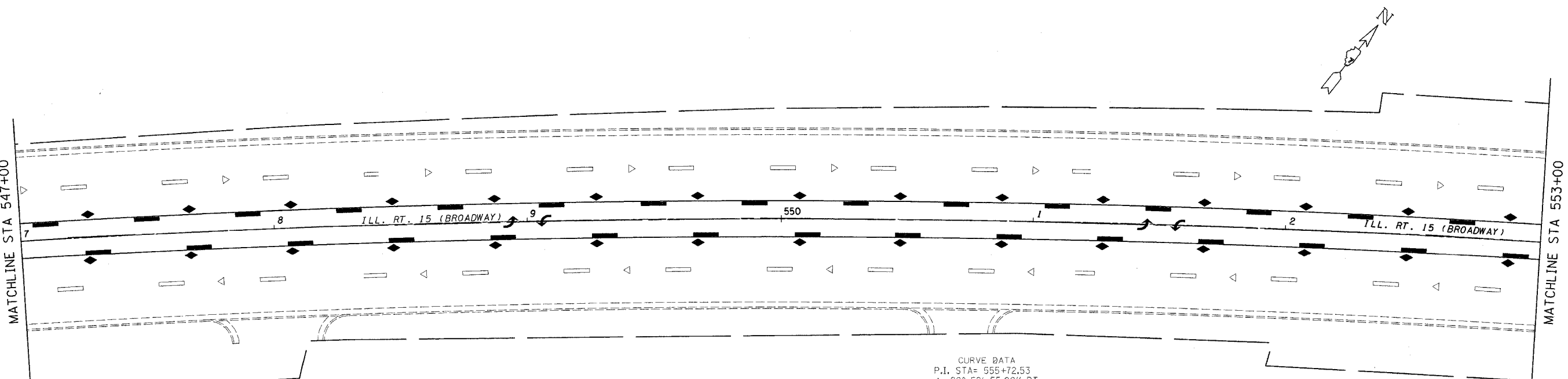

CURVE DATA
P.I. STA= 555+72.53
 $\Delta = 20^\circ 52' 55.00''$ RT
D= 1° 07' 60.00"
R= 5,055.51
T= 931.60
L= 1,842.52
E= 85.12
S.E.=
P.C. STA= 546+40.93
P.T. STA= 564+83.45

REVISIONS	
NAME	DATE

ILLINOIS DEPARTMENT OF TRANSPORTATION
**STA. 543 + 46
TO
STA. 553 + 00**
SCALE: VERT. DRAWN BY
 HORIZ. CHECKED BY
DATE