

76648

FAP ROUTE	SECTION	COUNTY	TOTAL SHEETS	SHEET NO.
789	1T	MADISON	15	1

STATE OF ILLINOIS
DEPARTMENT OF TRANSPORTATION
DIVISION OF HIGHWAYS

D-98-025-03

INDEX OF SHEETS

1	COVER SHEET
2	GENERAL NOTES
3	SUMMARY OF QUANTITIES
4	PLAN AND PROFILE SHEET
5	PLAN VIEW
6	TRAFFIC CONTROL SHEET
7	DETAILS OF PRECAST BOX CULVERTS
8	DETAILS OF CONCRETE COLLAR CULVERT EXTENSIONS
9	BORING LOGS
10-15	CROSS SECTIONS

**PROPOSED
HIGHWAY PLANS**

**FAP ROUTE 789 (IL RTE. 3 /111)
SECTION 1T
CULVERT REPLACEMENT
MADISON COUNTY
C-98-029-03**

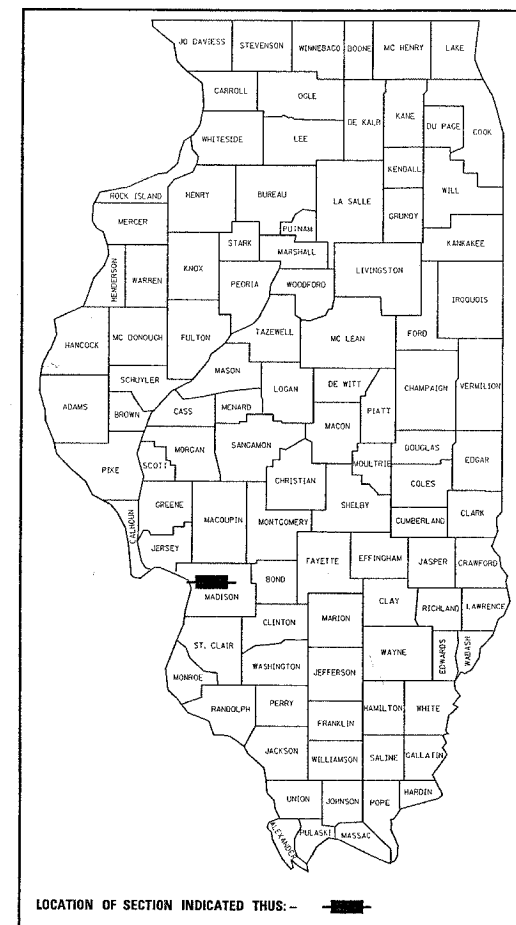

STANDARDS
000001-04
701101-01
701106-01
702001-05
780001-01

MICROFILMED _____
REEL NUMBER _____
AWARDED _____
RESIDENT ENGINEER _____
AS BUILT CHANGES WERE MADE
ON THE FOLLOWING SHEETS

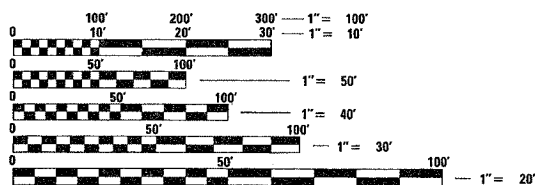

FULL SIZE PLANS HAVE BEEN PREPARED USING STANDARD ENGINEERING SCALES. REDUCED SIZED PLANS WILL NOT CONFORM TO STANDARD SCALES. IN MAKING MEASUREMENTS ON REDUCED PLANS, THE ABOVE SCALES MAY BE USED.

J.U.L.I.E.
JOINT UTILITY LOCATION INFORMATION FOR EXCAVATION
1-800-892-0123



PROJECT LOCATION

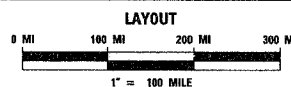
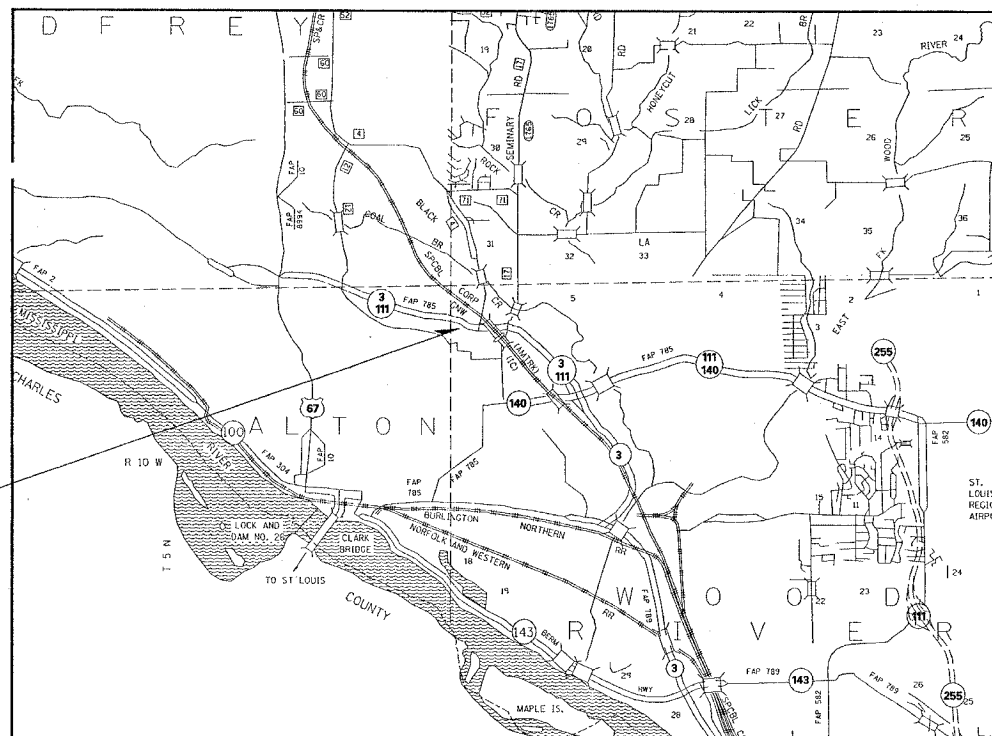

GROSS LENGTH = 546'
NET LENGTH = 486'

ADT	
YEAR	NUMBER
2001	28800
2003	29700
2023	40000
S.U.	4.2%
M.U.	1.4%

STATE OF ILLINOIS
DEPARTMENT OF TRANSPORTATION
DIVISION OF HIGHWAYS

SUBMITTED March 31, 2005
Mary C. Ramo
DEPUTY DIRECTOR OF HIGHWAYS,
REGION FIVE ENGINEER

May 13, 2005
Mike Hine
ENGINEER OF DESIGN AND ENVIRONMENT

May 13, 2005
Peter Moders
DIRECTOR, DIVISION OF HIGHWAYS

**PRINTED BY THE AUTHORITY
OF THE STATE OF ILLINOIS**

PROJECT ENGINEER: WENDA SO ITHERRAND (618) 346-3159
SQUAD LEADER: GREG HANCOCK (618) 346-3195

CONTRACT NO. 76648

FAP ROUTE	SECTION	COUNTY	TOTAL SHEETS	SHEET NO.
789	1T	MADISON	15	2
STA.	TO STA.		CONTRACT NO.: 76648	

GENERAL NOTES:

- THE ASSHTO DESIGNATION IS M 259 FOR ALL PRECAST CONCRETE BOX CULVERTS. THE 10'x8' BOX CULVERT DOES EXCEED APPLICABLE AASHTO SPECIFICATIONS.
- INLET AT STA. 219+07, 110' RT. CANNOT BE LOCATED ON MICROFILM NOR DOES A PERMIT EXIST. UNABLE TO LOCATE POSSIBLE INVERT ELEVATIONS.
- ALL EXISTING CULVERT FLOW LINES, INVERTS, ETC. TAKEN FROM MICROFILM AND VARIATIONS MAY EXIST IN THE FIELD.
- ILLINOIS STATE LAW REQUIRES A 48-HOUR NOTICE TO BE GIVEN TO UTILITIES BEFORE DIGGING. FIELD MARKING OF FACILITIES MAY BE OBTAINED BY CONTACTING J.U.L.I.E. OR FOR NON-MEMBERS, THE UTILITY COMPANY DIRECTLY. AGENCIES KNOWN TO HAVE FACILITIES WITHIN THE PROJECT AREA ARE AS FOLLOWS:
 - AMERITECH (COMMUNICATIONS)
 - AMEREN UE (GAS)
 - AMEREN UE (ELECTRIC)
 - CHARTER COMMUNICATIONS (COMMUNICATIONS)
 - ILLINOIS AMERICAN WATER (WATER)
 - LEVEL 3 COMMUNICATIONS (COMMUNICATIONS)
 - SPRINT COMMUNICATIONS CO. (COMMUNICATIONS)
 - WORLDCOM (COMMUNICATIONS)

(MEMBERS OF J.U.L.I.E. (800) 892-0123 ARE INDICATED BY •. NON-J.U.L.I.E. MEMBERS MUST BE NOTIFIED DIRECTLY.)
- SOIL BORINGS INDICATE THAT SANDSTONE COULD BE DIRECTLY BELOW THE FLOW LINES OF THE PROPOSED STRUCTURE. AN ESTIMATED AMOUNT OF ROCK EXCAVATION HAS BEEN INCLUDED. IF THE PAY ITEM IS NOT NEEDED IT SHALL BE DEDUCTED FROM THE CONTRACT.
- SOME RIPRAP EXISTS ON THE JOB SITE. THE CONTRACTOR SHALL STOCKPILE THE EXISTING RIPRAP REQUIRED TO BE REMOVED FOR EXCAVATING. THE CONTRACTOR SHALL INCORPORATE THE RIPRAP DURING BACKFILLING AS DIRECTED BY THE ENGINEER. THIS WORK SHALL BE INCLUDED IN THE PAY ITEM PRECAST CONCRETE BOX CULVERT AND NO ADDITIONAL COMPENSATION SHALL BE REQUIRED.
- SEVERAL INLETS DRAIN INTO THE EXISTING PIPE CULVERT. THE CONTRACTOR SHALL CONNECT ALL LATERAL PIPES INTO THE PROPOSED BOX CULVERT, INCLUDING COLLARS. THE CONTRACTOR SHALL EXPOSE ALL KNOWN INLET PIPES SO THE RESIDENT ENGINEER CAN DETERMINE A FLOW LINE ELEVATION. THIS WORK SHALL BE INCLUDED IN THE PAY ITEM PRECAST CONCRETE BOX CULVERT AND NO ADDITIONAL COMPENSATION SHALL BE REQUIRED.
- ANY COLLARS REQUIRED TO CONNECT SKEWED CULVERTS SHALL BE PAID FOR ACCORDING TO ARTICLE 109.04.
- THE CONTRACTOR SHALL BE REQUIRED TO DEVELOP THE DESIGN FOR THE TEMPORARY SHEET PILING. THE REQUIREMENTS OF THE DESIGN ARE LISTED IN THE SPECIAL PROVISION TEMPORARY SHEET PILING UNDER THE HEADING GENERAL. AN ESTIMATED AMOUNT IS INCLUDED IN THE PLANS FOR BIDDING AND PAY ITEM PURPOSES.
- A QUANTITY OF 112 FT. OF PAVEMENT MARKING HAS BEEN INCLUDED TO REPAIR EDGE LINES
A QUANTITY OF 36 FT. OF PAVEMENT MARKING HAS BEEN INCLUDED TO REPAIR CROSS WALK
A QUANTITY OF 18 FT. OF PAVEMENT MARKING HAS BEEN INCLUDED TO REPAIR STOP BAR
- A QUANTITY OF 36 FT. OF SHORT-TERM PAVEMENT MARKING HAS BEEN INCLUDED FOR THE CROSS WALK
A QUANTITY OF 36 FT. OF SHORT-TERM PAVEMENT MARKING HAS BEEN INCLUDED FOR THE STOP BAR

MIXTURE REQUIREMENTS - SUPERPAVE PROJECT

MIXTURE USE	PATCHING	SHOULDERS
AC/PG	PG 64-22	PG 58-22
RAP % (MAX)	10%	30%
DESIGN AIR VOIDS	4.0% @ Ndes = 90	2.0% @ Ndes = 30
MIX COMPOSITION (GRADATION MIXTURE)	IL. 19.0	
FRICITION AGG	MIXTURE B	BAM

COMMITMENTS

NONE

REVISIONS	
NAME	DATE

ILLINOIS DEPARTMENT OF TRANSPORTATION
GENERAL NOTES
 FAP ROUTE 789
 SECTION 1T
 MADISON COUNTY
 DRAWN BY:

S:\DATE: 3/30/2005
 c:\projects\789\plan\plan\p1n077.dwg
 REF-

FWP ROUTE	SECTION	COUNTY	TOTAL SHEETS	SHEET NO.
789	1T	MADISON	15	4
STA.	TO STA.			
CONTRACT NO.: 76648				



Exlst. Curve TESTCL1
 PI Sta. 220+69.50
 $\Delta = 36^\circ 25' 12''$ (LT)
 $D = 3^\circ 09' 15''$
 $T = 597.60'$
 $R = 1,816.55'$
 $L = 1,154.68'$
 $E = 95.77'$
 PC Sta. 214+71.90
 PT Sta. 226+26.58

DATE	BY

DATE	BY

LEGEND

- DITCH CHECK
- INLET PROTECTION

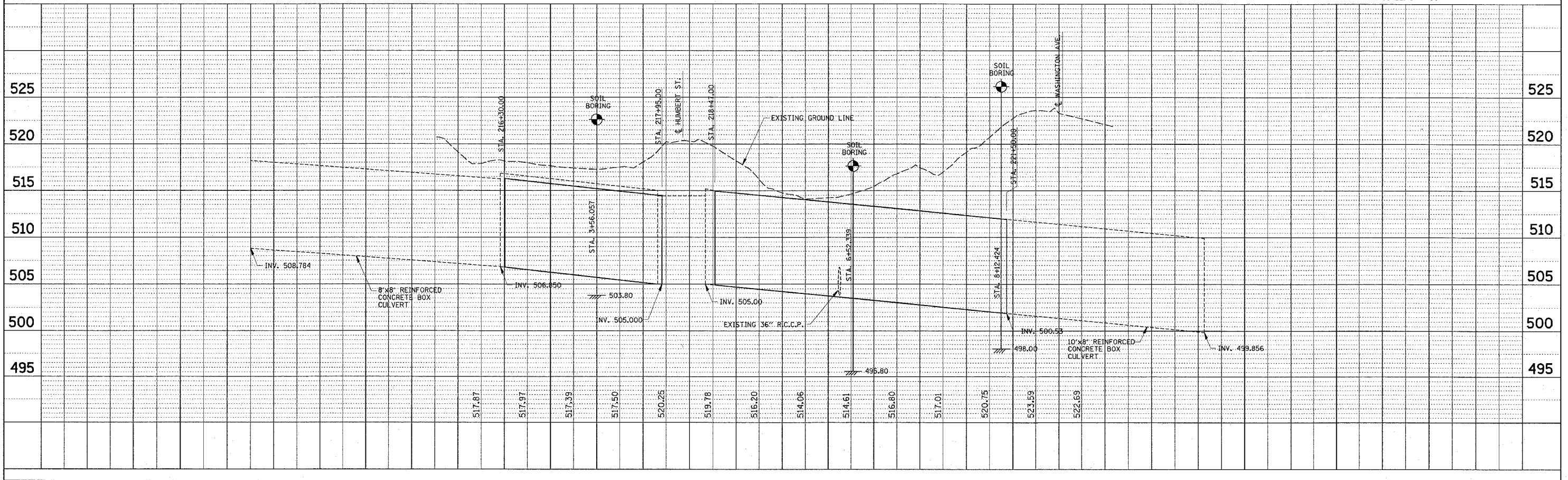
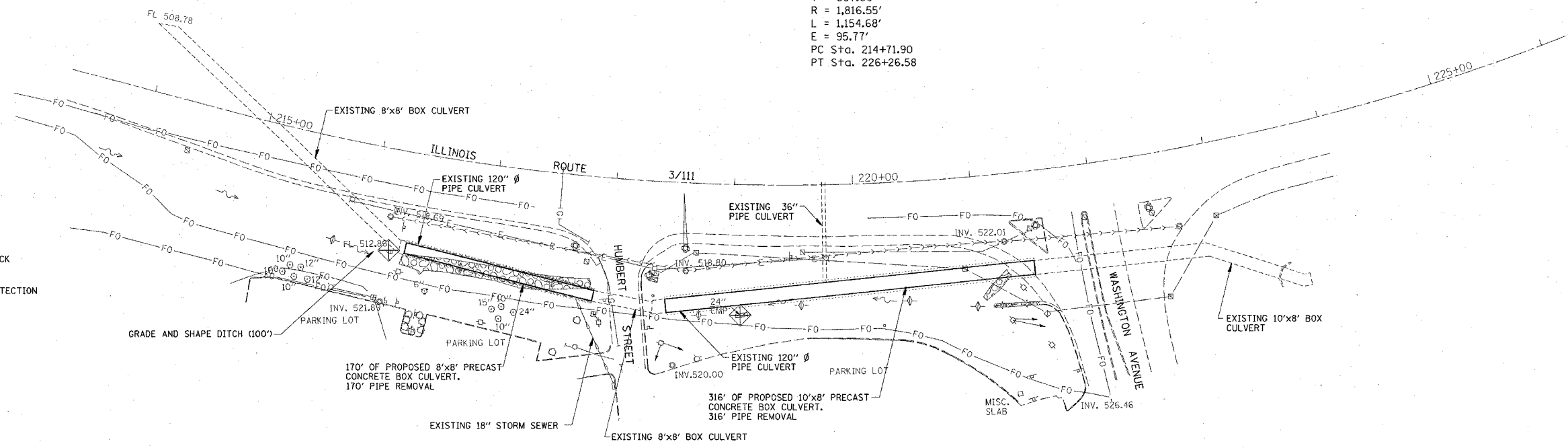



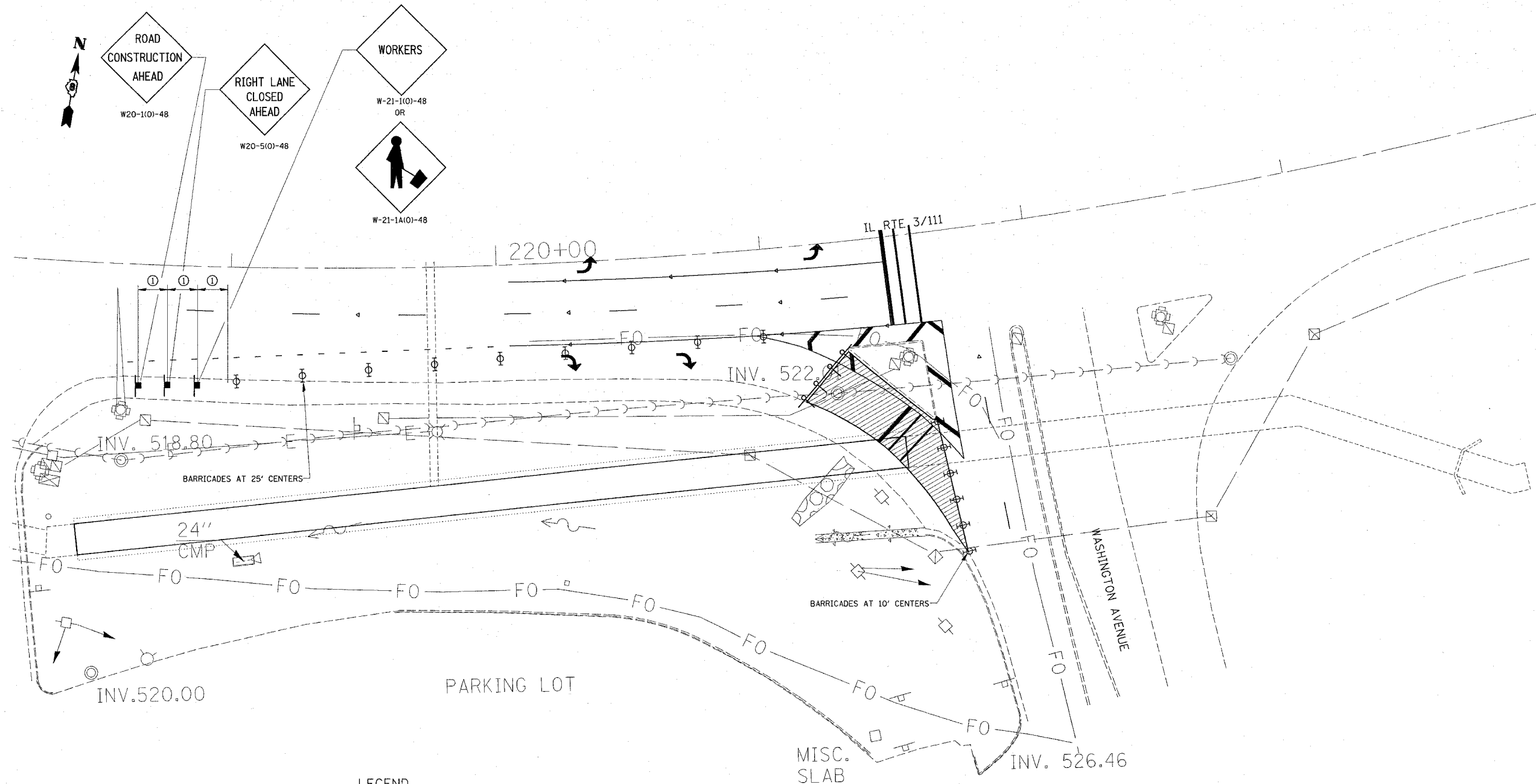

4/24/2005
 3/30/2005
 C:\Projects\ed025023\plan\p1097.dwg
 REF-

FAP ROUTE	SECTION	COUNTY	TOTAL SHEETS	SHEET NO.
789	1T	MADISON	15	6
STA.		TO STA.		CONTRACT NO.: 76648

PLAN	SURVEYED	DATE
NOTE BOOK	PLOTTED	BY
NO.	FILE NAME	

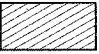

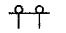
LEGEND

-  WORK AREA
-  SIGN ON PORTABLE OR PERMANENT SUPPORT
-  TYPE III BARRICADE WITH FLASHING LIGHTS
-  TYPE II BARRICADE OR DRUM WITH FLASHING LIGHT

SIGN SPACING	
POSTED SPEED	SIGN SPACING
55	500'
50-45	350'
< 45	200'

① = REFER TO SIGN SPACING TABLE FOR DISTANCES

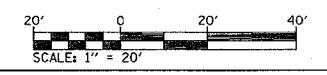

REVISIONS	
NAME	DATE

ILLINOIS DEPARTMENT OF TRANSPORTATION
TRAFFIC CONTROL AND PROTECTION (SPECIAL)
 FAP ROUTE 789
 SECTION 1T
 MADISON COUNTY
 DRAWN BY:

PLOT DATE: 3/30/2005

3/30/05
 3:00 PM
 01/30/05
 REF-
 REF-



Illinois Department of Transportation
Division of Highways
Illinois Department of Transportation

SOIL BORING LOG

Date 11/14/02

ROUTE FAP 789 DESCRIPTION Humbert Street and Washington Street in Alton LOGGED BY Larry Ford

SECTION 1T LOCATION NW 1/4, SEC. 6, TWP. 5N, RNG. 9W, 3 PM
COUNTY Madison DRILLING METHOD Hollow Stem Auger HAMMER TYPE 140# Automatic

STRUCT. NO. Station	D E P T H S	B L O S S	U C I S T	M O I S T	Surface Water Elev. Stream Bed Elev.	ft ft	D E P T H S	B L O S S	U C I S T	M O I S T
BORING NO. 2 Station 221+40 Offset 78.00ft RT CL Ground Surface Elev. 520.97										
Gray and Brown Silty CLAY										
	2									
	2	1.4								
	1	S15	21							
	2									
	4	2.0								
	6	S10	25							
	3									
	5	1.3								
	4	S15	23							
	2									
	1	0.9								
	3	S10	26							
	3	2.2								
	2	S10	19							
Gray Sandy Clay LOAM	2	0.9								
	2	S10	20							
	2									
	2	0.7								
	4	S15	21							
	3									
	1	NC	4							
Brown SAND	1									
	2	0.6								
	2	S10	24							
Gray Clay LOAM	3									

The Unconfined Compressive Strength (UCS) Failure Mode is indicated by (B-Bulge, S-Shear, P-Penetrometer)
The SPT (N value) is the sum of the last two blow values in each sampling zone (AASHTO T208)
BBS, from 137 (Rev. 8-99)



Illinois Department of Transportation
Division of Highways
Illinois Department of Transportation

SOIL BORING LOG

Page 1 of 1

Date 11/14/02

ROUTE FAP 789 DESCRIPTION Humbert Street and Washington Street in Alton LOGGED BY Larry Ford

SECTION 1T LOCATION NW 1/4, SEC. 6, TWP. 5N, RNG. 9W, 3 PM
COUNTY Madison DRILLING METHOD Hollow Stem Auger HAMMER TYPE 140# Automatic

STRUCT. NO. Station	D E P T H S	B L O S S	U C I S T	M O I S T	Surface Water Elev. Stream Bed Elev.	ft ft	D E P T H S	B L O S S	U C I S T	M O I S T
BORING NO. 3 Station 219+85 Offset 81.00ft RT CL Ground Surface Elev. 522.83										
Gray and Brown Silty CLAY										
	3									
	4	1.6								
	5	S15	21							
	4									
	4	1.7								
	5	S15	21							
	4									
	5	2.4								
	7	S15	23							
	3									
	5	1.3								
	6	S10	22							
	5									
	5	1.8								
	5	S10	20							
	2									
	3	1.0								
	2	S10	23							
	1									
	2	1.0								
	2	S15	23							
	3									

The Unconfined Compressive Strength (UCS) Failure Mode is indicated by (B-Bulge, S-Shear, P-Penetrometer)
The SPT (N value) is the sum of the last two blow values in each sampling zone (AASHTO T208)
BBS, from 137 (Rev. 8-99)

FAP ROUTE	SECTION	COUNTY	TOTAL SHEETS	SHEET NO
789	1T	MADISON	15	9
STA.		TO STA.		CONTRACT NO.: 76648



Illinois Department of Transportation
Division of Highways
Illinois Department of Transportation

SOIL BORING LOG

Page 1 of 1

Date 11/14/02

ROUTE FAP 789 DESCRIPTION Humbert Street and Washington Street in Alton LOGGED BY Larry Ford

SECTION 1T LOCATION NW 1/4, SEC. 6, TWP. 5N, RNG. 9W, 3 PM
COUNTY Madison DRILLING METHOD Hollow Stem Auger HAMMER TYPE 140# Automatic

STRUCT. NO. Station	D E P T H S	B L O S S	U C I S T	M O I S T	Surface Water Elev. Stream Bed Elev.	ft ft	D E P T H S	B L O S S	U C I S T	M O I S T
BORING NO. 1 Station 117+28 Offset 77.00ft RT CL Ground Surface Elev. 518.34										
Brown Silty CLAY										
	4									
	6	3.5								
	7	S15	18							
	4									
	4	2.9								
	3	S15	23							
	2									
	2	0.6								
	5	S10	16							
Limestone GRAVEL Bedding Material for Pipe Culvert	5									
	6	NC	8							
	2									
	1	0.4								
	1	S10	26							
	3									
	3	1.6								
	505"	S10	18							
	10	NP								
Gray SANDSTONE (Drillable, Hard)	10									
	15									
End of Boring	20									

The Unconfined Compressive Strength (UCS) Failure Mode is indicated by (B-Bulge, S-Shear, P-Penetrometer)
The SPT (N value) is the sum of the last two blow values in each sampling zone (AASHTO T208)
BBS, from 137 (Rev. 8-99)

REVISIONS	
NAME	DATE

ILLINOIS DEPARTMENT OF TRANSPORTATION
SOIL BORING LOGS

FAP ROUTE 789
SECTION 1T
MADISON COUNTY

DRAWN BY:

4404158
 3/30/2005
 c:\projects\789\p1\en\p1a097a.dgn
 REF

F.A. RTE.	SECTION	COUNTY	TOTAL SHEETS	SHEET NO.
789	1T	MADISON	15	12
STA.	TO STA.			
FED. ROAD DIST. NO.	ILLINOIS	FED. AID PROJECT		
CONTRACT NO.: 76648				

60 50 40 30 20 10 0 10 20 30 40 50 60 70 80 90 100 110 120 130 140 150 160 170 180 190 200 210 220 230 240

525 520 515 510

219+00.00

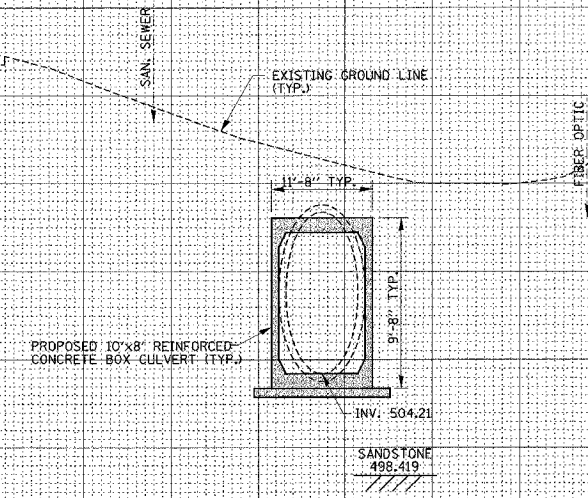

520 515

218+50.00

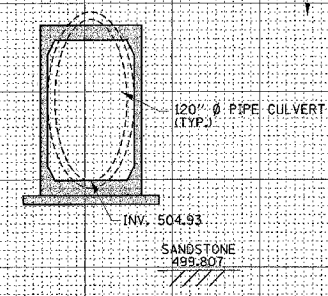

520 515

217+50.00

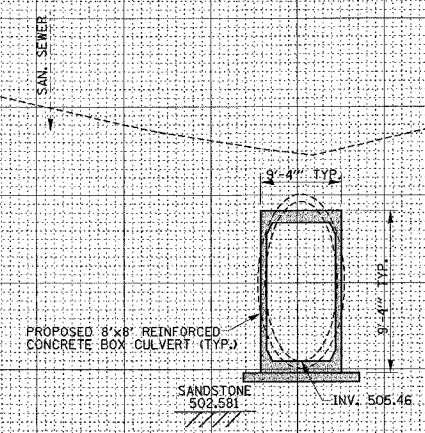

60 50 40 30 20 10 0 10 20 30 40 50 60 70 80 90 100 110 120 130 140 150 160 170 180 190 200 210 220 230 240

DATE _____
BY _____
SURVEYED _____
PLOTTED _____
NOTE BOOK _____
AREAS CHECKED _____
NO. _____

DATE _____
BY _____
SURVEYED _____
PLOTTED _____
NOTE BOOK _____
AREAS CHECKED _____
NO. _____

F.A. RTE.	SECTION	COUNTY	TOTAL SHEETS	SHEET NO.
789	IT	MADISON	15	14
STA.	TO STA.			
FED. ROAD DIST. NO.	ILLINOIS	FED. AID PROJECT		
CONTRACT NO.: 76648				

60 50 40 30 20 10 0 10 20 30 40 50 60 70 80 90 100 110 120 130 140 150 160 170 180 190 200 210 220 230 240

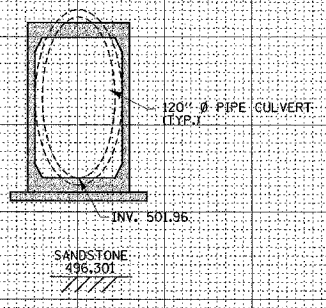
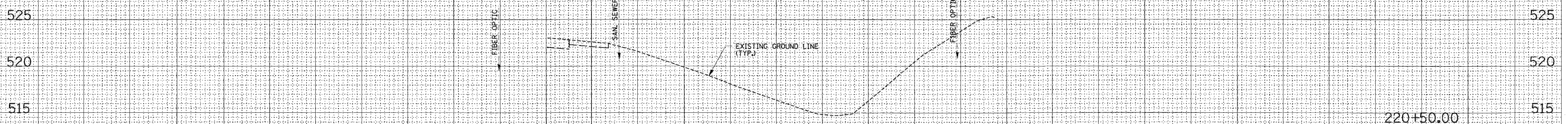
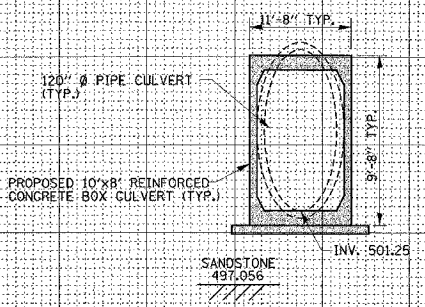
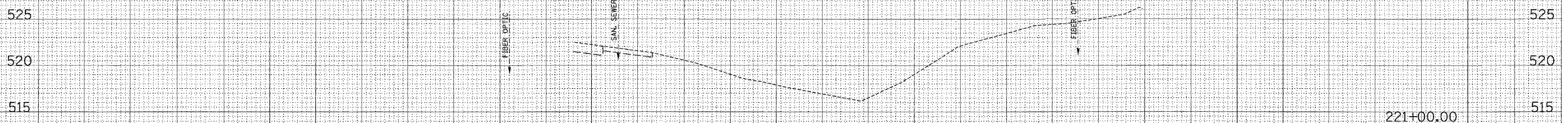

60 50 40 30 20 10 0 10 20 30 40 50 60 70 80 90 100 110 120 130 140 150 160 170 180 190 200 210 220 230 240

FINAL SURVEY BY DATE
 SURVEYED BY DATE
 PLOTTED BY DATE
 NOTE BOOK NO.
 AREAS CHECKED

ORIGINAL SURVEY BY DATE
 SURVEYED BY DATE
 PLOTTED BY DATE
 NOTE BOOK NO.
 AREAS CHECKED

F.A. RTE.	SECTION	COUNTY	TOTAL SHEETS	SHEET NO.
789	1T	MADISON	15	15
STA.	TO STA.			
FED. ROAD DIST. NO.	ILLINOIS	FED. AID PROJECT		
CONTRACT NO.: 76648				

60 50 40 30 20 10 0 10 20 30 40 50 60 70 80 90 100 110 120 130 140 150 160 170 180 190 200 210 220 230 240

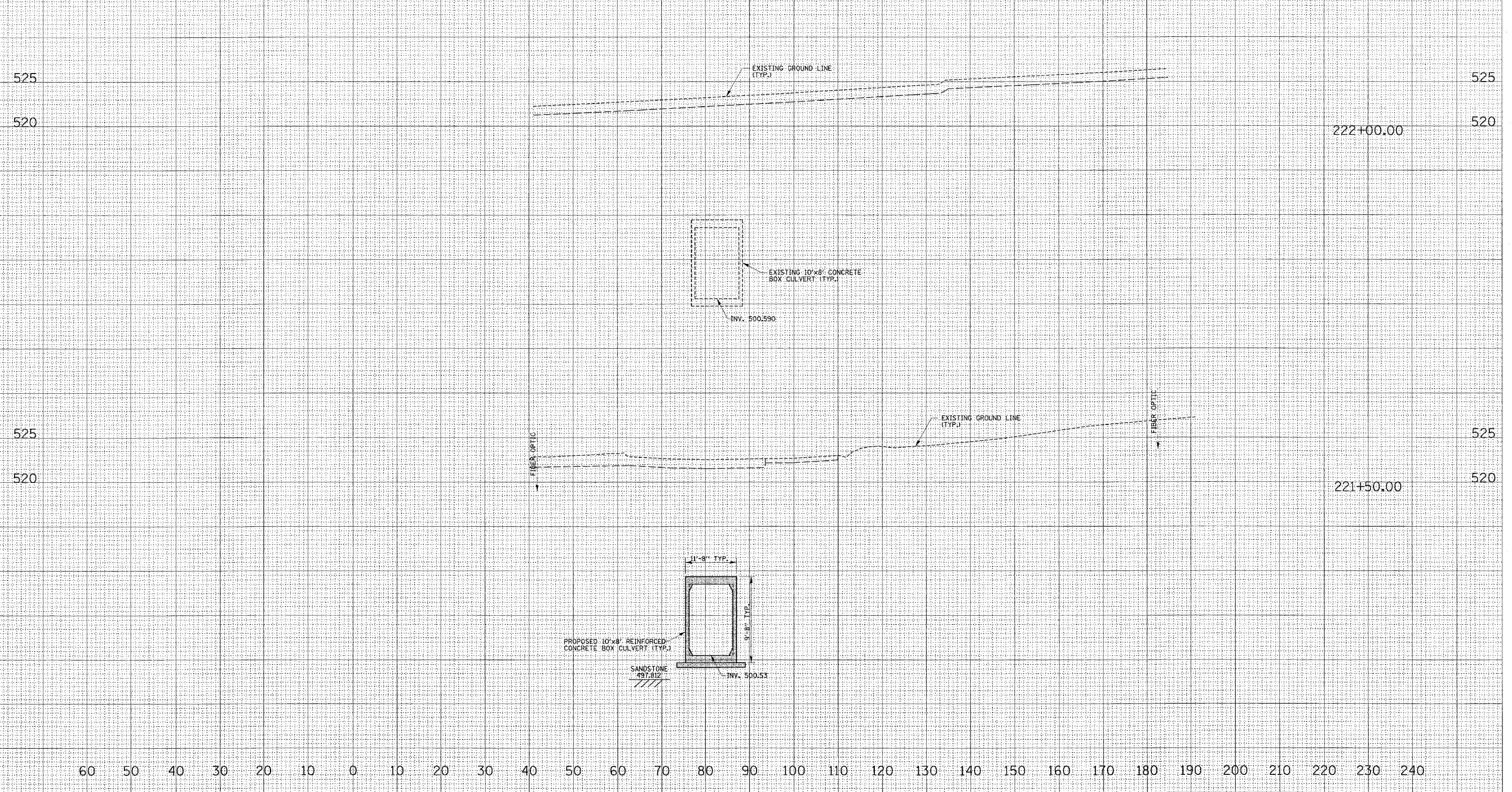

DATE _____
 BY _____
 SURVEYED _____
 TEMPLATE _____
 NOTE BOOK _____
 AREAS CHECKED _____

DATE _____
 BY _____
 SURVEYED _____
 TEMPLATE _____
 NOTE BOOK _____
 AREAS CHECKED _____

60 50 40 30 20 10 0 10 20 30 40 50 60 70 80 90 100 110 120 130 140 150 160 170 180 190 200 210 220 230 240