

76860

FAP ROUTE	SECTION	COUNTY	TOTAL SHEETS	SHEET NO.
785	138BR-2, 138BR-3	BOND	27	1

STATE OF ILLINOIS
DEPARTMENT OF TRANSPORTATION
DIVISION OF HIGHWAYS

**PROPOSED
HIGHWAY PLANS**
FAP ROUTE 785 (IL 140)
SECTION 138BR-2, 138BR-3
PROJECT NO: *BHF-0785(024)*
SUPERSTRUCTURE REPLACEMENT
BOND COUNTY

C-98-028-05

FOR INDEX OF SHEETS, SEE SHEET NO. 2

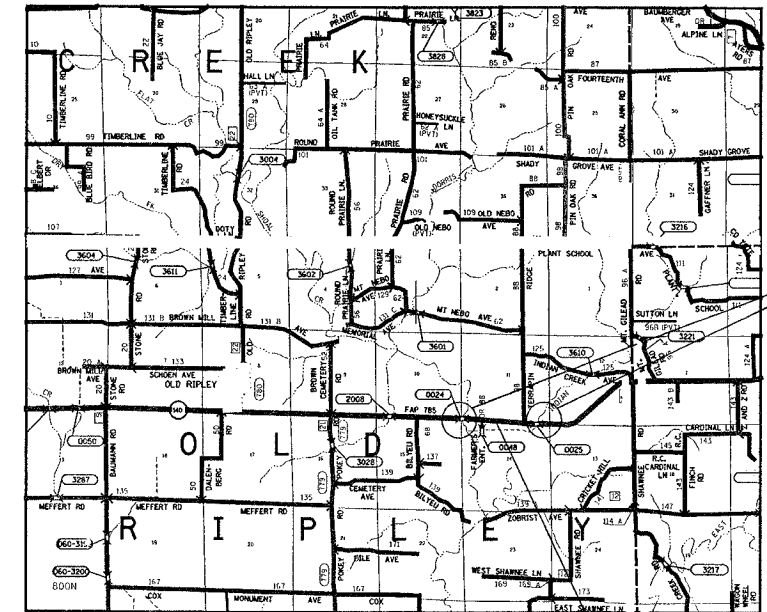
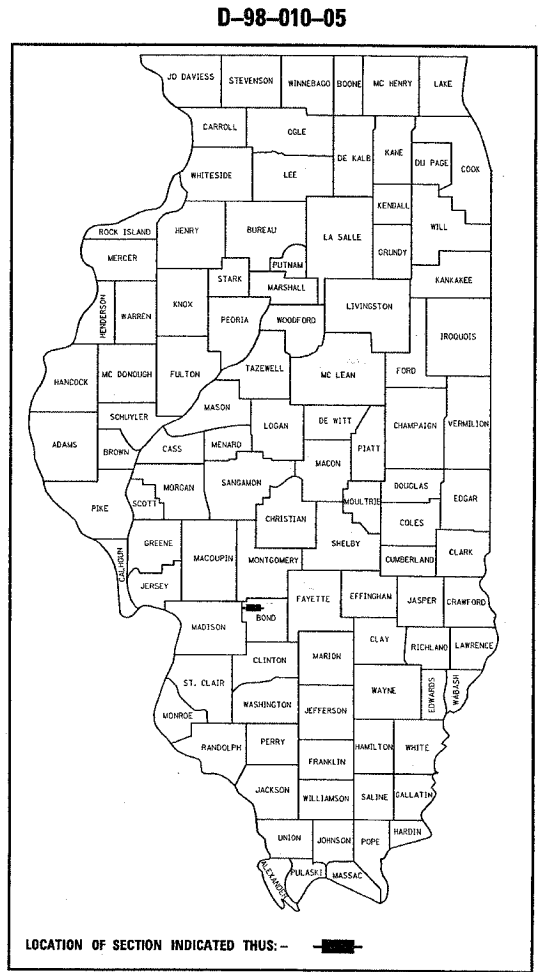

PROJECT LOCATIONS
IL 140 OVER BIG SHOAL CREEK (S.N. 003-0024)
AT STA. 1769+46.50

IL 140 OVER INDIAN CREEK (S.N. 003-0025)
AT STA. 1807+75.00

OMISSION
STA. 1772+90.10 TO
STA. 1807+07.70

GROSS LENGTH OVER BIG SHOAL CREEK = .069 MI.
OVER INDIAN CREEK = .025 MI.

NET LENGTH OVER BIG SHOAL CREEK = .069 MI.
OVER INDIAN CREEK = .025 MI.

STATE OF ILLINOIS
DEPARTMENT OF TRANSPORTATION
DIVISION OF HIGHWAYS

SUBMITTED March 30 20 05

Mary C. Romo
DEPUTY DIRECTOR OF HIGHWAYS
REGION FIVE ENGINEER

May 13, 2005
Mike Hise
ENGINEER OF DESIGN AND ENVIRONMENT

May 13, 2005
Victor Maden
DIRECTOR, DIVISION OF HIGHWAYS

**PRINTED BY THE AUTHORITY
OF THE STATE OF ILLINOIS**

PROJECT ENGINEER: PATTI LeBEAU (618) 345-3179
SQUAD CONTACT: ART MUEHLFELD (618) 366-3209

MICROFILMED _____
AWARDED _____
RESIDENT ENGINEER _____
AS BUILT CHANGES WERE MADE
ON THE FOLLOWING SHEETS _____

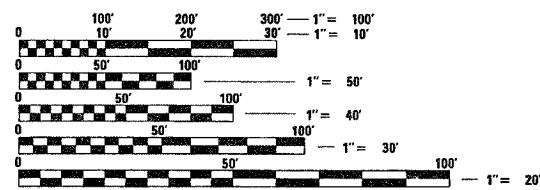

FULL SIZE PLANS HAVE BEEN PREPARED USING STANDARD
ENGINEERING SCALES. REDUCED SIZED PLANS WILL NOT
CONFORM TO STANDARD SCALES. IN MAKING MEASUREMENTS
ON REDUCED PLANS, THE ABOVE SCALES MAY BE USED.

J.U.L.I.E.
JOINT UTILITY LOCATION INFORMATION FOR EXCAVATION
1-800-892-0123

CONTRACT NO. 76860

TRAFFIC DATA
ADT = 1800 (2004)
ADT = 2200 (2024)
SU = 4.7%
MU = 5.0%

LAYOUT

0 MI 1 MI 2 MI 3 MI

1" = 1 MILE

BIG SHOAL		INDIAN	
LATITUDE	Y: 38.88749	LATITUDE	Y: 38.88722
LONGITUDE	X: 89.52240	LONGITUDE	X: 89.50885