

FAP ROUTE	SECTION	COUNTY	TOTAL SHEETS	SHEET NO.
785	138BR-2, 138BR-3	BOND	26	9
STATIONING		CONTRACT NO.: 76860		
STA.	TO STA.			



SIGNS REQUIRED

ILLINOIS 140	(2)							
DETOUR	(2)	IL 140 CLOSED DETOUR VIA IL 160 - US 40 I-70 - IL 127	(1)					
↑	(4)	IL 140 CLOSED DETOUR VIA IL 127 - US 40 I-70 - IL 160	(2)					
↖	(2)	IL 140 WEST CLOSED DETOUR VIA I-70 US 40 IL 160	(1)					
↙	(2)	ROAD CLOSED AHEAD	(5)					
↘	(2)	ROAD CLOSED AHEAD	(5)					
←	(16)	DETOUR AHEAD	(3)					
→	(8)	ROAD CLOSED 9 MI. AHEAD LOCAL TRAFFIC ONLY	(1)					
←	(4)	ROAD CLOSED 4 MI. AHEAD LOCAL TRAFFIC ONLY	(1)					
WEST	(4)							

NOTES

1. ALL SIGNS REQUIRED SHALL BE SUPPLIED TO THE CONTRACTOR BY I.D.O.T. THE CONTRACTOR SHALL FURNISH THE POSTS AND ERECT SIGNS AT THE LOCATIONS SHOWN ON THIS SHEET, AS DIRECTED BY THE R.E./R.T. THE POSTS SHALL REMAIN THE PROPERTY OF THE CONTRACTOR.
2. THE CONTRACTOR SHALL GIVE ILLINOIS DEPARTMENT OF TRANSPORTATION, BUREAU OF OPERATIONS TWO WEEKS NOTICE FOR THE SIGNS. THE CONTRACTOR SHALL PICK UP THE SIGNS AT THE TM BUILDING AT 9601 ST. CLAIR AVE. IN FAIRVIEW HEIGHTS.
3. THE CONTRACTOR SHALL REMOVE AND RETURN THE SIGNS TO THE TM BUILDING IN FAIRVIEW HEIGHTS AFTER THE CONTRACT HAS BEEN COMPLETED.
4. THE ABOVE NOTED WORK SHALL BE PAID FOR AT THE CONTRACT UNIT PRICE, LUMP SUM. FOR DETOUR SIGNING AND NO OTHER COMPENSATION WILL BE ALLOWED.
5. SIGN SPACING WILL BE 400' OR TO FIT FIELD CONDITIONS.
6. THE HEIGHT TO THE BOTTOM OF THE LOWEST SIGN SHALL NOT BE LESS THAN 6'.

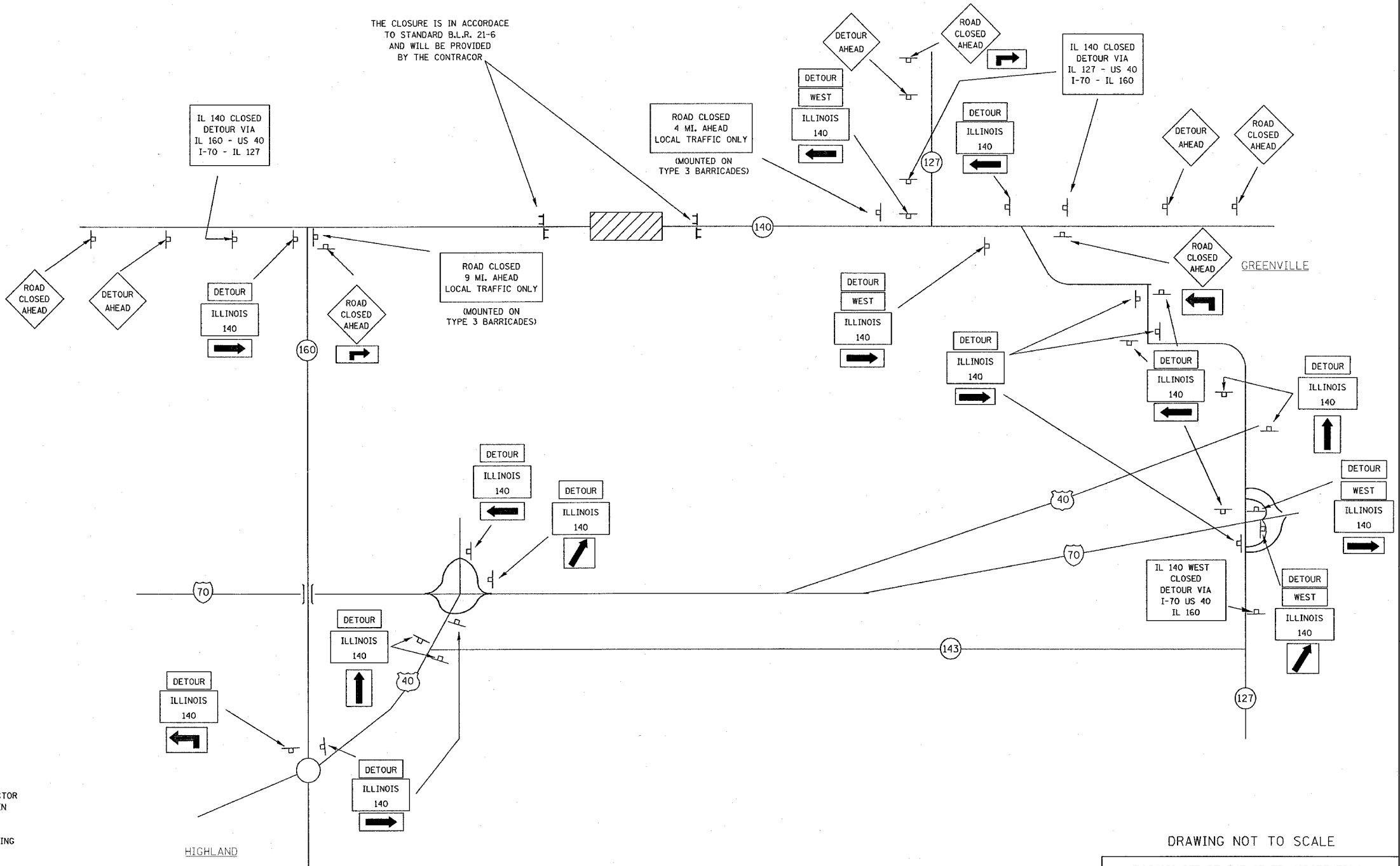

DRAWING NOT TO SCALE

ILLINOIS DEPARTMENT OF TRANSPORTATION

DETOUR SIGNING

FAP ROUTE 785
SECTION 138BR-2, 138BR-3
BOND COUNTY
SN 003-0024
SN 003-0025

REVISIONS	
NAME	DATE

DRAWN BY:

PLOT DATE: *DATE-TIME*

DATE	BY	NO.	NO.	NO.	NO.	NO.

DATE
 JOB
 REF
 REF