

F.A.P. ROUTE	CONTRACT NO.	COUNTY	TOTAL SH.
0126	R3776	McHENRY	77
STATE SECTION		McHENRY	
95-00090-00-EP		77	
CROSS SECTION STA. 209+00			
F.H.W.A. REG.5 ILLINOIS PROJECT M-8003 (3)			

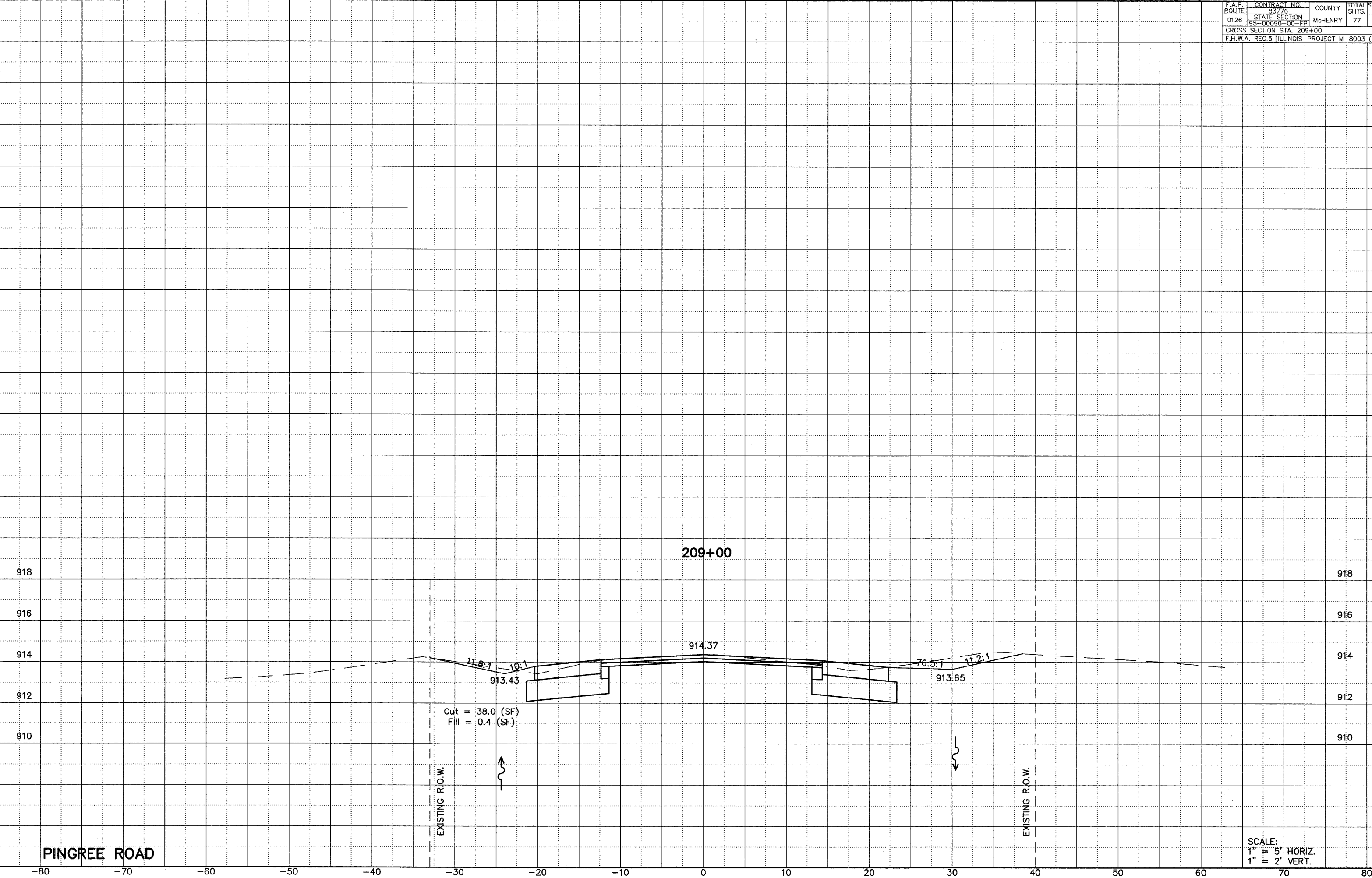

PINGREE ROAD

209+00

Cut = 38.0 (SF)  
Fill = 0.4 (SF)

SCALE:  
1" = 5' HORIZ.  
1" = 2' VERT.