

F.A.U. RTE.	SECTION	COUNTY	TOTAL SHEETS	SHEET NO.
2652	00-00069-00-PV	DUPAGE	146	73
STA. 10+70.70		TO STA. 66+16.00		
FED. ROAD DIST. NO.	ILLINOIS	FED. AID PROJECT		
CONTRACT NO. 83781				

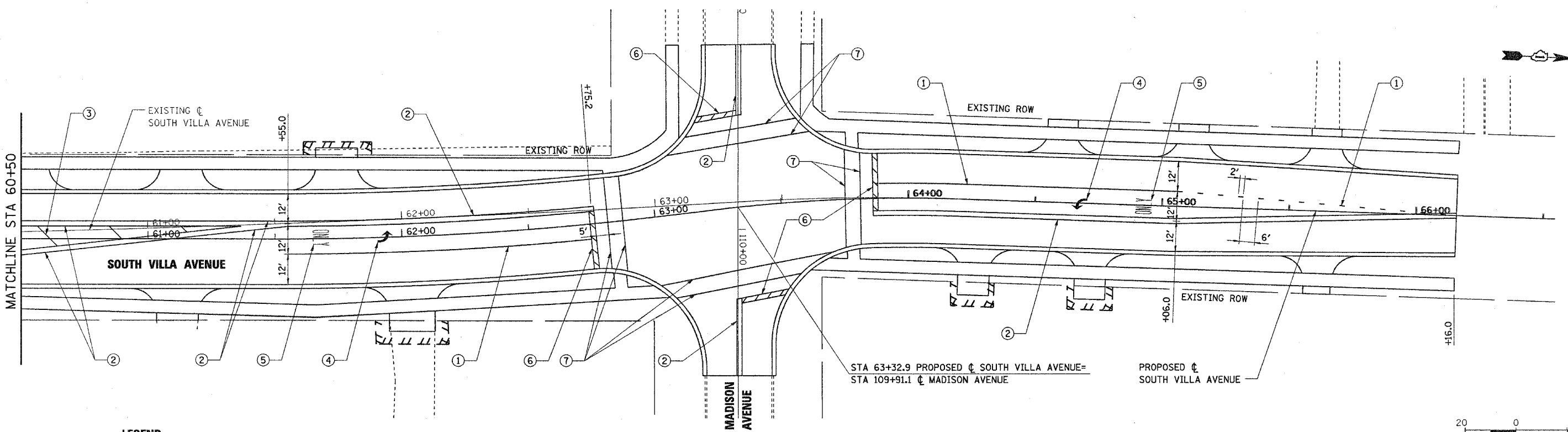

LEGEND:

- | | |
|--|---|
| ① 4" WHITE, POLYUREA PAVEMENT MARKING LINE | ⑤ WHITE, LETTERS, PREFORMED POLYUREA PAVEMENT MARKING |
| ② 4" DOUBLE YELLOW, POLYUREA PAVEMENT MARKING LINE | ⑥ 24" WHITE, POLYUREA PAVEMENT MARKING LINE |
| ③ 12" YELLOW @ 45° SKEW, 30 FT C-C, POLYUREA PAVEMENT MARKING LINE | ⑦ 6" WHITE, POLYUREA PAVEMENT MARKING LINE |
| ④ WHITE, TURN ARROW SYMBOL, PREFORMED POLYUREA PAVEMENT MARKING | ⑧ 4" SINGLE YELLOW, POLYUREA PAVEMENT MARKING LINE |

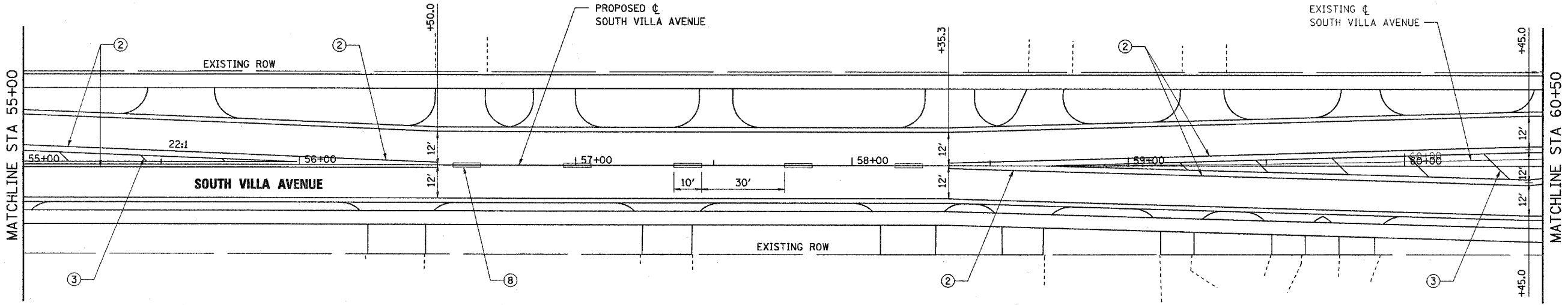
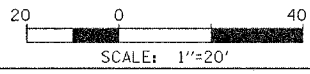

REVISIONS	
NAME	DATE

Stanley Consultants Inc.
 850 West Higgins Road
 Suite 730
 Chicago, Illinois 60639-2808
 Illinois Firm Registration No. 04-00533

VILLAGE OF VILLA PARK, ILLINOIS

**PAVEMENT MARKING
SOUTH VILLA AVENUE
SHEET 5 OF 5**

STA 55+00 TO STA 66+16

SCALE: 1"=20'
DATE: 11-NOV-2004

DRAWN BY: E.D.
CHECKED BY: J.T.G.

PLAN	DATE
BY	
CHECKED	
NO. OF WAY CHECKED	
PAID FILE NAME	

PROFILE	DATE
BY	
CHECKED	
NO. OF WAY CHECKED	
STRUCTURE NOTATIONS CHFD	