

F.A.P. ROUTE	336	COUNTY SECTION	99-00243-00-PV	COUNTY	KANE	TOTALS	268
CONTRACT NO.	83782	PLAN & PROFILE STA.	36+50 TO STA. 41+50	F.H.W.A. REG. 5 ILLINOIS PROJECT F-0336			

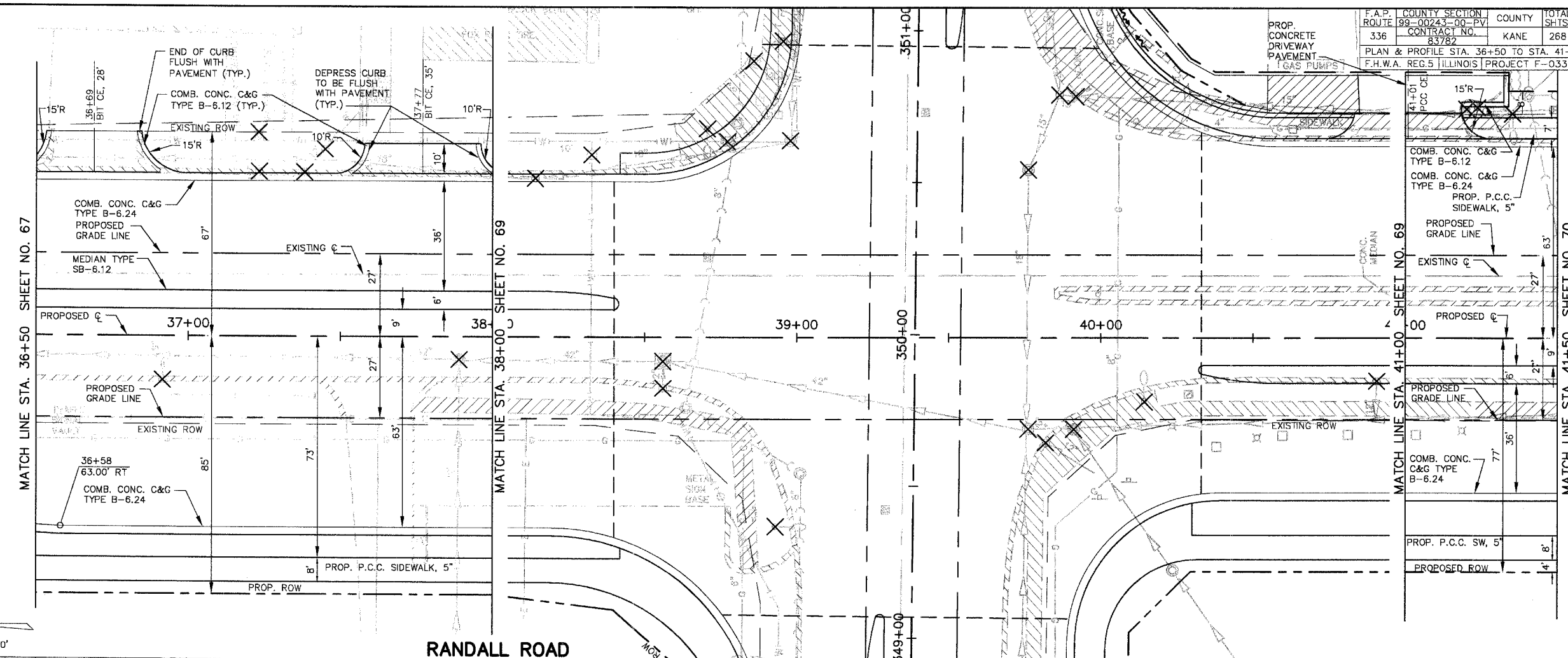

SCALE: 1" = 20'

RANDALL ROAD

