

F.A.P. ROUTE	COUNTY SECTION	COUNTY	TOTAL SHTS.
99-00243-00-PV		KANE	268
336	CONTRACT NO.		
	B3782		
LIGHTING PLAN			
F.H.W.A. REG.5 ILLINOIS PROJECT F-0336(O)			

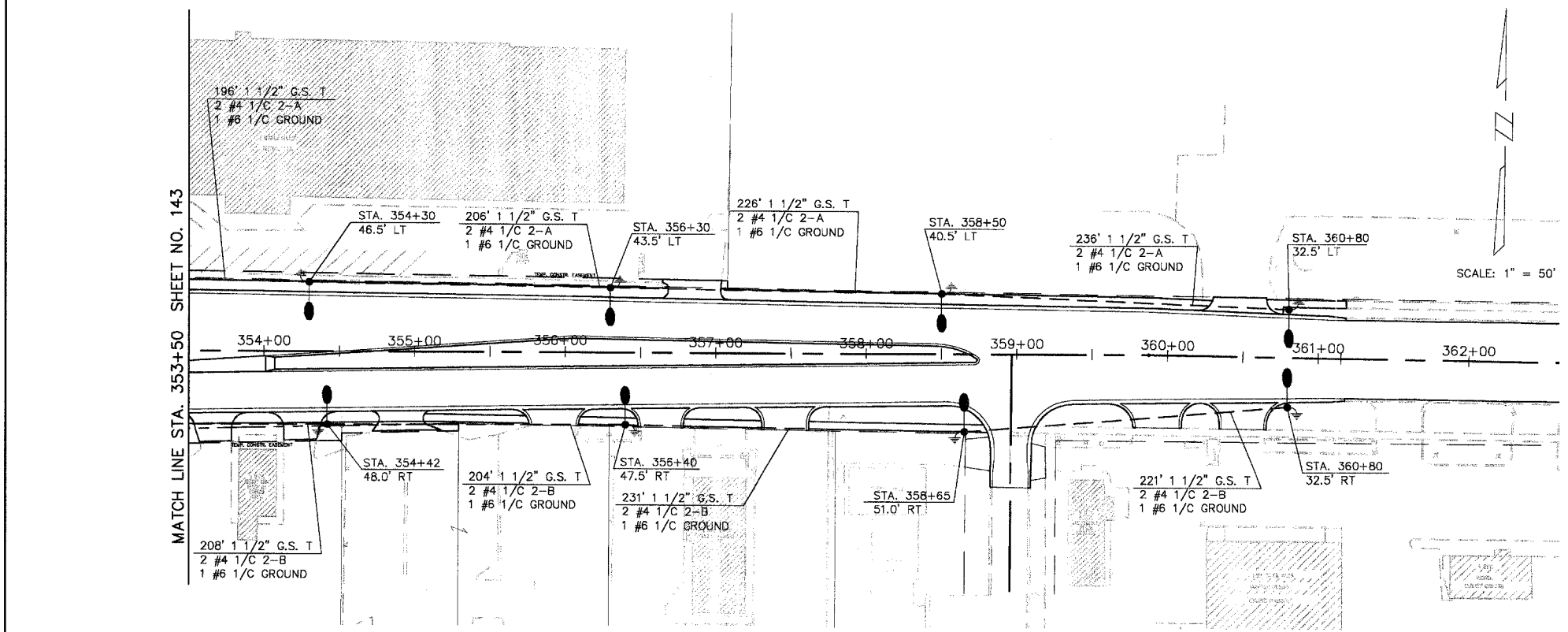
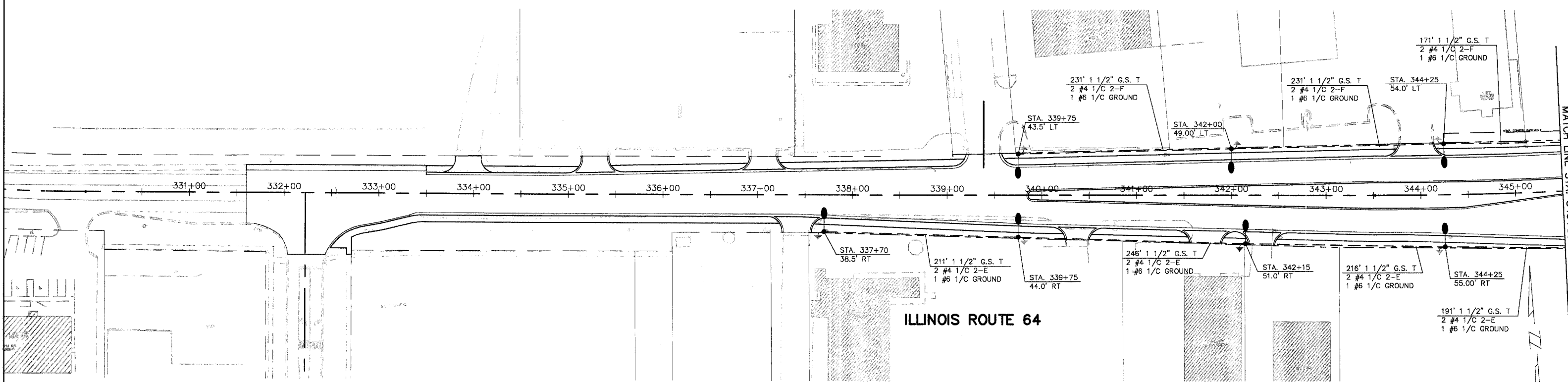

LEGEND

- PROPOSED LIGHT STANDARD WITH 310 WATT LUMINAIRE
- PROPOSED COMBINATION MAST ARM ASSEMBLY AND POLE WITH 400 WATT LUMINAIRE
- PROPOSED COMBINATION MAST ARM ASSEMBLY AND POLE WITH TWO LIGHTING MAST ARMS WITH 400 WATT LUMINAIRES
- PROPOSED LIGHTING CONTROLLER
- PROPOSED HANDHOLE
- GROUND ROD
- PROPOSED GFCI FESTOON OUTLET

GALVANIZED STEEL CONDUIT IN TRENCH (T), IN COMMON TRENCH (CT), EMBEDDED (EM), OR PUSHED (P) OF THE SIZE SPECIFIED WITH THE NUMBER AND SIZE OF CABLES SPECIFIED. CONDUIT LENGTHS INCLUDE 3 FEET OF VERTICAL CONDUIT AT EACH LIGHT STANDARD.

- EXISTING LIGHT STANDARD
- EXISTING LIGHT STANDARD TO BE REMOVED

SCALE: 1" = 50'

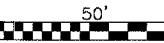

MATCH LINE STA. 353+50 SHEET NO. 143

REVISIONS	
NAME	DATE
PER BEO REVIEW	10-7-04

STREET LIGHTING PLAN

STATION 330+00 TO 360+00

MAIN STREET (ILLINOIS ROUTE 64)

SCALE: AS SHOWN DRAWN BY: JMH
DATE: 5-26-04 CHECKED BY: DAY

Revised 6-8-05