

F.A.P. ROUTE	COUNTY SECTION	COUNTY	TOTAL SHTS.
336	99-00243-00-PV	KANE	268
PROPOSED TYPICAL SECTIONS			
F.H.W.A. REG.5 ILLINOIS PROJECT F-0336(C)			

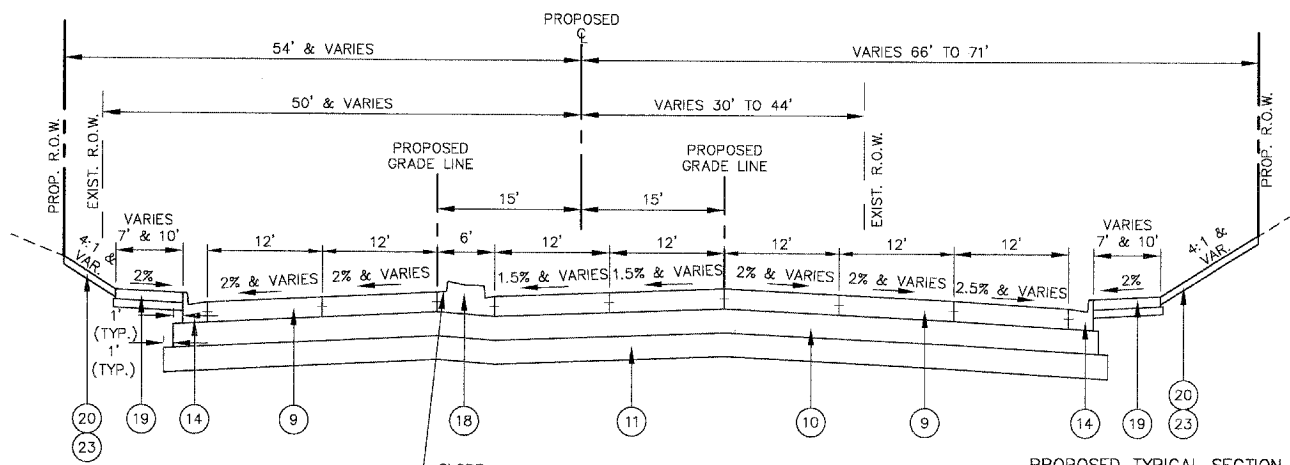

PROPOSED TYPICAL SECTION
 IL RTE. 64
 STA. 347+46 TO STA. 349+07

- PROPOSED TYPICAL SECTION**
 RANDALL ROAD / IL RTE. 64 INTERSECTION
 STA. 349+07 TO STA. 350+95
- (12) HIGH-EARLY-STRENGTH PCC PAVEMENT, 10" (JOINTED)
 SEE SHEET NO. 109 FOR PAVEMENT JOINTS AND ELEVATIONS.
 - (10) AGGREGATE SUBGRADE, 12"
 - (11) POROUS GRANULAR EMBANKMENT, SPECIAL 12" WITH GEOTECHNICAL FABRIC FOR GROUND STABILIZATION

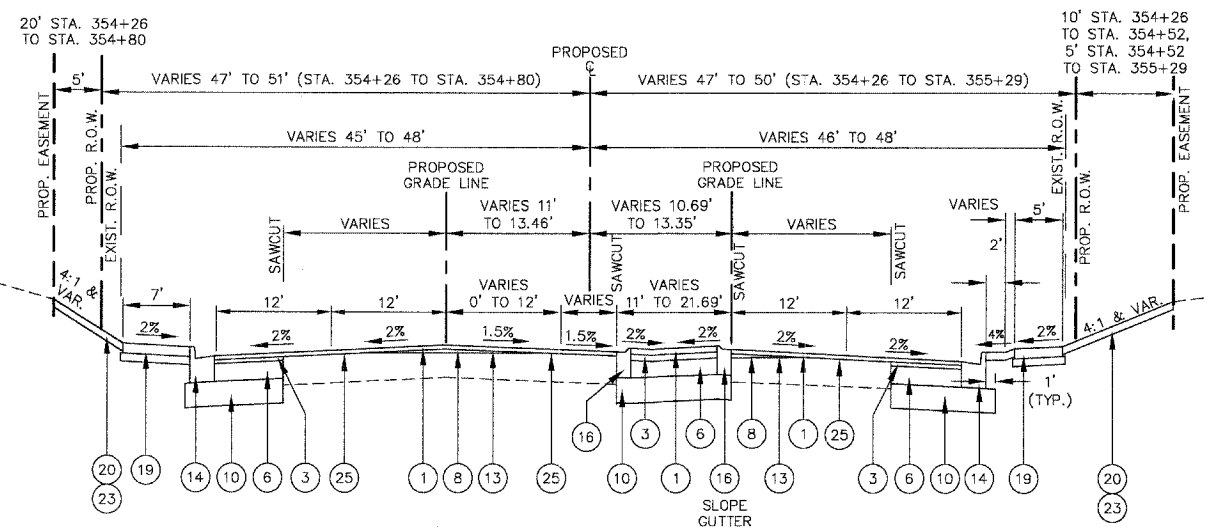

PROPOSED TYPICAL SECTION
 IL RTE. 64
 STA. 354+26 TO STA. 356+05

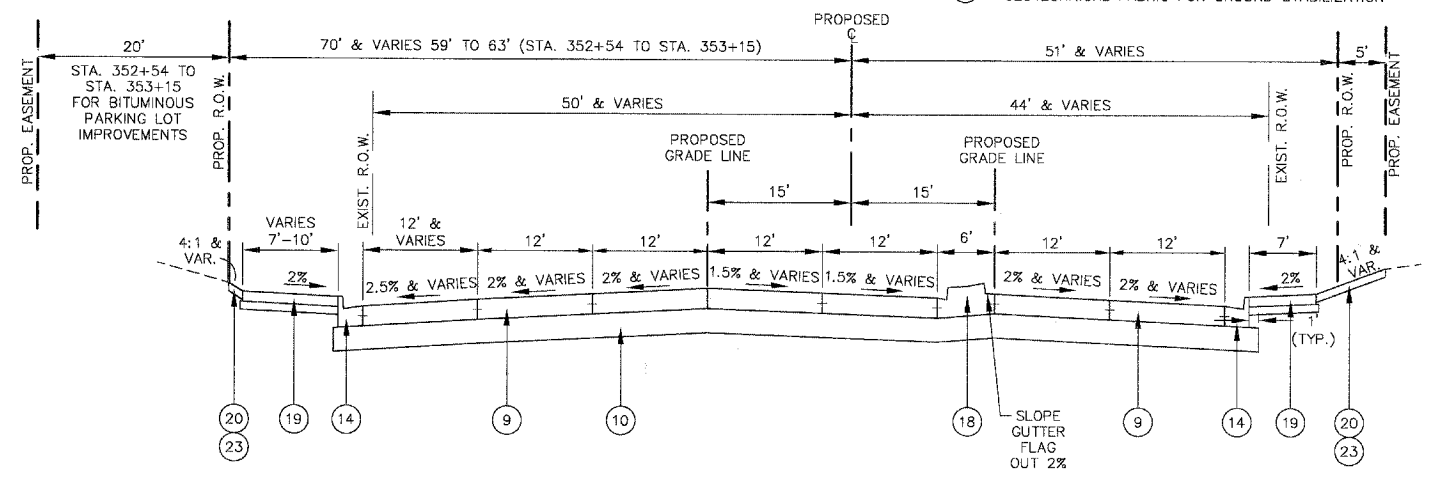

PROPOSED TYPICAL SECTION
 IL RTE. 64
 STA. 350+95 TO STA. 353+15

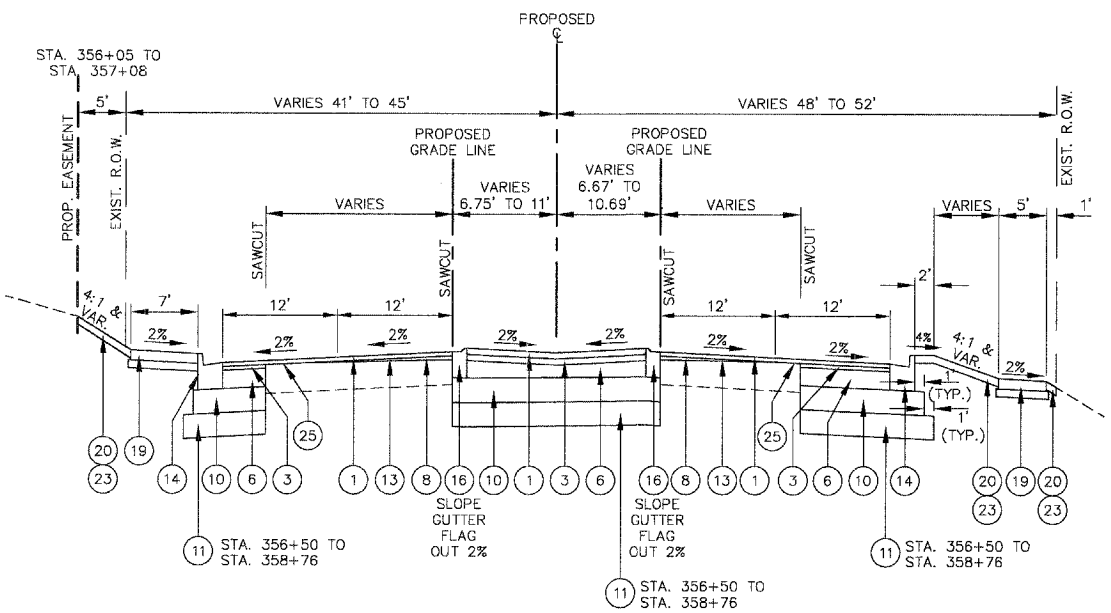

PROPOSED TYPICAL SECTION
 IL RTE. 64
 STA. 356+05 TO STA. 358+76

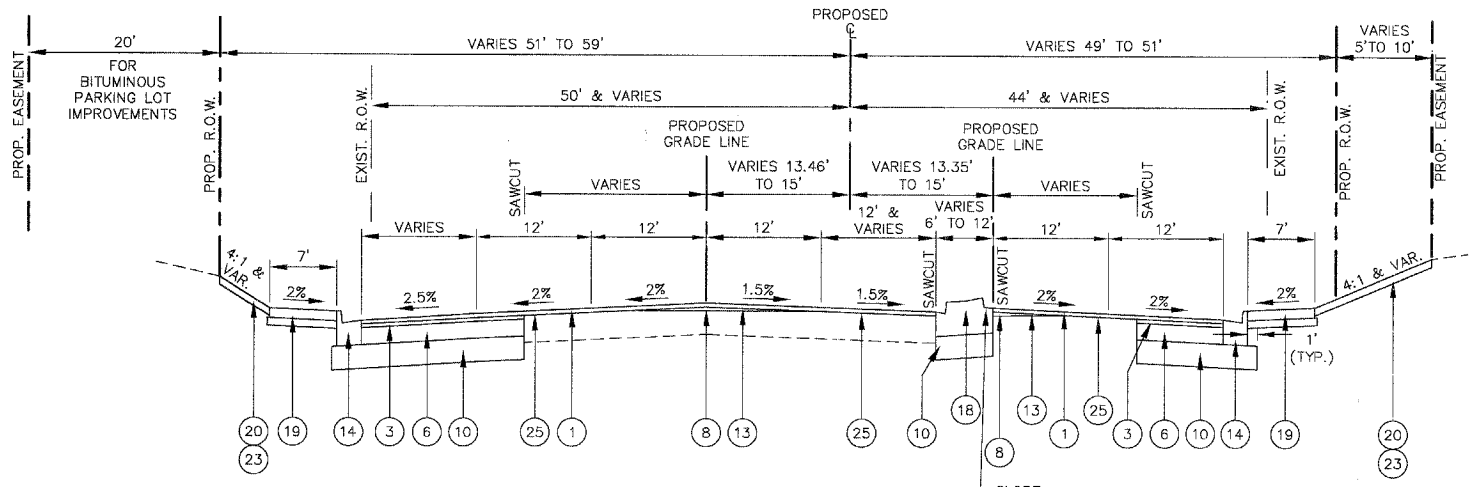

PROPOSED TYPICAL SECTION
 IL RTE. 64
 STA. 353+15 TO STA. 354+26

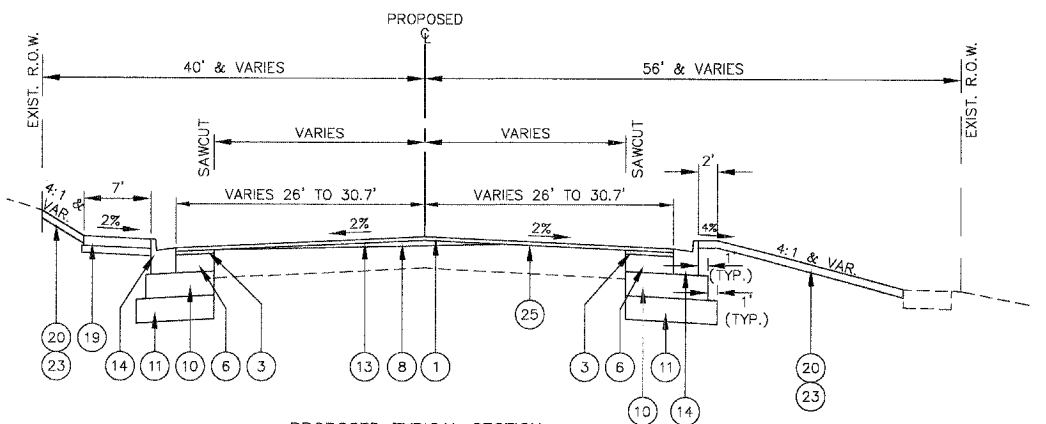

PROPOSED TYPICAL SECTION
 IL RTE. 64
 STA. 358+76 TO STA. 361+18

NOTE: STA. 361+18 TO STA. 364+25
 GRIND 2" (25)
 OVERLAY (1)

PROPOSED TYPICAL SECTION ITEMS

- (1) POLYMERIZED BITUMINOUS CONCRETE SURFACE COURSE, SUPERPAVE, MIX "F", N90, 2"
- (2) BITUMINOUS CONCRETE SURFACE COURSE, SUPERPAVE, MIX "D", N50, 2"
- (3) BITUMINOUS CONCRETE BINDER COURSE, SUPERPAVE, IL-19, N90, 2 1/4"
- (4) BITUMINOUS CONCRETE BINDER COURSE, SUPERPAVE, IL-19, N50, 2 1/4"
- (5) BITUMINOUS BASE COURSE, SUPERPAVE, 9 3/4"
- (6) BITUMINOUS BASE COURSE, SUPERPAVE, 8 3/4"
- (7) BITUMINOUS BASE COURSE, SUPERPAVE, 5 3/4"
- (8) LEVELING BINDER (MACHINE METHOD), SUPERPAVE, N70
- (9) PORTLAND CEMENT CONCRETE PAVEMENT, 10" (JOINTED) JOINTS @ 15' C/C SEE STANDARDS FOR TIE BARS AND DOWEL BARS
- (10) AGGREGATE SUBGRADE, 12"
- (11) POROUS GRANULAR EMBANKMENT, SPECIAL 12" WITH GEOTECHNICAL FABRIC FOR GROUND STABILIZATION
- (12) HIGH-EARLY-STRENGTH PORTLAND CEMENT CONCRETE PAVEMENT, 10" (JOINTED)
- (13) AREA REFLECTIVE CRACK CONTROL TREATMENT, SYSTEM A
- (14) COMBINATION CONCRETE CURB AND GUTTER, TYPE B-6.24
- (15) COMBINATION CONCRETE CURB AND GUTTER, TYPE B-6.12
- (16) COMBINATION CONCRETE CURB AND GUTTER, TYPE M-2.12
- (17) PORTLAND CEMENT CONCRETE CORRUGATED MEDIAN
- (18) CONCRETE MEDIAN, TYPE SB-6.12
- (19) PORTLAND CEMENT CONCRETE SIDEWALK, 5" WITH AGGREGATE BASE COURSE, TYPE B, 4"
- (20) TOPSOIL FURNISH AND PLACE, 4"
- (21) TOPSOIL FURNISH AND PLACE, 24" (LANDSCAPED MEDIAN, SEE LANDSCAPING PLANS FOR GRADING)
- (22) SEEDING CLASS 2A
- (23) SODDING, SALT TOLERANT
- (24) STEEL PLATE BEAM GUARD RAIL, TYPE A & GUARDRAIL STABILIZATION BITUMINOUS SHOULDERS SUPERPAVE 6"
- (25) BITUMINOUS SURFACE REMOVAL
- (26) STABILIZED BIKE PATH BITUMINOUS CONCRETE SURFACE COURSE, SUPERPAVE, MIX "C", N50, 3"; AGGREGATE BASE COURSE, TYPE B, 6"; AGGREGATE SHOULDERS, TYPE B, 6"
- (27) PIPE UNDERDRAIN, 4"