

**RANDALL ROAD  
 C CURVE #2**

RADIUS = 9950.00'  
 ARC LENGTH = 232.66'  
 CHORD LENGTH = 232.65'  
 TANGENT LENGTH = 116.33'  
 DEGREE OF CURVE = 00°-34'-33"  
 MID ORDINATE = 0.68"  
 EXTERNAL SECANT = 0.68"  
 INCLUDED ANGLE = 01°-20'-23"  
 PC = 30+95.36  
 PT = 33+28.01

F.A.P. ROUTE	COUNTY SECTION	COUNTY	TOTAL SH.
336	99-00243-00-PV	KANE	268
CONTRACT NO. 83782			
PLAN & PROFILE STA. 31+50 TO STA. 36+50			
F.H.W.A. REG 5 ILLINOIS PROJECT F-0336(0)			

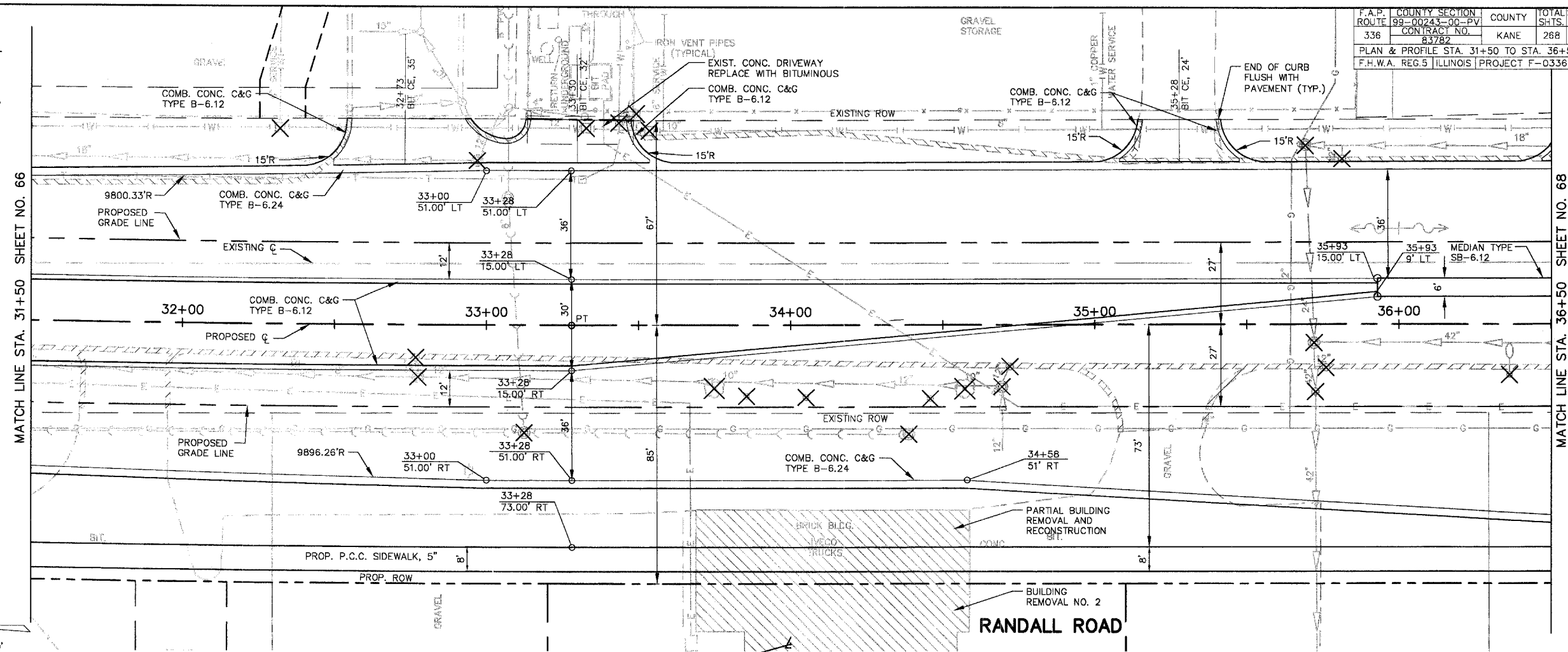

SCALE: 1" = 20'

