

|   |                |        |           |
|---|----------------|--------|-----------|
| F.A.P. ROUTE                              | COUNTY SECTION | COUNTY | TOTAL SH. |
| 336                                       | 99-00243-00-PV | KANE   | 268       |
| CONTRACT NO.                              | 83782          |        |           |
| PLAN & PROFILE STA. 358+50 TO STA. 363+00 |                |        |           |
| F.H.W.A. REG.5 ILLINOIS PROJECT F-0336(0) |                |        |           |

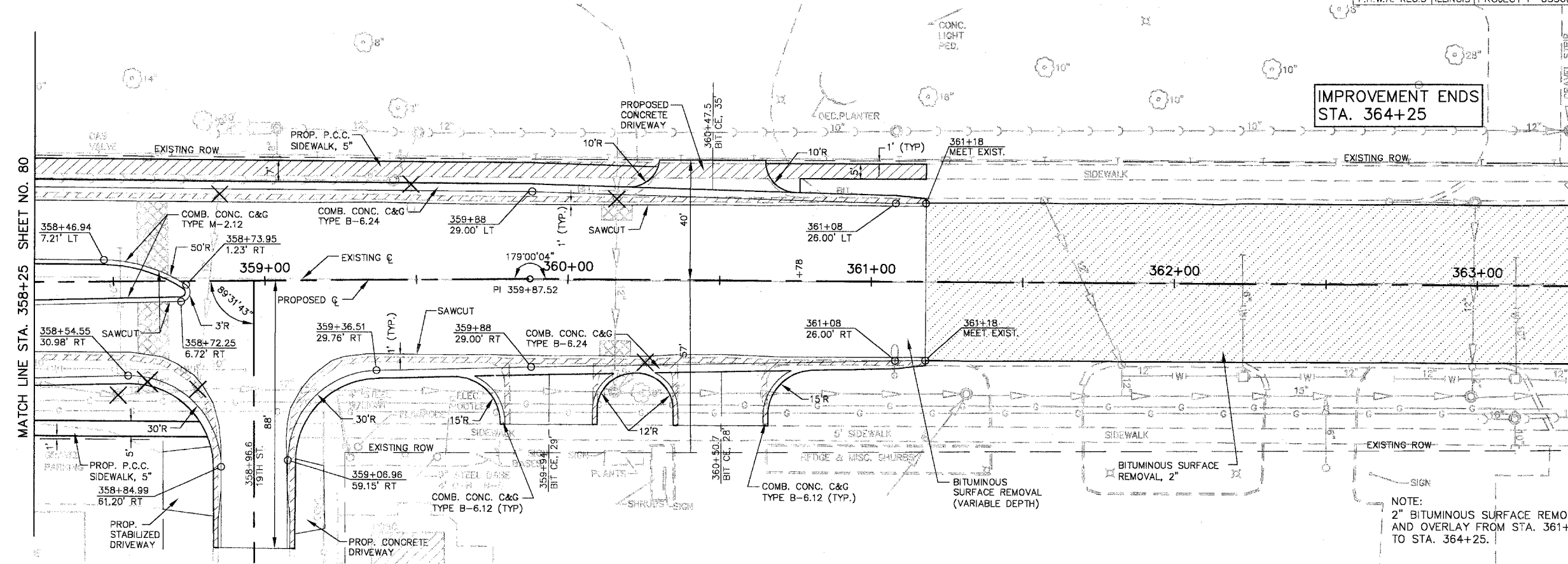

IMPROVEMENT ENDS  
 STA. 364+25

NOTE:  
 2" BITUMINOUS SURFACE REMOVAL AND OVERLAY FROM STA. 361+18 TO STA. 364+25.

SCALE: 1" = 20'

ILLINOIS ROUTE 64

