

F.A.P. ROUTE	COUNTY SECTION	COUNTY	TOTAL SHTS.
336	99-00243-00-PV	KANE	268
CONTRACT NO. 83782			
LIGHTING PLAN			
F.H.W.A. REG. 5 ILLINOIS PROJECT F-0336(C)			

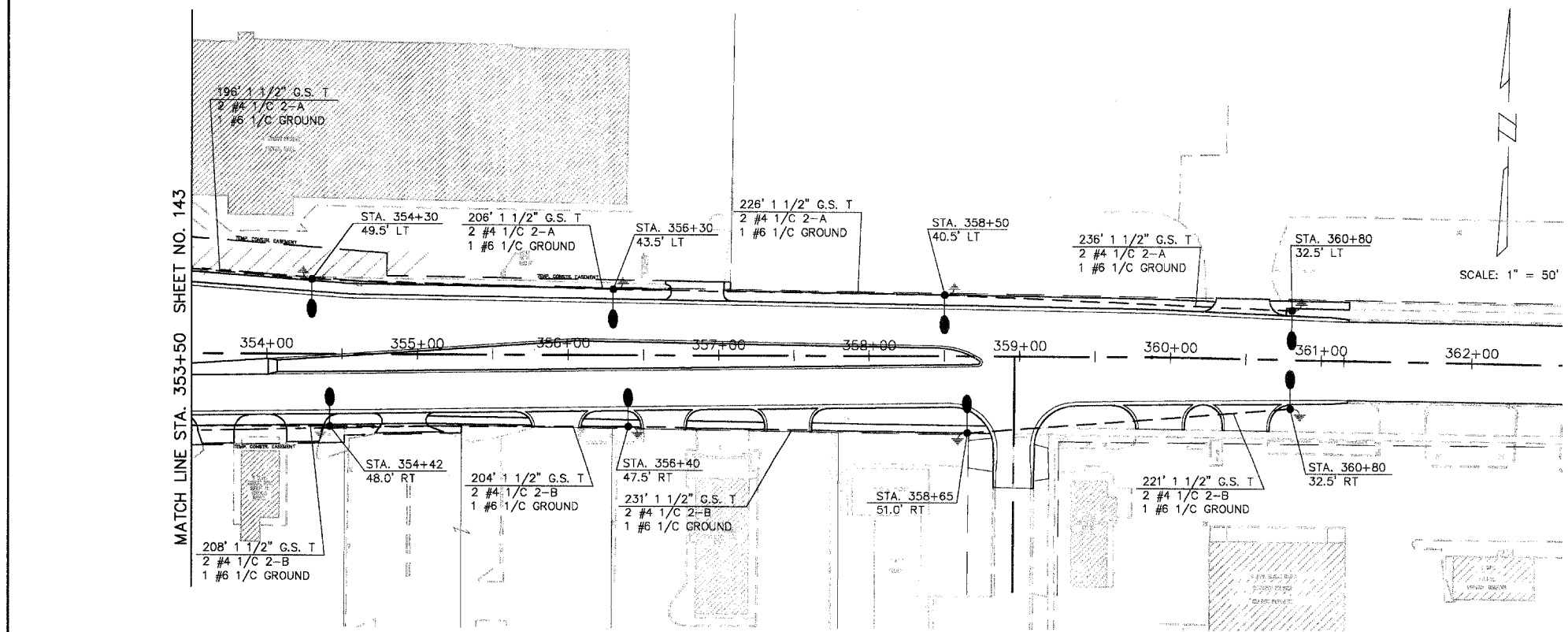

LEGEND

- PROPOSED LIGHT STANDARD WITH 310 WATT LUMINAIRE
- PROPOSED COMBINATION MAST ARM ASSEMBLY AND POLE WITH 400 WATT LUMINAIRE
- PROPOSED COMBINATION MAST ARM ASSEMBLY AND POLE WITH TWO LIGHTING MAST ARMS WITH 400 WATT LUMINAIRES
- PROPOSED LIGHTING CONTROLLER
- PROPOSED HANDHOLE
- GROUND ROD
- PROPOSED GFCI FESTOON OUTLET
- GALVANIZED STEEL CONDUIT IN TRENCH (T), IN COMMON TRENCH (CT), EMBEDDED (EM), OR PUSHED (P) OF THE SIZE SPECIFIED WITH THE NUMBER AND SIZE OF CABLES SPECIFIED. CONDUIT LENGTHS INCLUDE 3 FEET OF VERTICAL CONDUIT AT EACH LIGHT STANDARD.
- EXISTING LIGHT STANDARD
- EXISTING LIGHT STANDARD TO BE REMOVED

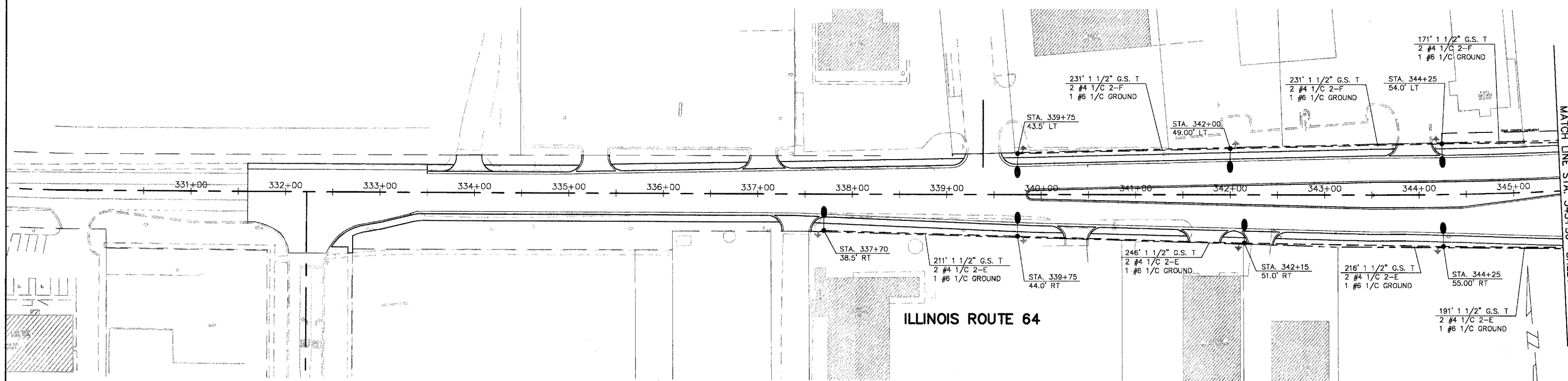
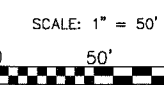

REVISIONS	
NAME	DATE
PER BEO REVIEW	10-7-04

STREET LIGHTING PLAN

STATION 330+00 TO 360+00

MAIN STREET (ILLINOIS ROUTE 64)

SCALE: AS SHOWN
DATE: 5-26-04

DRAWN BY: JMH
CHECKED BY: DAY

ILLINOIS ROUTE 64