

F.A.P. ROUTE	COUNTY SECTION	COUNTY	TOTAL SHEETS
336	99-00243-00-PV	KANE	268
	CONTRACT NO.		NO.
	83782		218
CROSS SECTION STA. 27+00 TO STA. 28+00			
F.H.W.A. REG. 5 ILLINOIS PROJECT F-0336(00)			

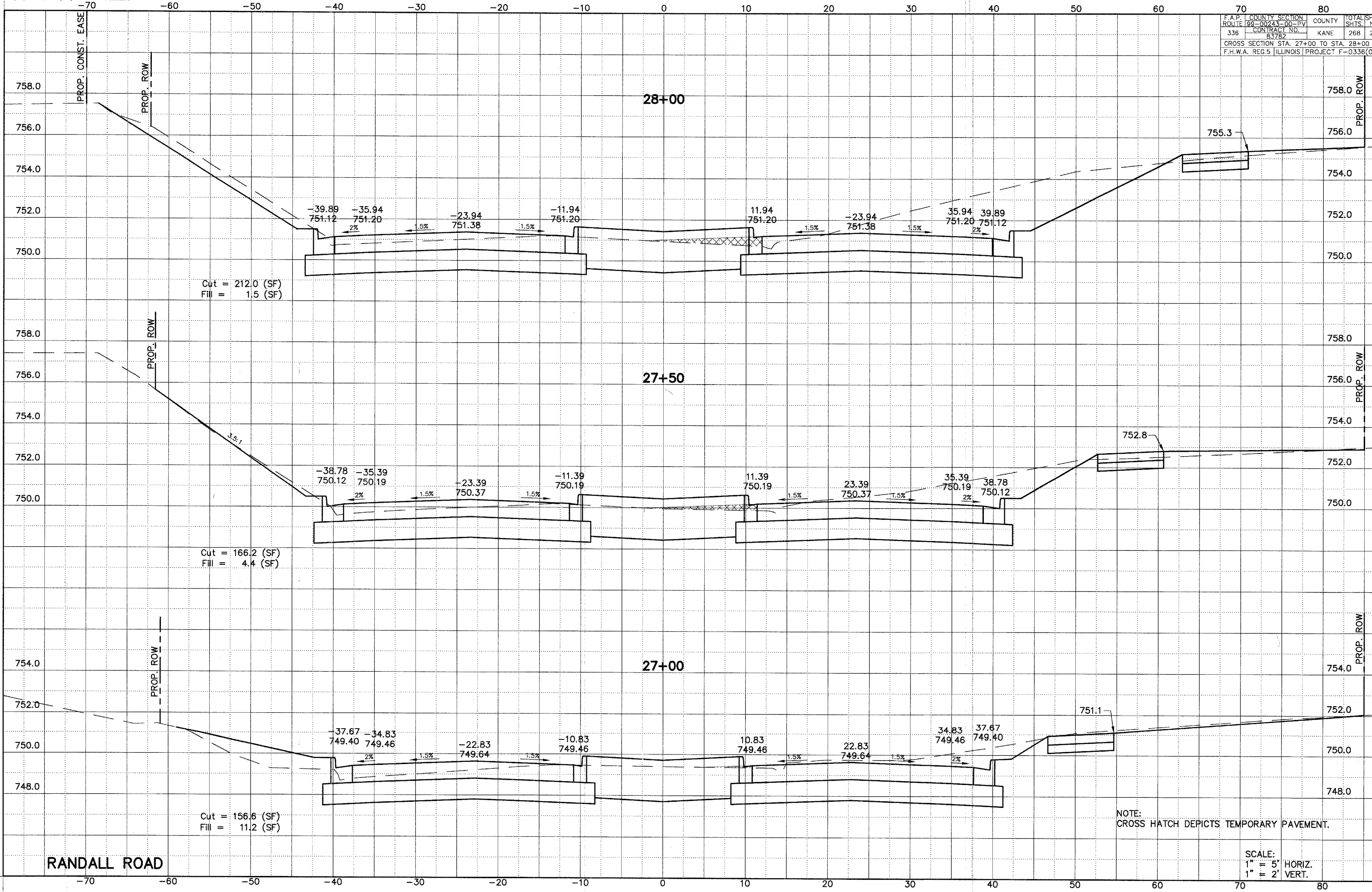

RANDALL ROAD

NOTE:
CROSS HATCH DEPICTS TEMPORARY PAVEMENT.

SCALE:
1" = 5' HORIZ.
1" = 2' VERT.