

F.A.U. RTE.	SECTION	COUNTY	TOTAL SHEETS	SHEET NO.
5100	04-00526-00-BR	WINNEBAGO	17	3
STA.		TO STA.		
FED. ROAD DIST. NO. 7		ILLINOIS	PROJECT BHM-509963	
CONTRACT NO. 85358				

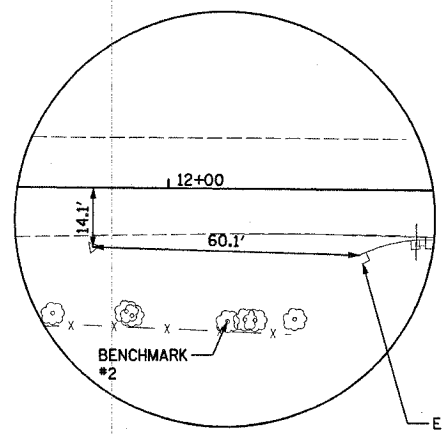

CONTROL POINT #1
5/8" IRON PIN

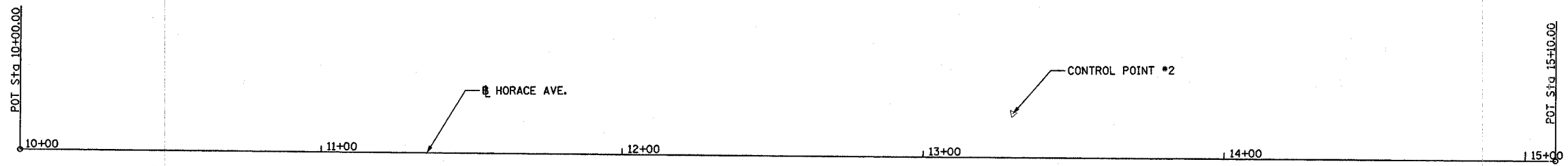
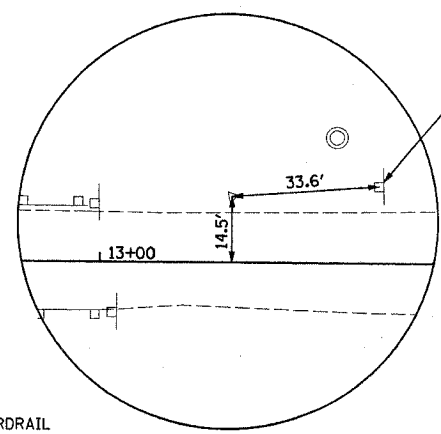

CONTROL POINT #2
5/8" IRON PIN

CONTROL AND TIES				
POINT #	NORTHING	EASTING	ELEVATION	DESCRIPTION
CP #1	10000.000	10000.000	729.75	5/8" I.P.
CP #2	10149.610	10000.000	729.84	5/8" I.P.

PROPOSED ALIGNMENT		
STATION	NORTHING	EASTING
10+00.00	9823.007	9951.698
15+10.00	10323.602	10049.195

BENCHMARK #1 = BENCHMARK DISC LOCATED IN CONCRETE HEADWALL OF CONCRETE ARCH VIADUCT STRUCTURE OVER SOUTH FORK OF KENT CREEK. THIS STRUCTURE IS LOCATED IMMEDIATELY NORTH OF CUNNINGHAM ROAD AND ABOUT 65 YARDS WEST OF SOUTH HORACE AVENUE. THE BENCHMARK DISK IS LOCATED IN SOUTH HEADWALL OF THE STRUCTURE ABOUT 2 FEET WEST OF EAST END OF HEADWALL, 1.5 FEET NORTH OF SOUTH EDGE OF HEADWALL, AND ABOUT 2 FEET BELOW LEVEL OF FORMER RAILROAD TRACK. ELEV. = 751.26

BENCHMARK #2 = SET SPIKE IN TREE LOCATED ON THE ROADWAY SIDE OF EXISTING FENCE PARALLEL TO HORACE AVENUE NEAR SOUTHEAST CORNER OF EXISTING STRUCTURE. TREE IS LOCATED ABOUT 65 FEET SOUTH AND ABOUT 30 FEET EAST OF THE CENTERLINE OF HORACE AVENUE. ELEV. = 729.62

NOTE:
THE TWO BENCHMARKS DESCRIBED IN PLANS WILL BE DESTROYED DURING CONSTRUCTION. CONTRACTOR WILL NEED TO ESTABLISH NEW BENCHMARKS.

LAYOUT	RLA	02/23/05	rlg
DRAWN	RLA	02/25/05	03/17/2005
REVIEWED	JDS	03/17/05	1:04:47 pm C:\44190\CP\CH\AS\Sheet\NC-5071ES.dgn

REVISIONS	
NAME	DATE

ILLINOIS DEPARTMENT OF TRANSPORTATION
F.A.U. 5100
SECTION 04-00526-00-BR
CITY OF ROCKFORD, IL
HORACE AVE. OVER S. FORK KENT CREEK
ALIGNMENT AND TIES
SCALE: VERT. -
HORIZ. -
DATE 03/22/05
DRAWN BY RLA
CHECKED BY JDS