

F.A.U. RTE.	SECTION	COUNTY	TOTAL SHEETS	SHEET NO.	SHEET NO. B3 OF 18 SHEETS
6325	02-00090-00-BR	LIVINGSTON	31	10	
STA.	TO STA.				
FED. ROAD DIST. NO. 7	ILLINOIS FED. AID PROJECT*				
CONTRACT NO. 87238					

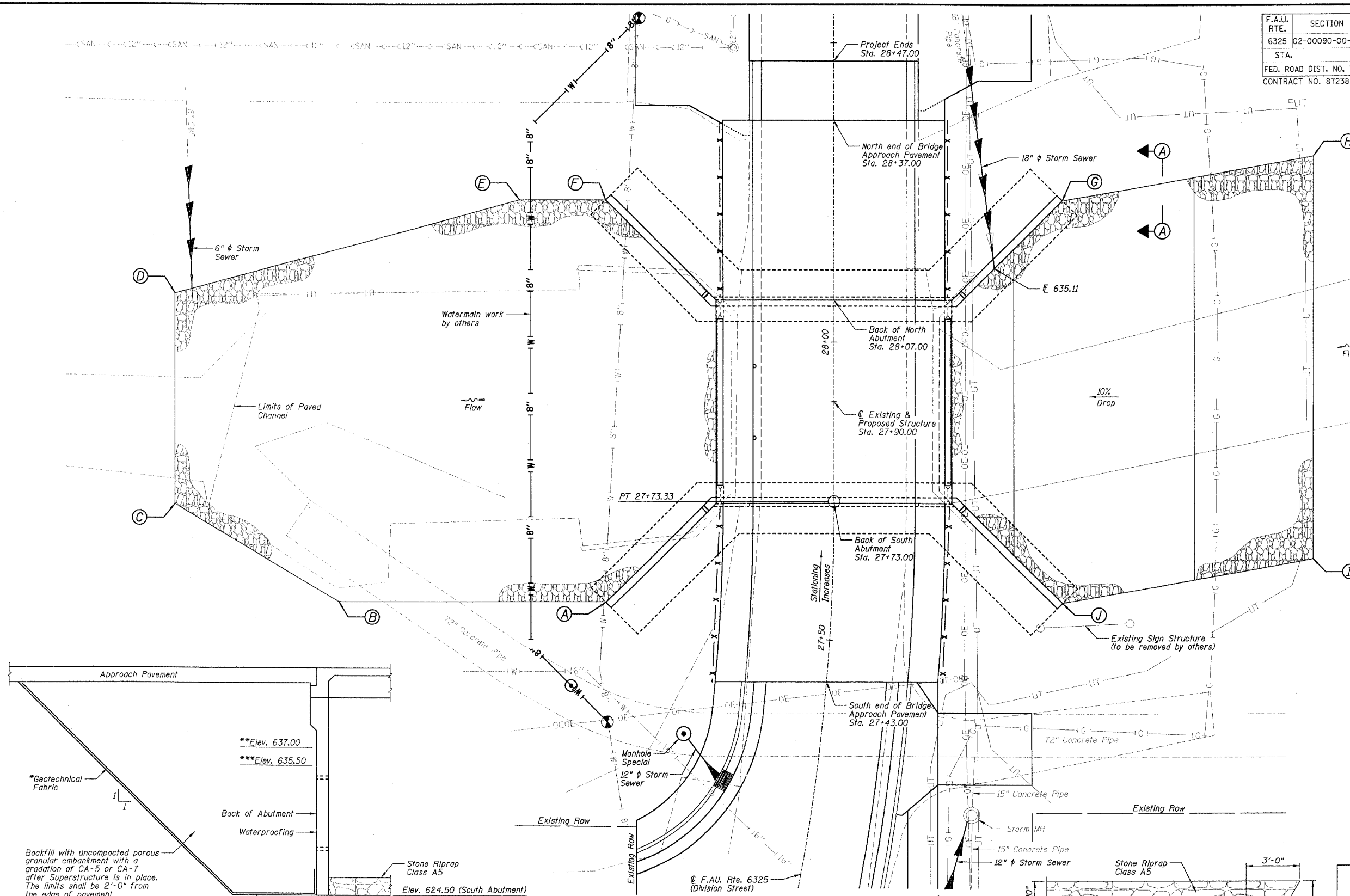

STONE RIPRAP LOCATION

Location	Station	Offset Distance
A	27+54	38' LT
B	27+51	82' LT
C	27+73	110' LT
D	28+08	110' LT
E	28+24	52' LT
F	28+24	38' LT
G	28+24	38' RT
H	28+31	80' RT
I	27+66	80' RT
J	27+58	38' RT

Note: Stations and offsets for the Stone Riprap Class A5 are from the roadway centerline.

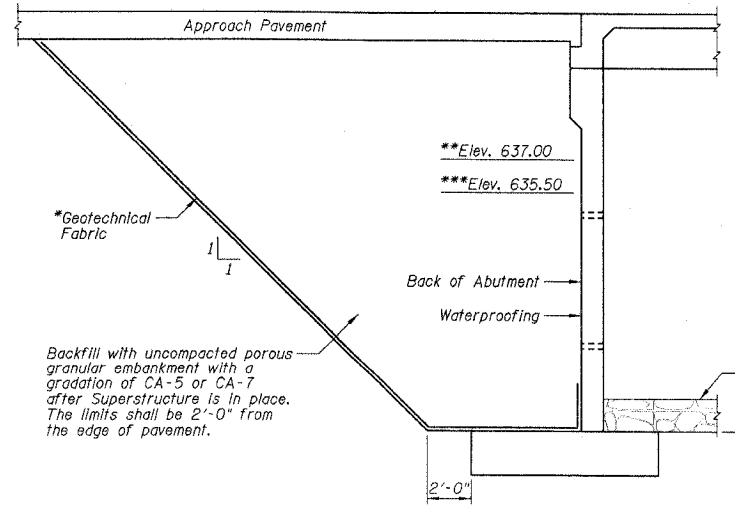

TYPICAL SECTION THRU ABUTMENT

- *Included in the cost of "Porous Granular Embankment".
- **Maximum backfill elevation without Superstructure in place (South Abutment).
- ***Maximum backfill elevation without Superstructure in place (North Abutment).

STONE RIPRAP LAYOUT PLAN

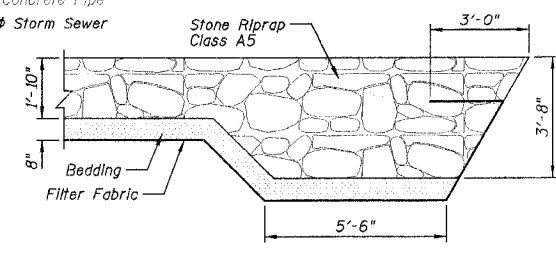

SECTION A-A

SECTION 02-00090-00-BR
LIVINGSTON COUNTY
PONTIAC, ILLINOIS

STONE RIPRAP LAYOUT PLAN

DESIGNED BY J.M.L.	<p>2708 McGraw Drive Bloomington, Illinois 61704 309-898-6455, 309-898-1571 fax</p>	FILE NO. 24-6884
DRAWN BY D.J.M.		DATE 01-14-05
CHECKED BY M.S.W.		SHEET NO. 10 of 31