

F.A.P. RTE.	SECTION	COUNTY	TOTAL SHEETS	SHEET NO.
315/317	***	FULTON	684	66
STA.	120+00	TO STA.	135+50	
FED. ROAD DIST. NO.	US 24	FED. AID PROJECT	*** 181, (18BRY&18BRY-1)BR, 18B-1 CONTRACT# 88753	

- LEGEND**
- ① AGG SURFACE COURSE TYPE A 6"
  - ② AGG SURFACE COURSE TYPE A 8"
  - ③ BIT SHOULDER 6 1/2" W/ BIT SURFACE CSE 1 1/2"
  - ④ CLASS B-3 RIPRAP
  - ⑤ CLASS A-2 RIPRAP
  - ⑥ CLASS A-3 RIPRAP
  - ⑦ CLASS A-4 RIPRAP
  - ⑧ CONCRETE COLLAR

EUGENE, COLEMAN

HARN, ROBERT J. ET AL

HENDRICK, DAVID L.

DEW, EDWARD M III

SEE INTERSECTION DETAIL SHEET FOR US 24 / BACK RD.

PROPOSED IMPROVEMENT ENDS STA 132+00.00

**PROPOSED IMPROVEMENT FAP 315/317 (US 24)**

STA. 120+00 TO STA. 135+50

DATE	
BY	
REVISION	
NO.	
DATE	
BY	
REVISION	
NO.	

DATE	
BY	
REVISION	
NO.	
DATE	
BY	
REVISION	
NO.	

US24SPOON\_PL.2 / PPSHTSS0.DGN

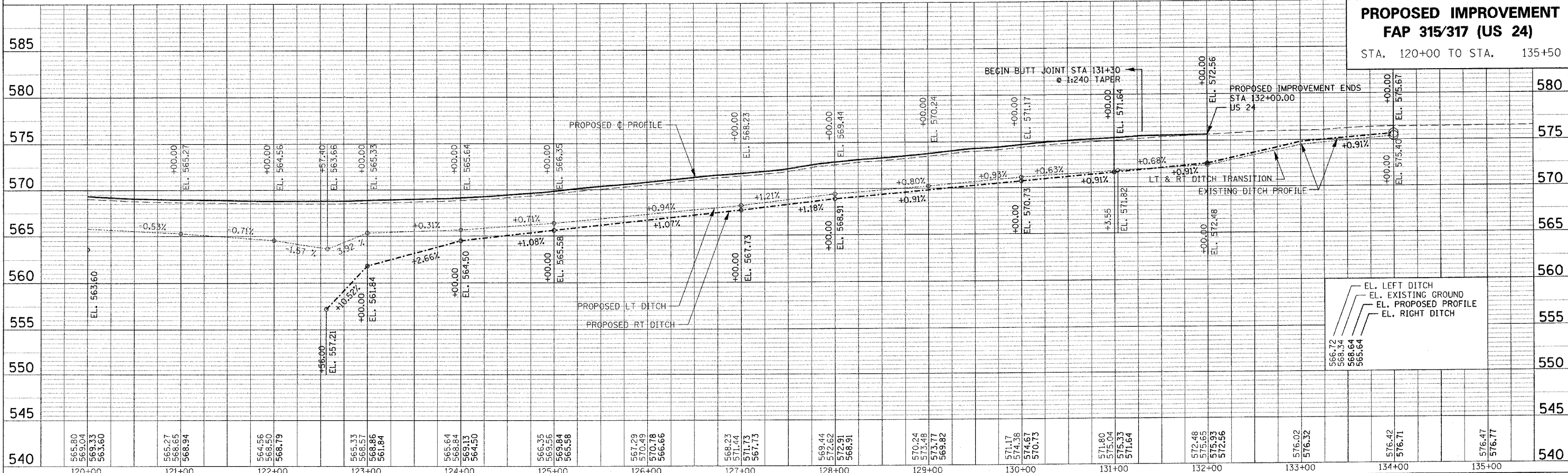

PLOTTED: \*\*DATE\*\*