

F.A.P. RTE.	SECTION	COUNTY	TOTAL SHEETS	SHEET NO.
317	***	FULTON	604	81
STA.		TO STA.		
FED. ROAD DIST. NO.		ILLINOIS	FED. AID PROJECT	
***181,18BRY&18BRY-1BR,18B-1				

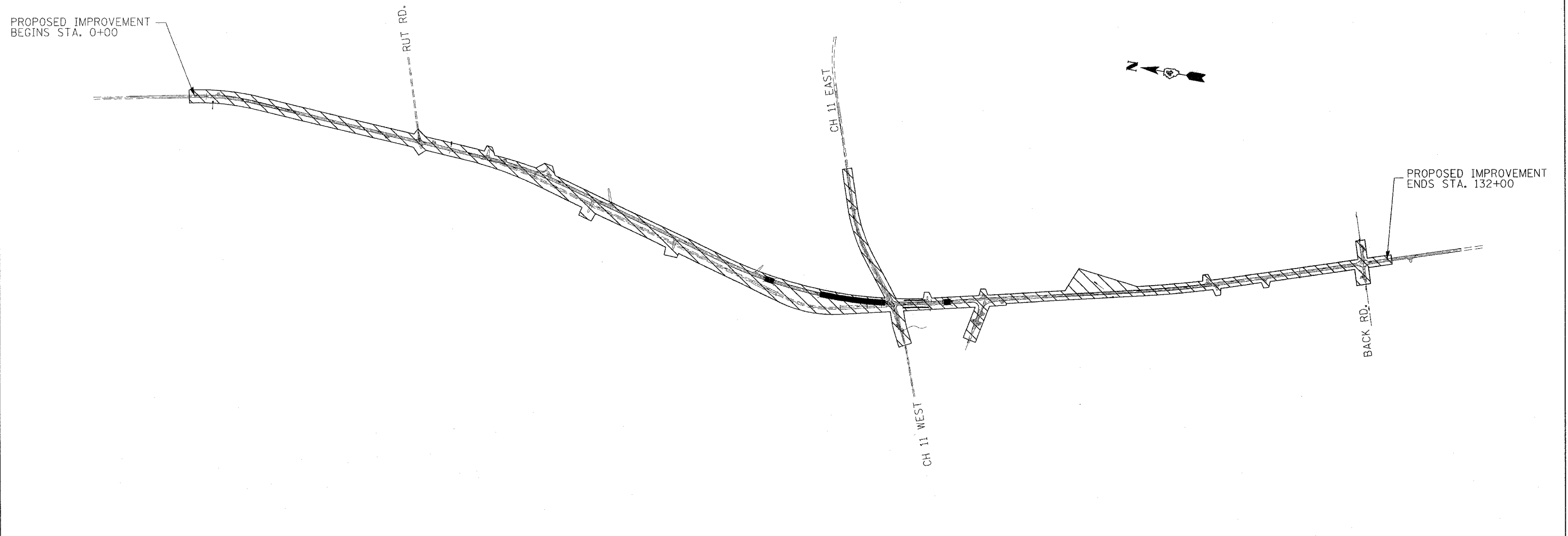

**STAGE V**

**TRAFFIC**

TRAFFIC ON THE NEW PAVEMENT

**CONSTRUCTION**

- COMPLETE COUNTY HIGHWAY 11 WEST REALIGNMENT
- REMOVAL OF EXISTING US 24 PAVEMENT
- REMOVAL OF EXISTING SPOON RIVER OVERFLOW AND THE SPOON RIVER STRUCTURES
- REMOVAL OF TEMPORARY RUNAROUND AND TEMPORARY STRUCTURE
- FINAL BINDER AND SURFACE COURSE, AGGREGATE SHOULDERS, GUARDRAIL, AND SEEDING
- SOUTHBOUND PAVEMENT TIE-IN AT NORTH END OF REALIGNMENT SECTION (30+00 TO 38+50)

REVISIONS	
NAME	DATE

ILLINOIS DEPARTMENT OF TRANSPORTATION

**STAGE V OVERVIEW**

SCALE: VERT.  
HORIZ.  
DATE

DRAWN BY  
CHECKED BY