

S:\GENDRAFT\STD&PLNS\SQUAD9\88753\Phase II PowerDraft Files\US 24-US 136 Flasher and Overhead 3-27-05.dgn

VAR. RTE.	SECTION	COUNTY	TOTAL SHEETS	SHEET NO.
317	**	FULTON	684	138
STA. TO STA.				
FED. ROAD DIST. NO. 4	ILLINOIS	FED. AID PROJECT		
**181, 188BRY & 188BRY-188, 188-1 CONTRACT # 88753				

SUMMARY OF QUANTITIES	UNIT	TOTAL QUANTITIES
SERVICE INSTALLATION, TYPE A	EACH	1.0
CONDUIT IN TRENCH, 2" DIA., PVC	FOOT	31.0
CONDUIT PUSHED, 2" DIA., PVC	FOOT	19.0
CONDUIT ATTACHED TO STRUCTURE, 1-1/2" DIA., GALVS	FOOT	49.0
TRENCH AND BACKFILL FOR ELECTRICAL WORK	FOOT	31.0
FLASHER CONTROLLER	EACH	1.0
GULFBOX JUNCTION	EACH	2.0
ELECTRIC CABLE IN CONDUIT, SIGNAL, NO. 14 3C	FOOT	74.0
SIGNAL HEAD, I-FACE, 1-SECTION, POST MOUNTED	EACH	1.0
LUMINAIRE, SODIUM VAPOR, MULTI-MOUNT, PHOTO-CELL CONTROL, 250 WATT	EACH	2.0

CONSTRUCTION NOTES

THE GULFBOX JUNCTION SHALL BE CONSTRUCTED SO THAT THE TOP OF THE FRAME WILL BE FLUSH WITH THE SURFACE OF THE MEDIAN.

THE LOCATION OF ALL UTILITIES SHALL BE FIELD VERIFIED BY THE CONTRACTOR BEFORE THE INSTALLATION OF ANY ELECTRICAL COMPONENTS.

COILABLE POLYETHYLENE DUCT MAY BE SUBSTITUTED FOR PVC CONDUIT PUSHED OR TRENCHED.

GALVANIZED STEEL CONDUIT SHALL BE USED FOR THE TYPE A SERVICE INSTALLATION AND ALL EXPOSED CONDUIT ABOVE GRADE.

ALL JUNCTION BOXES SHALL BE INSTALLED ONE INCH BELOW GRADE AND ENCASED IN A MINIMUM OF 6 INCHES OF CONCRETE ON ALL SIDES.

THE SERVICE DISCONNECT AND FLASHER CABINET SHALL BE MOUNTED AT A MINIMUM HEIGHT OF 3.5 FT ON THE PROPOSED SERVICE POLE.

THE TRAFFIC SIGNAL HEAD SHALL BE EQUIPPED WITH A 12" RED LED.

THE FLASHER INSTALLATION SHALL CONFORM TO STANDARD 880001.

A TWIN-TENON LUMINAIRE MOUNTING BRACKET, ALL MOUNTING HARDWARE, AND #6 WIRE SHALL BE PROVIDED AND INSTALLED ON THE PROPOSED SERVICE POLE. THE COST OF THIS WORK SHALL BE INCLUDED IN THE BID PRICE FOR THE LUMINAIRES.

LUMINAIRES SHALL BE EQUIPPED WITH INTEGRAL FUSING.

LUMINAIRES SHALL HAVE A MINIMUM 35 FT. MOUNTING HEIGHT.

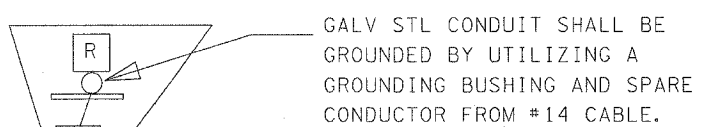
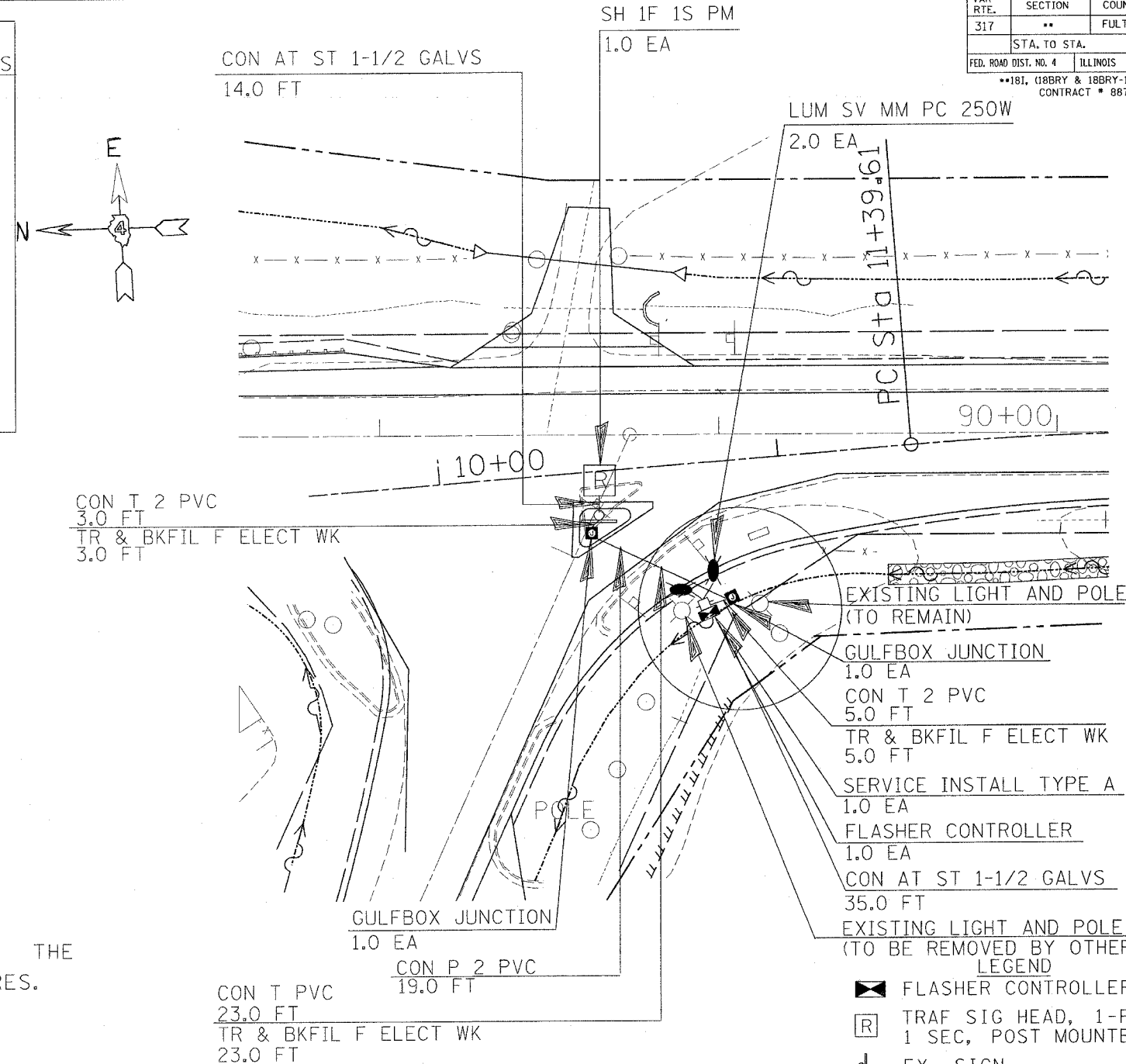

CABLE DIAGRAM
NOT TO SCALE

TRAFFIC SIGNAL LEGEND

- ⊙ OVERHEAD SERVICE CABLE FROM UTILITY
- ⊠ PROP. FLASHER CONTROLLER
- ③ 3/C NO. 14
- ⊠ PROP. TRAFFIC SIGNAL HEAD, 1 FACE, 1 SECTION, POST MOUNTED
- ⊙ PROP. GULFBOX JUNCTION
- ⊠ PROP. TYPE A SERVICE AND POLE
- ⊙ PROP. LUMINAIRE
- ⊠ EX. SIGN

- LEGEND**
- ⊠ FLASHER CONTROLLER
 - ⊠ TRAF SIG HEAD, 1-FACE, 1 SEC, POST MOUNTED
 - ⊠ EX. SIGN
 - PROPOSED CONDUIT
 - T 2 PVC OR P 2 PVC
 - ⊙ GULFBOX JUNCTION
 - ⊙ EX. LIGHT AND WOOD POLE
 - ⊠ PROP. TYPE A SERVICE
 - ⊙ PROP. LUMINAIRE, MM, 400 WATT, PC

REVISIONS	
NAME	DATE

ILLINOIS DEPARTMENT OF TRANSPORTATION
**FLASHING BEACON
OVERHEAD LIGHTING**
U.S. 24 & U.S. 136
SCALE: VERT. DATE
HORIZ. DATE
DRAWN BY
CHECKED BY

4/7/2005