

CONTRACT NO. 88753			
F.A. RTE.	SECTION	COUNTY	TOTAL SHEETS
315	***	FULTON	684
STA.		TO STA.	
FED. ROAD DIST. NO.		ILLINOIS FED. AID PROJECT	
*** 181.188RY&188RY-18R.188-1			

B.M: Chiseled square on Southeast wingwall of the Spoon River Overflow Structure El. 100.00
 Existing Structure: 6 Span R.C. Deck Girder, 1 Span thru Truss R.C. Abutments, R.C. Piers
 Built 1926 S.D.I. Rte. 31 Sec. 18-C Sta. 75+84
 Contractor to remove Truss span and structure to be widened. Salvage by contractor.
 A Temporary Bridge is required, 100 ft long 20 ft wide HS 15 Loading

STATE OF ILLINOIS
 DEPARTMENT OF PUBLIC WORKS & BUILDINGS
 DIVISION OF HIGHWAYS

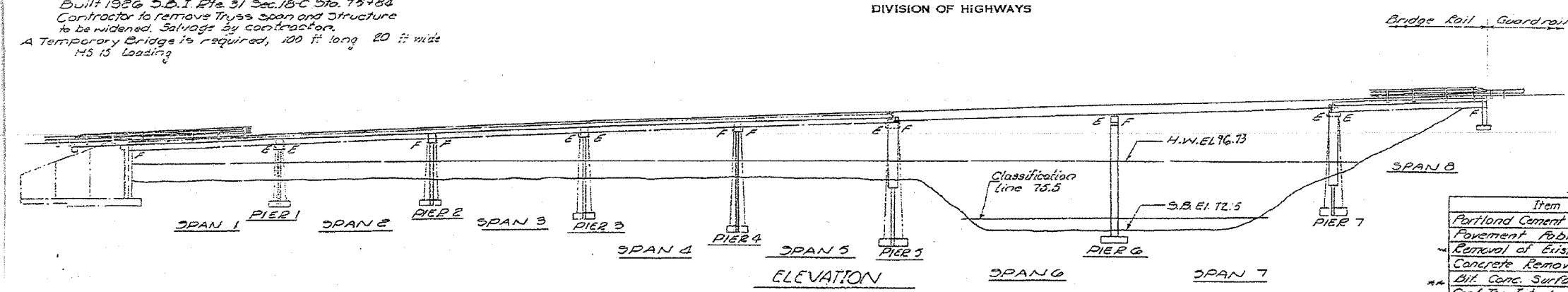

TOTAL BILL OF MATERIAL

Item	Unit	Super	Sub	Total
Portland Cement Conc. Pav't (10")	Sq. Yds.	17		17
Pavement Fabric	Sq. Yds.	17		17
Removal of Exst. Superstructure	Each	1		1
Concrete Removal	Cu. Yds.	10.3	10	11.3
Bit. Conc. Surface Removal	Sq. Yds.	621		621
Coat for Interlayer Protec. Coat	Sq. Yds.	1724		1724
Expansion Bolts 3/4" x 8"	Each	76	356	382
Class X Concrete	Cu. Yds.		170.1	170.1
Precast Conc. Bridge Slab	Sq. Ft.	149		149
Prec. Prest. Conc. Deck Bms. (21")	Sq. Ft.	3624		3624
Prec. Prest. Conc. Deck Bms. (35")	Sq. Ft.	4975		4975
Steel Railing Type N	Lin. Ft.	950		950
Reinforcement Bars	Lbs.		11,910	11,910
Steel Piles (10BP42)	Lin. Ft.		503	503
Test Piles (10BP42)	Each		1	1
Class X Conc. Encasement	Cu. Yds.		13.6	13.6
Temporary Bridge Complete	Each		1	1
Class A Excavation	Cu. Yds.		71	71
Class B Excavation	Cu. Yds.		75	75

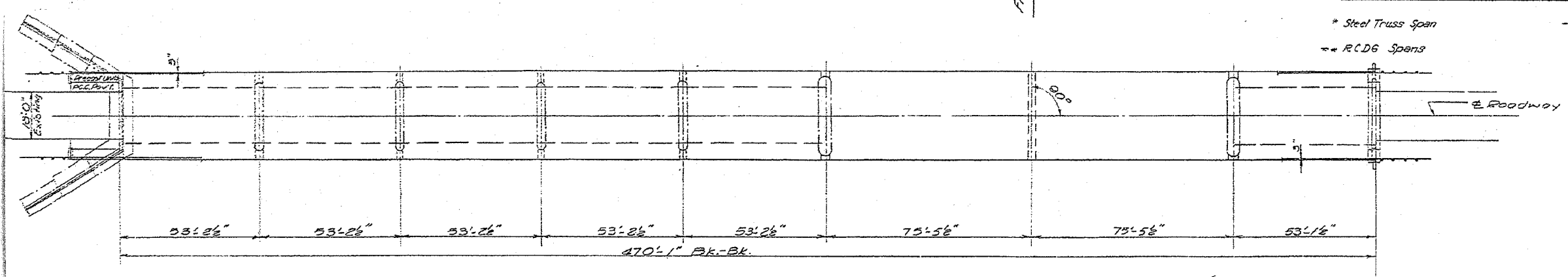

GENERAL NOTES

All reinforcement bars shall be lapped 24 dia. unless otherwise shown.

The Contractor shall drive (1) one Steel (10BP42) test pile in a permanent location at Pier 2 as directed by the Engineer before ordering the remainder of piles.

It shall be the responsibility of the Contractor to verify all dimensions and conditions existing in the field prior to construction and ordering of materials.

An alternate strand pattern using Extra High Strength Prestressing strand (EHS) is permitted. Expansion bolts shall consist of self drilling expansion anchors and 3/4" x 12" hooked bolts unless otherwise shown.

Limits of Coat for Interlayer Protective Coat shall be bk. to bk. of abutments and out to out of deck.

DESIGN STRESSES

FIELD UNITS	PRECAST PRESTR. UNITS
f _c = 1400 psi Super	f _c = 5000 psi
f _c = 1000 psi Sub	f _s = 4000 psi
f _s = 20,000 psi Prest	f _s = 248,000 psi
v _e = 75 psi Figs	f _s = 173,600 psi
n = 10	

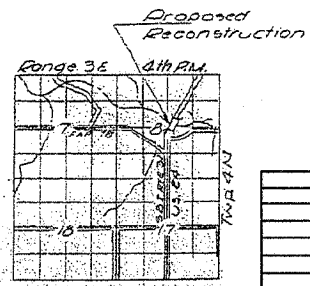

OVER SPOON RIVER
 S.B.I. ROUTE 31
 SECTION 188RY-1
 FULTON COUNTY
 STATION 75+84

DESIGNED	James Hamilton	EXAMINED	James Hamilton
CHECKED	James Hamilton	PASSED	James Hamilton
DRAWN	D. Deringer	APPROVED	James Hamilton
CHECKED	JP		

REVISIONS	
NAME	DATE

ILLINOIS DEPARTMENT OF TRANSPORTATION

EXISTING SPOON RIVER STRUCTURE FOR INFORMATION ONLY

SCALE: VERT. HORIZ.
 DATE

DRAWN BY
 CHECKED BY

PLOT DATE: 3/23/2000
 PLOT SCALE: 1/8" = 1'-0"
 USER NAME: jh111

LOADING HS 20-44