

STATE OF ILLINOIS
DEPARTMENT OF TRANSPORTATION

| | | | | |
|-----------------------|-------------|------------------|--------------|-----------|
| ROUTE NO. | SECTION | COUNTY | TOTAL SHEETS | SHEET NO. |
| FAP 315 | (18BRY-1)BR | FULTON | 169 | 46 |
| FED. ROAD DIST. NO. 7 | ILLINOIS | FED. AID PROJECT | | |

Contract #88753

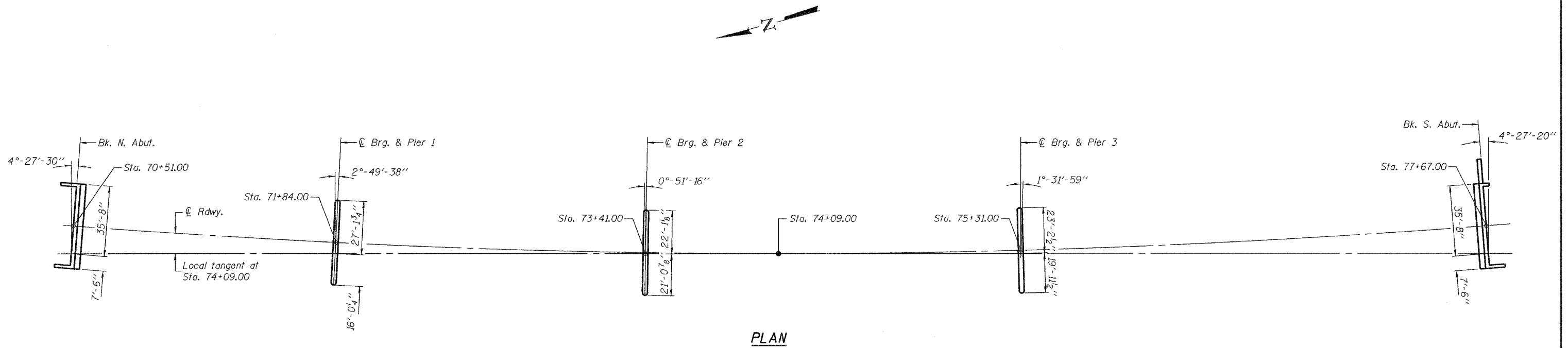

PLAN

| | |
|----------|----------------|
| DESIGNED | SEM/DPN |
| CHECKED | SMR/FT |
| DRAWN | h.t. parsons |
| CHECKED | SEM/SMR/DPN/FT |

May 16, 2005
 EXAMINED *Thomas J. Domagala*
 ENGINEER OF BRIDGE DESIGN
 PASSED *Ralph E. Anderson*
 ENGINEER OF BRIDGES AND STRUCTURES

FOOTING LAYOUT
 F.A.P. RTE. 315 - SEC. (18BRY-1)BR
 FULTON COUNTY
 STATION 74+09.000
 STRUCTURE NO. 029-0068