

F.A.P. RTE.	SECTION	COUNTY	TOTAL SHEETS	SHEET NO.
317	***	FULTON	684	250
STA.		TO STA.		
FED. ROAD DIST. NO.		ILLINOIS	FED. AID PROJECT	
*** 181, (18BRY&18BRY-1)BR, 18B-1				

ITEM	POINT	STA	OFFSET
TEMPORARY PAVEMENT MARKING	A	660+65.18	0.00'
	B	660+94.69	12.54' LT
	C	661+04.94	2.79' LT
	D	661+08.38	6.94' LT
	E	661+20.23	14.62' RT
	F	661+13.18	10.76' RT
	G	661+03.25	31.40' RT
	H	660+96.92	4.27' RT
TEMPORARY MEDIAN	1	661+06.24	1.26' LT
	2	661+09.45	0.84' LT
	3	661+12.31	4.36' RT
	4	661+10.32	7.09' RT
	5	661+03.91	4.52' RT
	6	661+03.47	1.66' RT

NOTE: 2' RADIUS AT EACH CORNER OF THE TEMP MEDIAN

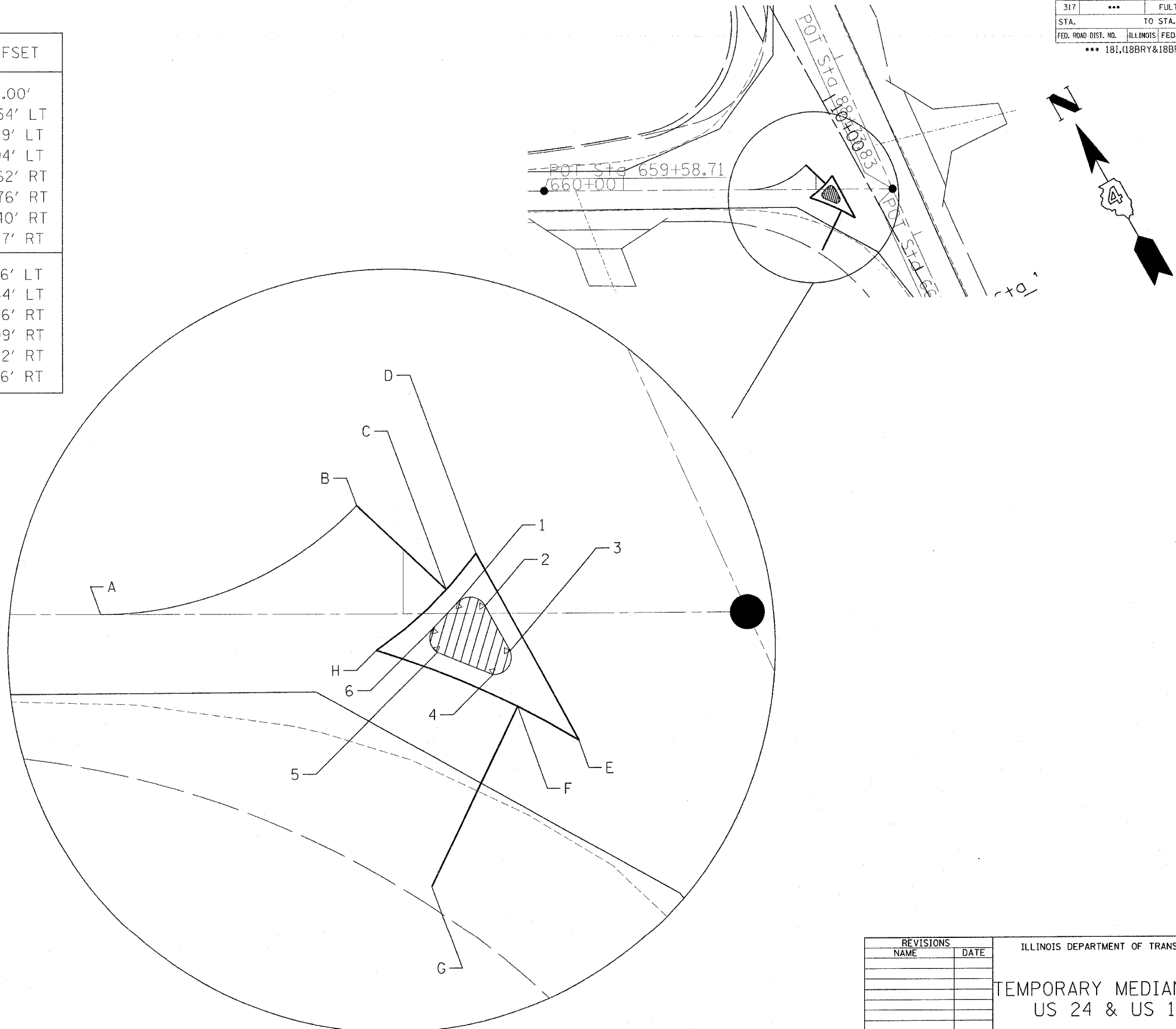

REVISIONS		ILLINOIS DEPARTMENT OF TRANSPORTATION
NAME	DATE	
		TEMPORARY MEDIAN DETAIL US 24 & US 136 N
SCALE:	VERT. DATE	DRAWN BY
HORIZ.		CHECKED BY

PLOT DATE = 4/7/2005
 FILE NAME = c:\p\c\projects\us24\spoon.ph\2\detail\mediansections.dgn
 PLOT SCALE = 20.0000 / IN.
 USER NAME = heggland