

ROUTE	SECTION	COUNTY	TOTAL SHEETS	SHEET NO.
T.R. 66	04-04125 -00-BR	PIATT	15	4
STA. 10+00	TO STA. 21+01.11			
ROAD DISTRICT	ILLINOIS	GOOSE CREEK		
CONTRACT NO. 91309				

CURVE DATA
 P.I. STA. 13+77.14
 $\Delta = 33^{\circ}00'00''$ RT.
 $D = 22^{\circ}00'00''$
 $T = 77.14'$
 $R = 260.44'$
 $L = 150.00'$
 $E = 11.18'$
 P.C. STA. 13+00.00
 P.T. STA. 14+50.00
 NO S.E.

LAWRENCE MARQUISS TRUST

N.E. 1/4, SEC. 35, T. 19 N., R. 5 E., 3RD P.M.

GEORGE TIMMONS

CURVE DATA
 P.I. STA. 17+03.60
 $\Delta = 12^{\circ}30'00''$ RT.
 $D = 7^{\circ}21'11''$
 $T = 85.34'$
 $R = 779.22'$
 $L = 170.00'$
 $E = 4.66'$
 P.C. STA. 16+18.26
 P.T. STA. 17+88.26
 NO S.E.

CHANNEL EXCAVATION

THE CHANNEL SHALL BE EXCAVATED AS SHOWN WITHIN THE LIMITS OF THE PROPOSED STRUCTURE THEN TAPER TO THE EXISTING CHANNEL AT THE R.O.W. LINES. SUITABLE EXCAVATED MATERIAL TO BE USED IN THE EMBANKMENT AS DIRECTED BY THE ENGINEER.

CHANNEL EXCAVATION = 350 CU. YD.

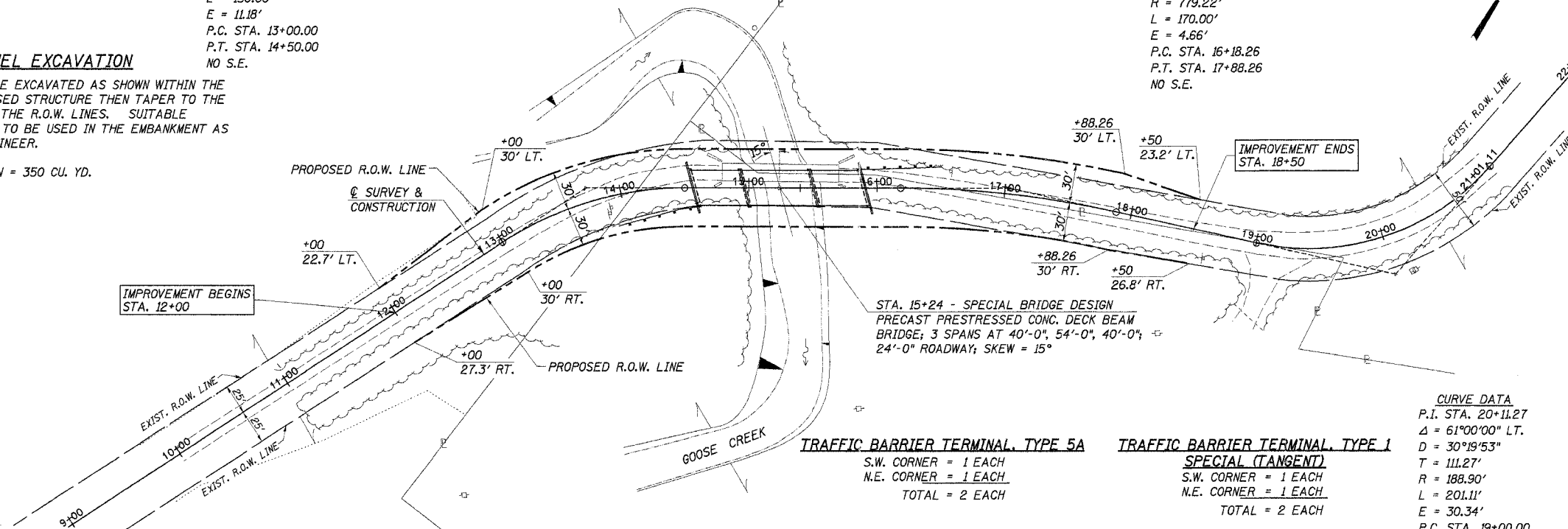

EXISTING STRUCTURE NO. 074-3051

SINGLE SPAN PRATT THRU TRUSS WITH TIMBER DECK ON CLOSED STONE ABUTMENTS AND WINGS.
 91'-0" BK.-BK. ABUTS.; 16'-0" DECK; SKEW = 0°
 REMOVAL OF EXISTING STRUCTURES = 1 EACH

OVERHEAD POWER

ILLINOIS POWER COMPANY
 BILL NIEBRUGGE
 618-236-6201

BURIED CABLE

VERIZON NORTH, INC.
 JONNA FRICKE
 309-663-3422

CURVE DATA
 P.I. STA. 20+11.27
 $\Delta = 61^{\circ}00'00''$ LT.
 $D = 30^{\circ}19'53''$
 $T = 111.27'$
 $R = 188.90'$
 $L = 201.11'$
 $E = 30.34'$
 P.C. STA. 19+00.00
 P.T. STA. 21+01.11
 NO S.E.

N.E. 1/4, SEC. 35, T. 19 N., R. 5 E., 3RD P.M.

JOHN C. STODDARD II

B.M. #1 - 60D NAIL IN 10" TREE
 15.3' LT., STA. 11+05
 EL. 651.54 (USGS)

B.M. #2 - CHISELED "□" ON S.E. WINGWALL
 .05' LT., STA. 14+73
 EL. 652.73

B.M. #3 - CHISELED "□" ON N.E. WINGWALL
 1.0' LT., STA. 15+73
 EL. 652.63

B.M. #4 - 60D NAIL IN POWER POLE
 34.0' RT., STA. 20+12
 EL. 657.38

EARTH EXCAVATION = 68 CU. YD.
 SUITABLE CHANNEL EXCAVATION = 175 CU. YD.
 FURNISHED EXCAVATION = 882 CU. YD.
 EMBANKMENT = 1064 CU. YD. (FOR INFORMATION ONLY)

