

F.A.P. RTE.	SECTION	COUNTY	TOTAL SHEETS	SHEET NO.
322	11-10	CHRISTIAN	310	37
STA.		TO STA.		
FED. ROAD DIST. NO.		ILLINOIS FED. AID PROJECT		

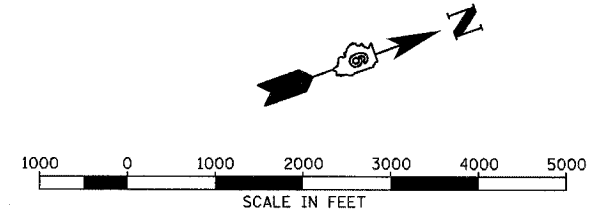
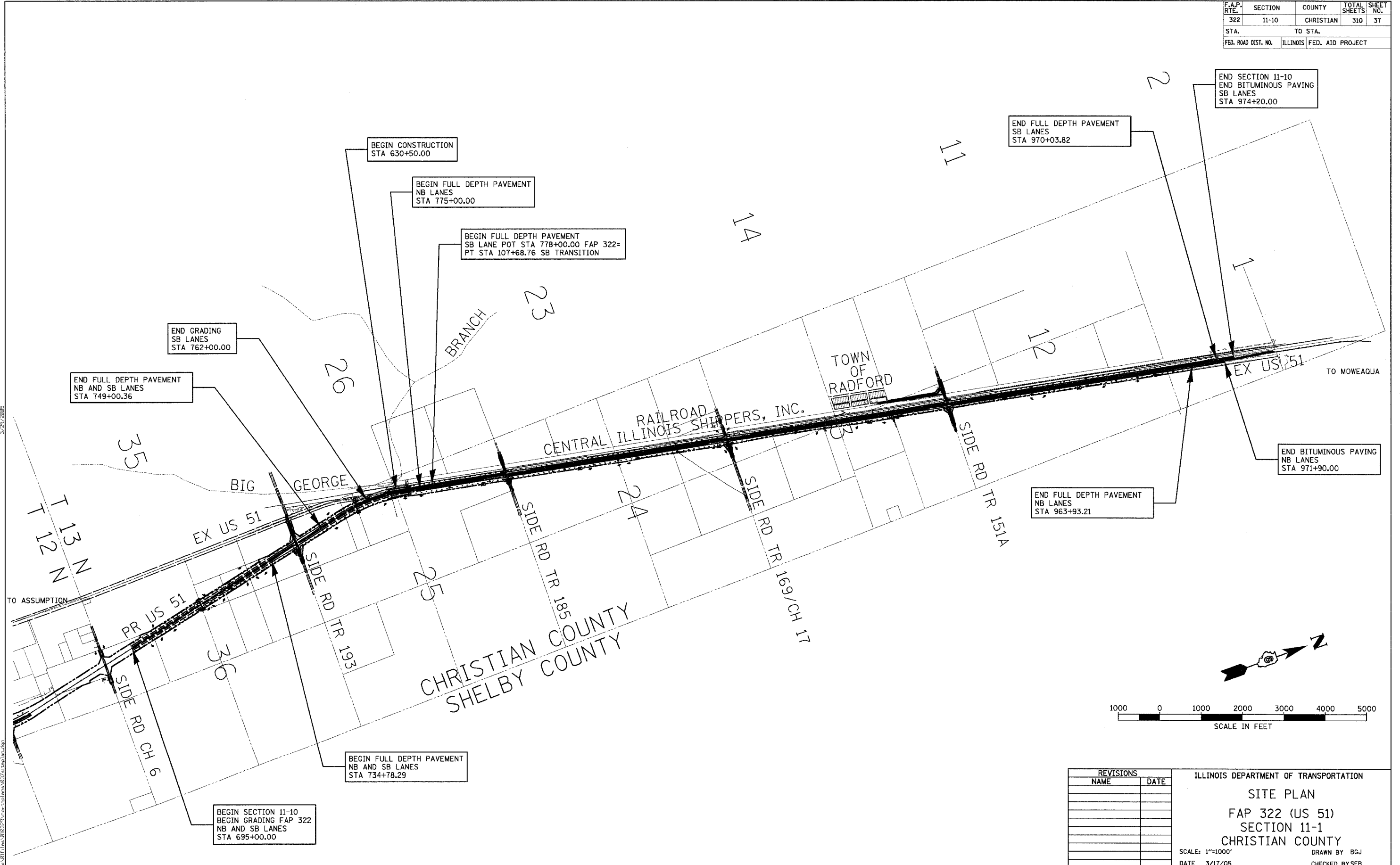

REVISIONS	
NAME	DATE

ILLINOIS DEPARTMENT OF TRANSPORTATION  
 SITE PLAN  
 FAP 322 (US 51)  
 SECTION 11-1  
 CHRISTIAN COUNTY  
 SCALE: 1"=1000'  
 DATE 3/17/05  
 DRAWN BY BGJ  
 CHECKED BY SEB

3/24/2005