

THE STAGE CONSTRUCTION SEQUENCE IS FOR INFORMATION ONLY. THE CONTRACTOR IS RESPONSIBLE FOR PLANNING AND EXECUTING THIS PROJECT WHICH SHALL BE SUBJECT TO THE APPROVAL OF THE ENGINEER.

F.A.P. RTE.	SECTION	COUNTY	TOTAL SHEETS	SHEET NO.
322	11-10	CHRISTIAN	310	38
STA.	TO STA.			
FED. ROAD DIST. NO.	ILLINOIS	FED. AID PROJECT		

STAGE 1

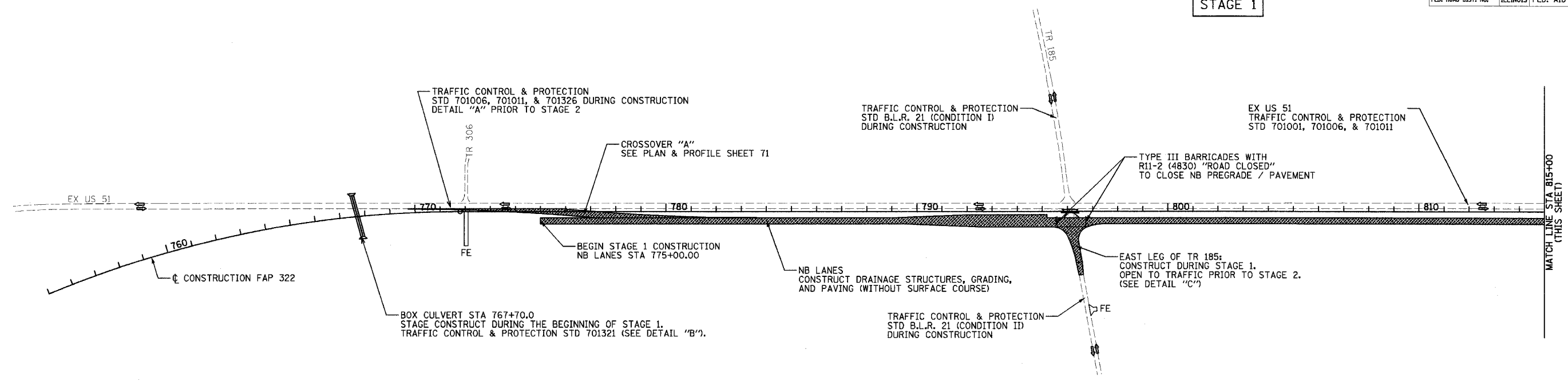

NOTE:
 AT ALL TIMES THE NEXT SIDE ROAD TO THE NORTH AND SOUTH OF A CLOSED SIDE ROAD SHALL REMAIN OPEN TO THROUGH TRAFFIC.
 PROVIDE ALL WEATHER ACCESS TO ALL PROPERTIES DURING CONSTRUCTION.
 THE FINAL 2" BITUMINOUS SURFACE LIFT TO BE PLACED AFTER STAGE 2.

LEGEND

▨ AREA UNDER CONSTRUCTION

← DIRECTION OF TRAFFIC

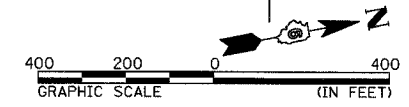
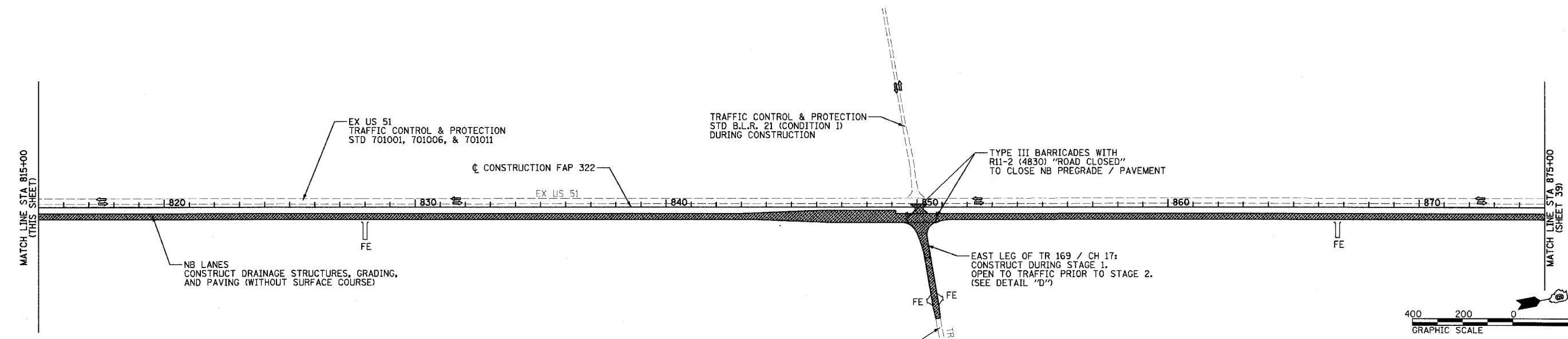

REVISIONS	
NAME	DATE

ILLINOIS DEPARTMENT OF TRANSPORTATION
 TRAFFIC CONTROL AND STAGING
 STAGE 1 - 755+00 TO 875+00
 FAP 322 (US 51)
 SECTION 11-1
 CHRISTIAN COUNTY

SCALE: 1"=200'
 DATE: 3/17/05
 DRAWN BY: SEB
 CHECKED BY: EBB

3/29/2005

\\na\p1\has\10\1025\proj\trb\trb\stage1\12.dwg