

STA 945+64.5
DITCH CHECK, STD 202001
TOP EL = 620.37

NE 1/4 SEC 12, T13N, R1E, 3RD PM

F.A.P. RTE.	SECTION	COUNTY	TOTAL SHEETS	SHEET NO.
322	11-10	CHRISTIAN	310	68
STA.	TO STA.			
FED. ROAD DIST. NO.	ILLINOIS	FED. AID PROJECT		

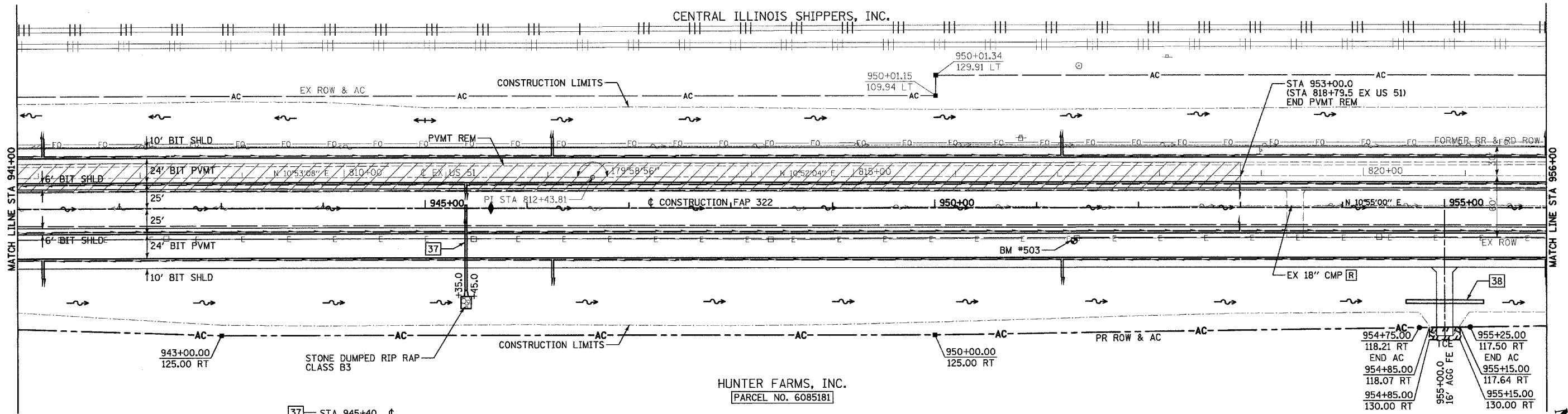

37 - STA 945+40
 MEDIAN INLET, STD 604101, 1 EACH
 REINFORCED CONCRETE PIPE TEE, 24" PIPE WITH 24" RISER, STD 542606, 1 EACH
 PIPE CULVERT, RCCP, TYPE 2, 24" X 78" (PAY LENGTH)
 USFL = 615.15 DSFL = 614.35
 CONCRETE FLARED END SECTION 24", STD 542301, 1 EACH
 TRENCH BACKFILL, 29.2 CU YD

38 - STA 955+00.0 92.5' RT
 PIPE CULVERT, CS/A, TY 1, 42" Ø, 76'
 USFL = 612.84 (954+62.2, 92.5' RT)
 DSFL = 612.76 (955+38.2, 92.5' RT)

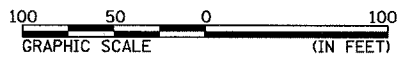

NE 1/4 SEC 12, T13N, R1E, 3RD PM

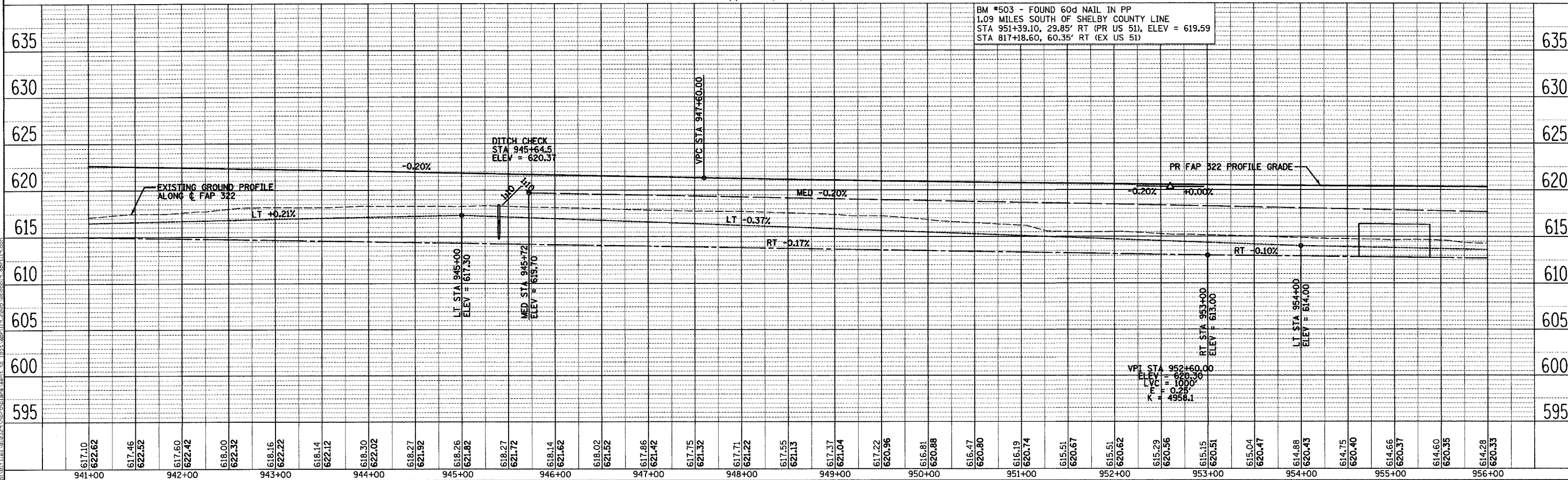

BM #503 - FOUND 60d NAIL IN PP
 1.09 MILES SOUTH OF SHELBY COUNTY LINE
 STA 951+39.10, 29.85' RT (PR US 51), ELEV = 619.59
 STA 817+18.60, 60.35' RT (EX US 51)

SURVEYED
 PLOTTED
 CHECKED
 RT. OF WAY CHECKED
 CAD FILE NAME
 NO.

PLUP ILL
 SURVEYED
 PLOTTED
 CHECKED
 RT. OF WAY CHECKED
 STRUCTURE NOTATION CHKD
 NO.

4/28/2005
 p:\01\1111\02023\chicago\work\1111_22005\066p049_sen1111.dwg
 REV: 4/19/04 - UNDERDRAINS - SLEB