

STATE OF ILLINOIS  
DEPARTMENT OF TRANSPORTATION

F.A.P. RTE.	SECTION	COUNTY	TOTAL SHEETS	SHEET NO.
322	11-1	CHRISTIAN	310	98
STA.		TO STA.		
FED. ROAD DIST. NO.	ILLINOIS	FED. AID PROJECT		

SE 1/4 SEC 1, T13 N, R1 E, 3RD PM

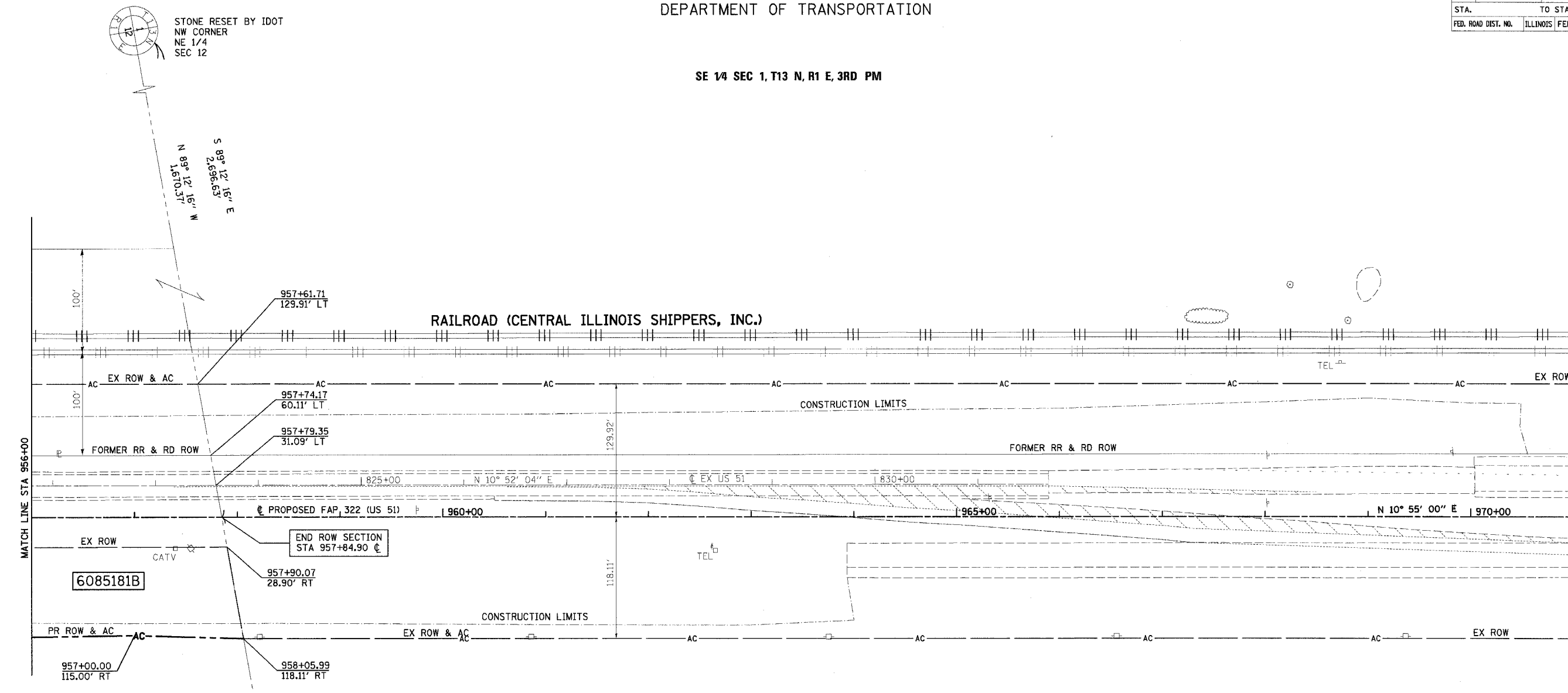

REMAINING AREA THIS SIDE = 217.895 ACRES

PARCEL NO 6085181A, & B  
T.E.-1, T.E.-2, T.E.-3, T.E.-4, & T.E.-5  
HUNTER FARMS, INC.  
FOR TABULATIONS SEE SHEET 17

NE 1/4 SEC 12, T13 N, R1 E, 3RD PM

CHRISTIAN COUNTY  
SHELBY COUNTY

FOUND STONE  
NE CORNER  
NE 1/4  
SEC 12

SE 1/4 SEC 1, T13 N, R1 E, 3RD PM

NOTES:  
BEARINGS ARE BASED ON THE ILLINOIS STATE PLANE  
COORDINATE SYSTEM, NAD83 1986 - WEST ZONE  
SURVEYED IN ENGLISH.

PLAT DISTANCES AND STATIONING ARE IN GRID ENGLISH.  
TO CONVERT TO GROUND DIVIDE BY GRID FACTOR.  
GRID FACTOR = 1.00003150

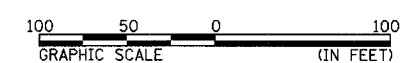

**RIGHT OF WAY PLANS**

ROUTE F.A.P. 322 (US 51)  
SECTION 11-1  
PROJECT  
COUNTY CHRISTIAN  
JOB NO. R-96-008-95  
STA 956+00 TO STA 970+00  
SCALE 1 = 50'

SHEET NO. 20 OF 24