

POINT	FAP 322 (US 51)		TR 151A		ELEVATION
	STATION	OFFSET	STATION	OFFSET	
A1	902+84.66	49.00' LT	9+30.17	120.23' RT	624.57
A2	902+98.74	49.57' LT	9+31.94	106.25' RT	624.52
A3	903+12.73	51.27' LT	9+32.58	92.18' RT	624.46
A4	903+26.54	54.08' LT	9+32.08	78.09' RT	624.37
A5	903+40.07	58.00' LT	9+30.45	64.10' RT	624.26
A6	903+53.25	63.00' LT	9+27.70	50.28' RT	624.14
A7	903+64.69	69.80' LT	9+22.89	37.88' RT	623.97
A8	903+73.92	79.36' LT	9+14.98	27.18' RT	623.78
A9	903+80.31	91.03' LT	9+04.53	18.95' RT	623.69
A10	903+83.40	103.97' LT	8+92.28	13.77' RT	623.72
A11	903+82.97	117.26' LT	8+79.09	12.00' RT	623.87

POINT	FAP 322 (US 51)		TR 151A		ELEVATION
	STATION	OFFSET	STATION	OFFSET	
E1	903+25.11	25.00' LT	9+60.52	84.31' RT	624.48
E2	903+67.54	15.55' LT	9+76.85	44.02' RT	624.20
E3	903+68.78	1.79' LT	9+90.64	45.08' RT	623.92
E4	903+22.44	13.00' RT	9+97.56	93.22' RT	624.24
E5	905+05.98	13.00' LT	10+00.96	92.11' LT	623.84
E6	904+59.77	1.69' RT	10+08.49	44.22' LT	623.71
E7	904+60.98	15.46' RT	10+22.28	43.33' LT	623.99
E8	905+03.61	25.00' RT	10+38.16	84.02' LT	624.08
E9	904+10.59	25.00' LT	9+74.65	CL	624.29
E10	904+18.61	25.00' RT	10+25.29	CL	624.27

POINT	FAP 322 (US 51)		TR 151A		ELEVATION
	STATION	OFFSET	STATION	OFFSET	
D1	903+43.04	61.00' RT	10+49.43	80.16' RT	624.20
D2	903+57.72	62.68' RT	10+53.32	65.90' RT	624.13
D3	903+71.64	67.63' RT	10+60.32	52.89' RT	624.00
D4	903+84.09	75.60' RT	10+70.08	41.79' RT	623.82
D5	903+94.41	86.18' RT	10+82.10	33.19' RT	623.59
D6	904+02.08	98.81' RT	10+95.75	27.52' RT	623.39
D7	904+10.86	119.38' RT	11+17.40	21.96' RT	623.10
D8	904+18.47	140.39' RT	11+39.33	17.61' RT	622.88
D9	904+24.91	161.81' RT	11+61.47	14.50' RT	622.68
D10	904+30.13	183.54' RT	11+83.75	12.63' RT	622.46
D11	904+34.13	205.54' RT	12+06.10	12.00' RT	622.22

POINT	FAP 322 (US 51)		TR 151A		ELEVATION
	STATION	OFFSET	STATION	OFFSET	
B1	903+92.72	204.26' LT	7+94.91	12.00' LT	623.18
B2	903+97.03	182.32' LT	8+17.26	12.63' LT	623.88
B3	904+02.56	160.66' LT	8+39.53	14.50' LT	624.10
B4	904+09.29	139.34' LT	8+61.67	17.61' LT	623.97
B5	904+17.20	118.43' LT	8+83.60	21.96' LT	623.67
B6	904+26.27	97.99' LT	9+05.26	27.52' LT	623.51
B7	904+34.00	85.61' LT	9+18.75	33.10' LT	623.54
B8	904+44.30	75.26' LT	9+30.65	41.55' LT	623.69
B9	904+56.65	67.47' LT	9+40.37	52.44' LT	623.82
B10	904+70.42	62.64' LT	9+47.42	65.22' LT	623.88
B11	904+84.92	61.00' LT	9+51.43	79.26' LT	623.89

POINT	FAP 322 (US 51)		TR 151A		ELEVATION
	STATION	OFFSET	STATION	OFFSET	
C1	904+44.78	116.57' RT	11+19.77	12.00' LT	623.19
C2	904+44.52	103.41' RT	11+06.72	13.73' LT	623.34
C3	904+47.70	90.64' RT	10+94.58	18.81' LT	623.48
C4	904+54.10	79.14' RT	10+84.18	26.88' LT	623.62
C5	904+63.28	69.71' RT	10+76.25	37.39' LT	623.76
C6	904+74.61	63.00' RT	10+71.33	49.60' LT	623.87
C7	904+87.78	58.00' RT	10+68.39	63.38' LT	623.94
C8	905+01.32	54.08' RT	10+66.57	77.35' LT	623.99
C9	905+15.13	51.27' RT	10+65.87	91.42' LT	624.01
C10	905+29.11	49.57' RT	10+66.31	105.51' LT	624.02
C11	905+43.19	49.00' RT	10+67.88	119.51' LT	624.00

F.A.P. RTE.	SECTION	COUNTY	TOTAL SHEETS	SHEET NO.
322	11-10	CHRISTIAN	310	108
STA.		TO STA.		
FED. ROAD DIST. NO.		ILLINOIS FED. AID PROJECT		

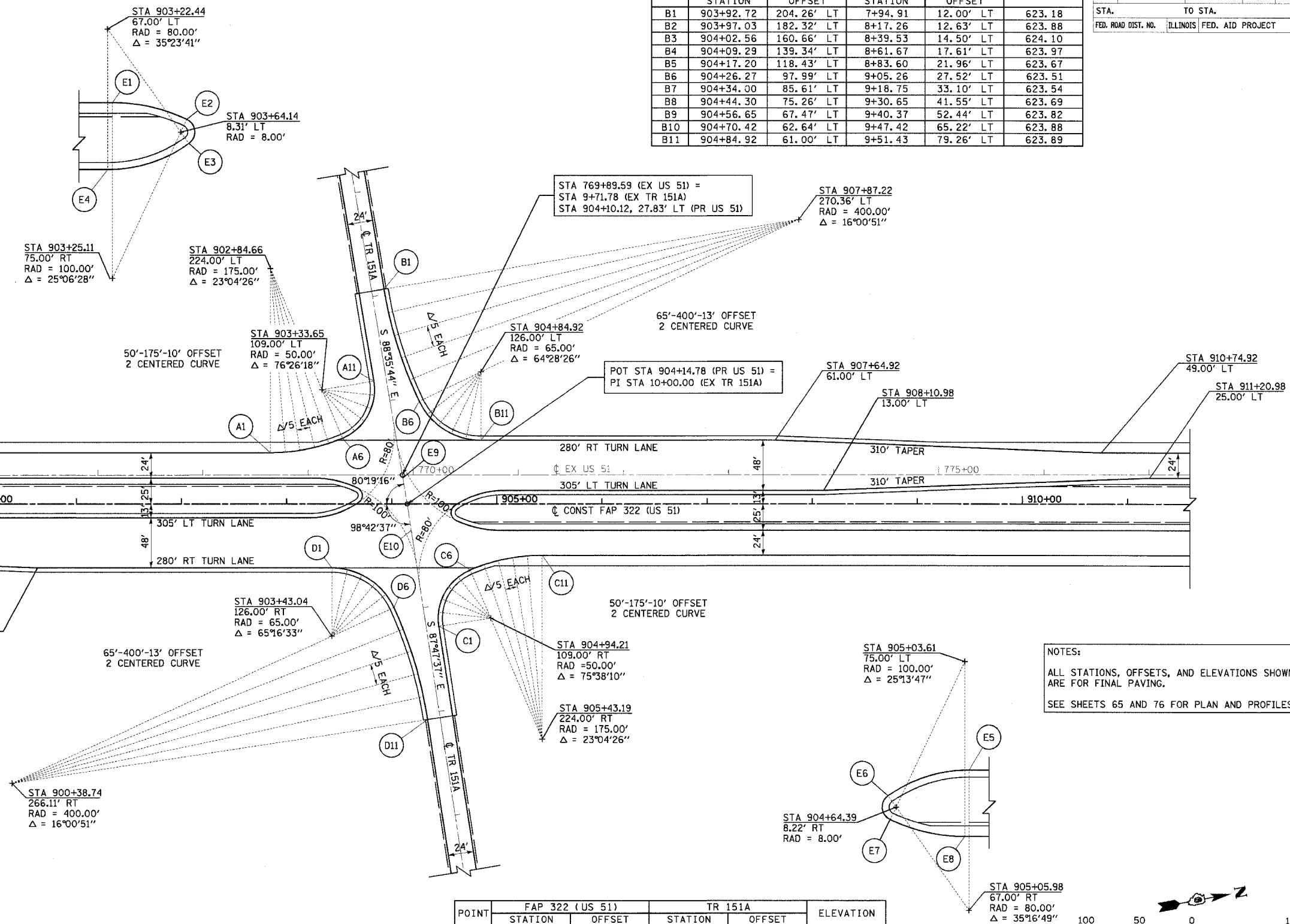

NOTES:  
 ALL STATIONS, OFFSETS, AND ELEVATIONS SHOWN ARE FOR FINAL PAVING.  
 SEE SHEETS 65 AND 76 FOR PLAN AND PROFILES.

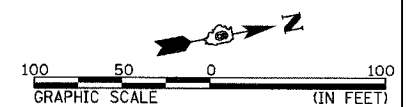

ILLINOIS DEPARTMENT OF TRANSPORTATION  
 GEOMETRIC DETAILS  
 TR 151A  
 FAP 322 (US 51)  
 SECTION 11-1  
 CHRISTIAN COUNTY

SCALE: 1"=50'  
 DATE: 3/18/05

DRAWN BY: BGJ  
 CHECKED BY: SEB

REVISIONS	
NAME	DATE

3/29/2005