

FAP ETL	SECTION	COUNTY	TOTAL SHEETS	SHEET NO.
332	(1012)W,RS	WHITE/EDWARDS	198	35
FED. ROAD DIST. NO. 7		ILLINOIS	FED. AID PROJECT NO.	

CONTRACT NO. 94652

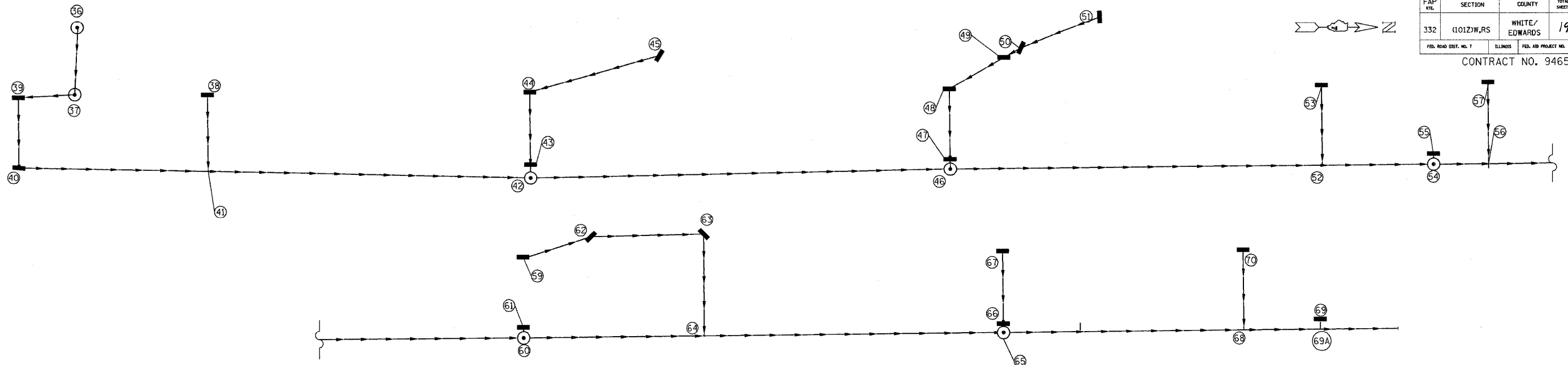

PIPE SCHEDULE								
PT. TO PT.	RG TYPE 1 15 in	RG TYPE 2 15 in	TYPE 2 15 in	TYPE 2 18 in	RG TYPE 2 21 in	TYPE 2 21 in	TYPE 2 27 in	TRENCH BACKFILL
	FT	FT	FT	FT	FT	FT	FT	CU YD
36 - 37	24.2							2.9
37 - 39		18.9						3.4
39 - 40			25.4					6.9
40 - 41			75.9					24.0
38 - 41			30.7					8.0
41 - 42			131.2					40.0
45 - 44	49.4							6.0
44 - 43			25.8					4.9
43 - 42			2.0					0.5
42 - 46			169.6					51.7
51 - 50	32.3							3.9
50 - 49		5.1						0.6
49 - 48			21.8					2.6
48 - 47			25.8					4.6
47 - 46			2.0					0.5
46 - 52			151.7					41.1
53 - 52			33.8					6.1
52 - 54			44.1					9.9
55 - 54			2.6					0.4
54 - 56				20.6				4.2
57 - 56			33.7					5.2
56 - 60				155.2				31.8
61 - 60			2.6					0.4
60 - 64					72.8			16.0
59 - 62		26.0						4.9
62 - 63		43.2						6.2
63 - 64		40.7						6.3
64 - 65						121.0		33.3
67 - 66			26.9					5.7
66 - 65			2.1					0.6
65 - 68							95.5	32.7
70 - 68			33.8					8.4
68 - 69A							31.2	11.7
69 - 69A			4.0					1.1
69A - 71							42.2	16.5
TOTAL	111.0	150.6	823.7	175.8	72.8	121.0	168.9	403.0

SCHEDULE OF DRAINAGE STRUCTURES									
PT	LOCATION STATION	OFFSET	DESCRIPTION	LID OR GRATE	INLET INVERT	INLET INVERT	OUTLET INVERT	SYM	
36	22+23.7	41.6' LT.	EXISTING MANHOLE - ADJUST LID	ADJUST	EXISTING	-	426.59 (E)	⊙	
37	22+22.5	15' LT.	MH TY A 4' DIA T1FCL	427.98	424.98 (W)	-	424.78 (S)	⊙	
38	22+76	14.5' LT.	INLET TY A T3F&G	426.24	-	-	422.43 (E)	■	
39	22+00	14.5' LT.	MH TY A 4' DIA T3F&G	428.29	424.41 (N)	-	424.21 (E)	⊙	
40	22+00	14.5' RT.	MH TY A 4' DIA T3F&G	428.29	423.81 (W)	-	423.61 (N)	⊙	
41	22+76	16.5' RT.	PIPE TEE 15P 15R	-	421.76 (S)	421.76 (W)	421.76 (N)	T	
42	24+06	20' RT.	MH TY A 4' DIA T1FCL	423.09	418.56 (S)	418.66 (W)	418.36 (N)	⊙	
43	24+06	14.5' RT.	INLET TY B T3F&G	422.50	418.80 (W)	-	418.70 (E)	■	
44	24+06	14.5' LT.	MH TY A 4' DIA T3F&G	422.50	419.16 (N)	-	419.06 (E)	⊙	
45	14+62	26.3' LT.	INLET TY A T10F&G	421.59	-	-	419.32 (S)	■	
46	15+80	20' RT.	MH TY A 4' DIA T1FCL	418.19	413.74 (S)	413.82 (W)	413.62 (N)	⊙	
47	15+80	14.5' RT.	INLET TY B T3F&G	417.60	413.96 (W)	-	413.86 (E)	■	
48	15+80	14.5' LT.	MH TY A 4' DIA T3F&G	417.60	414.41 (W)	-	414.21 (E)	⊙	
49	16+02	26.3' LT.	INLET TY B T10F&G	417.56	414.83 (N)	-	414.73 (S)	■	
50	16+09	30' LT.	INLET TY B T3F&G	418.06	415.03 (N)	-	414.93 (S)	■	
51	16+41	42' LT.	INLET TY A T3F&G	418.06	-	-	415.66 (S)	■	
52	17+30	20' RT.	PIPE TEE 15P 15R	-	409.92 (S)	409.92 (W)	409.92 (N)	T	
53	17+30	14.5' LT.	INLET TY A T3F&G	413.28	-	-	410.25 (E)	■	
54	17+75	20' RT.	MH TY A 4' DIA T1FCL	412.59	408.84 (S)	408.94 (W)	408.74 (N)	⊙	
55	17+75	14.5' RT.	INLET TY A T3F&G	412.00	-	-	408.99 (E)	■	
56	17+97	20' RT.	PIPE TEE 18P 15R	-	408.18 (S)	408.31 (W)	408.18 (N)	T	
57	17+97	14.5' LT.	INLET TY A T3F&G	411.35	-	-	408.64 (E)	■	
58			THIS POINT HAS BEEN ELIMINATED						
59	19+50	14.5' LT.	INLET TY A T3F&G	407.52	-	-	403.66 (N)	■	
60	19+50	20' RT.	MH TY A 4' DIA T1FCL	407.72	403.95 (S)	404.05 (W)	403.85 (N)	⊙	
61	19+50	14.5' RT.	INLET TY A T3F&G	407.13	-	-	404.10 (E)	■	
62	19+77	22.5' LT.	INLET TY B T3F&G	406.67	403.40 (S)	-	403.20 (N)	■	
63	20+23	22.5' LT.	MH TY A 4' DIA T3F&G	405.52	402.77 (S)	-	402.67 (E)	⊙	
64	20+23	20' RT.	PIPE TEE 21P 15R	-	402.22 (S)	402.47 (W)	402.22 (N)	T	
65	21+43	20' RT.	MH TY A 4' DIA T1FCL	403.75	398.95 (S)	399.05 (W)	398.85 (N)	⊙	
66	21+43	14.5' RT.	INLET TY B T3F&G	403.24	399.20 (W)	-	399.10 (E)	■	
67	21+43	14.5' LT.	INLET TY A T3F&G	403.24	-	-	399.60 (E)	■	
68	22+40	20' RT.	PIPE TEE 27P 15R	-	398.37 (S)	398.87 (W)	398.37 (N)	T	
69	22+71	14.5' RT.	INLET TY A T3F&G	402.72	-	-	398.75 (E)	■	
69A	22+71	20' RT.	PIPE TEE 27P 15R	-	398.21 (S)	398.71 (W)	398.21 (N)	T	
70	22+40	14.5' LT.	INLET TY A T3F&G	402.72	-	-	399.21 (E)	■	

c:\projects\94652\d02101pa.dgn  
stefjenmk\DATE

REVISIONS		ILLINOIS DEPARTMENT OF TRANSPORTATION
NAME	DATE	
		<b>STORM SEWER</b>  SCALE: VERT. _____ HORIZ. _____ DATE _____

DRAWN BY \_\_\_\_\_  
CHECKED BY \_\_\_\_\_