

1 2 3 4 5 6 7 8 9 10/26/2004
 10 11 12 13 14 15 16 17 18
 19 20 21 22 23 24 25 26 27
 28 29 30 31 32 33 34 35 36
 37 38 39 40 41 42 43 44 45
 46 47 48 49 50 51 52 53 54
 55 56 57 58 59 60 61 62 63

PROJECT ENGINEER : MARK DAUCHERTY
 SQUAD LEADER :
 DESIGNER : MATT HIRTZEL
 TELEPHONE : 217/342-3951 EX 313

SEE SHEET NUMBER 2
 FOR INDEX OF SHEETS

STATION EQUATIONS
 STA. 717+34.17 BK = STA. 717+12.79 AH
 STA. 820+40.90 BK = STA. 820+41.17 AH

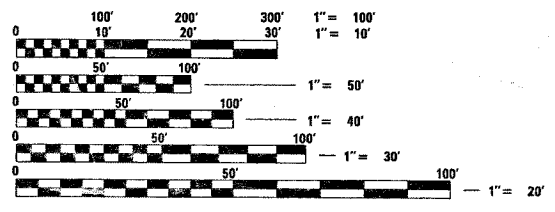

FULL SIZE PLANS HAVE BEEN PREPARED USING STANDARD
 ENGINEERING SCALES, REDUCED SIZED PLANS WILL NOT
 CONFORM TO STANDARD SCALES, IN MAKING MEASUREMENTS
 ON REDUCED PLANS, THE ABOVE SCALES MAY BE USED.

J.U.L.I.E.
 JOINT UTILITY LOCATION INFORMATION FOR EXCAVATION
 1-800-892-0123

CONTRACT NO. 94866
 TOWNSHIP : PATOKA, CARRIGAN

ADT = 2850

GROSS LENGTH = 12844 FEET = 2.43 MILES
 NET LENGTH = 12844 FEET = 2.43 MILES

SEAL

STATE OF ILLINOIS
 DEPARTMENT OF TRANSPORTATION
 DIVISION OF HIGHWAYS
**PLANS FOR PROPOSED
 FEDERAL HIGHWAY PROJECT**
 FAP ROUTE 322 (US ROUTE 51)
 SECTION 26RS-2
 PROJECT: NHF-0322(072)
 MARION COUNTY
 BITUMINOUS RESURFACING

C-97-051-04

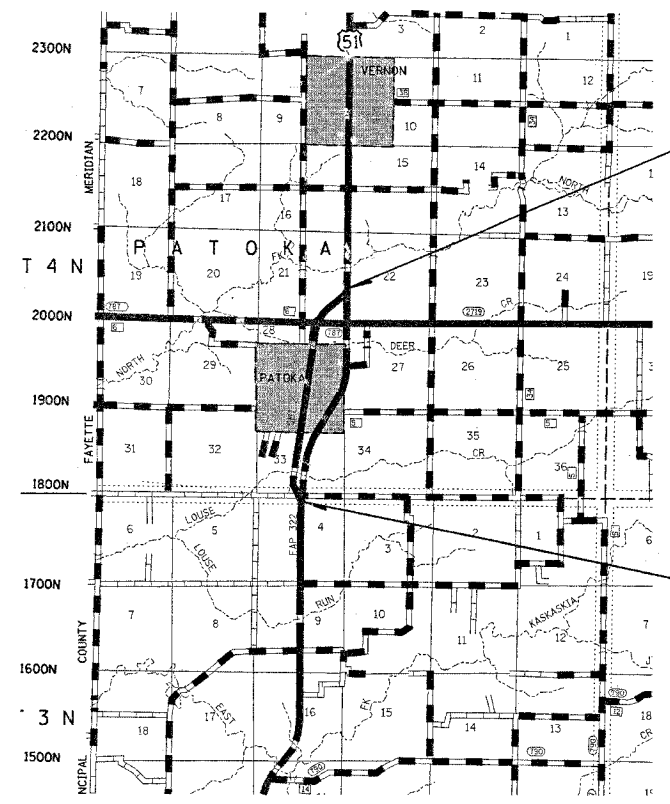

FAP ROUTE 322 (US ROUTE 51)
 SECTION 26RS-2
 MARION COUNTY
 BEGINS STA. 708+13.00

FAP ROUTE 322 (US ROUTE 51)
 SECTION 26RS-2
 MARION COUNTY
 ENDS STA. 836+36.00

FAP RTE.	SECTION	COUNTY	TOTAL SHEETS	SHEET NO.
322	26RS-2	MARION	18	1

D-97-022-04

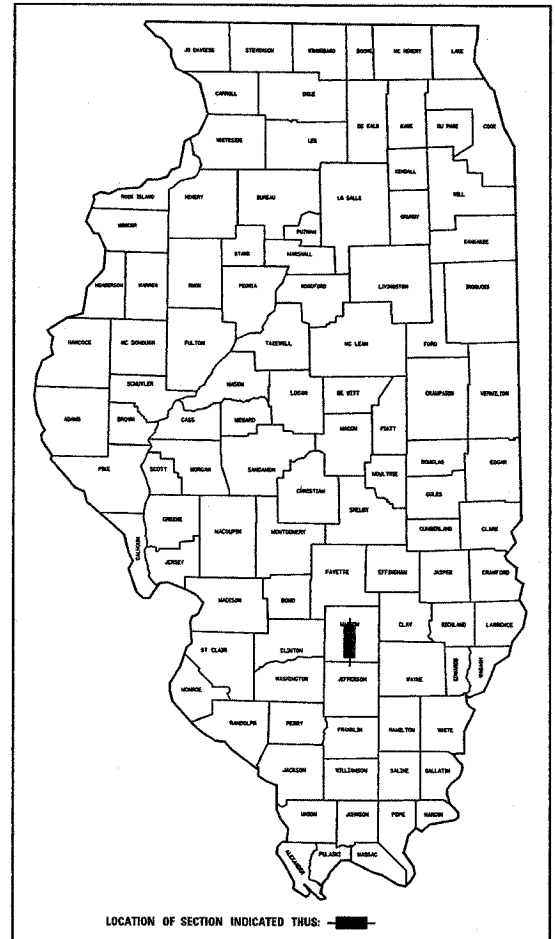

STATE OF ILLINOIS
 DEPARTMENT OF TRANSPORTATION
 DIVISION OF HIGHWAYS

SUBMITTED 10/27 20 04
Stacy E. ... DISTRICT ENGINEER

ENGINEER OF PROJECT DEVELOPMENT AND IMPLEMENTATION
May 13, 20 05
Mike Hine
 ENGINEER OF DESIGN AND ENVIRONMENT

May 13, 20 05
Victor Moden
 DIRECTOR, DIVISION OF HIGHWAYS

PRINTED BY THE AUTHORITY OF
 THE STATE OF ILLINOIS

94866