

| F.A.S. | SECTION | COUNTY | TOTAL SHEETS | SHEET NO. |
|-----------------------|----------------|----------|--------------|-----------|
| 878 | 01-00090-00-RS | HAMILTON | 4 | 1 |
| FED. ROAD DIST. NO. 7 | | ILLINOIS | ADEN ROAD | |
| LEC JOB # H04IL013HM | | | | |
| CONTRACT NO. 95426 | | | | |

STATE OF ILLINOIS
DEPARTMENT OF TRANSPORTATION
DIVISION OF HIGHWAYS
PLANS FOR PROPOSED
FEDERAL-AID SECONDARY PROJECT
F.A.S. 878 (CH12) SECTION 01-00090-00-RS HAMILTON COUNTY
PROJECT RS-878(103) JOB NO. C-97-024-05

INDEX OF SHEETS

| SHEET NO. | DESCRIPTION |
|-----------|--|
| 1 | TITLE SHEET |
| 2 | TYPICAL SECTIONS, SUMMARY OF QUANTITIES, GENERAL NOTES, MISCELLANEOUS DETAILS |
| 3-4 | DETAILS OF INTERSECTIONS, SIDEROADS, AND SCHEDULES |

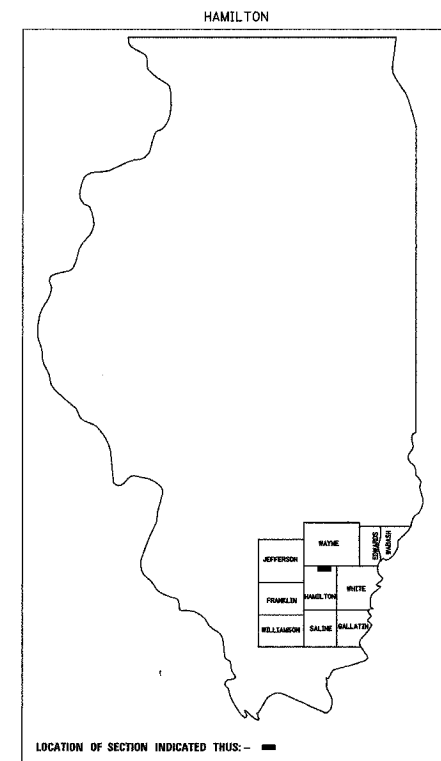

323 W. 3RD ST.
 P.O. BOX 160
 MT. CARMEL, IL
 62863
 PHONE:
 (618)-262-8651
 FAX:
 (618)-263-3327

405 W. STATE ST.
 SUITE 1
 PRINCETON, IN
 47370
 PHONE:
 (812)-386-7611
 FAX:
 (812)-385-2812



PROFESSIONAL
 DESIGN FIRM
 LAND SURVEY &
 PROFESSIONAL
 ENGINEERING
 CORPORATION
 184-00087
 (62-032435)/(35-002769)

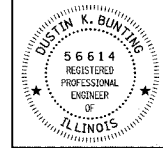

DUSTIN K. BUNTING
 NAME
 SIGNATURE
 DATE 03-07-05
 EXPIRES 11-30-05

THE FOLLOWING STANDARDS ARE A PART OF THESE PLANS AND ARE INCLUDED AFTER SHEET NO. 4

| | |
|-----------|---|
| 000001-04 | STANDARD SYMBOLS, ABBREVIATIONS & PATTERNS |
| 701006-02 | OFF-RD OPERATIONS, 2L, 2W, 4.5 m (15') TO 600 mm (24") AWAY, FOR SPEEDS ≥ 45 MPH |
| 701301-02 | LANE CLOSURE, 2L, 2W, SHORT TIME OPERATIONS |
| 701306-01 | LANE CLOSURE, 2L, 2W, SLOW MOVING OPERATIONS DAY ONLY FOR SPEEDS ≥ 45 MPH |
| 701311-02 | LANE CLOSURE, 2L, 2W, MOVING DAY ONLY OPERATIONS |
| 702001-05 | TRAFFIC CONTROL DEVICES |
| 780001-01 | TYPICAL PAVEMENT MARKINGS |

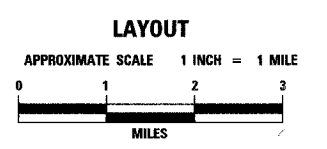
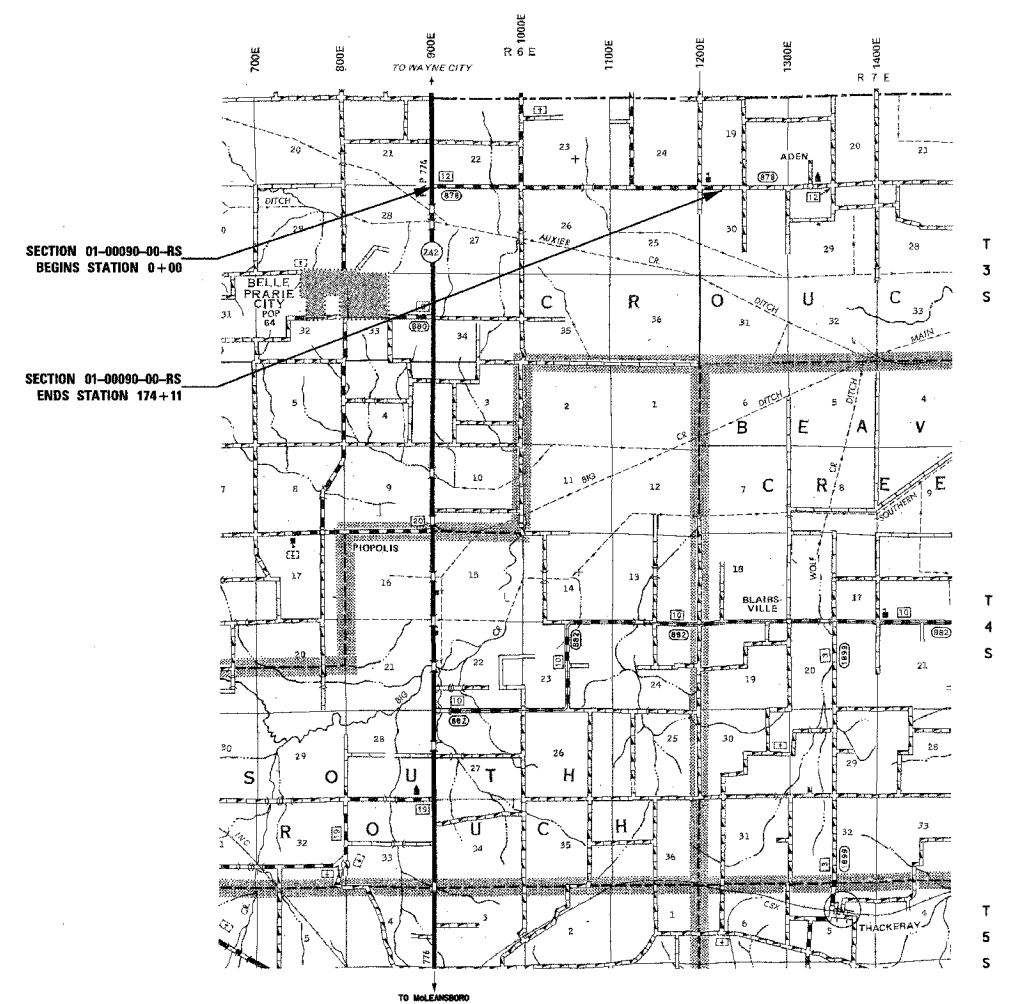

| | | |
|--------------|--------------|--------------|
| GROSS LENGTH | 17,411.00 FT | 3.2975 MILES |
| OMISSION | 00.00 FT | 0.0000 MILES |
| NET LENGTH | 17,411.00 FT | 3.2975 MILES |

CONTRACT NO. 95426
 DESIGN CLASS - MAJOR COLLECTOR
 CURRENT A.D.T. = 275
 DESIGN SPEED = 50 MPH

J.U.L.I.E.
JOINT UTILITY LOCATION INFORMATION FOR EXCAVATION
1-800-892-0123

THE ACCEPTANCE OF THIS PROJECT IS BASED
 ON THE MINIMUM DESIGN CRITERIA FOR A
 FEDERAL-AID L.A.P.P. TYPE IMPROVEMENT ON
 THE COUNTY HIGHWAY SYSTEM.

Maurice Kastl
 DISTRICT ENGINEER OF LOCAL ROADS & STREETS

| STATE OF ILLINOIS DEPARTMENT OF TRANSPORTATION | |
|---|------------|
| PASSED | 4/11 20 05 |
| <i>Maurice Kastl</i> DISTRICT ENGINEER OF LOCAL ROADS & STREETS | |
| APPROVED | 4/11 20 05 |
| <i>Christina K. Reed</i> DEPUTY DIRECTOR OF HIGHWAYS / REGION 4 ENGINEER | |

PLANS
 REVIEWED & APPROVED
Kenn Phillips
 COUNTY ENGINEER
 DATE 3-8-05

**TYPICAL CROSS SECTION
EXISTING**

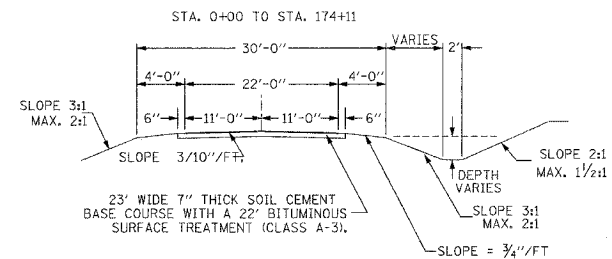

**TYPICAL CROSS SECTION
PROPOSED**

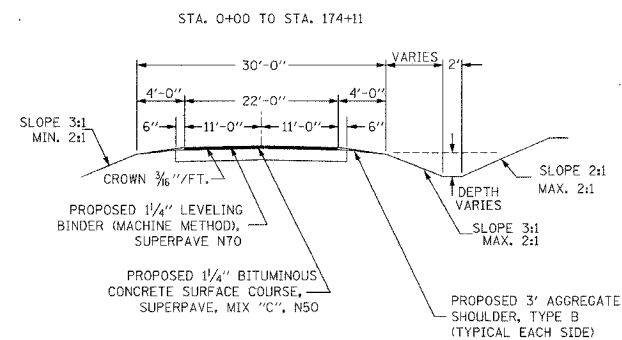

GENERAL NOTES:

THIS SECTION CONSISTS OF LEV BIND MM SUPER N70, BC SC SUPER C N50, AGGREGATE SHOULDERS, AND OTHER MISCELLANEOUS ITEMS NECESSARY TO COMPLETE THE PROJECT, ALL IN ACCORDANCE WITH THE PLANS, SPECIAL PROVISIONS AND "STANDARD SPECIFICATIONS FOR ROAD AND BRIDGE CONSTRUCTION" ADOPTED JANUARY 1, 2002.

THE EXISTING GRADE, ALIGNMENT, DRAINAGE STRUCTURES, BASE AND SURFACE WERE CONSTRUCTED UNDER SECTION 77-00049-00-SC AND SHALL REMAIN IN PLACE. ALL STATIONS REFERRED TO IN THE PLANS AND PROPOSAL ARE REFERENCED TO THE ABOVE MENTIONED SECTION.

| | |
|---------------------------------|---------|
| MAXIMUM PERCENT OF GRADE | +4.36 % |
| MINIMUM STOPPING SIGHT DISTANCE | 400 FT |
| DESIGN SPEED | 50 MPH |
| CURRENT ADT | 275 VPD |
| DESIGN ADT (20 YEAR) | 325 VPD |

THE BC SC SUPER C N50 SHALL BE PLACED IN ONE LIFT WITH A MINIMAL THICKNESS OF 1 1/4".

THE QUANTITY SHOWN IN THE SUMMARY OF QUANTITIES FOR BC SC SUPER C N50 ALLOWS 131.8 TON FOR THE TAPERS ON THE MAINLINE AND THE SIDEROADS, 94.4 TON FOR THE ENTRANCES, 32.3 TON FOR THE MAILBOX TURNOUTS, AND 2962.1 TON FOR THE 1" BC SC SUPER C N50.

CONSTRUCT BITUMINOUS TAPER OF 1/4" TO 0" FROM STATION 173+61 TO BEGINNING STATION 174+11.

UNPAVED AREAS WILL BE PREPARED ACCORDING TO ARTICLE 406.19 OF THE "STANDARD SPECIFICATIONS FOR ROAD AND BRIDGE CONSTRUCTION" ADOPTED JANUARY 1, 2002.

THE FOLLOWING RATES HAVE BEEN USED TO CALCULATE PLAN QUANTITIES:

| | |
|----------------------------------|-------------------------|
| AGGREGATE SHOULDERS TY. B | 1.8 T / CU YD |
| BITUMINOUS CONCRETE | 0.0560 T / SQ YD / INCH |
| AGGREGATE PRIME COAT | 0.001 T / SQ YD |
| BITUMINOUS MATERIAL (PRIME COAT) | 0.05 GAL / SQ YD |

SUMMARY OF QUANTITIES

| QUANTITY | UNIT | ITEM | 1000 CODE NUMBER |
|----------|--------|---|------------------|
| 2176.00 | GALLON | BITUMINOUS MATERIALS (PRIME COAT) | 40600100 |
| 44.00 | TON | AGGREGATE (PRIME COAT) | 40600300 |
| 4789.00 | TON | LEVELING BINDER (MACHINE METHOD), SUPERPAVE N70 | X4066770 |
| 3221.00 | TON | BITUMINOUS CONCRETE SURFACE COURSE, SUPERPAVE, MIX "C", N50 | X4066414 |
| 178.00 | SQ YD | BITUMINOUS SURFACE REMOVAL - BUTT JOINT | 40600980 |
| 44.00 | SQ YD | TEMPORARY RAMP | 40600990 |
| 1750.00 | TON | AGGREGATE SHOULDERS, TYPE B | 48101200 |
| 1.00 | L SUM | TRAFFIC CONTROL AND PROTECTION STANDARD 701306 | 70100460 |
| 5223.00 | FOOT | SHORT-TERM PAVEMENT MARKING | 70300100 |
| 58982.00 | FOOT | PAINT PAVEMENT MARKING-LINE 4" | 78001100 |
| 1741.00 | FOOT | SHORT-TERM PAVEMENT MARKING REMOVAL | XX003140 |

323 W. 3RD ST.
P.O. BOX 160
MT. CARMEL, IL
62863
PHONE:
(618)-262-8651
FAX:
(618)-263-3327

405 W. STATE ST.
SUITE 1
PRINCETON, IN
47570
PHONE:
(812)-386-7611
FAX:
(812)-385-2812



PROFESSIONAL DESIGN FIRM
LAND SURVEY & PROFESSIONAL ENGINEERING CORPORATION
184-000887
(62-032435)(35-002769)

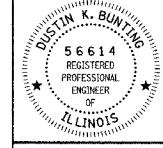

DUSTIN K. BUNTING
NAME
SIGNATURE
DATE 03-07-05
11-30-05
EXPIRES

DETAIL OF PRIVATE AND FIELD ENTRANCES

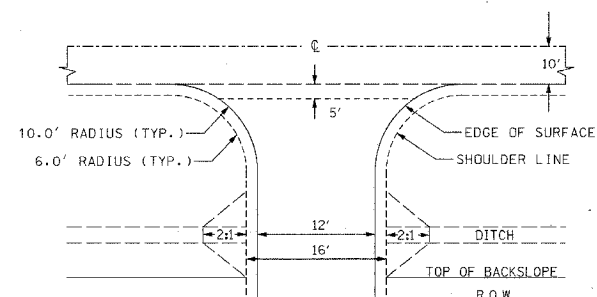

NOTE: THE 5' AREA FROM THE EDGE OF SURFACE, AS SHOWN ABOVE, SHALL BE BC SC SUPER C N50 FOR THE PRIVATE ENTRANCES AND THE FIELD ENTRANCES. THIS QUANTITY IS INCLUDED IN THE QUANTITY FOR BC SC SUPER C N50.

PRIVATE & FIELD ENTRANCE APPROACH DETAIL

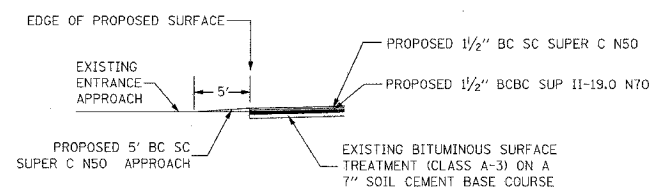

SCHEDULE OF PRIVATE AND FIELD ENTRANCES

| STATION | LOCATION | BC SC SUPER "C" N50 TONS |
|---------|----------|--------------------------|
| 13+03 | LT | 2.1 |
| 13+55 | RT | 1.9 |
| 23+00 | RT | 3.6 |
| 26+50 | LT | 2.2 |
| 26+90 | RT | 1.8 |
| 28+46 | LT | 2.3 |
| 28+75 | RT | 1.4 |
| 33+43 | RT | 3.0 |
| 35+14 | RT | 1.6 |
| 35+88 | LT | 1.6 |
| 40+08 | RT | 1.3 |
| 45+67 | RT | 2.1 |
| 64+12 | RT | 2.3 |
| 64+82 | LT | 1.6 |
| 66+87 | RT | 1.7 |
| 68+88 | LT | 1.4 |
| 71+96 | LT | 2.2 |
| 80+01 | RT | 2.1 |
| 80+16 | LT | 1.9 |
| 99+11 | LT | 1.9 |
| 106+00 | LT | 1.8 |
| 106+02 | RT | 2.3 |
| 117+25 | RT | 1.9 |
| 119+82 | RT | 2.7 |
| 120+74 | LT | 2.1 |
| 122+15 | RT | 1.9 |
| 123+65 | RT | 2.1 |
| 126+69 | RT | 2.1 |
| 126+80 | LT | 2.4 |
| 133+46 | LT | 2.1 |
| 133+63 | RT | 3.1 |
| 136+33 | LT | 2.1 |
| 141+02 | LT | 2.7 |
| 146+99 | RT | 1.6 |
| 147+59 | LT | 1.9 |
| 157+84 | LT | 9.9 |
| 158+20 | RT | 2.3 |
| 160+02 | LT | 1.6 |
| 165+17 | LT | 3.5 |
| 168+39 | RT | 1.9 |
| 173+69 | LT | 2.2 |
| | TOTAL | 94.4 |

THE ABOVE QUANTITY IS INCLUDED IN THE BC SC SUPER C N50 IN THE SUMMARY OF QUANTITIES.

SCHEDULE OF MAILBOX TURNOUTS

| STATION | LOCATION | EST. QUANTITY ALLOWED TONS |
|---------|----------|----------------------------|
| 22+72 | RT. | 2.3 |
| 28+19 | LT | 4.0 |
| 33+19 | RT. | 2.4 |
| 46+11 | RT. | 3.4 |
| 53+27 | RT. | 2.8 |
| 69+20 | LT. | 3.5 |
| 118+83 | LT. | 3.6 |
| 123+65 | LT. | 2.7 |
| 140+36 | LT. | 3.0 |
| 160+35 | LT. | 2.7 |
| 160+37 | LT. | |
| 164+90 | LT. | 1.9 |
| | TOTAL | 32.3 |

THE ABOVE QUANTITY IS INCLUDED IN THE BC SC SUPER C N50 IN THE SUMMARY OF QUANTITIES.

UTILITIES

J.U.L.I.E.
800-892-0123

TYPICAL DETAILS OF SURFACING
AT SIDEROADS AND INTERSECTIONS

| | | | | |
|-----------------------|----------------|----------|--------------|--------------------|
| F.A.S. | SECTION | COUNTY | TOTAL SHEETS | SHEET NO. |
| B78 | 01-00090-00-RS | HAMILTON | 4 | 3 |
| FED. ROAD DIST. NO. 7 | | ILLINOIS | | ADEN ROAD |
| LEC JOB # H041L013HM | | | | CONTRACT NO. 95426 |

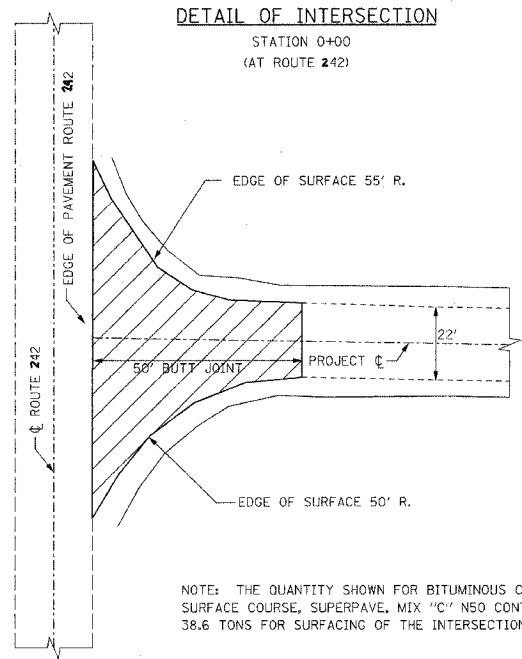

NOTE: THE QUANTITY SHOWN FOR BITUMINOUS CONCRETE SURFACE COURSE, SUPERPAVE, MIX "C", N50 CONTAINS 38.6 TONS FOR SURFACING OF THE INTERSECTION.

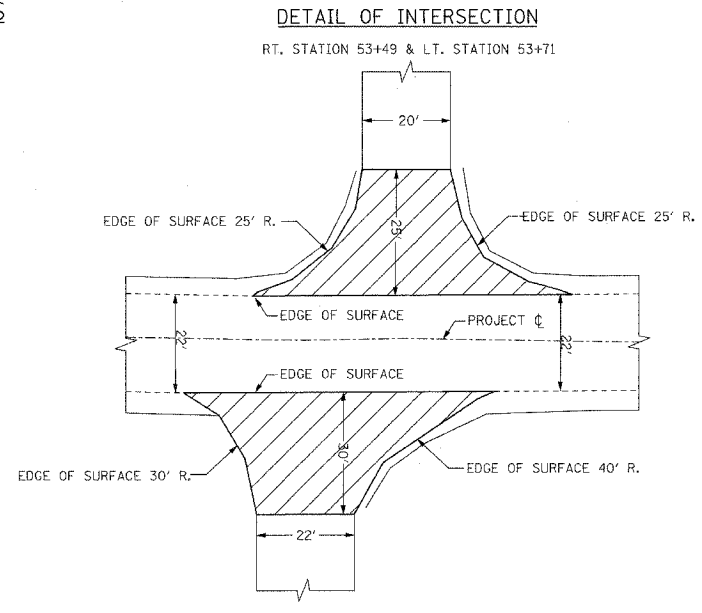
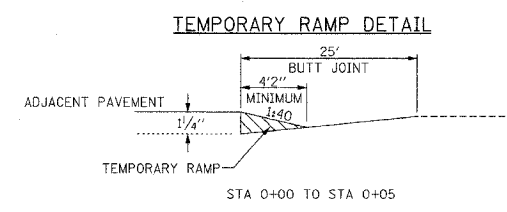
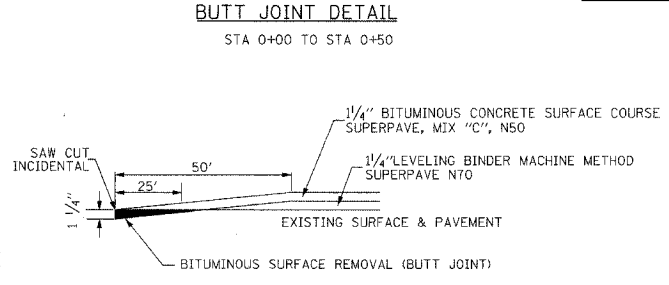

NOTE: THE QUANTITY SHOWN FOR BITUMINOUS CONCRETE SURFACE COURSE, SUPERPAVE, MIX "C", N50 INCLUDES 16.5 TONS OF MATERIAL FOR THE SIDEROAD LT. APPROACH AND RADII AND 18.1 TONS OF MATERIAL FOR THE SIDEROAD RT. APPROACH AND RADII.

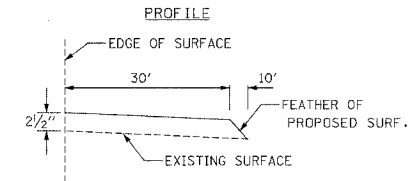
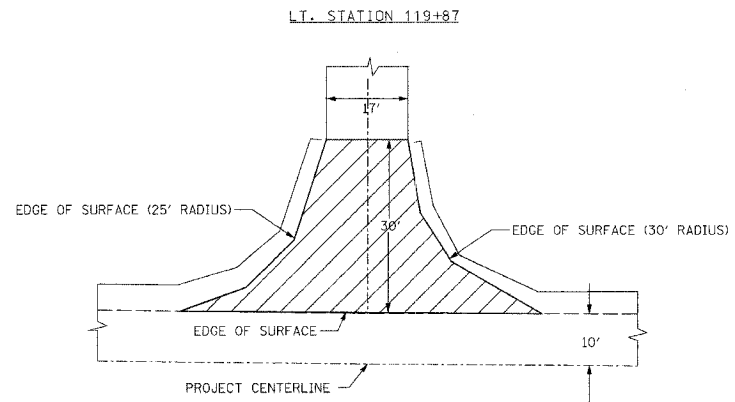
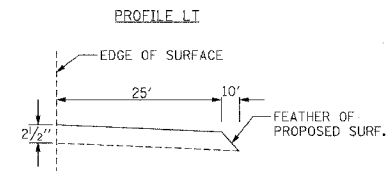
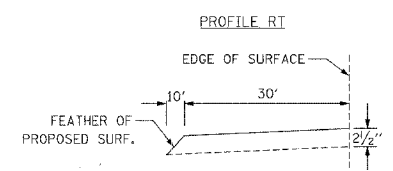

NOTE: THE QUANTITY SHOWN FOR BC SC SUPER C N50 INCLUDES 20.0 TONS OF MATERIAL FOR THE SIDEROAD APPROACH AND RADII.

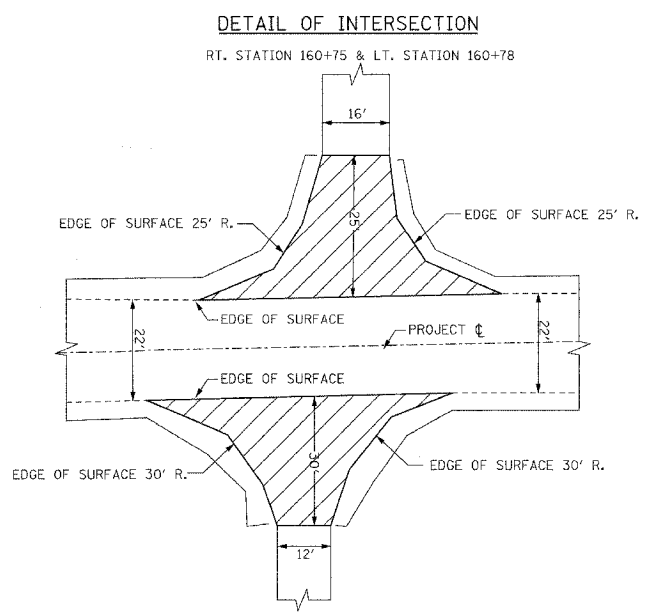

NOTE: THE QUANTITY SHOWN FOR BITUMINOUS CONCRETE SURFACE COURSE, SUPERPAVE, MIX "C", N50 INCLUDES 15.5 TONS OF MATERIAL FOR THE SIDEROAD LT. APPROACH AND RADII AND 14.3 TONS OF MATERIAL FOR THE SIDEROAD RT. APPROACH AND RADII.

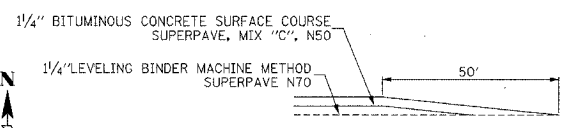
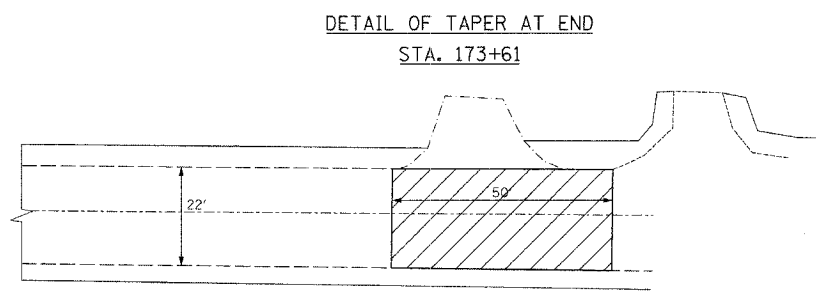
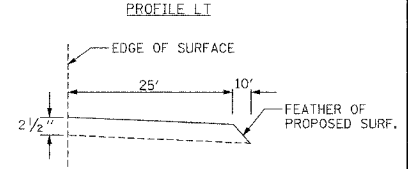
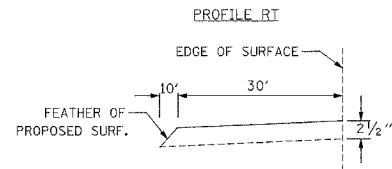

NOTE: TAPER PROPOSED BITUMINOUS CONCRETE SURFACE COURSE, SUPERPAVE, MIX "C", N50 FROM 1/4" THICK AT STA. 173+61 TO 0" THICK AT STA. 174+11

THE QUANTITY SHOWN FOR BITUMINOUS CONCRETE SURFACE COURSE, SUPERPAVE, MIX "C", N50 IN THE SUMMARY OF QUANTITIES INCLUDES 8.8 TON OF MATERIAL FOR THE TAPER.

323 W. 3RD ST.
P.O. BOX 160
MT. CARMEL, IL
62863
PHONE:
(618)-262-8651
FAX:
(618)-263-3327

405 W. STATE ST.
SUITE 1
PRINCETON, IN
47670
PHONE:
(812)-386-7611
FAX:
(812)-385-2812



PROFESSIONAL
DESIGN FIRM
LAND SURVEY &
PROFESSIONAL
ENGINEERING
CORPORATION
184-00887
(62-032435)(35-002769)



DUSTIN K. BUNTING
NAME
SIGNATURE
08-07-05
DATE
11-30-05
EXPIRES

| F.A.S. | SECTION | COUNTY | TOTAL SHEETS | SHEET NO. |
|-----------------------|----------------|----------|--------------|-----------|
| 878 | 01-00090-00-RS | HAMILTON | 4 | 4 |
| FED. ROAD DIST. NO. 7 | | ILLINOIS | ADEN ROAD | |
| LEC JOB # HQ4IL013HM | | | | |
| CONTRACT NO. 95426 | | | | |

SCHEDULE OF PAVEMENT MARKINGS

| STATION | TO | STATION | LOCATION | LENGTH - FOOT |
|-------------|----|---------|----------|---------------|
| CENTERLINE | | | | |
| 0+00 | | 174+11 | | 2435 |
| EDGE LINE | | | | |
| 0+00 | | 53+23 | RT. | 5323 |
| 53+91 | | 160+54 | RT. | 10663 |
| 160+96 | | 174+11 | RT. | 1315 |
| EDGE LINE | | | | |
| 0+00 | | 53+48 | LT. | 5348 |
| 53+94 | | 119+66 | LT. | 6572 |
| 120+10 | | 160+57 | LT. | 4047 |
| 160+98 | | 174+11 | LT. | 1313 |
| NO. PASSING | | | | |
| 10+65 | | 56+20 | RT. | 4555 |
| 95+00 | | 163+50 | RT. | 6850 |
| 25+50 | | 74+50 | LT. | 4900 |
| 117+50 | | 174+11 | LT. | 5661 |
| | | | | TOTAL |
| | | | | 58982 |

THE ABOVE QUANTITY IS INCLUDED IN PAINT PAVEMENT MARKING-LINE 4" IN THE SUMMARY OF QUANTITIES.

SCHEDULE OF AGGREGATE SHOULDER STONE IN TANGENT

| STATION | TO | STATION | LOCATION | ALLOWED TONS EST. QUANTITY |
|----------|----|----------|----------|----------------------------|
| 0+00 | | 61+78.65 | LT. | 287.5 |
| 0+00 | | 61+78.65 | RT. | 268.9 |
| 67+26.99 | | 68+66.26 | LT. | 6.3 |
| 67+26.99 | | 68+66.26 | RT. | 7.5 |
| 74+13.06 | | 174+11 | LT. | 555.2 |
| 74+13.06 | | 174+11 | RT. | 480.1 |
| | | | | TOTAL |
| | | | | 1605.5 |

THE ABOVE QUANTITY IS FOR THE ENTIRE SECTION AND IS INCLUDED IN THE QUANTITY FOR AGGREGATE SHOULDERS, TYPE B IN THE SUMMARY OF QUANTITIES.

SCHEDULE OF AGGREGATE SHOULDER STONE IN SUPERELEVATION

| STATION | TO | STATION | LOCATION | ALLOWED TONS EST. QUANTITY |
|----------|----|----------|----------|----------------------------|
| 61+78.65 | | 67+26.99 | LT. | 18.1 |
| 61+78.65 | | 67+26.99 | RT. | 58.4 |
| 68+66.26 | | 74+13.06 | LT. | 49.2 |
| 68+66.26 | | 74+13.06 | RT. | 18.9 |
| | | | | TOTAL |
| | | | | 144.6 |

THE ABOVE QUANTITY IS FOR THE ENTIRE SECTION AND IS INCLUDED IN THE QUANTITY FOR AGGREGATE SHOULDERS, TYPE B IN THE SUMMARY OF QUANTITIES.

AGGREGATE SHOULDER DETAIL

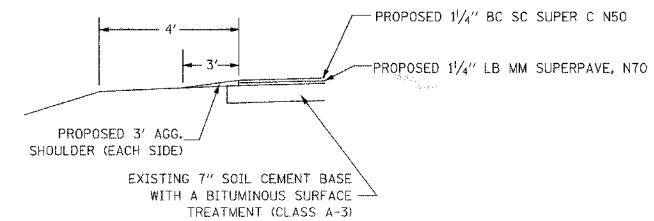

SCHEDULE FOR SUPERELEVATION RATES

| CURVE #2 | CURVE #3 |
|------------------------------------|------------------------------------|
| TANGENT RUNOFF BEGINS STA 61+78.65 | TANGENT RUNOFF BEGINS STA 68+66.26 |
| S.E. RUNOFF BEGINS STA 62+16.24 | S.E. RUNOFF BEGINS STA 69+03.85 |
| FULL S.E. BEG STA 62+99.41 | FULL S.E. BEG STA 69+88.46 |
| FULL S.E. END STA 66+06.23 | FULL S.E. END STA 72+90.86 |
| S.E. END STA 66+89.60 | S.E. END STA 73+75.47 |
| TANGENT RUNOFF ENDS STA 67+26.99 | TANGENT RUNOFF ENDS STA 74+13.06 |
| S.E. RATE = 0.0346 FT / FT | S.E. RATE = 0.0352 FT / FT |

323 W. 3RD ST.
P.O. BOX 160
MT. CARMEL, IL
62863
PHONE:
(618)-262-8651
FAX:
(618)-263-3327

405 W. STATE ST.
SUITE 1
PRINCETON, IN
47570
PHONE:
(812)-386-7611
FAX:
(812)-385-2812



PROFESSIONAL
DESIGN FIRM
LAND SURVEY &
PROFESSIONAL
ENGINEERING
CORPORATION
184-000887
(82-032435)(35-002769)

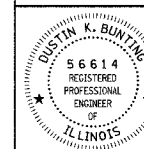

DUSTIN K. BUNTING
NAME
Dustin K. Bunting
SIGNATURE
DATE
11-30-05
EXPIRES