

F.A.U. RTE.	SECTION	COUNTY	TOTAL SHEETS	SHEET NO.
-	01-00193-00-SW	ST. CLAIR	14	1
STA.		TO STA.		
FED. ROAD DIST. NO.		ILLINOIS FED. AID PROJECT		
CONTRACT NO. 97230				

STATE OF ILLINOIS
DEPARTMENT OF TRANSPORTATION

PLANS FOR PROPOSED CITY OF BELLEVILLE NORTH CHARLES / SCHEEL STREETScape SECTION: 01-00193-00-SW ST. CLAIR COUNTY

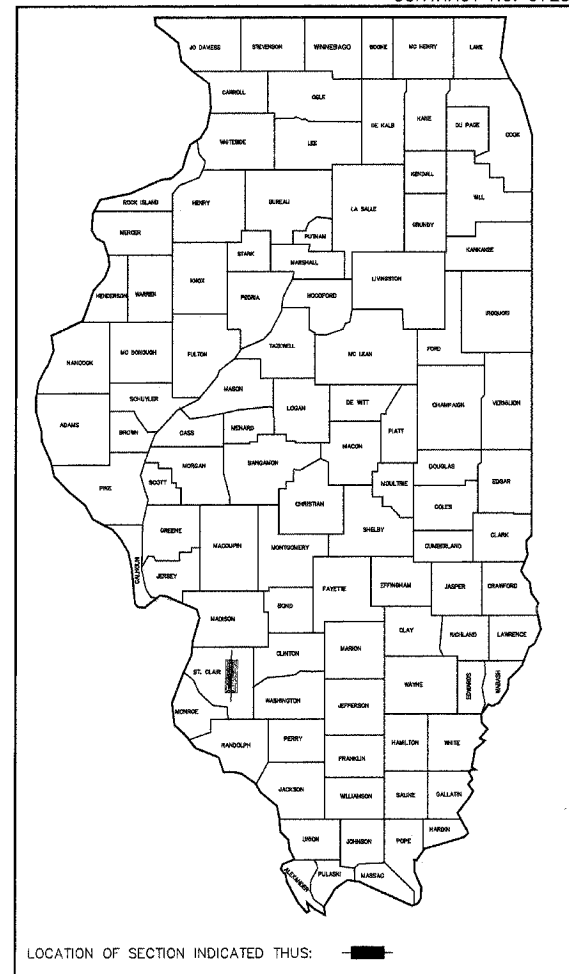

INDEX OF SHEETS

SHEET NO.	ITEM
1	COVER SHEET
2	SUMMARY OF QUANTITIES & GENERAL NOTES
3	EXISTING TYPICAL SECTIONS
4	PROPOSED TYPICAL SECTIONS
5	GENERAL PLAN
6-8	NORTH CHARLES / SCHEEL STREET PLAN
9-11	CONSTRUCTION DETAILS & SCHEDULES
12-14	ELECTRICAL PLAN

STANDARDS

424001-03	701501-02
604016-01	701801-03
606001-02	702001-05

PROJECT NO. TE-00D8 (89)
JOB NO. C-98-329-02

SCALE IN FEET
PLAN 1" = 20'
GENERAL PLAN 1" = 100'

MICROFILMED _____
REEL NUMBER _____
AWARDED _____
RESIDENT ENGINEER _____

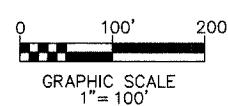
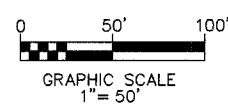
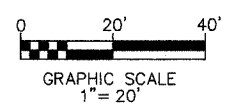

FULL SIZE PLANS HAVE BEEN PREPARED USING STANDARD ENGINEERING SCALES. REDUCED SIZED PLANS WILL NOT CONFORM TO STANDARD SCALES. IN MAKING MEASUREMENTS ON REDUCED PLANS, THE ABOVE SCALES MAY BE USED.

JOINT UTILITY LOCATING INFORMATION FOR EXCAVATIONS PHONE: 800-892-0123

CONTRACT NO.: 97230
FUNCTIONAL CLASSIFICATION: URBAN COLLECTOR
DESIGN TRAFFIC: 2,100
DESIGN SPEED: N/A

SECTION ENDS @ STA. 38+25
BENTON STREET

SECTION BEGINS @ STA. 10+37
E. MAIN STREET

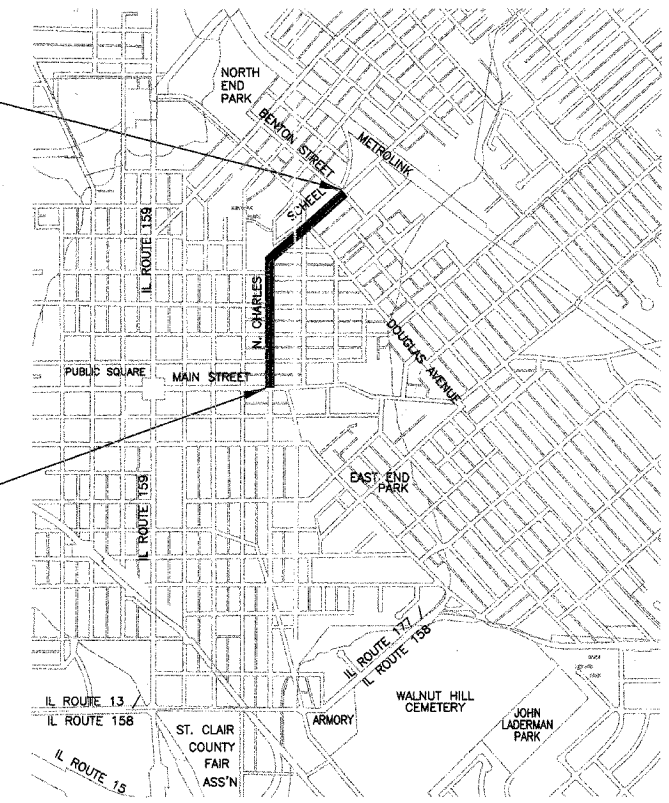

LOCATION MAP
SCALE: 1" = 1200'

NET LENGTH OF PROJECT = 2,788 FEET (0.528 MILES)

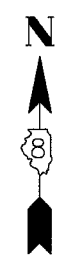

APPROVED 8-27-04 2004
[Signature] LOCAL AGENCY REPRESENTATIVE

PASSED 9-3 2004
[Signature] DISTRICT ENGINEER OF LOCAL ROADS & STREETS

APPROVED 9-3 2004
[Signature] DISTRICT ENGINEER

STATE OF ILLINOIS
DEPARTMENT OF TRANSPORTATION

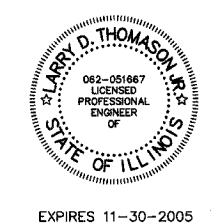

E+A Energy Plus ASSOCIATES
Project Management & Energy Services

8437 Steelecrest Lane
Troy, Illinois 62294
Office (618) 667-0000
Fax (618) 667-0001

[Signature] LARRY D. THOMASON, JR. P.E. DATE: 8-20-04

21004

GENERAL NOTES

SUMMARY OF QUANTITIES		CONSTRUCTION TYPE CODE Y003	
CODE NO.	ITEM	UNIT	QUANTITY
35100500	AGGREGATE BASE COURSE, TYPE A 6"	SQ YD	131
42000540	PORTLAND CEMENT CONCRETE PAVEMENT 12"	SQ YD	15
42300200	PORTLAND CEMENT CONCRETE DRIVEWAY PAVEMENT, 8"	SQ YD	246
42300400	PORTLAND CEMENT CONCRETE DRIVEWAY PAVEMENT, 8"	SQ YD	90
42400100	PORTLAND CEMENT CONCRETE SIDEWALK 4 INCH	SQ FT	2,185
42400420	PORTLAND CEMENT CONCRETE SIDEWALK 4 INCH, SPECIAL	SQ FT	12,056
42400440	PORTLAND CEMENT CONCRETE SIDEWALK 6 INCH, SPECIAL	SQ FT	594
44000100	PAVEMENT REMOVAL	SQ YD	15
44000200	DRIVEWAY PAVEMENT REMOVAL	SQ YD	458
44000300	CURB REMOVAL	FOOT	2,765
44000600	SIDEWALK REMOVAL	SQ FT	10,819
60260200	INLETS TO BE ADJUSTED (SPECIAL)	EACH	3
60260600	INLETS TO BE ADJUSTED WITH NEW TYPE 4 FRAME AND GRATE	EACH	3
60600605	CONCRETE CURB, TYPE B	FOOT	2,739
67100100	MOBILIZATION	L SUM	1
70102620	TRAFFIC CONTROL AND PROTECTION, STANDARD 701501	L SUM	1
70102640	TRAFFIC CONTROL AND PROTECTION, STANDARD 701801	L SUM	1
80400100	ELECTRIC SERVICE INSTALLATION	EACH	1
81012500	CONDUIT IN TRENCH, 1 1/2" DIA., PVC	FOOT	2,145
81021320	CONDUIT PUSHED, 1 1/2" DIA., PVC	FOOT	790
81100600	CONDUIT ATTACHED TO STRUCTURE, 2" DIA., GALVANIZED STEEL	FOOT	10
81300610	JUNCTION BOX, STAINLESS STEEL, ATTACHED TO STRUCTURE, 14" X 12" X 6"	EACH	2
81500200	TRENCH AND BACKFILL FOR ELECTRICAL WORK	FOOT	2,145
81702120	ELECTRIC CABLE IN CONDUIT, 600V (XLP-TYPE USE) 1/C NO. 8	FOOT	5,686
81702130	ELECTRIC CABLE IN CONDUIT, 600V (XLP-TYPE USE) 1/C NO. 6	FOOT	5,528
81702140	ELECTRIC CABLE IN CONDUIT, 600V (XLP-TYPE USE) 1/C NO. 4	FOOT	5,964
83600100	LIGHT POLE FOUNDATION	EACH	38
84200700	LIGHTING FOUNDATION REMOVAL	EACH	2
XX006019	LUMINARY CUT OUT	SQ YD	22.8
XX006030	ROOF DRAIN CHANNEL	FOOT	57
XX006031	SINGLE STREET LIGHT AND POLE, TYPE "EA"	EACH	34
XX006032	DOUBLE STREET LIGHT AND POLE, TYPE "EB"	EACH	4
XX000880	SEEDING, CLASS 1 (SPECIAL)	SQ YD	440
XX000959	TRASH RECEPTACLES	EACH	7
XX002873	BRICK SIDEWALK REMOVAL	SQ FT	5,578
XX004467	BRICK PAVER SIDEWALK ON RIGID BASE	SQ FT	2,990
XX004949	INCIDENTAL BITUMINOUS SURFACING, SUPERPAVE	TON	15
20000990	AGGREGATE FOR TEMPORARY ACCESS	TON	50

* SPECIALTY ITEMS
 ** TRASH RECEPTACLES ARE NOT A FEDERAL PARTICIPATING PAY ITEM
 *** Fund Type 07C, Construction Type Code Y003

MIXTURE REQUIREMENTS - SUPERPAVE PROJECT	
MIXTURE USE	INCIDENTAL
AC/PG	PG 64-22
RAP% (MAX)	10%
DESIGN AIR VOIDS	4.0% @ Ndes=70
MIX COMPOSITION (GRADATION MIXTURE)	
FRICTION AGG	MIXTURE C

THE STANDARDS WITH THE REVISION NUMBER LISTED ON THE COVER SHEET OF THE PLANS SHALL APPLY TO THIS PROJECT.

UNDERGROUND FACILITIES, STRUCTURES AND UTILITIES HAVE BEEN PLOTTED FROM AVAILABLE SURVEYS AND RECORDS. THEIR LOCATIONS MUST BE CONSIDERED TO BE APPROXIMATE ONLY. IT IS POSSIBLE THERE MAY BE OTHERS, THE EXISTENCE OF WHICH IS NOT PRESENTLY KNOWN OR SHOWN. IT IS THE CONTRACTOR'S RESPONSIBILITY TO DETERMINE THEIR EXISTENCE AND EXACT LOCATION AND TO AVOID DAMAGE THERETO. FIELD LOCATIONS OF UNDERGROUND FACILITIES MAY BE OBTAINED BY CALLING THE J.U.L.I.E. SYSTEM AT 800-892-0123 AND PROVIDING 48 HOURS ADVANCE NOTICE. NON-J.U.L.I.E. MEMBERS MAY BE CONTACTED DIRECT. AGENCIES KNOWN TO HAVE FACILITIES WITHIN THE PROJECT LIMITS ARE LISTED IN THE SPECIAL PROVISIONS.

ANY FACILITIES OR APPURTENANCES WHICH ARE THE PROPERTY OF ANY PUBLIC UTILITY LOCATED WITHIN THE LIMITS OF CONSTRUCTION SHALL BE RELOCATED OR ADJUSTED BY THEIR RESPECTIVE OWNERS. THE CONTRACTOR SHALL NOTIFY AND COOPERATE WITH THE OWNERS OF ANY SUCH FACILITY IN THEIR REMOVAL AND REARRANGEMENT OPERATIONS IN ORDER THAT THESE OPERATIONS AND THE CONSTRUCTION OF THIS PROJECT MAY PROGRESS IN A REASONABLE MANNER.

THE FOLLOWING UTILITY COMPANIES MAY HAVE FACILITIES LOCATED WITHIN THE LIMITS OF CONSTRUCTION WHICH MAY REQUIRE ADJUSTMENT, RELOCATION OR REMOVAL.

ILLINOIS POWER CO. (GAS & ELECTRIC) 1050 WEST BOULVARD BELLEVILLE, IL 62221 (618) 234-3400

ILLINOIS AMERICAN WATER CO. (WATER) 100 NORTH WATERWORKS DR. BELLEVILLE, IL 62223 (618) 277-7450

AMERITECH (TELEPHONE) 203 GOETHE ST. COLLINSVILLE, IL 62234 (618) 346-6400

CITY OF BELLEVILLE (SANITARY SEWER) 450 ENVIRONMENTAL DRIVE BELLEVILLE, IL 62220 (618) 233-6810

CHARTER COMMUNICATIONS (CABLE TV) 210 W. DIVISION MARYVILLE, IL 62062 (618) 345-8121

MCLEOD USA (FIBER OPTIC COMMUNICATIONS) 102 EAST SHAFER STREET FORTSYTHE, IL 63525

IT IS UNDERSTOOD AND AGREED THAT THE CONTRACTOR HAS TAKEN THE FOREGOING INTO CONSIDERATION IN PREPARING HIS/HER BID, AND NO ADDITIONAL COMPENSATION WILL BE ALLOWED FOR ANY DELAYS OR INCONVENIENCE CAUSED BY SAME.

THE CONTRACTOR SHALL REMOVE, MAINTAIN IN A TEMPORARY LOCATION, AND PERMANENTLY RESET ALL MAILBOXES AND TRAFFIC SIGNS WHICH INTERFERE WITH CONSTRUCTION OPERATIONS IN ACCORDANCE WITH ARTICLES 107.20 AND 107.25 OF THE "STANDARD SPECIFICATIONS FOR ROAD AND BRIDGE CONSTRUCTION."

THE CONTRACTOR SHALL PROTECT AND CAREFULLY PRESERVE ALL PROPERTY MARKERS AND MONUMENTS UNTIL THE OWNER AND AN AUTHORIZED SURVEYOR, OR AGENT, HAS WITNESSED OR OTHERWISE REFERENCED THEIR LOCATION.

UNLESS OTHERWISE NOTED, THE CONTRACTOR SHALL CONFINE HIS OPERATIONS TO THE AREA LOCATED WITHIN THE EXISTING RIGHT OF WAY. ANY AREA DISTURBED BEYOND THE EXISTING RIGHT OF WAY SHALL BE RESTORED TO ITS ORIGINAL CONDITION AT THE CONTRACTOR'S EXPENSE.

ALL WORK ASSOCIATED WITH THIS PROJECT SHALL CONFORM TO THE "AMERICANS WITH DISABILITIES ACT." CROSS SLOPES ON ALL SIDEWALKS, SIDEWALKS RAMPS, AND DRIVEWAYS SHALL BE 2% MAXIMUM UNLESS OTHERWISE NOTED. RAMP LONGITUDINAL SLOPES SHALL NOT EXCEED 8%.

ALL EARTH SURFACES DISTURBED BY CONSTRUCTION SHALL BE FERTILIZED, SEEDED AND MULCHED AS DIRECTED BY THE ENGINEER.

SEEDING DATES: FALL: AUGUST 16 - DECEMBER 31
 SPRING: JANUARY 1 - MAY 31

NO SEEDING SHALL BE DONE BETWEEN JUNE 1 - AUGUST 15.

FERTILIZER NUTRIENTS SHALL BE APPLIED AT THE RATE OF 270 POUNDS PER ACRE AT A RATIO OF 1:1:1 AS FOLLOWS: 90 POUNDS PER ACRE EACH FOR NITROGEN, PHOSPHORUS AND POTASSIUM. MULCH SHALL BE APPLIED AT A RATE OF 2.0 TONS PER ACRE.

ALL EXCAVATIONS SHALL BE PROTECTED WITH EXTENDED LEG BARRICADES WITH APPROPRIATE LIGHTS.

THE CONTRACTOR SHALL NOT REMOVE ANY CURB AND SIDEWALK THAT CANNOT BE RECONSTRUCTED WITHIN THREE WORKING DAYS. ACCESS TO ALL BUSINESSES AND RESIDENCES SHALL BE MAINTAINED AT ALL TIMES. THE CONTRACTOR SHALL CONTACT BUSINESS OWNERS AND RESIDENTS PRIOR TO CONSTRUCTING ADJACENT TO THEIR AFFECTED PROPERTIES.

PRIOR TO REMOVING THE EXISTING SIDEWALK, THE CONTRACTOR SHALL REMOVE ALL PARKING METERS AND DELIVER THEM TO THE CITY OF BELLEVILLE. 12"x12" BLOCK OUTS SHALL BE CONSTRUCTED IN THE PROPOSED SIDEWALKS AS DIRECTED BY THE CITY OF BELLEVILLE FOR LATER RE-INSTALLATION OF PARKING METERS. REMOVAL, DELIVERY AND BLOCK OUTS FOR PARKING METERS WILL NOT BE PAID FOR SEPARATELY, BUT SHALL BE INCLUDED IN THE SIDEWALK REMOVAL AND P.C.C. SIDEWALK UNIT PRICES.

ALL INCIDENTAL FEATURES SUCH AS RAILROAD TIES AND WALLS TO BE REMOVED AND FOR WHICH THERE IS NO SPECIFIC PAY ITEM, WILL NOT BE MEASURED SEPARATELY FOR PAYMENT. THE COST OF THIS INCIDENTAL WORK SHALL BE INCLUDED IN THE UNIT COST FOR PCC SIDEWALK 4", SPECIAL.

RESIDENTS AND BUSINESS OWNERS MAY CLAIM ANY QUANTITY OF UNUSED BRICKS REMOVED DURING CONSTRUCTION OF THE NEW SIDEWALK WHICH ARE IMMEDIATELY ADJACENT TO THEIR PROPERTIES. DISTRIBUTION OF UNUSED BRICKS SHALL BE AS OUTLINED IN THE SPECIAL PROVISIONS. THE CITY OF BELLEVILLE SHALL HAVE THE RIGHT TO SALVAGE ANY REMAINING BRICKS. BRICKS NOT SALVAGED BY THE CITY, BUSINESS OWNER OR RESIDENT SHALL BE REMOVED FROM THE JOBSITE BY THE CONTRACTOR WITH NO ADDITIONAL COMPENSATION.

BRICK STENCILED SIDEWALK LOCATIONS ARE INDICATED BY A BRICK HATCHING PATTERN. TEXTURED RAMP LOCATIONS ARE DENOTED BY A "CONCRETE" HATCH PATTERN. NON-TEXTURED, NON-STENCILED SIDEWALK ARE THOSE AREAS WITHOUT HATCH PATTERN. BRICK PAVER SIDEWALK ON RIGID BASE LOCATIONS INDICATED BY BRICK HATCHING PATTERN AND NOTED ON PLAN SHEETS.

P.C.C. SIDEWALK 4" SPECIAL (UNLESS OTHERWISE NOTED) P.C.C. SIDEWALK 4" RAMP

OR BRICK PAVER SIDEWALK ON CONCRETE BASE

EXISTING STREET SIGNS SHALL BE REMOVED AS NEEDED AND RE-ERECTED AS DIRECTED BY THE ENGINEER. PVC COLLARS SHALL BE INSTALLED AROUND THE POST ISOLATING THE POST FROM THE NEW SIDEWALK. SIGN REMOVAL AND RE-ERECTION AND PVC COLLARS SHALL NOT BE PAID FOR SEPARATELY BUT SHALL BE CONSIDERED INCLUDED IN THE UNIT COST FOR PCC SIDEWALK 4", SPECIAL.

EXISTING UTILITIES WHICH ARE NOT BEING REMOVED OR RELOCATED BY THE UTILITY OWNER SHALL BE ADJUSTED TO THE NEW SIDEWALK / DRIVEWAY SURFACE ELEVATION. ADJUSTMENTS OF THE EXISTING UTILITIES WILL NOT BE PAID FOR SEPARATELY, BUT SHALL BE CONSIDERED INCLUDED IN THE SIDEWALK OR DRIVEWAY PAVEMENT CONSTRUCTION.

EARTH EXCAVATION, EMBANKMENT, AND/OR FURNISHED EXCAVATION SHALL NOT BE PAID FOR AS SEPARATE PAY ITEMS. ANY CUT AND FILL NECESSARY TO BRING THE SIDEWALK TO THE PROPOSED ELEVATION SHALL BE CONSIDERED INCLUDED IN PCC SIDEWALK 4", SPECIAL.

PLACE ELECTRICAL CONDUIT 3 1/2' FROM FACE OF CURB TO AVOID CONFLICT WITH FUTURE TREE PLANTINGS BY OTHERS.

SOIL IN THE TREE CUT OUT LOCATIONS SHALL BE FREE OF AGGREGATE AND CONSTRUCTION DEBRIS.

SEE THE SPECIAL PROVISIONS FOR OTHER INCIDENTAL CONSTRUCTION ITEMS AND OPERATIONS WHICH ARE TO BE INCLUDED WITH AND PAID FOR UNDER CERTAIN SPECIFIED PAY ITEMS.

F.A. RTE.	SECTION	COUNTY	TOTAL SHEETS	SHEET NO.
-	01-00193-00-SW	ST. CLAIR	14	3
STA.		TO STA.		
FED. ROAD DIST. NO.		ILLINOIS	FED. AID PROJECT	
EXISTING TYPICAL SECTIONS				
CONTRACT NO. 97230				

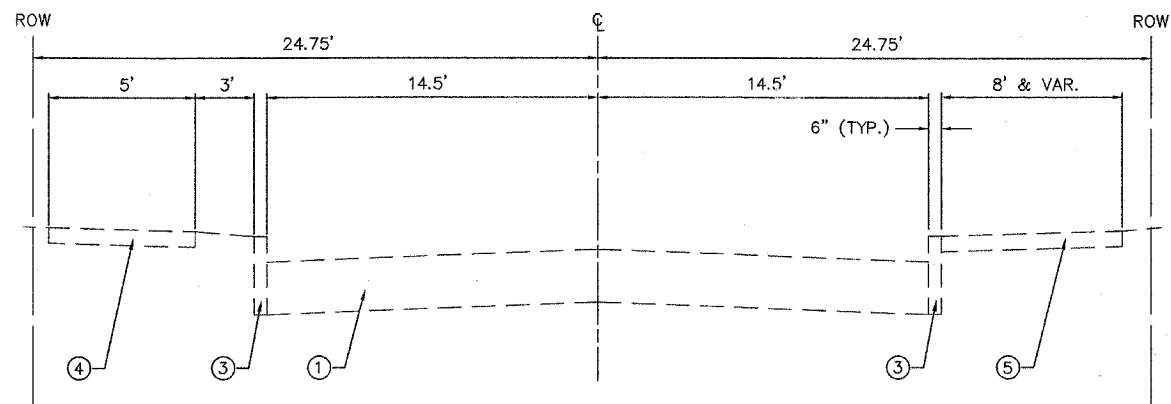

EXISTING TYPICAL SECTION
STA. 17+00 TO STA. 20+50
(NOT TO SCALE)

- ① EXISTING BITUMINOUS CONCRETE PAVEMENT
- ② EXISTING P.C.C. PAVEMENT
- ③ EXISTING CONCRETE CURB
- ④ EXISTING P.C.C. SIDEWALK
- ⑤ EXISTING BRICK SIDEWALK
- ⑥ PROPOSED CONCRETE CURB, TYPE B
- ⑦ PROPOSED BRICK STENCILED P.C.C. SIDEWALK
- ⑧ PROPOSED BRICK SIDEWALK ON RIGID BASE

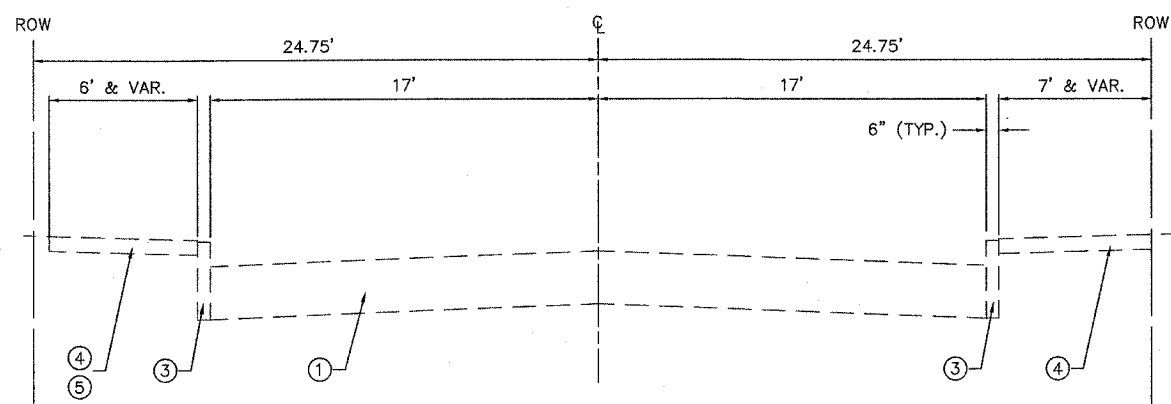

EXISTING TYPICAL SECTION
STA. 13+50 TO STA. 17+00
(NOT TO SCALE)

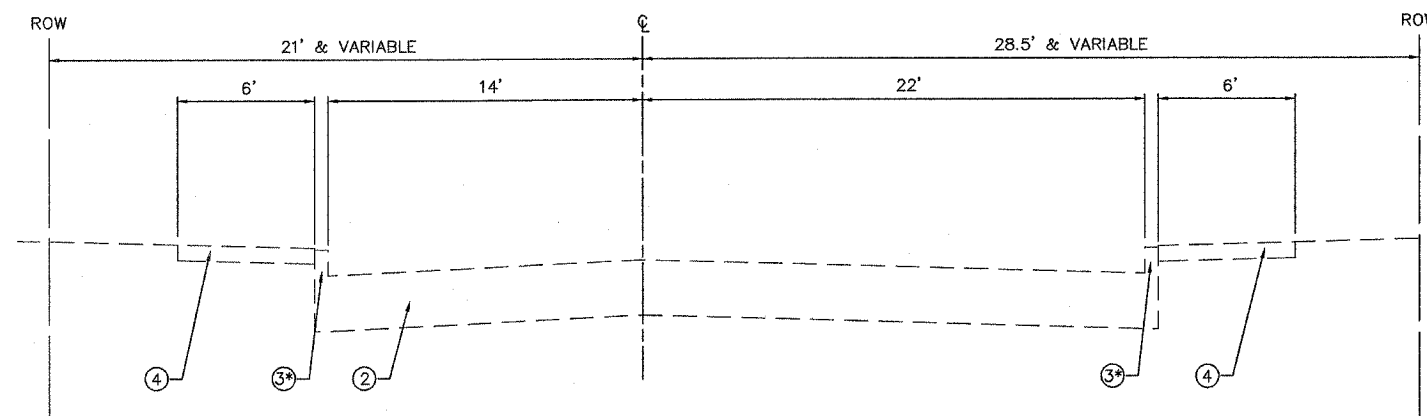

EXISTING TYPICAL SECTION
STA. 25+20 TO STA. 38+25
(NOT TO SCALE)

* COMB. CONC. CURB & GUTTER, TY B-6.24
POURED MONOLITHICALLY
WITH PAVEMENT

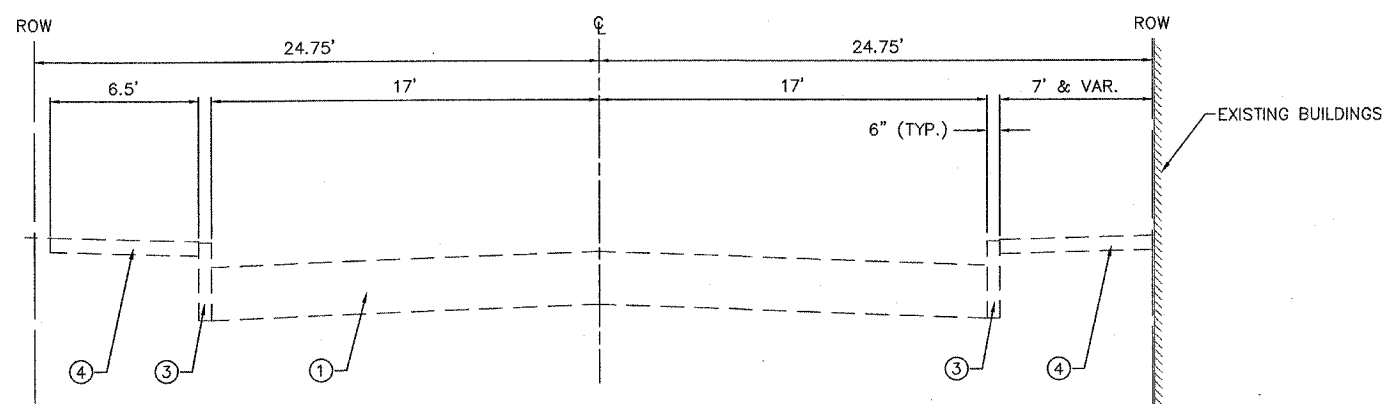

EXISTING TYPICAL SECTION
STA. 10+37 TO STA. 13+50
(NOT TO SCALE)

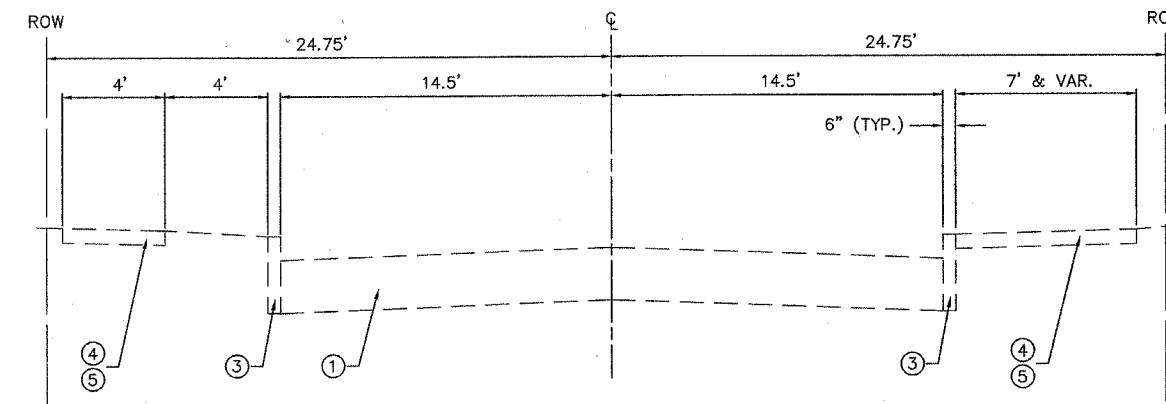

EXISTING TYPICAL SECTION
STA. 20+50 TO STA. 25+20
(NOT TO SCALE)

F.A. RTE.	SECTION	COUNTY	TOTAL SHEETS	SHEET NO.
-	01-00193-00-SW	ST. CLAIR	14	4
STA.		TO STA.		
FED. ROAD DIST. NO.	ILLINOIS	FED. AID PROJECT		
PROPOSED TYPICAL SECTIONS				
CONTRACT NO. 97230				

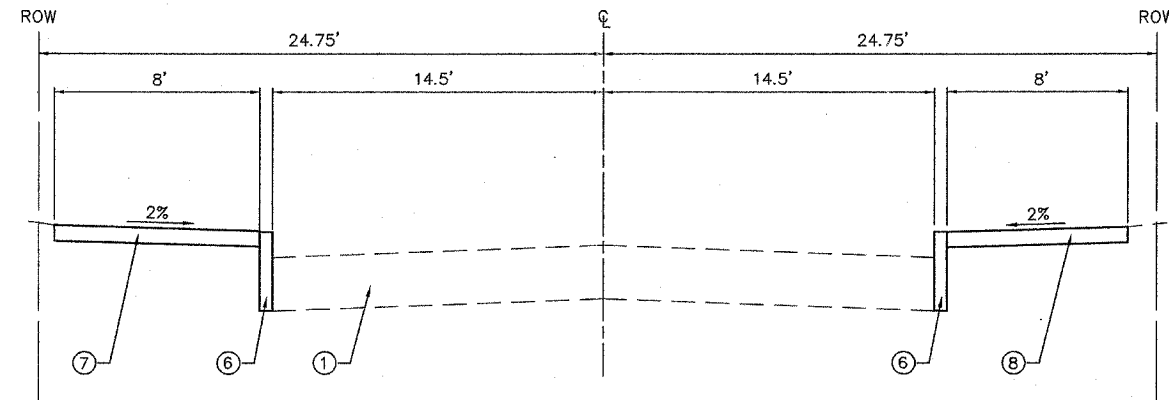

PROPOSED TYPICAL SECTION

STA. 20+50 TO STA. 25+20
(NOT TO SCALE)

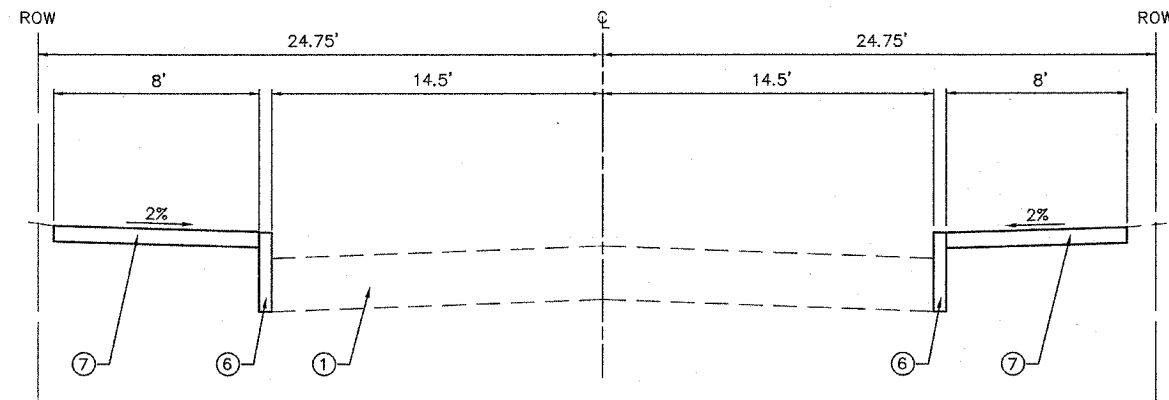

PROPOSED TYPICAL SECTION

STA. 17+00 TO STA. 20+50
(NOT TO SCALE)

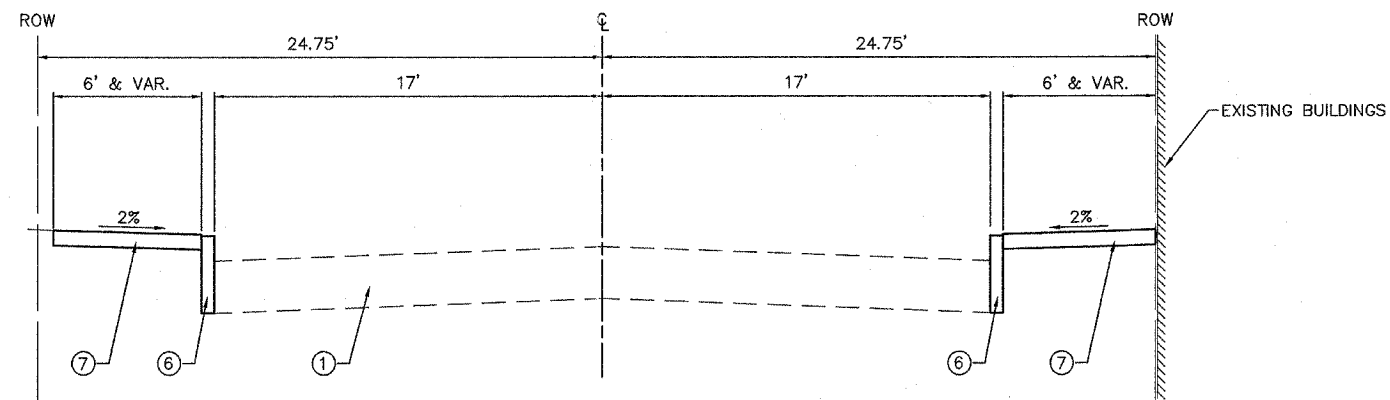

PROPOSED TYPICAL SECTION

STA. 10+37 TO STA. 17+00
(NOT TO SCALE)

- ① EXISTING BITUMINOUS CONCRETE PAVEMENT
- ② EXISTING P.C.C. PAVEMENT
- ③ EXISTING CONCRETE CURB
- ④ EXISTING P.C.C. SIDEWALK
- ⑤ EXISTING BRICK SIDEWALK
- ⑥ PROPOSED CONCRETE CURB, TYPE B
- ⑦ PROPOSED BRICK STENCILED P.C.C. SIDEWALK
- ⑧ PROPOSED BRICK SIDEWALK ON RIGID BASE

F.A. R.T.E.	SECTION	COUNTY	TOTAL SHEETS	SHEET NO.
-	01-00193-00-SW	ST. CLAIR	14	5
STA.		TO STA.		
FED. ROAD DIST. NO.	ILLINOIS	FED. AID PROJECT		
GENERAL PLAN				

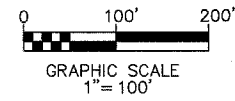

CONTRACT NO. 97230

BY	DATE
FINAL SURVEY PLOTTED	
NOTE BOOK TEMPLATE AREAS CHECKED	
NO.	

BY	DATE
ORIGINAL SURVEY PLOTTED	
NOTE BOOK TEMPLATE AREAS CHECKED	
NO.	



F.A. RTE.	SECTION	COUNTY	TOTAL SHEETS	SHEET NO.
-	01-00193-00-SW	ST. CLAIR	14	6
STA. 10+00		TO STA. 20+00		
FED. ROAD DIST. NO.		ILLINOIS FED. AID PROJECT		
NORTH CHARLES / SCHEEL STREETScape		CONTRACT NO. 97230		

BY	DATE
FINAL SURVEY PLOTTED	
NOTE BOOK TEMPLATE	
AREAS CHECKED	
NO.	

BY	DATE
ORIGINAL SURVEY PLOTTED	
NOTE BOOK TEMPLATE	
AREAS CHECKED	
NO.	

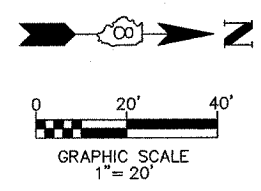
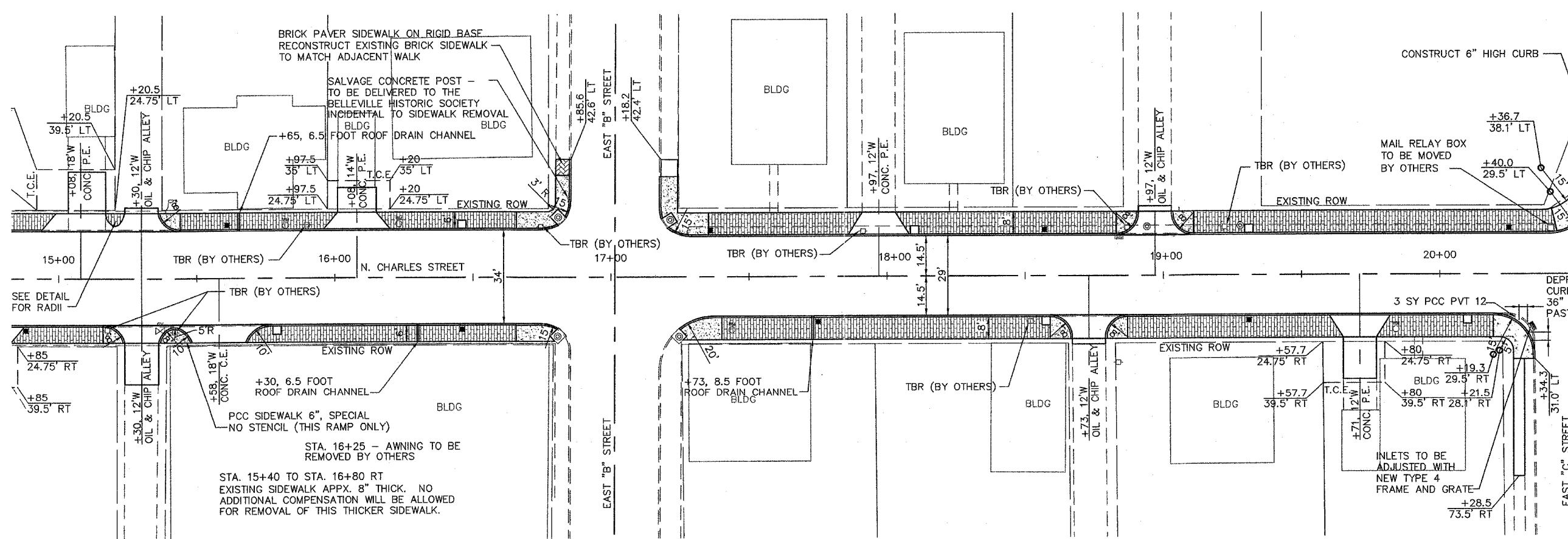
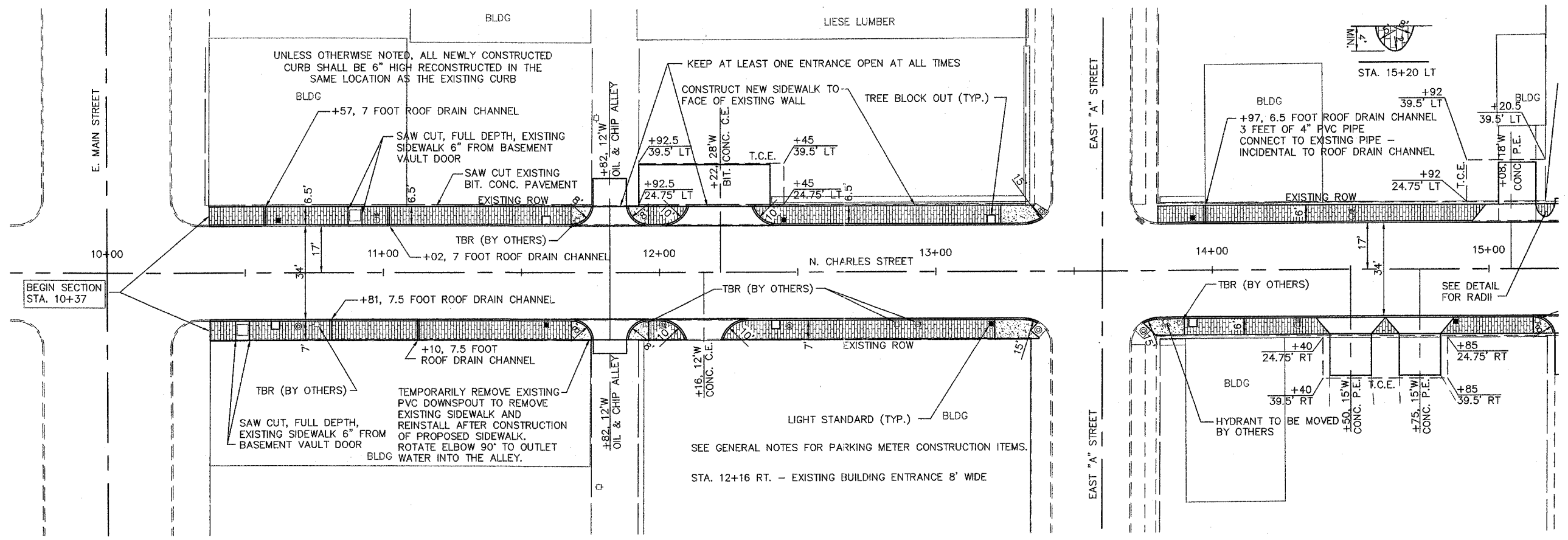

STA. 16+25 - AWNING TO BE REMOVED BY OTHERS

STA. 15+40 TO STA. 16+80 RT EXISTING SIDEWALK APPX. 8" THICK. NO ADDITIONAL COMPENSATION WILL BE ALLOWED FOR REMOVAL OF THIS THICKER SIDEWALK.

SEE GENERAL NOTES FOR PARKING METER CONSTRUCTION ITEMS.

STA. 12+16 RT. - EXISTING BUILDING ENTRANCE 8' WIDE

DEPRESS CURE 36" MIN. PAST INLET

INLETS TO BE ADJUSTED WITH NEW TYPE 4 FRAME AND GRATE

F.A. RTE.	SECTION	COUNTY	TOTAL SHEETS	SHEET NO.
-	01-00193-00-SW	ST. CLAIR	14	8
STA. 30+00		TO STA. 40+00		
FED. ROAD DIST. NO.		ILLINOIS FED. AID PROJECT		
NORTH CHARLES / SCHEEL STREETScape		CONTRACT NO. 97230		

BY	DATE
FINAL SURVEYED	
SURVEY PLOTTED	
NOTE BOOK TEMPLATE	
AREAS	
CHECKED	
NO.	

BY	DATE
ORIGINAL SURVEYED	
SURVEY PLOTTED	
NOTE BOOK TEMPLATE	
AREAS	
CHECKED	
NO.	

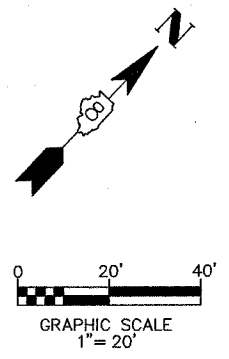
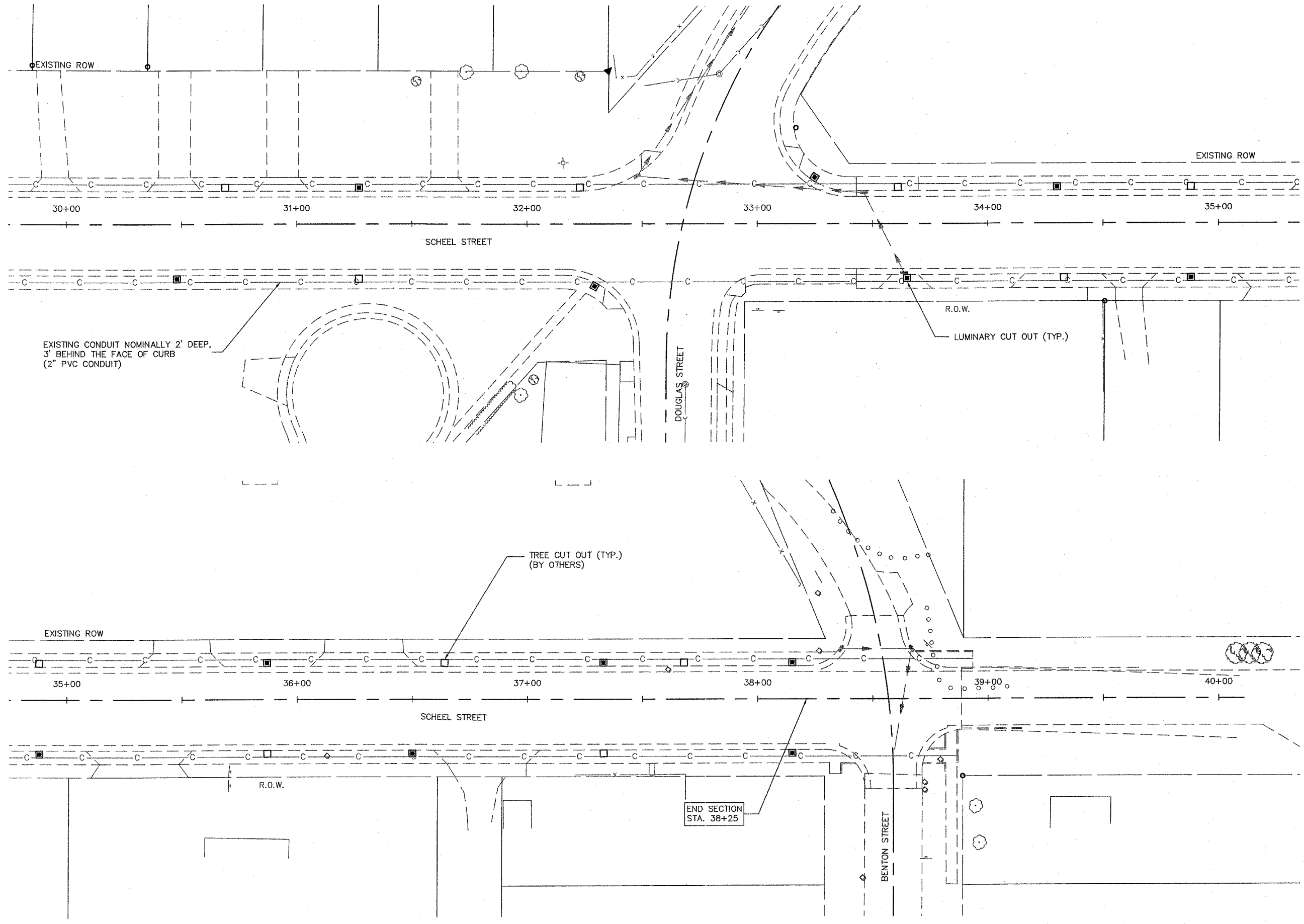

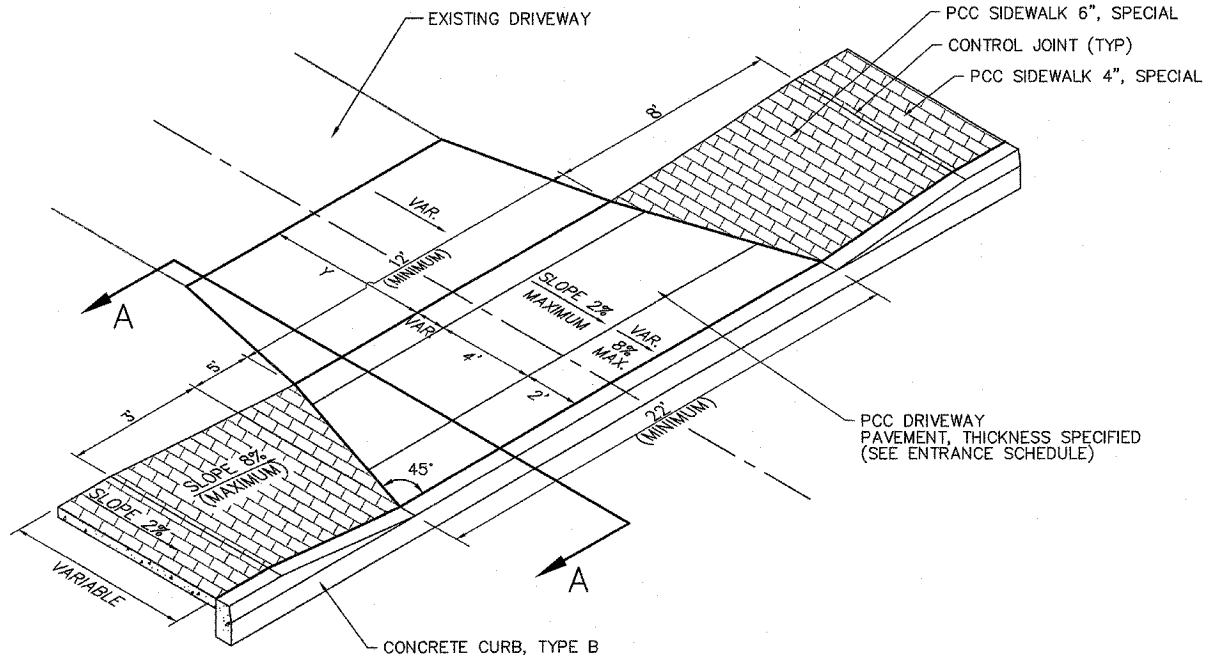

TYPICAL ENTRANCE DETAIL
(NOT TO SCALE)

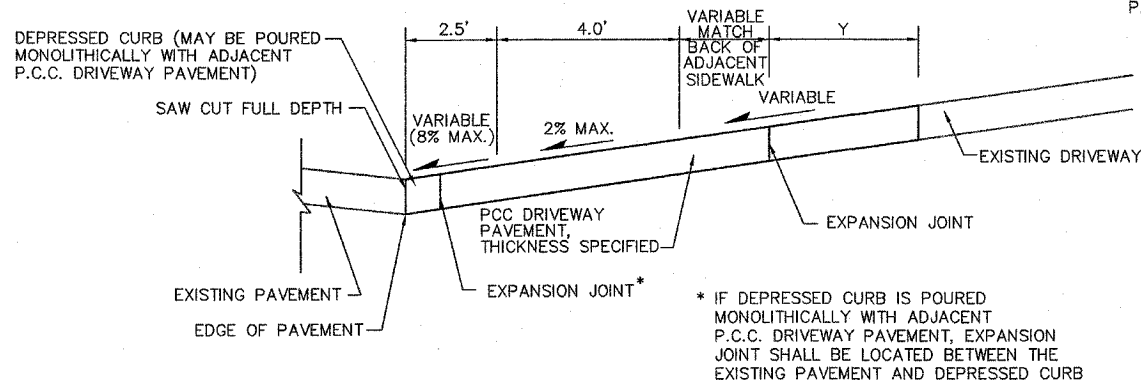

SECTION A-A
(NOT TO SCALE)

SIDEWALK SCHEDULE

STATION	STATION	OFFSET	PC CONC SIDEWALK 4 42400100 (SQ FT)	PC CONC SIDEWALK 4 SPL 42400420 (SQ FT)	PC CONC SIDEWALK 6 SPL 42400440 (SQ FT)	BR PAV SDWK RIGID BASE XX004467 (SQ FT)	SIDEWALK REM 44000600 (SQ FT)	BRICK SIDEWALK REM XX002873 (SQ FT)
10+37	13+60	LT	141	1,313	74		1,577	-
10+37	13+60	RT	164	1,522	76		1,718	-
13+60	17+00	LT	164	1,163	108	36	356	1,358
13+60	17+00	RT	168	959	167		1,465	-
17+00	20+60	LT	510	2,164	81		2,648	-
17+00	20+60	RT	461	1,828	88		-	2,182
20+60	25+00	LT	206	2,832	-		1,274	310
20+60	23+95	RT	288	-	-	2,172	1,581	869
23+95	25+12	RT	83	-	-	782	-	859
25+12	38+25	LT & RT	-	275	-		-	-
TOTAL			2,185	12,056	594	2,990	10,619	5,578

- NOTE:
1. SIDEWALK RAMPS ACCESSIBLE TO THE DISABLED ARE REQUIRED.
 2. UNUSED SALVAGED BRICKS SHALL BE COLLECTED, STACKED AND DELIVERED TO THE CITY OF BELLEVILLE.
 3. SEE PLAN SHEETS FOR LOCATIONS AND TYPES.
 4. SEE HIGHWAY STANDARD 424001 FOR SIDEWALK RAMP DETAILS.

CURB & GUTTER SCHEDULE

STATION	STATION	OFFSET	CURB REM 44000300 (FOOT)	CONC CURB TB 60600605 (FOOT)
10+37	13+60	LT	302	298
10+37	13+60	RT	300	296
13+60	17+00	LT	322	313
13+60	17+00	RT	307	301
17+00	20+60	LT	374	375
17+00	20+60	RT	325	323
20+60	25+00	LT	391	391
20+60	23+95	RT	339	337
23+95	25+12	RT	105	105
TOTAL			2,785	2,739

TREE BLOCK OUT SCHEDULE

STATION	OFFSET	TREE BLOCK OUT	TREE CUT OUT (BY OTHERS)
10+61	RT	1	
11+59	LT	1	
12+42	RT	1	
13+20	LT	1	
13+93	RT	1	
15+79	RT	1	
16+46	LT	1	
18+10	LT	1	
18+57	RT	1	
19+31	LT	1	
20+10	RT	1	
21+63	RT	1	
22+50	LT	1	
23+25	RT	1	
23+91	LT	1	
24+95	RT	1	
25+91	LT		1
26+62	RT		1
27+48	LT		1
28+38	RT		1
29+16	LT		1
29+88	RT		1
30+69	LT		1
31+27	RT		1
32+23	LT		1
33+61	LT		1
34+33	RT		1
34+88	LT		1
35+87	RT		1
36+64	LT		1
37+33	RT		1
37+68	LT		1
TOTAL		16	16

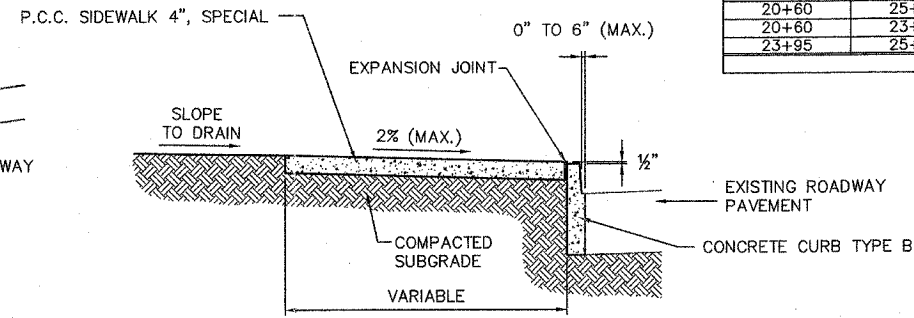

TYPICAL SIDEWALK SECTION
(NOT TO SCALE)

ENTRANCE SCHEDULE

STATION	LT / RT	ENTRANCE TYPE	ENTRANCE WIDTH (FT)	EXISTING SURFACE TYPE	EXISTING DRIVEWAY SLOPE (1)	PROPOSED DRIVEWAY SLOPE (2)	"Y" (FT)	AGG BASE COURSE A 6 35100500 (SQ YD)	PCC DRIVEWAY PAVT 6 42300200 (SQ YD)	PCC DRIVEWAY PAVT 8 42300400 (SQ YD)	DRIVE PAVEMENT REM 44000200 (SQ YD)	INCLD BIT SURFACING SUPERPAVE XX004949 (TON)
11+82	LT	ALLEY	12	OIL / CHIP	6.6% - 4%	2% - 2% - 7%	10	13		12	34	1.5
11+82	RT	ALLEY	12	OIL / CHIP	4.5% - 2%	2% - 2% - 6%	5	7		13	28	0.7
12+16	RT	C.E. / BLDG.	12	CONC.	16% - 16%	16% - 16% - 16%	-	-	13		9	-
12+22	LT	C.E.	28	BIT. CONC.	9.4% - 8.5%	8% - 2% - 10%	15	79	24		102	8.8
14+50	RT	P.E.	15	CONC.	8.3% - 8.3%	8% - 2% - 10%	15		38		39	
14+75	RT	P.E.	15	CONC.	8.3% - 8.3%	8% - 2% - 10%	15		38		39	
15+08	LT	P.E.	24	CONC.	10.9% - 5.5%	8% - 2% - 8%	15		41		33	
15+30	LT	ALLEY	12	OIL / CHIP	7.2% - 5.5%	8% - 2% - 7%	2	3		11	14	0.3
15+30	RT	ALLEY	12	OIL / CHIP	6.9% - 9.5%	8% - 2% - 10%	15	20		12	33	2.3
15+58	RT	C.E. / BLDG.	18	CONC.	12% - 12%	12% - 12% - 12%	-		15		22	
16+08	LT	P.E.	14	CONC.	9.5% - 12%	8% - 2% - 15%	9		27		11	
17+97	LT	P.E.	12	CONC.	8% - 7%	8% - 2% - 9%	-		15		11	
18+73	RT	ALLEY	12	OIL / CHIP	4.2% - 0.5%	2% - 2% - 3%	2	3		14	17	0.3
18+97	LT	ALLEY	12	OIL / CHIP	4.7% - 5.0%	2% - 2% - 6%	2	3		14	17	0.3
19+71	RT	P.E.	12	CONC.	8% - 8%	8% - 2% - 9.5%	15		35		32	
22+22	RT	ALLEY	12	OIL / CHIP	0% - 5%	2% - 2% - 3%	2	3		14	17	0.3
TOTAL								131	246	90	458	15

- NOTES:
1. DRIVEWAY SLOPE AT SIDEWALK - DRIVEWAY SLOPE BEYOND SIDEWALK.
 2. DRIVEWAY SLOPE FOR FIRST 2.5' - DRIVEWAY SLOPE FOR NEXT 4.0' - DRIVEWAY SLOPE TO "Y"
 3. NOMINAL EXISTING DRIVEWAY PAVEMENT THICKNESS:
CONCRETE - 6"
BIT. CONC. - 2" SURFACE, 6" AGG. BASE
OIL/CHIP - 1 1/2" SURFACE, 6" AGG. BASE
 4. EXISTING DRIVEWAY PAVEMENT WITHIN THE SIDEWALK AREA IS CONCRETE OR BRICK.
 5. NOMINAL COMPACTED BITUMINOUS CONCRETE SURFACE COURSE THICKNESS - 2"
 6. PRIOR TO CONSTRUCTION, THE ENGINEER SHALL CONTACT EACH PROPERTY OWNER & VERIFY THE LOCATION AND WIDTH OF ALL ENTRANCES.

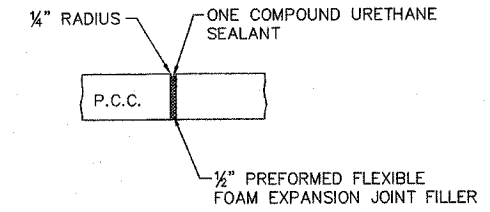

TYPICAL CONCRETE EXPANSION JOINT
(NOT TO SCALE)

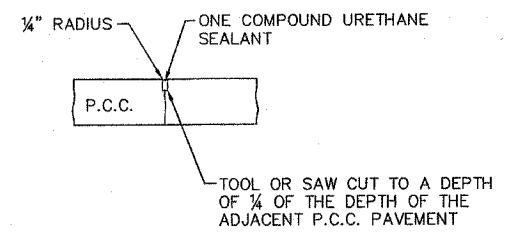

TYPICAL CONCRETE CONTROL JOINT
(NOT TO SCALE)

LUMINARY SCHEDULE

STATION	LT / RT	SINGLE ST LT & POLE (EACH)	DOUBLE ST LT & POLE (EACH)	LUMINARY CUT OUT (SQ YD)
10+62	LT	1		
11+59	RT	1		
12+45	LT	1		
13+20	RT	1		
13+93	LT	1		
14+88	RT	1		
15+61	LT	1		
16+46	RT	1		
17+36	LT	1		
17+75	RT	1		
18+57	LT	1		
19+31	RT	1		
20+25	LT	1		
21+00	RT	1		
21+63	LT	1		
22+50	RT	1		
23+25	LT	1		
24+18	RT	1		
24+63	LT	1		
25+34	LT	1		1.2
25+91	RT	1		1.2
26+62	LT	1		1.2
27+48	RT		1	1.2
28+38	LT		1	1.2
29+16	RT	1		1.2
29+72	LT	1		1.2
30+48	RT	1		1.2
31+27	LT	1		1.2
32+30	RT		1	1.2
33+24	LT		1	1.2
33+65	RT	1		1.2
34+30	LT	1		1.2
34+88	RT	1		1.2
35+87	LT	1		1.2
36+50	RT	1		1.2
37+33	LT	1		1.2
38+15	RT	1		1.2
38+15	RT	1		1.2
TOTALS		34	4	22.8

Contract 97230

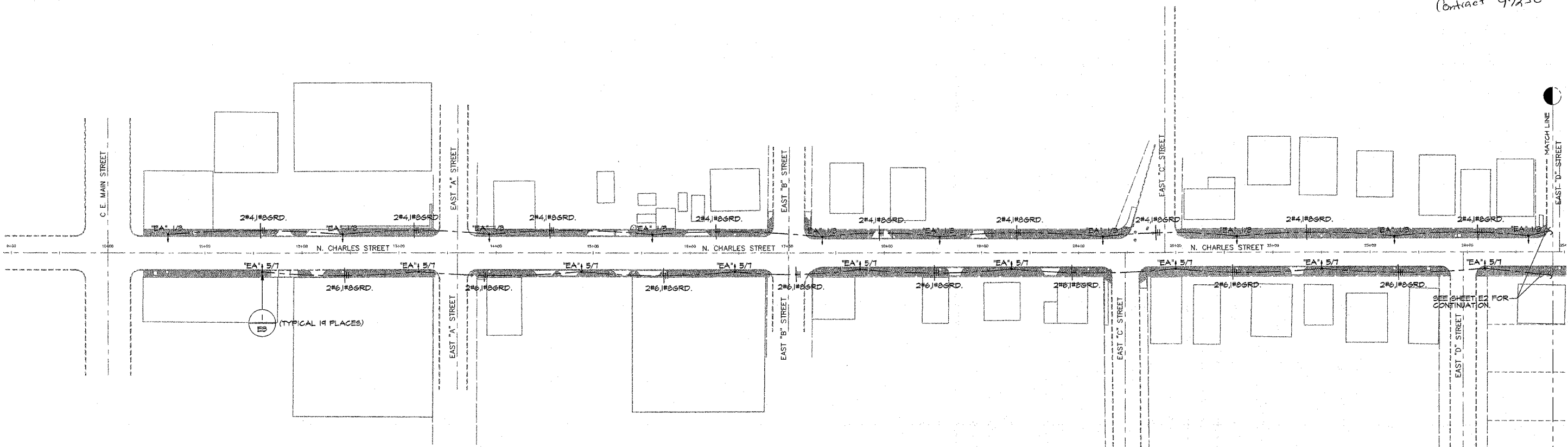

ELECTRICAL SITE PLAN (SOUTH)
SCALE: 1" = 50'-0"
NORTH

ELECTRICAL SCHEDULE					
ITEM NO.	PAY ITEM	UNIT	ABBREVIATION	CODE NUMBER	TOTAL
1	ELECTRIC SERVICE INSTALLATION	EACH	ELECT SERV INSTAL	80400100	1
2	CONDUIT IN TRENCH, 1-1/2" DIA., PVC	FOOT	CON T 1 1/2 PVC	81012500	2145
3	CONDUIT PUSHED, 1-1/2" DIA., PVC	FOOT	CON P 1 1/2 PVC	81021320	740
4	TRENCH AND BACKFILL FOR ELECTRICAL WORK	FOOT	TR & BKFIL F ELECT WK	81500200	2145
5	ELECTRIC CABLE IN CONDUIT, 600V (XLP-TYPE USE) 1/2 NO. 3	FOOT	EC C XLP USE 1/2 3	81702120	5606
6	ELECTRIC CABLE IN CONDUIT, 600V (XLP-TYPE USE) 1/2 NO. 6	FOOT	EC C XLP USE 1/2 6	81702130	5528
7	ELECTRIC CABLE IN CONDUIT, 600V (XLP-TYPE USE) 1/2 NO. 4	FOOT	EC C XLP USE 1/2 4	81702140	5464
8	LIGHT POLE FOUNDATION	EACH	LIGHT POLE FDN	83600100	38
9	SINGLE STREET LIGHT AND POLE, TYPE "EA"	EACH	SINGLE ST LT & POLE	XX	34
10	DOUBLE STREET LIGHT AND POLE, TYPE "EB"	EACH	DOUB ST LT & POLE	XX	4

GENERAL NOTES

- EXISTING SIDEWALK ON THIS SHEET TO BE REMOVED BY CIVIL CONTRACTOR.
- COORDINATE ALL POLE LOCATIONS WITH INLETS, TRENCHES, ETC., PRIOR TO INSTALLATION.
- FACE OF LIGHT POLES TO BE INSTALLED 24" FROM FACE OF CURB.
- CALL JULIE TO LOCATE ALL UNDERGROUND UTILITIES BEFORE DIGGING.
- DURING INSTALLATION OF ALL UNDERGROUND ELECTRICAL, EXERCISE EXTREME CAUTION DUE TO UNDERGROUND POWER AND UTILITY LINES THAT MAY BE EXISTING.
- LIGHTING CONDUITS SHALL BE 1-1/2" PVC CONDUIT MINIMUM AND INSTALLED AT 24" MINIMUM BELOW FINISHED GRADE; CABLES SHALL BE NO. 6 AWG MINIMUM, UNLESS OTHERWISE NOTED.
- PUSH CONDUITS TO BE USED AT INTERSECTIONS AT EAST "A" STREET, EAST "B" STREET, EAST "C" STREET, AND EAST "D" STREET.
- SEE DETAIL 4 ON SHEET E3 FOR TRENCHING.
- SEE SHEET E2 FOR PANEL "1LL1" LOCATION.

KEYED NOTE

- IF TOTALS ARE DIFFERENT THAN THOSE INDICATED IN THE ELECTRICAL SCHEDULE NOTIFY ENGINEER PRIOR TO BIDDING.

LIGHTING FIXTURE SCHEDULE				LAMP DATA		MOUNTING DATA			
PLAN MARK	MANUFACTURER AND CATALOG NUMBER OR APPROVED EQUAL	REMARKS	FINISH	NO. OF LAMPS	LAMP ORDERING NUMBER	TOTAL FIXTURE WATTAGE	LOCATION		
							EXTERIOR	CEILING	SURFACE
EA	AAL #ALN610-HB-175M-H-DB12-4F16-188-(2)BBD4-24-MDM-BLK, 240V	LTG FIXT. SCHED. NOTES 1 & 2	BLACK	1	MITS/C/M/MD	210	<input checked="" type="checkbox"/>	<input type="checkbox"/>	<input type="checkbox"/>
EB	AAL #2-ALN610-HB-175M-H-DB12-4F16-188-(2)BBD4-24-MDM-BLK, 240V	LTG FIXT. SCHED. NOTES 1, 2 & 3	BLACK	2	MITS/C/M/MD	420	<input checked="" type="checkbox"/>	<input type="checkbox"/>	<input type="checkbox"/>

LIGHTING FIXTURE SCHEDULE NOTES

- PROVIDE FUSING IN BASE OF POLE. ALSO REQUIRES SURGE PROTECTOR CONNECTED BETWEEN FUSE HOLDER AND LUMINAIRE(S). SEE STANDARD SPECIFICATIONS.
- WITH MULTITAP BALLAST.
- WITH TWO (2) TRA6U-BLK ARMS

BELLEVILLE STREET LIGHTING
ON N. CHARLES STREET/SCHEEL STREET
FROM E. MAIN STREET TO BENTON STREET

Kuhlmann Design Group, Inc.
66 Progress Parkway
St. Louis, Missouri 63043-3706
Tel: (314) 434-8888

E+A Energy Plus Associates
8437 Steeplecrest Lane
Troy, Illinois 62294
Office (618) 667-0000
Fax (618) 667-0001

DISCLAIMER OF RESPONSIBILITY
I hereby specify that the documents intended to be authorized by my seal are limited to this sheet, and I hereby disclaim any responsibility for all other Drawings, Specifications, Estimates, Reports or other documents or instruments relating to or intended to be used for any part of this project.

NICHOLAS T. DIMERCURIO
062-055576
STATE OF ILLINOIS

Nicholas T. Dimercurio
Signature 4/4/05
NO. DATE
License expires 11/30/2005

PROJECT NO. 020001 CONTRACT NO. 0001
DRAWN WJK CHECKED
DATE 3/5/2002

ELECTRICAL SITE PLAN (SOUTH) AND SCHEDULES
SHEET 12 OF 14

E1
Copyright © 2002 Kuhlmann Design Group, Inc. All Rights Reserved.

