

F.A. RTE.	SECTION	COUNTY	TOTAL SHEETS	SHEET NO.
9303	01-00032-05-PV	MONROE	23	12
STA.		TO STA.		
FED. ROAD DIST. NO.		ILLINOIS FED. AID PROJECT		
INTERSECTION DETAILS				
CONTRACT NO. 97250				

NORTH METTER STREET

POINT	STATION	DISTANCE, OFFSET	EOP ELEVATION (FEET)	REMARKS
1	91+76.24	13.00' LT	493.69	END OF RADIUS
2	91+90.34	18.82' LT	493.31	
3	91+96.24	32.89' LT	492.92	
4	91+98.41	53.00' LT	492.77	MATCH EXISTING
5	91+90.34	13.00' LT	493.43	
6	92+10.06	12.81' LT	493.08	
7	92+10.24	32.81' LT	493.03	
8	92+10.41	53.00' LT	492.97	MATCH EXISTING
9	92+29.71	13.00' LT	492.69	
10	92+21.71	53.10' LT	492.35	MATCH EXISTING
11	92+23.80	32.85' LT	492.75	
12	92+29.71	18.80' LT	492.63	
13	92+43.80	13.00' LT	492.38	END OF RADIUS
14	91+76.24	33.00' LT		CENTER OF 20' RADIUS
15	92+43.80	33.00' LT		CENTER OF 20' RADIUS

SOUTH METTER STREET

POINT	STATION	DISTANCE, OFFSET	EOP ELEVATION (FEET)	REMARKS
1	91+75.65	13.00' RT	493.68	END OF RADIUS
2	91+83.33	14.53' RT	493.57	
3	91+83.33	13.00' RT	493.56	
4	91+89.84	13.08' RT	493.43	
5	91+89.84	18.90' RT	493.49	
6	91+92.54	22.28' RT	493.43	
7	91+95.65	33.11' RT	493.49	
8	92+09.83	13.19' RT	493.08	
9	92+09.65	33.19' RT	493.49	
10	92+29.90	18.91' RT	492.71	
11	92+29.90	13.11' RT	492.68	
12	92+44.09	13.00' RT	492.38	END OF RADIUS
13	91+97.48	53.00' RT	493.72	MATCH EXISTING
14	92+09.48	53.00' RT	493.90	MATCH EXISTING
15	92+22.18	52.90' RT	493.49	MATCH EXISTING
16	92+24.09	33.15' RT	493.21	
17	91+75.65	33.00' RT		CENTER OF 20' RADIUS
18	92+44.09	33.00' RT		CENTER OF 20' RADIUS

NORTH ALLEY/DRIVEWAY

POINT	STATION	DISTANCE, OFFSET	EOP ELEVATION (FEET)	REMARKS
1	93+35.00	13.00' LT	489.95	END OF RADIUS
2	93+43.00	13.00' LT	489.73	
3	93+50.71	13.00' LT	489.51	
4	93+59.00	13.00' LT	489.27	
5	93+64.82	13.00' LT	489.10	
6	93+70.11	13.00' LT	488.95	
7	93+74.82	13.00' LT	488.82	
8	93+82.82	13.00' LT	488.59	END OF RADIUS
9	93+43.00	23.00' LT	489.76	
10	93+44.05	26.45' LT	489.60	MATCH EXISTING
11	93+50.71	26.45' LT	489.60	MATCH EXISTING
12	93+50.71	23.00' LT	489.54	
13	93+59.00	23.00' LT	489.30	
14	93+59.01	26.45' LT	489.60	MATCH EXISTING
15	93+61.91	19.82' LT	489.60	2' RADIUS
16	93+64.82	23.00' LT	488.96	
17	93+66.69	30.37' LT	488.73	MATCH EXISTING
18	93+70.11	30.37' LT	488.66	MATCH EXISTING
19	93+70.11	23.00' LT	488.81	
20	93+74.82	30.37' LT	488.51	MATCH EXISTING
21	93+74.82	23.00' LT	488.68	
22	93+35.00	23.00' LT		CENTER OF 8' RADIUS
23	93+82.82	23.00' LT		CENTER OF 8' RADIUS

SOUTH ALLEY

POINT	STATION	DISTANCE, OFFSET	EOP ELEVATION (FEET)	REMARKS
1	93+73.50	13.00' RT	488.85	END OF RADIUS
2	93+81.50	13.00' RT	488.63	
3	93+87.50	13.00' RT	488.46	
4	93+93.50	13.00' RT	488.28	
5	94+01.50	13.00' RT	488.06	END OF RADIUS
6	93+81.50	23.00' RT	488.78	
7	93+87.50	23.00' RT	488.61	
8	93+93.50	23.00' RT	488.43	
9	93+81.50	34.00' RT	489.05	MATCH EXISTING
10	93+87.50	34.00' RT	489.05	MATCH EXISTING
11	93+92.88	34.00' RT	489.09	MATCH EXISTING
12	93+73.50	23.00' RT		CENTER OF 8' RADIUS
13	94+01.50	23.00' RT		CENTER OF 8' RADIUS

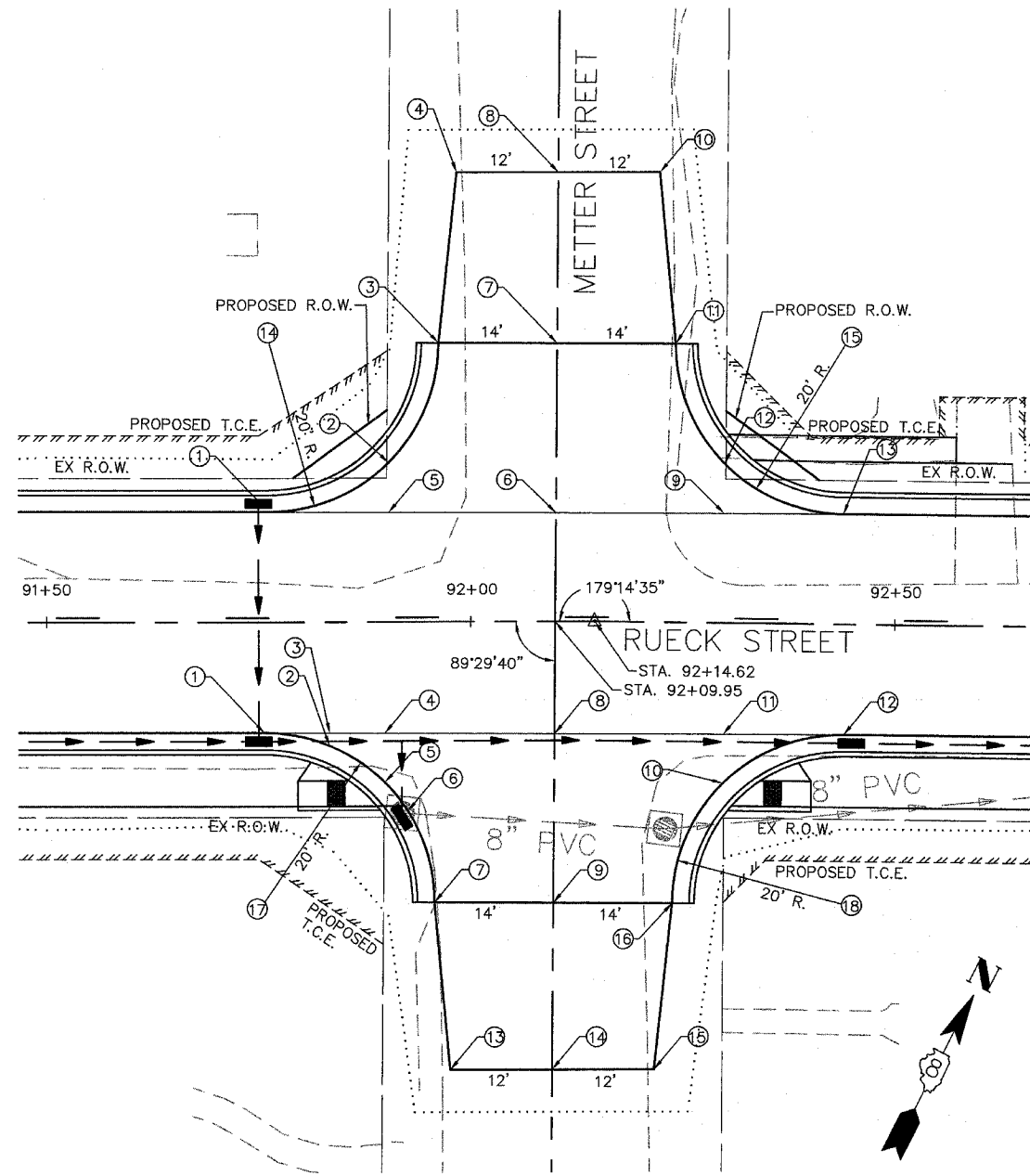

INTERSECTION LAYOUT AT
METTER STREET & RUECK STREET

SCALE 1" = 10'

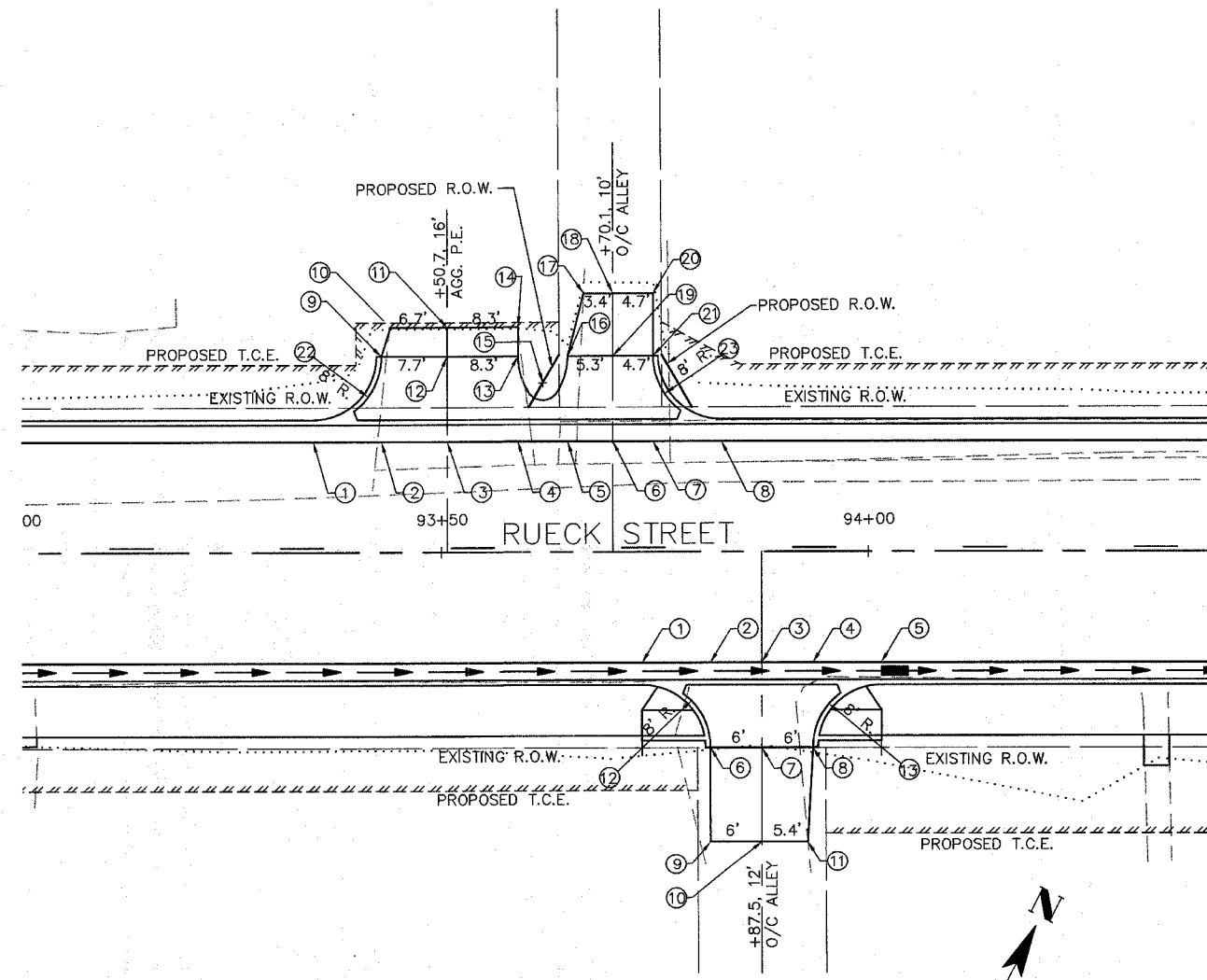

INTERSECTION LAYOUT AT
ALLEYS & RUECK STREET

SCALE 1" = 10'