

PE084

| REVISIONS | | |
|-----------|----|------|
| NUMBER | BY | DATE |
| | | |
| | | |
| | | |

0 1 2
 THIS BAR IS EQUAL TO 2'
 AT FULL SCALE (34X22).
 PLOT 1

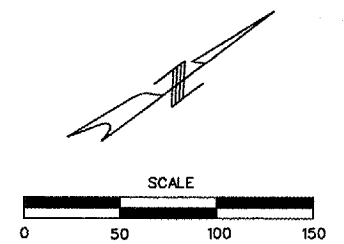

- LEGEND**
- REMOVE EXISTING PAVEMENT
CONSTRUCT 2" BITUMINOUS SURFACE COURSE
ON 2" BITUMINOUS BASE COURSE ON 8" CRUSHED
AGGREGATE BASE COURSE
 - CONSTRUCT 2" BITUMINOUS SURFACE COURSE
ON 2" BITUMINOUS BASE COURSE ON 8" CRUSHED
AGGREGATE BASE COURSE
 - CONSTRUCT 2" BITUMINOUS
SURFACE COURSE OVERLAY
 - REMOVE EXISTING PAVEMENT
 - CONSTRUCT 4" P.C.C. SIDEWALK
ON 2" SAND (FA-2)

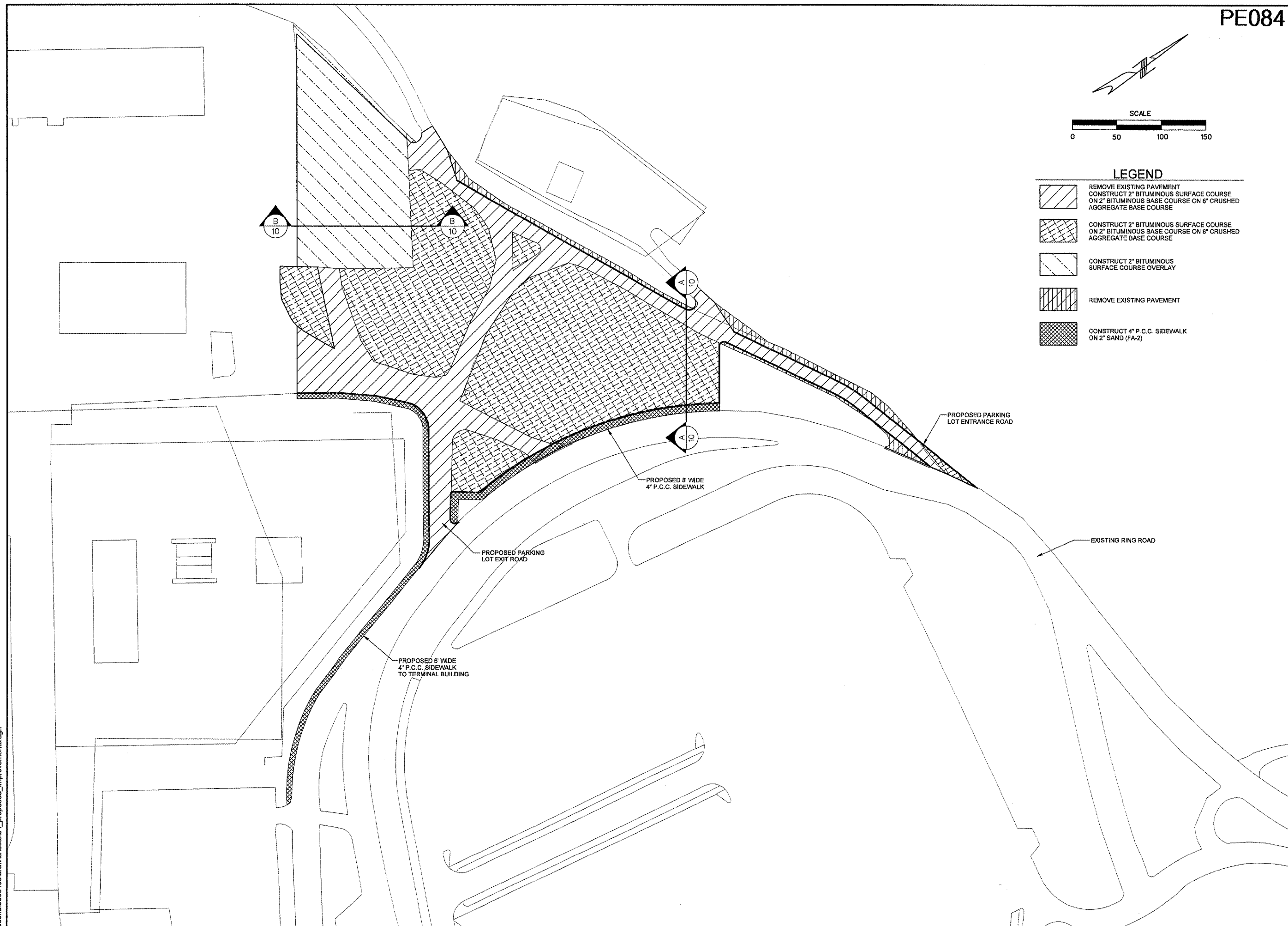

G R E A T E R
Peoria
 R E G I O N A L
Airport

**CONSTRUCT, LIGHT & MARK
 WEST LONG TERM PARKING LOT**

CMT
 CRAWFORD, MURPHY & TILLY, INC.
 CONSULTING ENGINEERS
© Copyright CMT, Inc.

IL PROJECT NUMBER
PIA-3385

FILE: _____

DESIGN BY: BWG

DRAWN BY: JSP

CHECKED BY: BJS

APPROVED BY: CET

DATE: JUNE 17, 2005

JOB No: 05061-03-00

**PROPOSED
IMPROVEMENTS**

SHEET 4 OF 41 SHEETS

05/26/2005
 k:\peoria\0506103\drawings\04_proposed_improvements.dgn