

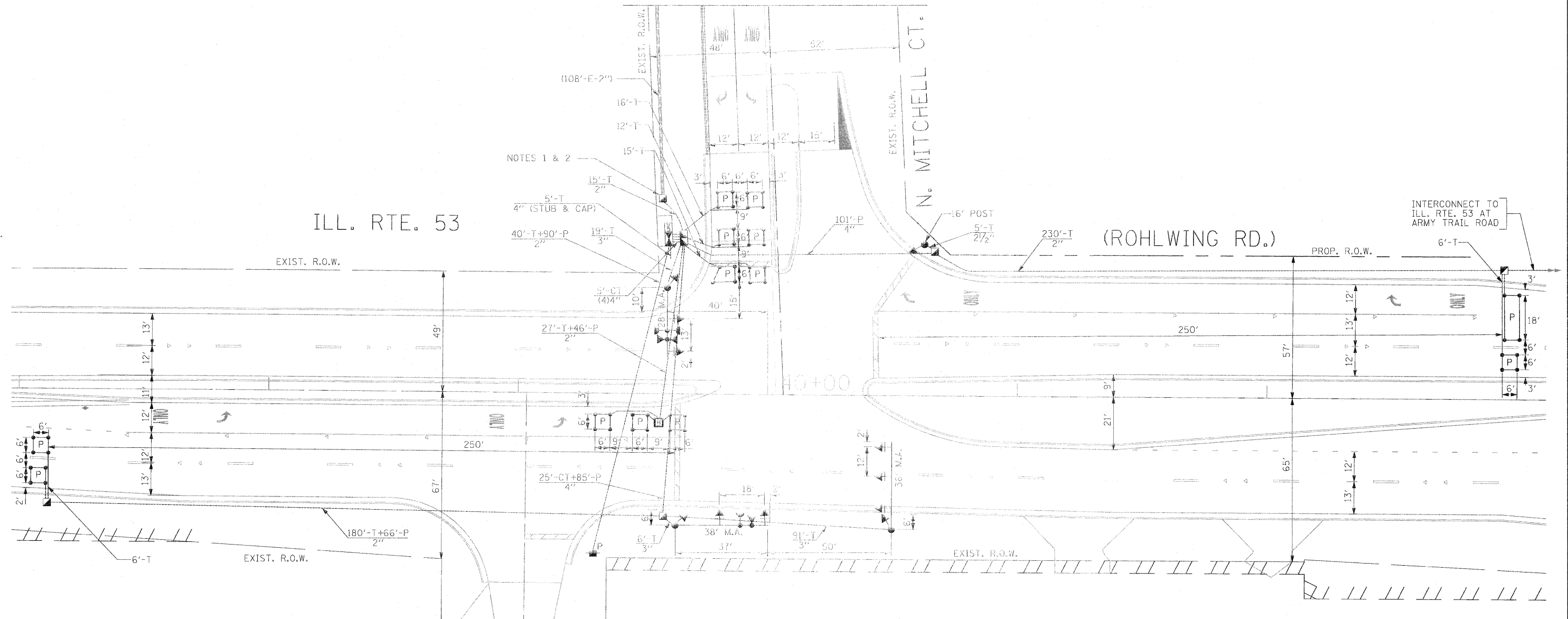

- NOTE 1: THE PROPOSED HANDHOLE SHALL BE CONSTRUCTED TO INTERCEPT THE EXISTING CONDUIT AS SHOWN IN THE PLAN AND AS DIRECTED BY THE ENGINEER.
- NOTE 2: REMOVE TWO EXISTING 2C CABLES FROM EXISTING TEMPORARY CONTROLLER TO THE WEST OF THE PROPOSED HANDHOLE AND REINSTALL IN THE PROPOSED CONDUITS, DOUBLE HANDHOLE, AND TO THE PROPOSED CONTROLLER CABINET (35' ±).
- NOTE 3: THE CONTRACTOR SHALL NOTIFY THE ADDISON FIRE DEPARTMENT A MINIMUM OF 24 HOURS PRIOR TO AND THE DAY OF ANY DOWN TIME IN THE OPERATION OF THE EMERGENCY VEHICLE PREEMPTION PUSH-BUTTONS LOCATED IN THE FIRE STATION LOCATED IN THE SOUTHWEST CORNER OF THIS INTERSECTION. THE DOWN TIME SHALL NOT EXCEED 2 HOURS.

MATCH LINE A-A



THE TRAFFIC SIGNAL CONTROL EQUIPMENT FOR THIS PROJECT SHALL BE "ECONOLITE" TO MATCH THE EXISTING ADJACENT SYSTEM.

Rev. 6-8-11

FILE NAME = #FILE#	USER NAME = #USER#	DESIGNED - PKG	REVISED -	STATE OF ILLINOIS DEPARTMENT OF TRANSPORTATION	TRAFFIC SIGNAL INSTALLATION PLAN ILLINOIS ROUTE 53 (ROHLWING RD.) AT N. MITCHELL CT. (SHEET 1 OF 2)			F.A.P. RTE. 2578	SECTION 532B	COUNTY DuPage	TOTAL SHEETS 781	SHEET NO. 435	
	PLOT SCALE = #SCALE#	DRAWN - MAA, EA	REVISED -		SCALE: 1"=20'	SHEET NO. OF SHEETS	STA. TO STA.	CONTRACT NO. 60477		FED. ROAD DIST. NO. - [ILLINOIS] FED. AID PROJECT			
	PLOT DATE = #DATE#	CHECKED - PKG, EA	REVISED -										
		DATE - 5/18/2011	REVISED -										