

TEMPORARY RADIO INTERCONNECT TO  
MEDINAH DR./SPRING LAKE DR.  
(SEE TEMPORARY INTERCONNECT PLANS)

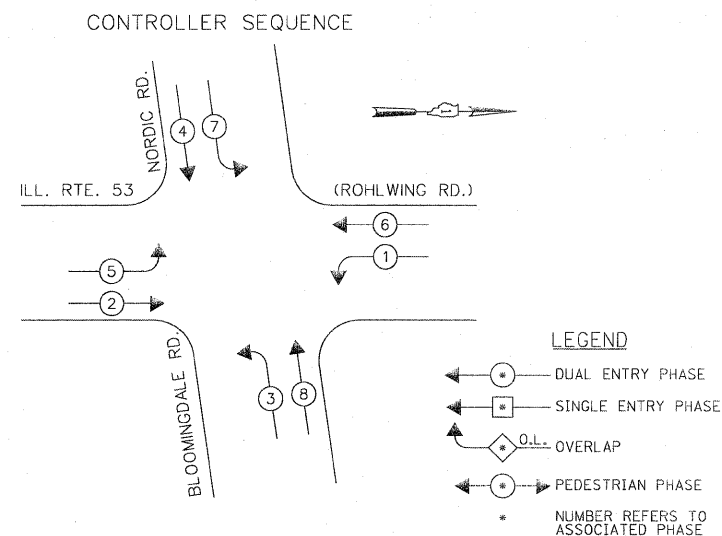

**TEMPORARY PHASE DESIGNATION DIAGRAM**

STAGES: PRE-STAGE, S1-1, S1-2, S1-3, S2-1, S2-2, S2-3, S3, AND AFTER PROPOSED ROADWAY GEOMETRICS ARE BUILT

**EMERGENCY VEHICLE PREEMPTION SEQUENCE**

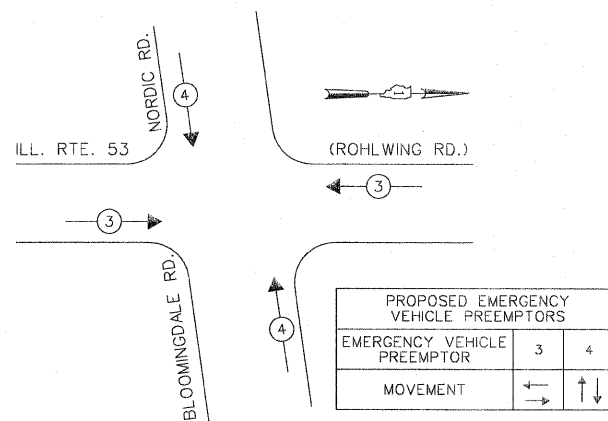

STAGES: PRE-STAGE, S1-1, S1-2, S1-3, S2-1, S2-2, S2-3, S3, AND AFTER PROPOSED ROADWAY GEOMETRICS ARE BUILT

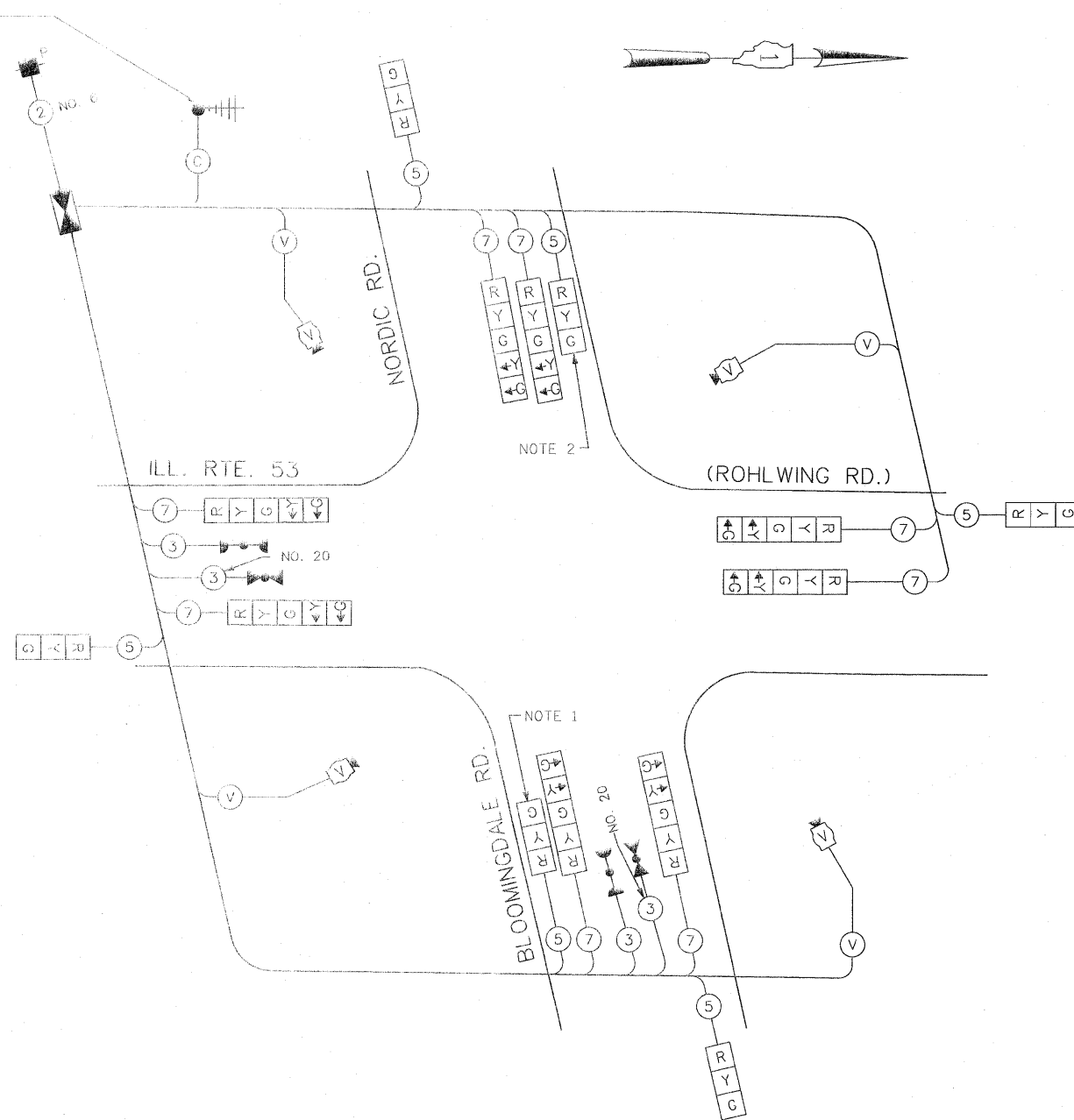

STAGES: PRE-STAGE, S1-1, S1-2, S1-3, S2-1, S2-2, S2-3, S3, AND AFTER PROPOSED ROADWAY GEOMETRICS ARE BUILT

NOTE 1: THE 3-SECTION SIGNAL HEAD MOUNTED ON THE FAR-SIDE SPAN WIRE FOR EASTBOUND DIRECTION OF TRAFFIC IS NEEDED DURING CONSTRUCTION STAGE S2-2. IN ALL OTHER STAGES THIS 3-SECTION SIGNAL HEAD SHALL BE DISCONNECTED AND BAGGED.

NOTE 2: THE 3-SECTION SIGNAL HEAD MOUNTED ON THE FAR-SIDE SPAN WIRE FOR WESTBOUND DIRECTION OF TRAFFIC IS NEEDED DURING CONSTRUCTION STAGE S1-2. IN ALL OTHER STAGES THIS 3-SECTION SIGNAL HEAD SHALL BE DISCONNECTED AND BAGGED.

THE TRAFFIC SIGNAL CONTROL EQUIPMENT FOR THIS PROJECT SHALL BE "ECONOLITE" TO MATCH THE EXISTING ADJACENT SYSTEM.

I.D.O.T. TRAFFIC SIGNAL INSTALLATION ELECTRICAL SERVICE REQUIREMENTS					TOTAL WATTAGE
TYPE	NO LAMPS	WATTAGE		%OPERATION	
		INCAND.	LED		
SIGNAL (RED)	14	135	17	0.50	119
(YELLOW)	14	135	25	0.25	87.5
(GREEN)	14	135	15	0.25	52.5
ARROW	16	135	12	0.10	19.2
PED. SIGNAL		90	25	1.00	
CONTROLLER	1	100	100	1.00	100
ILLUM. SIGN			25	0.05	
VIDEO SYSTEM	1	150		1.00	150
FLASHER				0.50	
ENERGY COSTS TO:					TOTAL = 528.2

VILLAGE OF ITASCA  
550 WEST IRVING PARK ROAD  
ITASCA, ILLINOIS 60143-1795

ENERGY SUPPLY CONTACT: CURTIS TOPPS  
PHONE: (630) 691-4356  
COMPANY: COMMONWEALTH EDISON

FILE NAME =	USER NAME = #USER#	DESIGNED - PKG	REVISED -
#FILEL#		DRAWN - MAA, EA	REVISED -
	PLOT SCALE = #SCALE#	CHECKED - PKG, EA	REVISED -
	PLOT DATE = #DATE#	DATE - 5/18/2011	REVISED -

STATE OF ILLINOIS  
DEPARTMENT OF TRANSPORTATION

TEMPORARY CABLE PLAN, TEMPORARY PHASE DESIGNATION DIAGRAM  
TEMPORARY EMERGENCY VEHICLE PREEMPTION SEQUENCE  
ILLINOIS ROUTE 53 (ROHLWING RD.) AT NORDIC RD./BLOOMINGDALE RD.  
PRE-STAGE, STAGE 1, STAGE 2, AND STAGE 3 (SHEET 4 OF 4).

F.A.P. RTE. 2578	SECTION 532B	COUNTY DuPage	TOTAL SHEETS 781	SHEET NO. 469
FED. ROAD DIST. NO. ILLINOIS FED. AID PROJECT			CONTRACT NO. 60477	

Rev. 6-8-11